

City of Portland, Maine – Building or Use Permit Application 389 Congress Street, 04101, Tel: (207) 874-8703, FAX: 874-8716

Location of Construction: 41 Edgeworth Avenue		Owner: Kelly and Scott Dover		Phone: 871-8966		Permit No: 970616	
Owner Address:		Lessee/Buyer's Name:		Phone:		Business Name:	
Contractor Name:		Address:		Phone:		<div style="border: 2px solid black; padding: 5px; text-align: center;"> PERMIT ISSUED Jun 19 1997 CITY OF PORTLAND </div>	
Past Use: garage		Proposed Use: same w/repairs		COST OF WORK: \$500.00 FIRE DEPT. <input type="checkbox"/> Approved <input type="checkbox"/> Denied Signature:		PERMIT FEE: \$25.00 INSPECTION: Use Group: Type: Signature:	
Proposed Project Description: make repairs to existing garage as per plans				PEDESTRIAN ACTIVITIES DISTRICT (P.A.D.) Action: <input type="checkbox"/> Approved <input type="checkbox"/> Approved with Conditions <input type="checkbox"/> Denied Signature: Date:			
Permit Taken By: Vicki Dover		Date Applied For: 6/12/97					
1. This permit application does not preclude the Applicant(s) from meeting applicable State and Federal rules. 2. Building permits do not include plumbing, septic or electrical work. 3. Building permits are void if work is not started within six (6) months of the date of issuance. False information may invalidate a building permit and stop all work.. Call Kelly for P/U - 883-9610							
<div style="text-align: center;"> CERTIFICATION I hereby certify that I am the owner of record of the named property, or that the proposed work is authorized by the owner of record and that I have been authorized by the owner to make this application as his authorized agent and I agree to conform to all applicable laws of this jurisdiction. In addition, if a permit for work described in the application is issued, I certify that the code official's authorized representative shall have the authority to enter all areas covered by such permit at any reasonable hour to enforce the provisions of the code(s) applicable to such permit </div>							
SIGNATURE OF APPLICANT Kelly Dover		ADDRESS:		DATE: 6/12/97		PHONE:	
RESPONSIBLE PERSON IN CHARGE OF WORK, TITLE						PHONE:	
<div style="text-align: center;"> White-Permit Desk Green-Assessor's Canary-D.P.W. Pink-Public File Ivory Card-Inspector </div>							
<div style="text-align: right;"> Zoning Appeal <input type="checkbox"/> Variance <input type="checkbox"/> Miscellaneous <input type="checkbox"/> Conditional Use <input type="checkbox"/> Interpretation <input type="checkbox"/> Approved <input type="checkbox"/> Denied Historic Preservation <input type="checkbox"/> Not in District or Landmark <input type="checkbox"/> Does Not Require Review <input type="checkbox"/> Requires Review Action: <input type="checkbox"/> Approved <input type="checkbox"/> Approved with Conditions <input type="checkbox"/> Denied Date: </div>							
<div style="text-align: right;"> CEO DISTRICT </div>							

PERMIT ISSUED
WITH REQUIREMENTS

COMMENTS

6/20/97 NW4

Garage repaired w/out inspection.

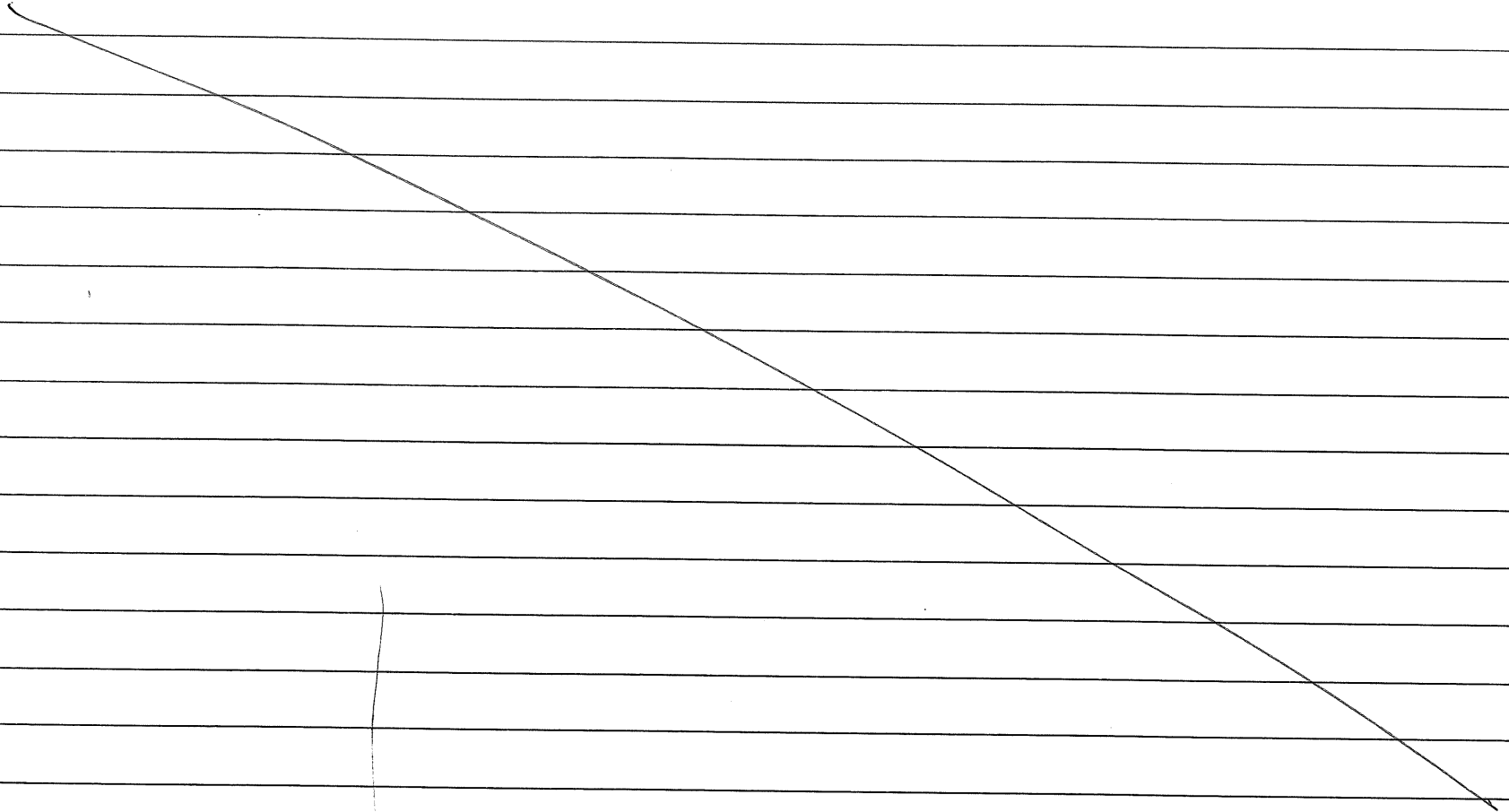

1

Inspection Record		Date
Type		
Foundation:	_____	_____
Framing:	_____	_____
Plumbing:	_____	_____
Final:	_____	_____
Other:	_____	_____

City of Portland, Maine – Building or Use Permit Application 389 Congress Street, 04101, Tel: (207) 874-8703, FAX: 874-8716

Location of Construction: 41 Edgeworth Avenue		Owner: Kelly and Scott Dorr		Phone: 871-8966	Permit No: 970616
Owner Address:		Lessee/Buyer's Name:		Phone:	BusinessName:
Contractor Name:		Address:		Phone:	
Past Use: garage		Proposed Use: same w/repairs		COST OF WORK: \$500.00	PERMIT FEE: \$25.00
				FIRE DEPT. <input type="checkbox"/> Approved <input type="checkbox"/> Denied	INSPECTION: Use Group: U Type: 5B Signature: [Signature]
Proposed Project Description: make repairs to existing garage as per plans				PEDESTRIAN ACTIVITIES DISTRICT (P.A.D.) Action: Approved <input type="checkbox"/> Approved with Conditions: <input type="checkbox"/> Denied <input type="checkbox"/> Signature: _____ Date: _____	
Permit Taken By: Vicki Dover		Date Applied For: 6/12/97			

1. This permit application does not preclude the Applicant(s) from meeting applicable State and Federal rules.
2. Building permits do not include plumbing, septic or electrical work.
3. Building permits are void if work is not started within six (6) months of the date of issuance. False information may invalidate a building permit and stop all work..

Call Kelly for P/U - 883-9610

CERTIFICATION

I hereby certify that I am the owner of record of the named property, or that the proposed work is authorized by the owner of record and that I have been authorized by the owner to make this application as his authorized agent and I agree to conform to all applicable laws of this jurisdiction. In addition, if a permit for work described in the application is issued, I certify that the code official's authorized representative shall have the authority to enter all areas covered by such permit at any reasonable hour to enforce the provisions of the code(s) applicable to such permit

SIGNATURE OF APPLICANT Kelly Dorr ADDRESS: _____ DATE: 6/12/97 PHONE: _____

RESPONSIBLE PERSON IN CHARGE OF WORK, TITLE _____ PHONE: _____

White-Permit Desk Green-Assessor's Canary-D.P.W. Pink-Public File Ivory Card-Inspector

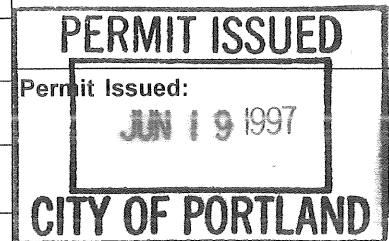

Zone: R-3 CBL: 184-A-12
Zoning Approval: OK with conditions
Special Zone or Reviews:
☐ Shoreland
☐ Wetland
☐ Flood Zone
☐ Subdivision
☐ Site Plan maj ☐ minor ☐ mm

Zoning Appeal

- ☐ Variance
- ☐ Miscellaneous
- ☐ Conditional Use
- ☐ Interpretation
- ☐ Approved
- ☐ Denied

Historic Preservation

- ☒ Not in District or Landmark
- ☒ Does Not Require Review
- ☐ Requires Review

Action:

- ☐ Approved
- ☐ Approved with Conditions
- ☐ Denied

Date: 6/13/97

CEO DISTRICT

[Signature]

PERMIT ISSUED
WITH REQUIREMENTS

LAND USE - ZONING REPORT

ADDRESS: 41 Edgeworth Ave DATE: 6/10/97

REASON FOR PERMIT: Repair existing garage

BUILDING OWNER: Kelly and Scott Dorro-B-L 184-A-12

PERMIT APPLICANT: owner

APPROVED: with conditions DENIED: _____
4

CONDITION(S) OF APPROVAL

1. During its existence, all aspects of the Home Occupation criteria, Section 14-410, shall be maintained.
2. The footprint of the existing _____ shall not be increased during maintenance reconstruction.
3. All the conditions placed on the original, previously approved, permit issued on _____ are still in effect for this amendment.
- (4.) Your present structure is legally nonconforming as to rear and side setbacks. If you were to demolish the building on your own volition, you will not be able to maintain these same setbacks. Instead you would need to meet the zoning setbacks set forth in today's ordinances. In order to preserve these legally non-conforming setbacks, you may only rebuild the garage in place and in phases.
5. This property shall remain a single family dwelling. Any change of use shall require a separate permit application for review and approval.
6. Our records indicate that this property has a legal use of _____ units. Any change in this approved use shall require a separate permit application for review and approval.
7. Separate permits shall be required for any signage.
8. Separate permits shall be required for future decks and/or garage.
9. Other requirements of condition _____

Marge Schmuckal Marge Schmuckal, Zoning Administrator,
Asst. Chief of Code Enforcement

BUILDING PERMIT REPORT

DATE: 19 June 1997 ADDRESS: 41 Edgeworth Ave.
REASON FOR PERMIT: Repair garage
BUILDING OWNER: Dorr
CONTRACTOR: Owner
PERMIT APPLICANT: Dorr APPROVAL: *12*27 DENIED

CONDITION(S) OF APPROVAL

- ~~1.~~ This permit does not excuse the applicant from meeting applicable State and Federal rules and laws.
- ~~2.~~ Before concrete for foundation is placed, approvals from the ~~Development Review Coordinator~~ and Inspection Services must be obtained. (A 24 hour notice is required prior to inspection)
3. Precaution must be taken to protect concrete from freezing.
4. It is strongly recommended that a registered land surveyor check all foundation forms before concrete is placed. This is done to verify that the proper setbacks are maintained.
5. Private garages located beneath habitable rooms in occupancies in Use Group R-1, R-2, R-3 or I-1 shall be separated from adjacent interior spaces by fire partitions and floor/ceiling assembly which are constructed with not less than 1-hour fire resisting rating. Private garages attached side-by-side to rooms in the above occupancies shall be completely separated from the interior spaces and the attic area by means of ½ inch gypsum board or the equivalent applied to the garage means of ½ inch gypsum board or the equivalent applied to the garage side. (Chapter 4 Section 407.0 of the BOCA/1996)
6. All chimneys and vents shall be installed and maintained as per Chapter 12 of the City's Mechanical Code. (The BOCA National Mechanical Code/1993) U.L. 103.
7. Sound transmission control in residential building shall be done in accordance with Chapter 12 section 1214.0 of the city's building code.
8. Guardrail & Handrails A guardrail system is a system of building components located near the open sides of elevated walking surfaces for the purpose of minimizing the possibility of an accidental fall from the walking surface to the lower level. Minimum height all Use Groups 42" , except Use Group R which is 36". In occupancies in Use Group A, B, H-4, I-1, I-2 M and R and public garages and open parking structures, open guards shall have balusters or be of solid material such that a sphere with a diameter of 4" cannot pass through any opening. Guards shall not have an ornamental pattern that would provide a ladder effect.
9. Headroom in habitable space is a minimum of 7'6".
10. Stair construction in Use Group R-3 & R-4 is a minimum of 10" tread and 7 3/4" maximum rise. All other Use group minimum 11" tread. 7" maximum rise.
11. The minimum headroom in all parts of a stairway shall not be less than 80 inches.
12. Every sleeping room below the fourth story in buildings of use Groups R and I-1 shall have at least one operable window or exterior door approved for emergency egress or rescue. The units must be operable from the inside without the use of special knowledge or separate tools. Where windows are provided as means of egress or rescue they shall have a sill height not more than 44 inches (1118mm) above the floor. All egress or rescue windows from sleeping rooms shall have a minimum net clear opening height dimension of 24 inches (610mm). The minimum net clear opening width dimension shall be 20 inches (508mm), and a minimum net clear opening of 5.7 sq. ft.
13. Each apartment shall have access to two (2) separate, remote and approved means of egress. A single exit is acceptable when it exits directly from the apartment to the building exterior with no communications to other apartment units.
14. All vertical openings shall be enclosed with construction having a fire rating of at least one (1) hour, including fire doors with self closer's.
15. The boiler shall be protected by enclosing with (1) hour fire-rated construction including fire doors and ceiling, or by providing automatic extinguishment.
16. All single and multiple station smoke detectors shall be of an approved type and shall be installed in accordance with the provisions of the City's Building Code Chapter 9, Section 19, 920.3.2 (BOCA National Building Code/1996), and NFPA 101 Chapter 18 & 19. (Smoke detectors shall be installed and maintained at the following locations):
 - In the immediate vicinity of bedrooms
 - In all bedrooms
 - In each story within a dwelling unit, including basements

In addition to the required AC primary power source, required smoke detectors in occupancies in Use Groups R-2, R-3 and

I-1 shall receive power from a battery when the AC primary power source is interrupted. (Interconnection is required)

17. A portable fire extinguisher shall be located as per NFPA #10. They shall bear the label of an approved agency and be of an approved type.
18. The Fire Alarm System shall be maintained to NFPA #72 Standard.
19. The Sprinkler System shall maintained to NFPA #13 Standard.
20. All exit signs, lights, and means of egress lighting shall be done in accordance with Chapter 10 Section & Subsections 1023. & 1024. Of the City's building code. (The BOCA National Building Code/1996)
21. All construction and demolition debris must be disposed at the City's authorized reclamation site. The fee rate is attached. Proof of such disposal must be furnished to the office of Inspection Services before final Certificate of Occupancy is issued or demolition permit is granted.
22. Section 25-135 of the Municipal Code for the City of Portland states, "No person or utility shall be granted a permit to excavate or open any street or sidewalk from the time of November 15 of each year to April 15 of the following year".
23. The builder of a facility to which Section 4594-C of the Maine State Human Rights Act Title 5 MRSA refers, shall obtain a certification from a design professional that the plans commencing construction of the facility, the builder shall submit the certification to the Division of Inspection Services.
24. This permit does not excuse the applicant from obtaining any license which may be needed from the City Clerk's office.
25. Ventilation shall meet the requirements of Chapter 12 Sections 1210. of the City's Building Code.
26. All electrical and plumbing permits must be obtained by a Master Licensed holders of their trade.

*27. Please read and implement items on attached Land Use - Zoning report

28. _____

29. _____

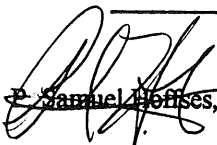
P. Samuel Hoffes, Chief of Code Enforcement

cc: Lt. McDougall, PFD
Marge Schmuckal

6/11/97

Kelly + Scott Dorr
41 Edgeworth Ave
Portland ME 04103
184-A-12
#4

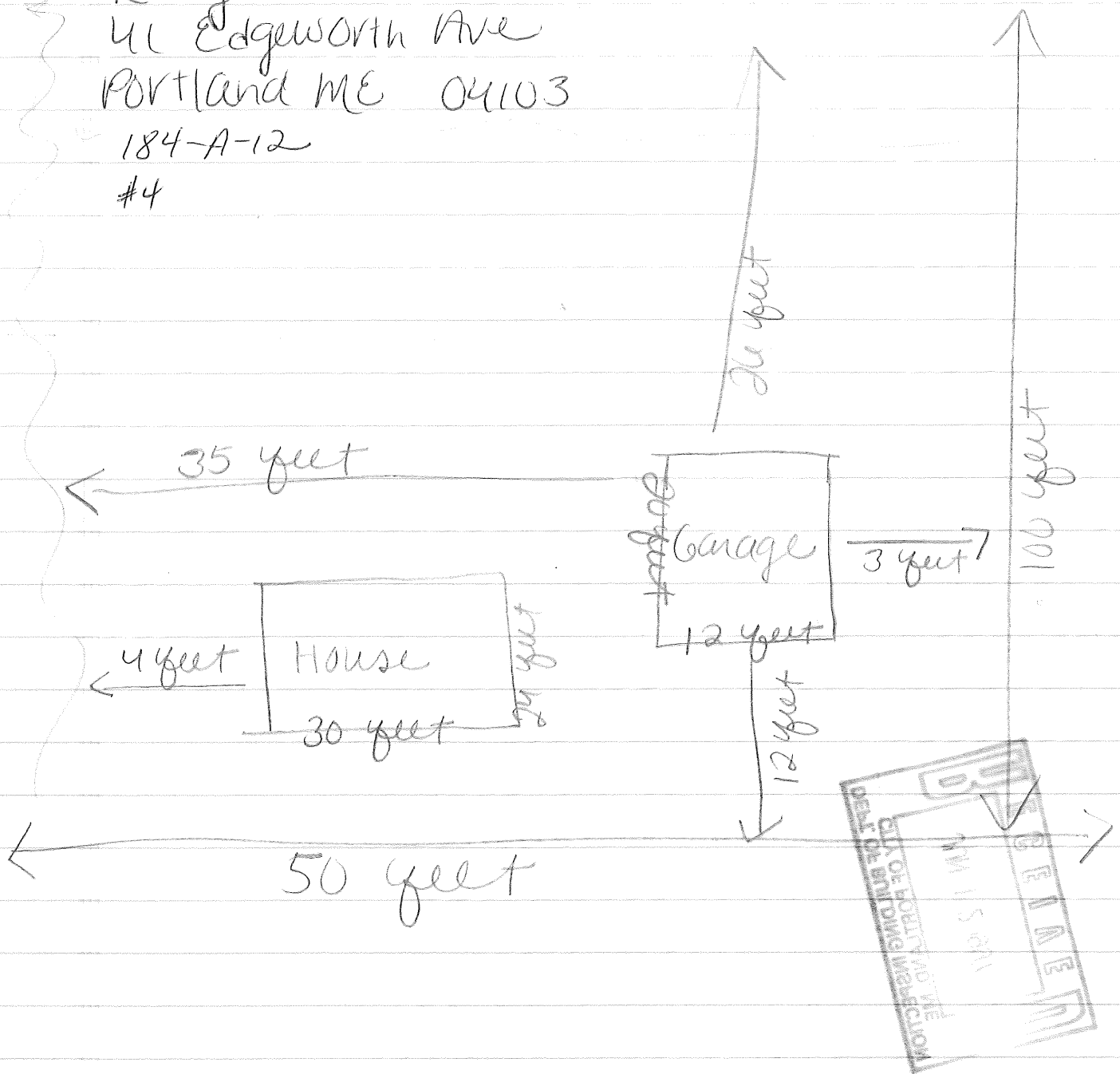

We will be repairing our garage. The garage was built on top of a ~~t/r~~ driveway. The ~~t/r~~ has given way on the sides and the bottom boards of the garage have rotted causing garage to lean.

The boards in the garage going up and down are 23 ~~i~~ches on the center. The side walls are tounge and groove 7 1/2 boards.

We will jack up the garage and replace 4 of the 7 1/2 tounge and groove boards around the bottom. We also will pour a cement slab underneath. The ~~t/r~~ has given away and this will prevent the bottom boards from rotting again. If we can not afford the cement slab, then we will put some cement blocks along the ~~u~~nderneath so that the bottom of the garage will not be sitting on the ground.

