

**SECTION 1**  
1/2" = 1'-0" **82**

NOTE: RAISED (OR HIGH) FLOOR ELEVATION (+ 109'-10 3/4") SHALL BE VERIFIED IN THE FIELD (V.I.F.) BY G.C. TO MATCH EXISTING FLOOR ELEVATION IN MAIN BLDG.

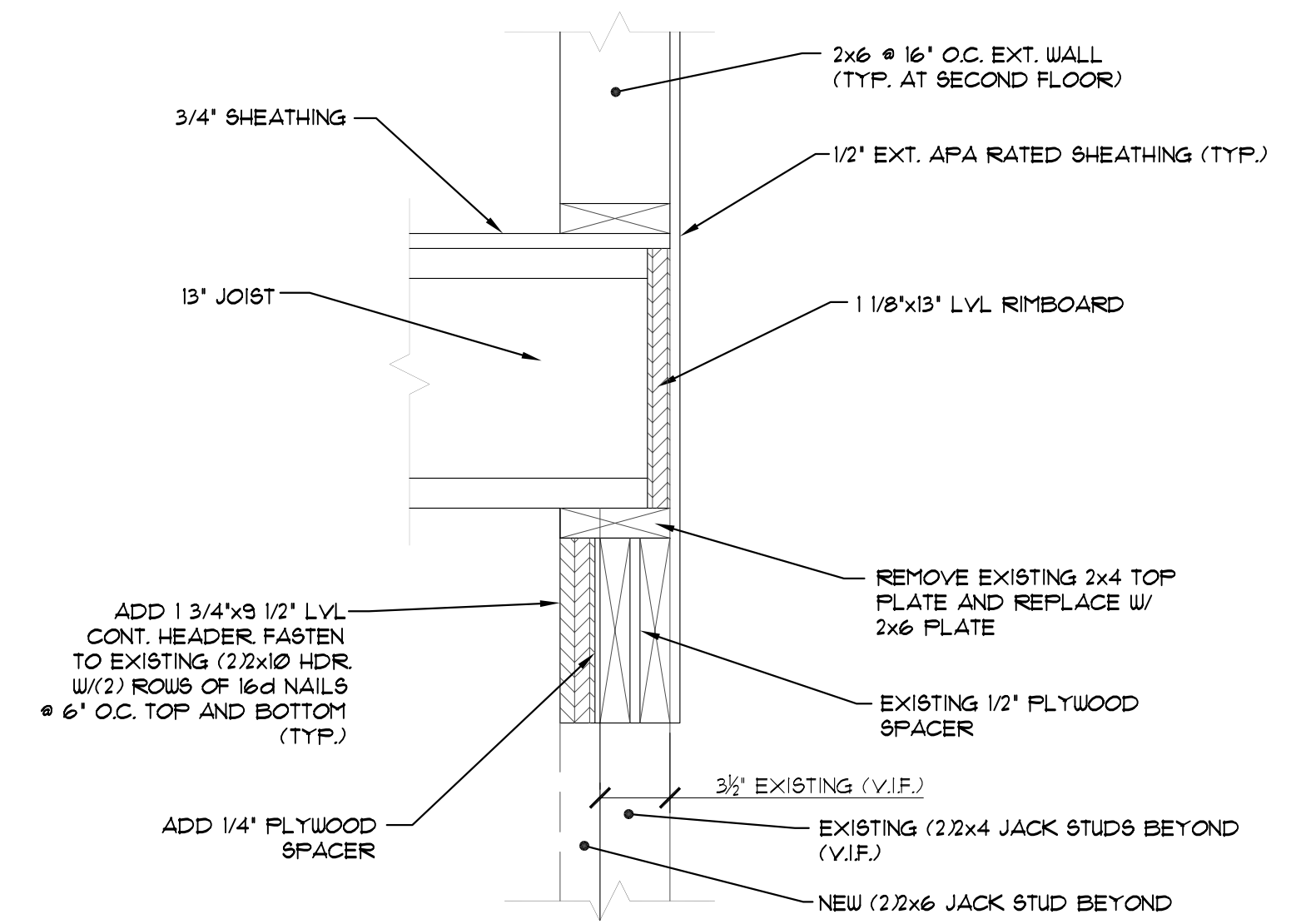

**DETAIL (@ OVERHEAD DOOR HEADERS)** **A**  
1 1/2" = 1'-0" **S3**

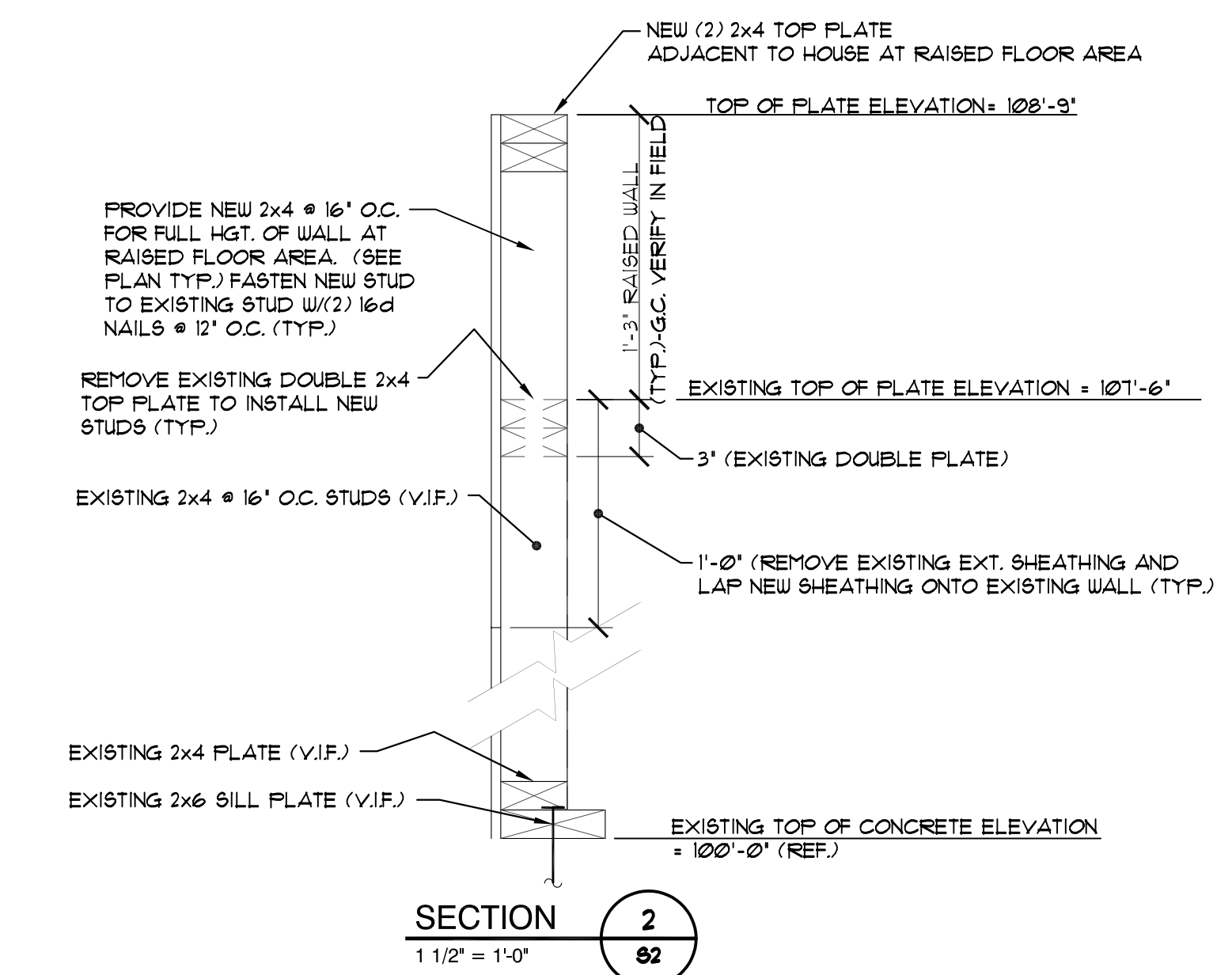

**SECTION 2**  
1 1/2" = 1'-0" **82**

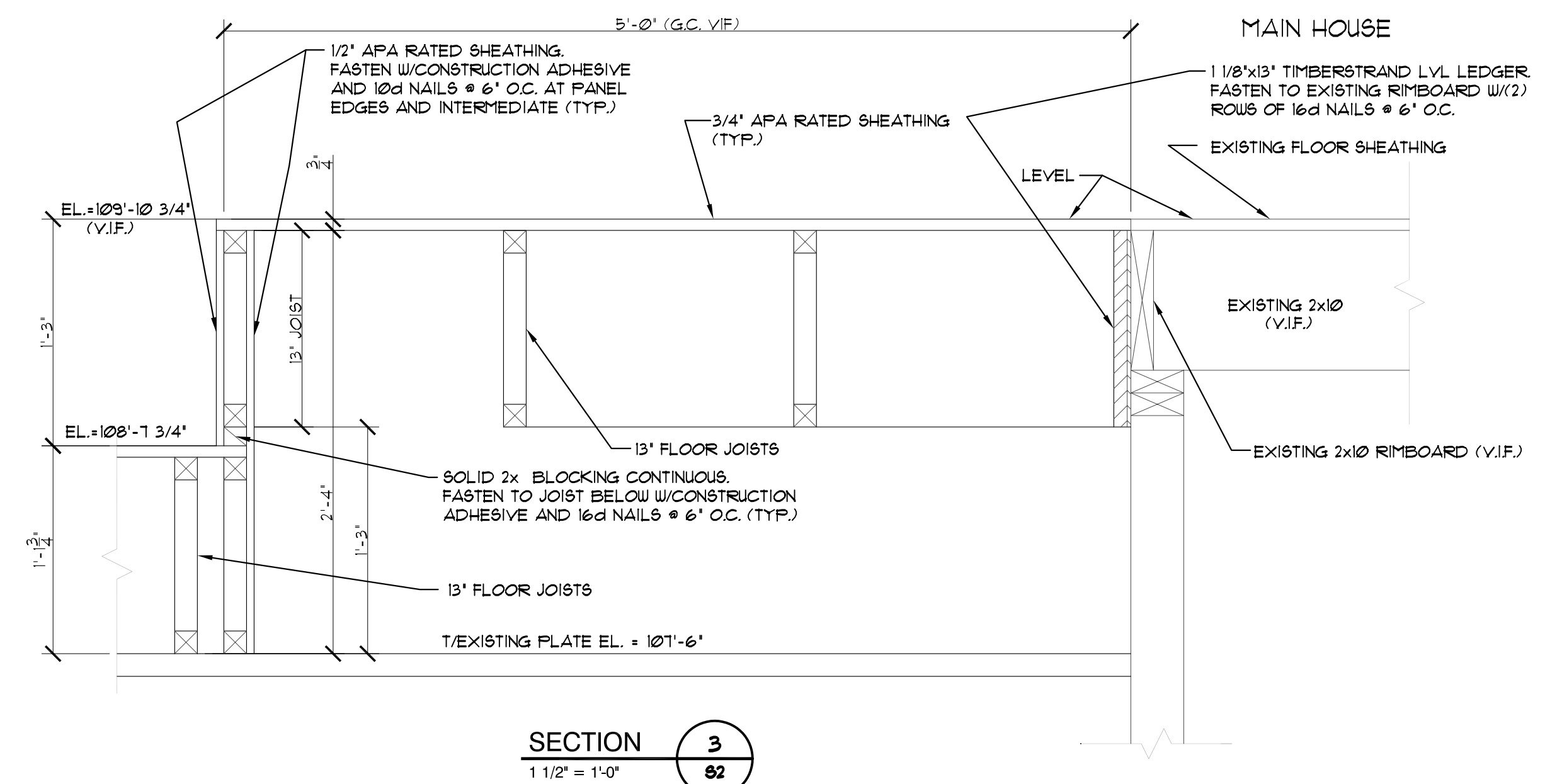

**SECTION 3**  
1 1/2" = 1'-0" **82**

**L & L STRUCTURAL ENGINEERING SERVICES, INC.**  
SIX Q STREET  
SOUTH PORTLAND, MAINE 04106  
PHONE: (207) 767-4830  
FAX: (207) 799-5432

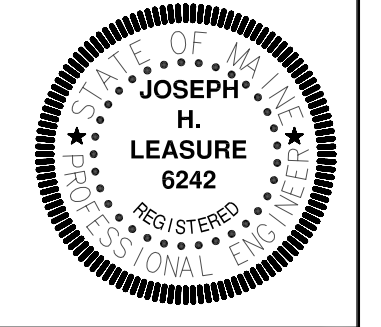

app'd	description	date	rev.

designed by: HLL	checked by: MFL	scale: AS NOTED	date: OCT. 20, 2006	plot date: OCT. 20, 2006	project #: 26181
drawn by: LEM					

**PIACENTINI ADDITION**  
59 Phipps Rd,  
Portland, Maine  
SECTIONS AND DETAIL

**S3**