

**City of Portland, Maine - Building or Use Permit Application**

389 Congress Street, 04101 Tel: (207) 874-8703, Fax: (207) 874-8716

Permit No: 06-071	Issue Date: <b>PERMIT ISSUED</b>	CBL: 182A B008001
----------------------	-------------------------------------	----------------------

Location of Construction: 29 ALDEN CIR	Owner Name: SPUGNARDI MICHAEL P	Owner Address: 29 ALDEN CIR	Phone:
Business Name:	Contractor Name: Home owner	Contractor Address:	Phone:
Lessee/Buyer's Name	Phone:	Permit Type: Additions - Commercial	Zone: R3

Past Use: Single Family	Proposed Use: Single Family 2' x 21' deck	Permit Fee: \$40.00	Cost of Work: \$1,400.00	CEO District: 5
----------------------------	--	------------------------	-----------------------------	--------------------

Proposed Project Description: 12' x 21' deck	FIRE DEPT: <input type="checkbox"/> Approved <input type="checkbox"/> Denied <i>N/A</i>	INSPECTION: Use Group <i>R-3</i> Type <i>SB</i> <i>IRC 2003</i>
	Signature	Signature

PEDESTRIAN ACTIVITIES DISTRICT (P.A.D.)	
Action <input type="checkbox"/> Approved <input type="checkbox"/> Approved w/Conditions <input type="checkbox"/> Denied	
Signature	Date

Permit Taken By: dmartin	Date Applied For: 07/20/2006	<b>Zoning Approval</b>
-----------------------------	---------------------------------	------------------------

<p>1.</p> <p>2. Building permits do not include plumbing, septic or electrical work.</p> <p>3. Building permits are void if work is not started within six (6) months of the date of issuance. False information may invalidate a building permit and stop all work..</p>	<b>Special Zone or Reviews</b> <input type="checkbox"/> Shoreland <input type="checkbox"/> Wetland <input type="checkbox"/> Flood Zone <input type="checkbox"/> Subdivision <input type="checkbox"/> Site Plan Maj <input type="checkbox"/> Minor <input type="checkbox"/> MM <input type="checkbox"/> <i>Ok w/condition</i> Date: 7/27/06 <i>ABM</i>	<b>Zoning Appeal</b> <input type="checkbox"/> Variance <input type="checkbox"/> Miscellaneous <input type="checkbox"/> Conditional Use <input type="checkbox"/> Interpretation <input type="checkbox"/> Approved <input type="checkbox"/> Denied late:	<b>Historic Preservation</b> <input checked="" type="checkbox"/> Not in District or Landmark <input type="checkbox"/> Does Not Require Review <input type="checkbox"/> Requires Review <input type="checkbox"/> Approved <input type="checkbox"/> Approved w/Conditions <input type="checkbox"/> Denied <i>ABM</i> late:
---	---	---	--

**CERTIFICATION**

I hereby certify that I am the owner of record of the named property, or that the proposed work is authorized by the owner of record and that I have been authorized by the owner to make this application as his authorized agent and I agree to conform to all applicable laws of this jurisdiction. In addition, if a permit for work described in the application is issued, I certify that the code official's authorized representative shall have the authority to enter all areas covered by such permit at any reasonable hour to enforce the provision of the code(s) applicable to such permit.

SIGNATURE OF APPLICANT	ADDRESS	DATE	PHONE
RESPONSIBLE PERSON IN CHARGE OF WORK. TITLE		DATE	PHONE



# General Building Permit Application

If you or the property owner owes real estate or personal property taxes or uset charges on any property within the City, payment arrangements must be made before permits of any kind are accepted.

Location/Address of Construction: <u>24 ALDEN CIRCLE</u>		
Total Square Footage of Proposed Structure <u>262</u>	Square Footage of Lot <u>10,260</u>	
Tax Assessor's Chart, Block & Lot Chart#      Block#      Lot# <u>182 A      B      008</u>	Owner: <u>MICHAEL SPUGNARDI</u>	Telephone: <u>207-899-0582</u>
Lessee/Buyer's Name (If Applicable)	Applicant name, address & telephone: <u>MICHAEL SPUGNARDI</u> <u>29 ALDEN CIRCLE</u> <u>PORTLAND, ME 04102</u>	Cost Of Work: \$ <u>1,400</u> Fee: \$ <u>40</u> C of O Fee: \$ _____
Current Specific use: <u>SINGLE FAMILY</u>		
If vacant, what was the previous use? _____		
Proposed Specific use: _____		
Project description: <u>12 x 2) DECK</u>		

Contractor's name, address & telephone: <u>HOMEOWNER</u>	
Who should we contact when the permit is ready. <u>MICHAEL SPUGNARDI</u>	Mailing address: _____
Phone: <u>207-415-5627 (CELL)</u>	

In order to be sure the City fully understands the full scope of the project, the Planning and Development Department may request additional information prior to the issuance of a permit. For further information visit us on-line at [www.portlandmaine.gov](http://www.portlandmaine.gov), stop by the Building Inspections office, room 315 City Hall or call 874-8703.

I hereby certify that I am the Owner of record of the named property, or that the owner of record authorizes the proposed work and that I have been authorized by the owner to make this application as his/her authorized agent. I agree to conform to all applicable laws of this jurisdiction. In addition, if a permit for work described in this application is issued, I certify that the Code Official's authorized representative shall have the authority to enter all areas covered by this permit at any reasonable hour to enforce the provisions of the codes applicable to this permit.

Signature of applicant: <u>[Signature]</u>	Date: <u>7/20/06</u>
--	----------------------

CITY OF PORTLAND, ME

JUL 20 2006

RECEIVED

This is not a permit; you may not commence ANY work until the permit is issued.

**City of Portland, Maine - Building or Use Permit**

<b>Permit No:</b> 06-1071	<b>Date Applied For:</b> 0712012006	<b>CBL:</b> 182A BOO8001
------------------------------	--	-----------------------------

<b>Location of Construction:</b> 29 ALDEN CIR	<b>Owner Name:</b> SPUGNARDI MICHAEL P	<b>Owner Address:</b> 29 ALDEN CIR	<b>Phone:</b>
<b>Business Name:</b>	<b>Contractor Name:</b> Home owner	<b>Contractor Address:</b>	<b>Phone:</b>
<b>Tenant/Lessee/Buyer's Name</b>	<b>Phone:</b>	<b>Permit Type:</b> Additions - Commercial	

Single Family 12' x 21' deck	12' x 21' deck
------------------------------	----------------

**Dept:** Zoning      **Status:** Approved with Conditions      **Reviewer:** Ann Machado      **Approval Date:** 0712712006  
**Note:** **Ok to Issue:**

1) This permit is being approved on the basis of plans submitted. Any deviations shall require a separate approval before starting that work.

**Dept:** Building      **Status:** Approved      **Reviewer:** Tammy Munson      **Approval Date:** 0811112006  
**Note:** **Ok to Issue:**

**Comments:**  
7126106-amachado: Spoke to Michael Spugnardi. The plot plan is not to scale so I need the distances from the rear & side property lines to make sure that the new deck meets the zoning requirements.  
7127106-amachado: Michael emailed me a PDF with the setbacks.

This page contains a detailed description of the Parcel ID you selected. Press the **New Search** button at the bottom of the screen to submit a new query.

lot 19 PB 50/64

**Location** 29 ALDEN CIR  
**Land Use** SINGLE FAMILY

**Owner Address** SPUGNARDI MICHAEL P  
 29 ALDEN CIR  
 PORTLAND ME 04102

**Book/Page** 20419/315  
**Legal** 182A-B-8  
 ALDEN CIRCLE 27-33  
 9137 SF

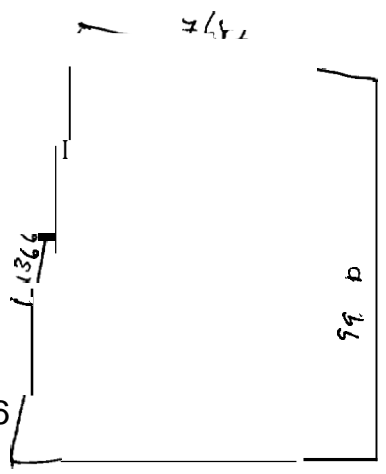

Current Assessed Valuation For Fiscal Year 2006

Estimated Assessed Valuation For Fiscal Year 2007\*

Land	Building	Total
\$66,200	\$124,000	\$190,200

\* Value subject to change based upon review of property status as of 4/1/06. The tax rate will be determined by City Council in May 2006.

Property Information

Year Built	Style	Story Height	Sq. Ft.	Total Acres	Bedrooms	Full Baths	Half Baths	Total Rooms	Attic	Basement
1955	Ranch	1	1161	0.21	3	1	1	6	None	Full

Outbuildings

Type	quantity	Year Built	Size	Grade	Condition
GARAGE-WD/CB	1	1955	14X22	C	A

Sales Information

Date	Type	Price	Book/Page
10/01/2003	LAND + BLUING	\$188,000	20419-315

Picture and Sketch

Picture Sketch Tax Map

[Click here to view Tax Roll Information.](#)

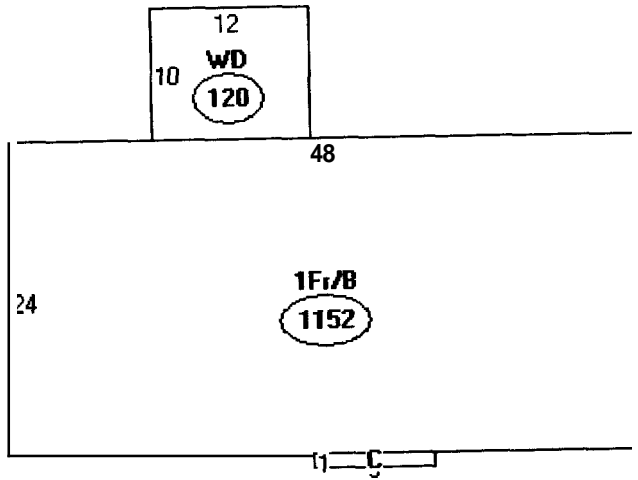

Descriptor/Area

A: 1Fr/B  
1152 sqft

~~B: WD  
120 sqft~~

C: FBAY  
9 sqft

11617

bulldozer 5x6 = 30

land step 3x5 = 25  
5x2

garage = 308

R3  
Rear 25' req - 44.5 given  
Side 8' req - 24 from right  
- 38 from left to steps  
lot coverage - 35% = 3197.95 sq ft

1776 sq ft

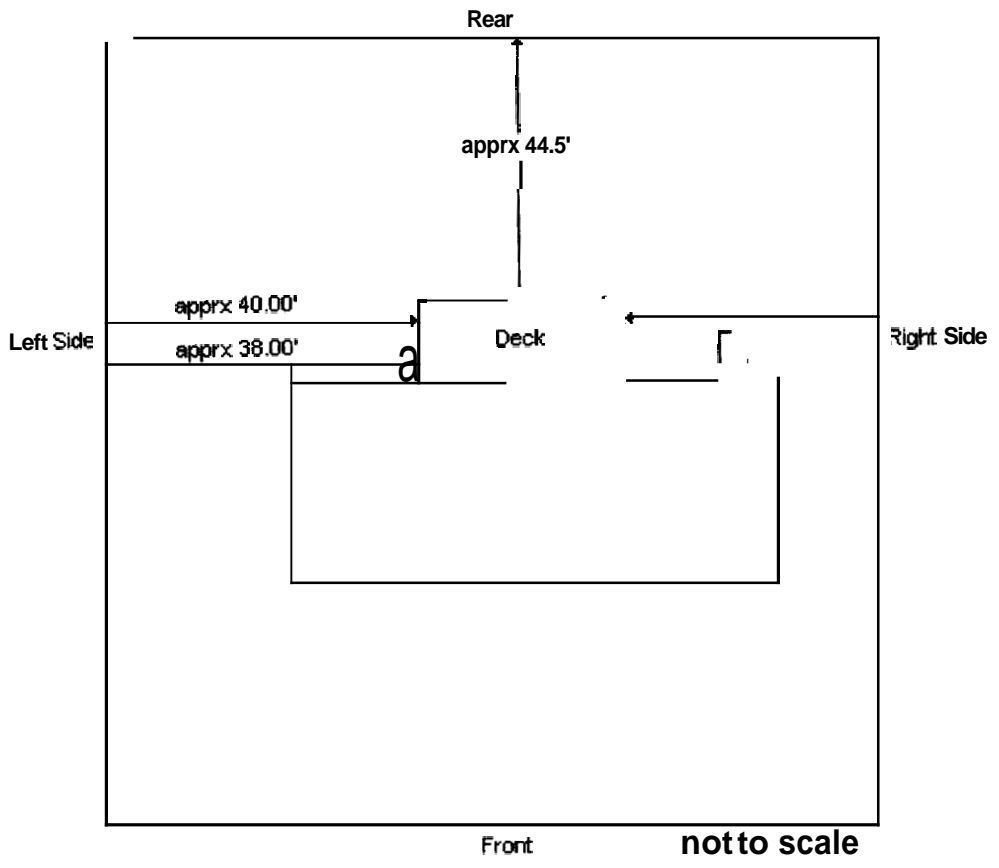
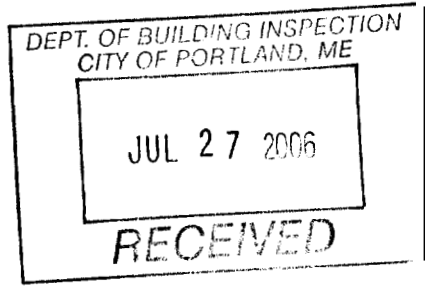

**From:** <Mike.Spugnardi@Dielectric.spx.com>  
**To:** <amachado@portlandmaine.gov>  
**Date:** 7/27/2006 10:30:54 AM  
**Subject:** 29 Alden Circle Proposed Set Backs

Attached is crude sketch of the proposed deck with the setbacks to the property lines on the left, right, and rear sides. These are accurate as I could get as the property lines are not clearly defined in some cases. To the left and rear I measured to the fence line, however on the right, there is no fence so I measured to the line in the grass where my neighbor and I start/stop cutting our lawns.

I hope this helps.

**Thank you, and if you have any other questions, please let me know.**

Michael Spugnardi  
TV Antenna Product Line Manager /  
Senior Electrical Engineer  
Dielectric Communications  
A Unit of SPX Corporation  
Phone: (207) 655-8266  
Fax: (207) 655-8259

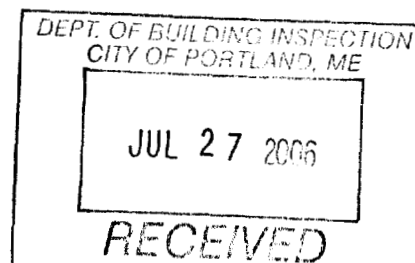

"The information contained in this electronic mail transmission is intended by SPX Corporation for the use of the named individual or entity to which it is directed and may **contain** information that is confidential or privileged. If you have received this electronic mail transmission in error, please delete it from your system without copying **or forwarding** it, and notify the sender of the error by reply **email** so that the sender's address records can be corrected."