

DISPLAY THIS CARD ON PRINCIPAL FRONTAGE OF WORK

CITY OF PORTLAND

DEPARTMENT OF BUILDING INSPECTION

PERMIT

Please Read Application And Notes, If Any, Attached

Permit Number: 051222

PERMIT ISSUED SEP 15 2005 CITY OF PORTLAND

This is to certify that Henson Michael C & /Shed B... has permission to install a 8 x 12 shed w/ ramp AT 84 Alden Cir

182A A02100

provided that the person or persons, firm or corporation accepting this permit shall comply with all of the provisions of the Statutes of Maine and of the ordinances of the City of Portland regulating the construction, maintenance and use of buildings and structures, and of the application on file in this department.

Apply to Public Works for street line and grade if nature of work requires such information.

Notification of inspection must be given and work on permit in progress before this building or part thereof is tenanted or closed-in. HOUR NOTICE IS REQUIRED.

A certificate of occupancy must be procured by owner before this building or part thereof is occupied.

OTHER REQUIRED APPROVALS

Fire Dept. Health Dept. Appeal Board Other DepartmentName

Handwritten signature and date 9/14/05

Director - Building & Inspection Services

PENALTY FOR REMOVING THIS CARD

City of Portland, Maine - Building or Use Permit Application

389 Congress Street, 04101 Tel: (207) 874-8703, Fax: (207) 874-8716

Permit No: 05-1222	Issue Date: SEP 15 2005	CBL: 182A A021001
-----------------------	----------------------------	----------------------

Location of Construction: 84 Alden Cir	Owner Name: Henson Michael C &	Owner Address: 84 Alden Cir	Phone:
Business Name:	Contractor Name: Shed Happens	Contractor Address: 1042 Chadborne Rd, Standish	Phone: 2078923636
Lessee/Buyer's Name	Phone:	Permit Type: Sheds	Zone: R-3

Past Use: Single Family Home	Proposed Use: Single Family Home/ install a 8 x 12 shed w/ ramp	Permit Fee: \$39.00	Cost of Work: \$1,950.00	CEO District: 5
--	---	-------------------------------	------------------------------------	---------------------------

Proposed Project Description: install a 8 x 12 shed w/ ramp	FIRE DEPT: <input type="checkbox"/> Approved <input checked="" type="checkbox"/> Denied Signature: <i>[Signature]</i>	INSPECTION: Use Group: R-3 Type: 5B Signature: <i>[Signature]</i>
---	---	--

Permit Taken By: Idobson	Date Applied For: 08/22/2005	Zoning Approval
------------------------------------	--	------------------------

<ol style="list-style-type: none"> This permit application does not preclude the Applicant(s) from meeting applicable State and Federal Rules. Building permits do not include plumbing, septic or electrical work. Building permits are void if work is not started within six (6) months of the date of issuance. False information may invalidate a building permit and stop all work.. 	Special Zone or Reviews <input type="checkbox"/> Shoreland <input type="checkbox"/> Wetland <input type="checkbox"/> Flood Zone <input type="checkbox"/> Subdivision <input type="checkbox"/> Site Plan Maj <input type="checkbox"/> Minor <input type="checkbox"/> MM <input type="checkbox"/> Date: 9/14/05	Zoning Appeal <input type="checkbox"/> Variance <input type="checkbox"/> Miscellaneous <input type="checkbox"/> Conditional Use <input type="checkbox"/> Interpretation <input type="checkbox"/> Approved <input type="checkbox"/> Denied Date:	Historic Preservation <input checked="" type="checkbox"/> Not in District or Landmark <input type="checkbox"/> Does Not Require Review <input type="checkbox"/> Requires Review <input type="checkbox"/> Approved <input type="checkbox"/> Approved w/Conditions <input type="checkbox"/> Denied Date: 9/14/05
---	---	---	--

CERTIFICATION

I hereby certify that I am the owner of record of the named property, or that the proposed work is authorized by the owner of record and that I have been authorized by the owner to make this application as his authorized agent and I agree to conform to all applicable laws of this jurisdiction. In addition, if a permit for work described in the application is issued, I certify that the code official's authorized representative shall have the authority to enter all areas covered by such permit at any reasonable hour to enforce the provision of the code(s) applicable to such permit.

SIGNATURE OF APPLICANT	ADDRESS	DATE	PHONE
RESPONSIBLE PERSON IN CHARGE OF WORK, TITLE		DATE	PHONE

City of Portland, Maine - Building or Use Permit

389 Congress Street, 04101 Tel: (207) 874-8703, Fax: (207) 874-8716

Permit No: 05-1222	Date Applied For: 08/22/2005	CBL: 182A A021001
-----------------------	---------------------------------	----------------------

Location of Construction: 84 Alden Cir	Owner Name: Henson Michael C &	Owner Address: 84 Alden Cir	Phone:
Business Name:	Contractor Name: Shed Happens	Contractor Address: 1042 Chadbome Rd. Standish	Phone (207) 892-3636
Lessee/Buyer's Name	Phone:	Permit Type: Sheds	

Proposed Use: Single Family Home/ install a 8 x 12 shed w/ ramp	Proposed Project Description: install a 8 x 12 shed w/ ramp
--	--

Dept: Zoning **Status:** Approved with Conditions **Reviewer:** Tammy Munson **Approval Date:** 0911412005

Note: **Ok to Issue:**

1) The shed must be placed a minimum of 5' from the side and rear property lines.

Dept: Building **Status:** Approved **Reviewer:** Tammy Munson **Approval Date:** 09/14/2005

Note: **Ok to Issue:**

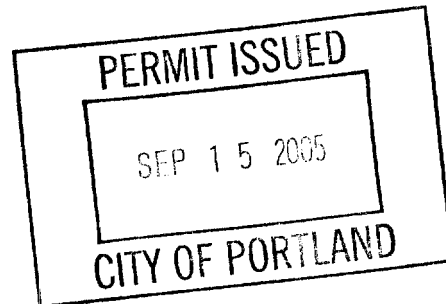



Residential Building Permit Application

If you or the property owner owes real estate or personal property taxes or user charges on any property within the City, payment arrangements must be made before permits of any kind are accepted.

Location/Address of Construction: 84 Alden Cir Portland ME 04102		
Total Square Footage of Proposed Structure 96 SF	Square Footage of Lot 9146 (0.21 acre)	
Tax Assessor's Chart, Block & Lot Chart# Block# Lot# 182 AA 021	Owner: Michael Henson Nicole Harkins	Telephone: 774-7404
Lessee/Buyer's Name (If Applicable)	Applicant name, address & telephone: Nicole Harkins 84 Alden Cir	Cost Of Work: \$ 1,950.00 Fee: \$

Single family home

Proposed Specific use: shed

Project description: 8 x 12 shed w/ ramp

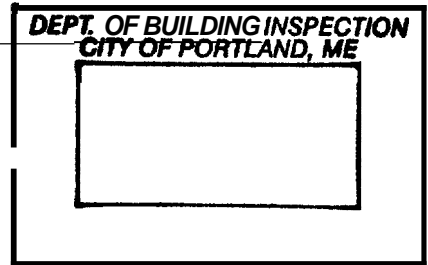

Contractor's name, address & telephone: Shed Happens 892-3636
1042 Chadbourne Rd Standish ME 04084

Who should we contact when the permit is ready: Mike or Nicole Henson Harkins

Phone: 774-7404

Please submit all of the information outlined in the Residential Application Checklist. Failure to do so will result in the automatic denial of your permit.

At the discretion of the Planning and Development Department, additional information may be required prior to permit approval. For further information stop by the Building Inspections office, room 315 City Hall or call 874-8703.

I hereby certify that I am the Owner of record of the named property, or that the owner of record authorizes the proposed work and that I have been authorized by the owner to make this application as his/her authorized agent. I agree to conform to all applicable laws of this jurisdiction. In addition, if a permit for work described in this application is issued, I certify that the Code Official's authorized representative shall have the authority to enter all areas covered by this permit at any reasonable hour to enforce the provisions of the codes applicable to this permit.

Signature of applicant: Nicol Harkins	Date: 8/22/05
---------------------------------------	---------------

Permit Fee: \$30.00 For the first \$1000.00 Construction Cost, \$9.00 per additional \$1000.00 cost

This is not a Permit; you may not commence any work until the Permit is issued.



CITY OF PORTLAND, MAINE
Department of Building Inspections

11/19/05 20 05

Received from Michael Hawkins

Location of Work 84 Alden Cir

Cost of Construction \$ 1,250.00

Permit Fee \$ 20.00

Building (E) Plumbing (I5) Electrical (I2) Site Plan (U2)

Other _____

CBL: 182 AACR1

Check #: 107 Total Collected \$ 29.00

THIS IS NOT A PERMIT

No work is to be started until PERMIT CARD is actually posted upon the premises. Acceptance of fee is no guarantee that permit will be granted. PRESERVE THIS RECEIPT. In case permit cannot be granted the amount of the fee will be refunded upon return of the receipt less \$10.00 or 10% whichever is greater.

WHITE - Applicant's Copy
YELLOW - Office Copy
PINK - Permit Copy

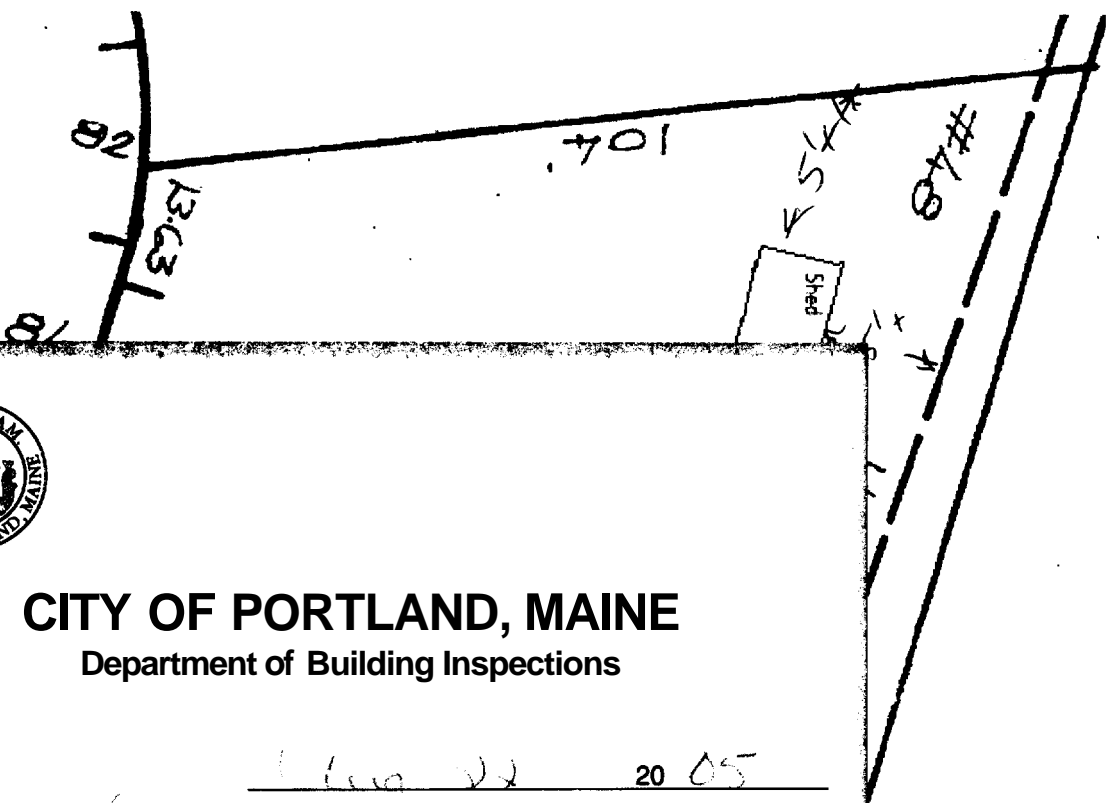

Structurally the Best manufactured Shed Available Guaranteed

Shed Happens,

2005

Phone #892-3636

Inc.

Fax # 892-3622

Mailing Address: 1042 Chadbourne Road Standish, Me 04084
Retail Location: intersection of Rte 302 and 115 North Windham



Gable

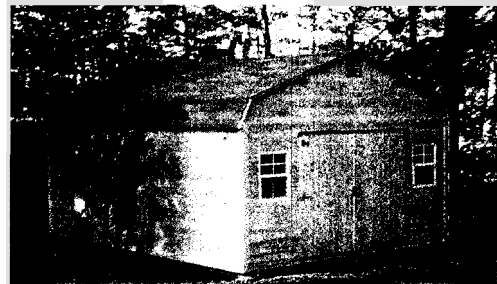

Gambrel

Superior Quality! Comparable Prices! You Decide!

Delivery, setup and leveling are included granted 3 criteria are satisfied
Delivery is within 30 miles of Standish, over 30 miles is \$2 per mile one way
That we can back our 1 ton pickup truck and 18' trailer up to shed site
That the shed site grade is less than 12" from high corner to low corner

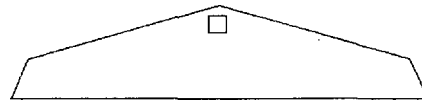

6' x 8'	\$1225	12' x 12'	\$2575	6' x 8'	N/A	12' x 12'	\$2725
6' x 10'	\$1400	12' x 14'	\$2900	6' x 10'	N/A	12' x 14'	\$3050
6' x 12'	\$1575	12' x 16'	\$3100	6' x 12'	N/A	12' x 16'	\$3250
8' x 8'	\$1475	12' x 20'	\$3925	8' x 8'	\$1575	12' x 20'	\$4075
8' x 10'	\$1675	12' x 24'	\$4950	8' x 10'	\$1775	12' x 24'	\$5100
8' x 12'	\$1875	14' x 14'	\$3578	8' x 12'	\$1975	14' x 14'	\$3778
8' x 14'	\$2100	14' x 16'	\$4082	8' x 14'	\$2225	14' x 16'	\$4282
8' x 16'	\$2325	14' x 20'	\$5082	8' x 16'	\$2425	14' x 20'	\$5282
8' x 20'	\$2900	14' x 24'	\$6182	8' x 20'	\$3000	14' x 24'	\$6382
10' x 10'	\$1975			10' x 10'	\$2100		
10' x 12'	\$2225			10' x 12'	\$2350		
10' x 14'	\$2475			10' x 14'	\$2625		
10' x 16'	\$2675			10' x 16'	\$2825		
10' x 20'	\$3475			10' x 20'	\$3600		

Quickest average delivery time in the Industry. Guaranteed!
(Due to delivering completely built sheds) 2 week turnaround
for most orders (excludes custom orders and materials) **SHI** is
the only Shed company that can or will give you a delivery
date at time of order!

www.shedhappens.com