

PERMIT ISSUED

City of Portland, Maine - Building or Use Permit Application
 389 Congress Street, 04101 Tel: (207) 874-8703, Fax: (207) 874-8716

Permit No: 03-1330	Issue Date: OCT 29 2003	CBL: 182A A018001
-----------------------	-----------------------------------	----------------------

Location of Construction: 70 Alden Cir	Owner Name: Loranger Francis &	Owner Address: 70 Alden Cir CITY OF PORTLAND	Phone: 799-9058
Business Name:	Contractor Name: Jack of All Trades	Contractor Address: 41 Cleveland Circle South Portland	Phone: 2079397430
Lessee/Buyer's Name:	Phone:	Permit Type: Additions - Dwellings	Zone: R3

Past Use: Single Family	Proposed Use: Single Family w/rear porch	Permit Fee: \$39.00	Cost of Work: \$1,500.00	CEO District: 3
Proposed Project Description: Build an 8x8 rear porch		FIRE DEPT: <input type="checkbox"/> Approved <input type="checkbox"/> Denied		INSPECTION: Use Group: R3 Type: 5B BOCA 1999
		Signature: _____		Signature: JMB 10/29/03
PEDESTRIAN ACTIVITIES DISTRICT (P.A.D.)				
Action: <input type="checkbox"/> Approved <input type="checkbox"/> Approved w/Conditions <input type="checkbox"/> Denied				
Signature: _____ Date: _____				

Permit Taken By: jmb	Date Applied For: 10/29/2003	Zoning Approval
-------------------------	---------------------------------	------------------------

<ol style="list-style-type: none"> 1. This permit application does not preclude the Applicant(s) from meeting applicable State and Federal Rules. 2. Building permits do not include plumbing, septic or electrical work. 3. Building permits are void if work is not started within six (6) months of the date of issuance. False information may invalidate a building permit and stop all work.. 	Special Zone or Reviews <input type="checkbox"/> Shoreland <input type="checkbox"/> Wetland <input type="checkbox"/> Flood Zone <input type="checkbox"/> Subdivision <input type="checkbox"/> Site Plan Maj <input type="checkbox"/> Minor <input type="checkbox"/> MM <input type="checkbox"/> Date: JMB 10/29/03	Zoning Appeal <input type="checkbox"/> Variance <input type="checkbox"/> Miscellaneous <input type="checkbox"/> Conditional Use <input type="checkbox"/> Interpretation <input type="checkbox"/> Approved <input type="checkbox"/> Denied Date: _____	Historic Preservation <input checked="" type="checkbox"/> Not in District or Landmark <input type="checkbox"/> Does Not Require Review <input type="checkbox"/> Requires Review <input type="checkbox"/> Approved <input type="checkbox"/> Approved w/Conditions <input type="checkbox"/> Denied Date: JMB
--	---	---	---

CERTIFICATION

I hereby certify that I am the owner of record of the named property, or that the proposed work is authorized by the owner of record and that I have been authorized by the owner to make this application as his authorized agent and I agree to conform to all applicable laws of this jurisdiction. In addition, if a permit for work described in the application is issued, I certify that the code official's authorized representative shall have the authority to enter all areas covered by such permit at any reasonable hour to enforce the provision of the code(s) applicable to such permit.

SIGNATURE OF APPLICANT	ADDRESS	DATE	PHONE
RESPONSIBLE PERSON IN CHARGE OF WORK, TITLE		DATE	PHONE

City of Portland, Maine - Building or Use Permit

389 Congress Street, 04101 Tel: (207) 874-8703, Fax: (207) 874-8716

Permit No: 03-1330	Date Applied For: 10/29/2003	CBL: 182A A018001
------------------------------	--	-----------------------------

Location of Construction: 70 Alden Cir	Owner Name: Loranger Francis &	Owner Address: 70 Alden Cir	Phone: () 799-9058
Business Name:	Contractor Name:	Contractor Address:	Phone:
Lessee/Buyer's Name	Phone:	Permit Type: Additions - Dwellings	

Proposed Use: Single Family w/rear porch	Proposed Project Description: Build an 8x8 rear porch
--	---

Dept: Zoning	Status: Approved	Reviewer: Jeanine Bourke	Approval Date: 10/29/2003
Note:			Ok to Issue: <input checked="" type="checkbox"/>
1) It is the responsibility of the property owner to establish the property lines for setback requirement. This line must be strung at the footing inspection for verification and approval to continue.			
2) This permit is being approved on the basis of plans submitted. Any deviations shall require a separate approval before starting that work.			

Dept: Building	Status: Approved	Reviewer: Jeanine Bourke	Approval Date: 10/29/2003
Note:			Ok to Issue: <input type="checkbox"/>

All Purpose Building Permit Application

If you or the property owner owes real estate or personal property taxes or user charges on any property within the City, payment arrangements must be made before permits of any kind are accepted.

Location/Address of Construction: 70 ALDEN CIRCLE		
Total Square Footage of Proposed Structure 64	Square Footage of Lot 2500 4-8,150	
Tax Assessor's Chart, Block & Lot Chart# 182 Block# AA Lot# 18	Owner: FRAN/NANCY CORANEN	Telephone: 774 6960
Lessee/Buyer's Name (if Applicable)	Applicant name, address & telephone: ARME HOFFMAN 939 7430	Cost Of Work: \$ 1500 Fee: \$ 39.00
Current use: _____		
If the location is currently vacant, what was prior use: _____		
Approximately how long has it been vacant: _____		
Proposed use: _____		
Project description: BUILD AN 8'8" DECK TO REPLACE SMALL PORCH LANDING		
Contractor's name, address & telephone: JACK OF ALL TRADES 41 CEDERLAND CIR ST		
Who should we contact when the permit is ready: _____		
Mailing address: _____		
We will contact you by phone when the permit is ready. You must come in and pick up the permit and review the requirements before starting any work, with a Plan Reviewer. A stop work order will be issued and a \$100.00 fee if any work starts before the permit is picked up. PHONE: _____		

IF THE REQUIRED INFORMATION IS NOT INCLUDED IN THE SUBMISSIONS THE PERMIT WILL BE AUTOMATICALLY DENIED AT THE DISCRETION OF THE BUILDING/PLANNING DEPARTMENT, WE MAY REQUIRE ADDITIONAL INFORMATION IN ORDER TO APPROVE THIS PERMIT.

I hereby certify that I am the Owner of record of the named property, or that the owner of record authorizes the proposed work and that I have been authorized by the owner to make this application as his/her authorized agent. I agree to conform to all applicable laws of this jurisdiction. In addition, if a permit for work described in this application is issued, I certify that the Code Official's authorized representative shall have the authority to enter all areas covered by this permit at any reasonable hour to enforce the provisions of the codes applicable to this permit.

Signature of applicant: 	Date: 10/29/03
---	-----------------------

This is NOT a permit, you may not commence ANY work until the permit is issued.
If you are in a Historic District you may be subject to additional permitting and fees with the Planning Department on the 4th floor of City Hall

This page contains a detailed description of the Parcel ID you selected. Press the **New Search** button at the bottom of the screen to submit a new query.

Current Owner Information

Card Number 1 of 1
Parcel ID 182A A018001
Location 70 ALDEN CIR
Land Use SINGLE FAMILY

Owner Address LORANGER FRANCIS & NANCY DEANE-LORANGER JTS
70 ALDEN CIR
PORTLAND ME 04102

Book/Page 14119/152
Legal 182A-A-18
ALDEN CIR 66-72
8150 SF

Valuation Information

Land #34,020 **Building** #113,300 **Total** #147,320

Property Information

Year Built 1960	Style Garrison	Story Height 2	Sq. Ft. 1953	Total Acres 0.187	
Bedrooms 4	Full Baths 1	Half Baths 1	Total Rooms 8	Attic None	Basement Full

Outbuildings

Type	Quantity	Year Built	Size	Grade	Condition
-------------	-----------------	-------------------	-------------	--------------	------------------

Sales Information

Date	Type	Price	Book/Page
-------------	-------------	--------------	------------------

Picture and Sketch

[Picture](#) [Sketch](#)

[Click here](#) to view Tax Roll Information.

Any information concerning tax payments should be directed to the Treasury office at 874-8490 or e-mailed.



830 10/29
Arnie
#1330
K3
Paul 6
Zone X

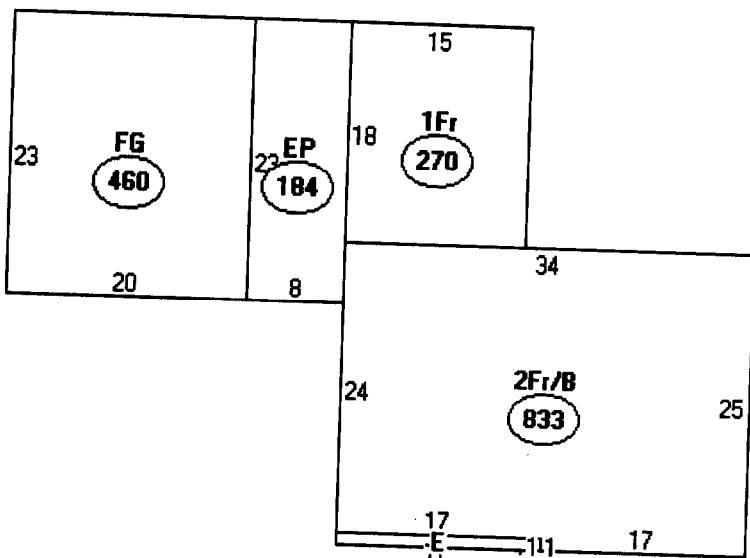

Descriptor/Area

- A: 2Fr/B
833 sqft
- B: EP
184 sqft
- C: FG
460 sqft
- D: 1Fr
270 sqft
- E: FOH
17 sqft

1,764
64 deck

828

OK

8,150 SF
x 25%

2,037

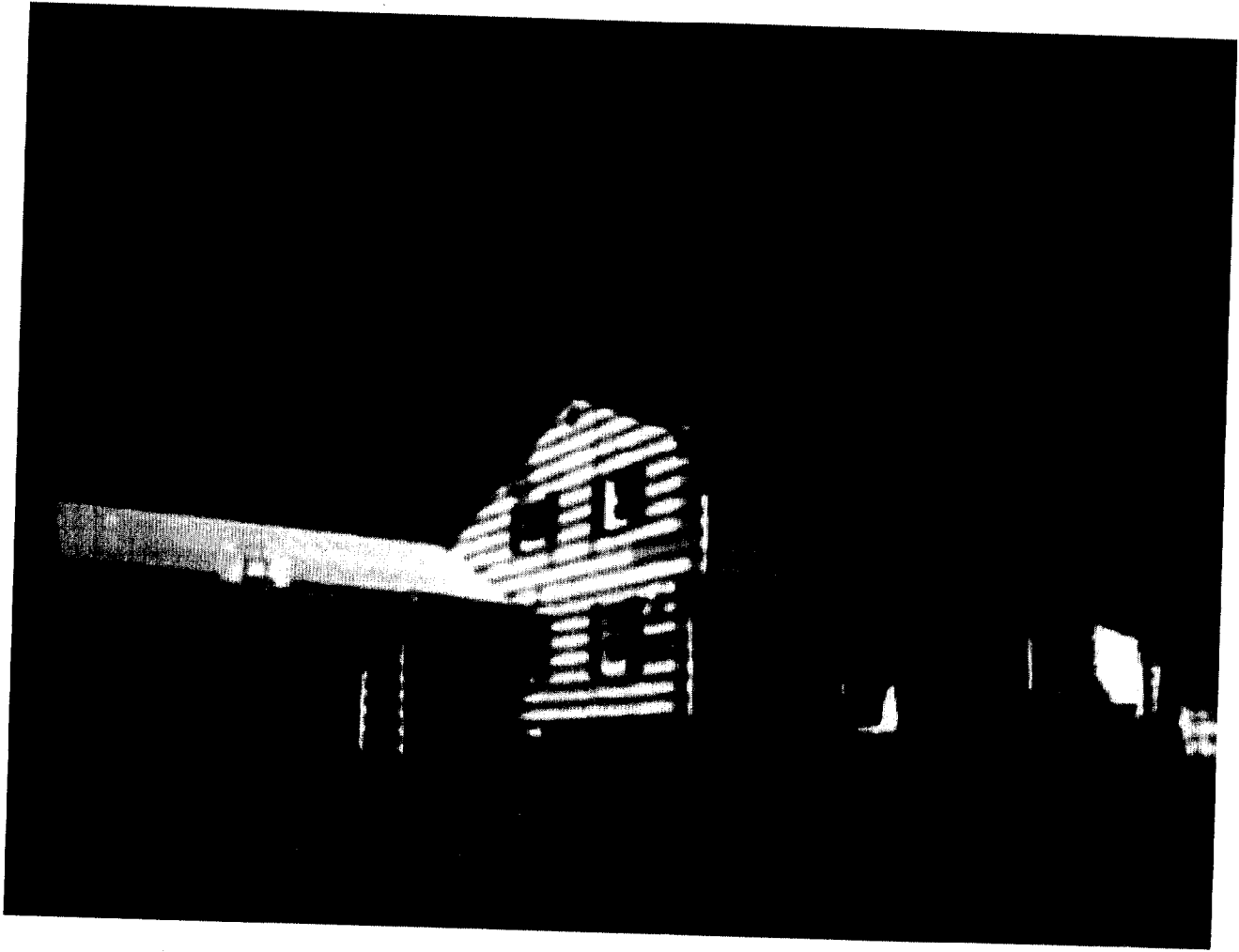

R3 Zone
 Rear 25' Req 25' shown
 Side 8' Req 34' shown

8" SONOTUBES
 2XB FRAMING
 COMPOSITE DECKING

FRAN'S NANA LORANGER
 70 AIDEN CIRCLE
 PORTLAND ME 04102

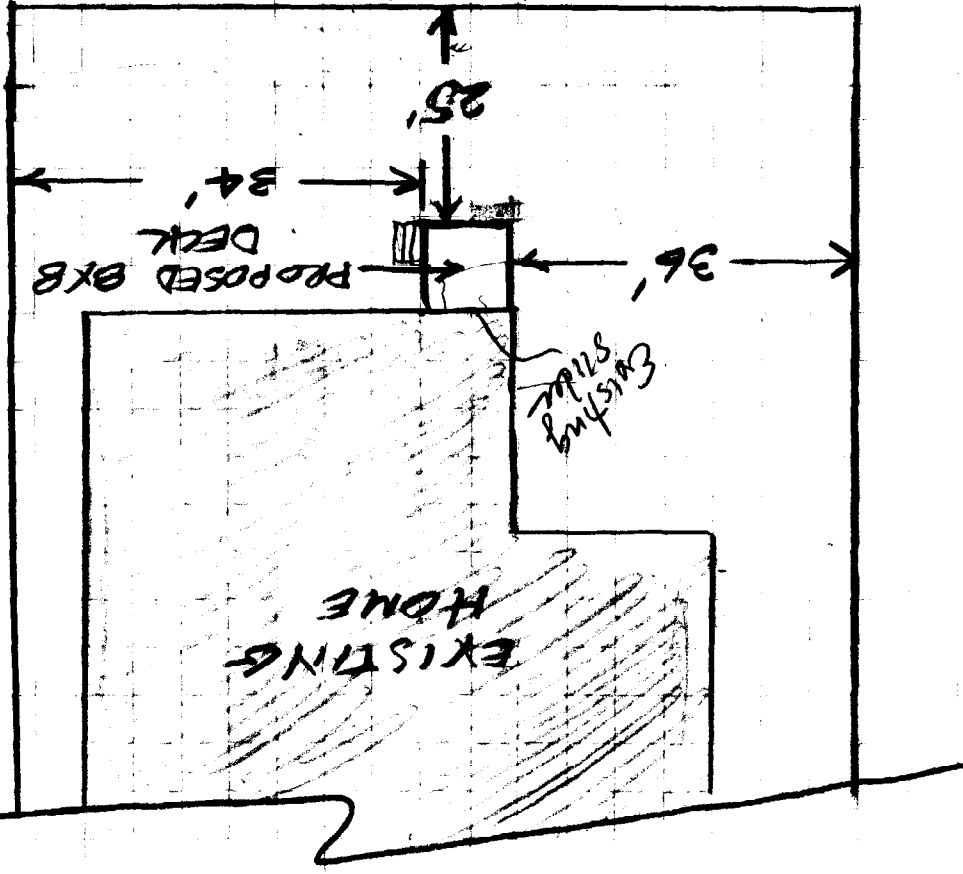

WOODEN DECK

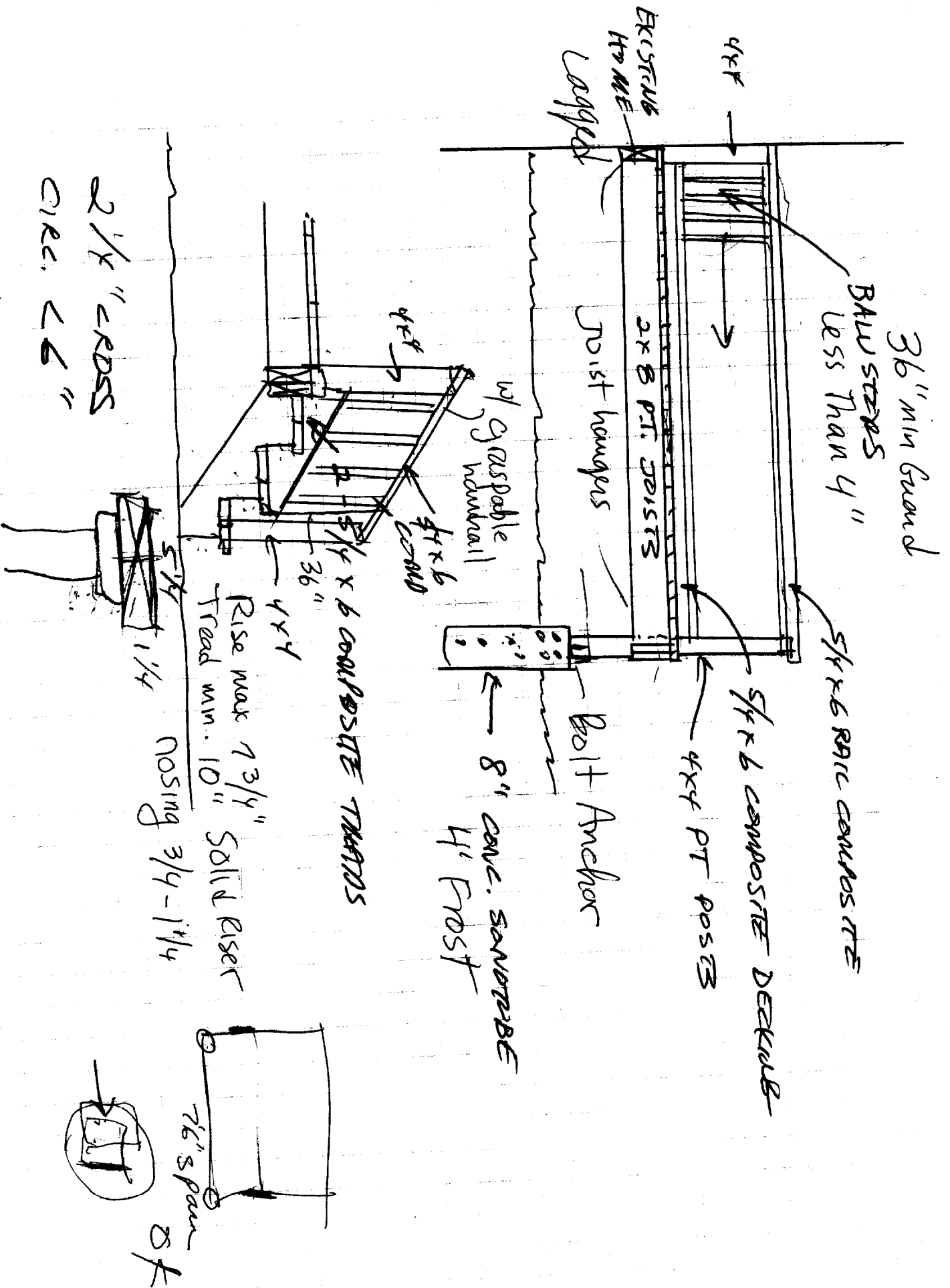

DISPLAY THIS CARD ON PRINCIPAL FRONTAGE OF WORK

CITY OF PORTLAND PERMIT ISSUED

BUILDING DEPARTMENT

PERMIT

Permit Number: 001330
OCT 29 2003

Please Read Application And Notes, If Any, Attached

This is to certify that Loranger Francis &/Jack of Trades
has permission to Build an 8x8 rear porch
AT 70 Alden Cir 182A A018001
CITY OF PORTLAND

provided that the person or persons, firm or corporation accepting this permit shall comply with all of the provisions of the Statutes of Maine and of the ordinances of the City of Portland regulating the construction, maintenance and use of buildings and structures, and of the application on file in this department.

Apply to Public Works for street line and grade if nature of work requires such information.

Notification of inspection must be given and written permission procured before this building or part thereof is leased or otherwise closed-in. **HEAR NOTICE IS REQUIRED.**

A certificate of occupancy must be procured by owner before this building or part thereof is occupied.

PERMIT ISSUED
Fire Dept. _____
Health Dept. OCT 29 2003
Appeal Board _____
Other _____
CITY OF PORTLAND

Jamie Bonke 10/29/03
Director Building & Inspection Services

PENALTY FOR REMOVING THIS CARD

BUILDING PERMIT INSPECTION PROCEDURES

Please call 874-8703 or ~~874-8693~~ to schedule your inspections as agreed upon

Permits expire in 6 months, if the project is not started or ceases for 6 months.

The Owner or their designee is required to notify the inspections office for the following inspections and provide adequate notice. Notice must be called in 48-72 hours in advance in order to schedule an inspection:

By initialzing at each inspection time, you are agreeing that you understand the inspection procedure and additional fees from a "Stop Work Order" and "Stop Work Order Release" will be incurred if the procedure is not followed as stated below.

JB Pre-construction Meeting: Must be scheduled with your inspection team upon receipt of this permit. Jay Reynolds, Development Review Coordinator at 874-8692 ~~must~~ also be contacted at this time, before any site work begins on any project other than single family additions or alterations.

- | | |
|--|---|
| <input checked="" type="checkbox"/> <u>Footing/Building Location Inspection:</u> | Prior to pouring concrete |
| <input type="checkbox"/> <u>Re-Bar Schedule Inspection:</u> | Prior to pouring concrete |
| <input type="checkbox"/> <u>Foundation Inspection:</u> | Prior to placing ANY backfill |
| <input type="checkbox"/> <u>Framing/Rough Plumbing/Electrical:</u> | Prior to any insulating or drywalling |
| <input checked="" type="checkbox"/> <u>Final/Certificate of Occupancy:</u> | Prior to any occupancy of the structure or use. NOTE: There is a \$75.00 fee per inspection at this point. |

Certificate of Occupancy is not required for certain projects. Your inspector can advise you if your project requires a Certificate of Occupancy. All projects DO require a final inspection

If any of the inspections do not occur, the project cannot go on to the next phase, REGARDLESS OF THE NOTICE OR CIRCUMSTANCES.

NA **CERIFICATE OF OCCUPANICES MUST BE ISSUED AND PAID FOR, BEFORE THE SPACE MAY BE OCCUPIED**

Signature of applicant/designee

Signature of Inspections Official

Date

Date

CBL: 182AA

Building Permit #: 03-1330