

PERMIT ISSUED

City of Portland, Maine - Building or Use Permit Application

389 Congress Street, 04101 Tel: (207) 874-8703, Fax: (207) 874-8716

Permit No: 03-0431	Issue Date: MAY 02 2003	CBL: 182 E003001
-----------------------	----------------------------	---------------------

Location of Construction: 20 Woodfield Rd	Owner Name: Turcotte Leonard W &	Owner Address: 20 Woodfield Rd CITY OF PORTLAND	Phone:
Business Name:	Contractor Name: Davis Woodworking	Contractor Address: 971 Brighton Avenue Portland	Phone: 2077742045
Lessee/Buyer's Name	Phone:	Permit Type: Sheds	Zone:

Past Use: single family	Proposed Use: single family - build 8' x 12' shed	Permit Fee: \$37.00	Cost of Work: \$1,570.00	CEO District: 3
----------------------------	--	------------------------	-----------------------------	--------------------

FIRE DEPT: <input type="checkbox"/> Approved <input checked="" type="checkbox"/> Denied N/A	INSPECTION: Use Group: U Type: 5B BOCA 99
Signature:	Signature:

Proposed Project Description:
build 8' x 12' shed

PEDESTRIAN ACTIVITIES DISTRICT (P.A.D.)		
Action:	<input type="checkbox"/> Approved	<input type="checkbox"/> Approved w/Conditions
Signature:	Date:	

Permit Taken By: gg	Date Applied For: 05/02/2003	Zoning Approval	
------------------------	---------------------------------	------------------------	--

- This permit application does not preclude the Applicant(s) from meeting applicable State and Federal Rules.
- Building permits do not include plumbing, septic or electrical work.
- Building permits are void if work is not started within six (6) months of the date of issuance. False information may invalidate a building permit and stop all work..

Special Zone or Reviews <input type="checkbox"/> Shoreland <input type="checkbox"/> Wetland <input checked="" type="checkbox"/> Flood Zone <input type="checkbox"/> Subdivision <input type="checkbox"/> Site Plan Maj <input type="checkbox"/> Minor <input type="checkbox"/> MM <input type="checkbox"/> Date: 5/2/03	Zoning Appeal <input type="checkbox"/> Variance <input type="checkbox"/> Miscellaneous <input type="checkbox"/> Conditional Use <input type="checkbox"/> Interpretation <input type="checkbox"/> Approved <input type="checkbox"/> Denied Date:	Historic Preservation <input checked="" type="checkbox"/> Not in District or Landmark <input type="checkbox"/> Does Not Require Review <input type="checkbox"/> Requires Review <input type="checkbox"/> Approved <input type="checkbox"/> Approved w/Conditions <input type="checkbox"/> Denied Date: 5/2/03
---	---	---

CERTIFICATION

I hereby certify that I am the owner of record of the named property, or that the proposed work is authorized by the owner of record and that I have been authorized by the owner to make this application as his authorized agent and I agree to conform to all applicable laws of this jurisdiction. In addition, if a permit for work described in the application is issued, I certify that the code official's authorized representative shall have the authority to enter all areas covered by such permit at any reasonable hour to enforce the provision of the code(s) applicable to such permit.

SIGNATURE OF APPLICANT ADDRESS DATE PHONE

RESPONSIBLE PERSON IN CHARGE OF WORK, TITLE DATE PHONE



Residential Building Permit Application

If you or the property owner owes real estate or personal property taxes or user charges on any property within the City, payment arrangements must be made before permits of any kind are accepted.

Location/ Address of Construction:		
Total Square Footage of Proposed Structure <i>98'</i>	Square Footage of Lot <i>10,000 sq feet</i>	
Tax Assessor's Chart, Block & Lot Chart# <i>182</i> Block# <i>E</i> Lot# <i>003</i>	Owner: <i>TURCOTTE, LEONARD W & SUSAN E.</i>	Telephone:
Lessee/ Buyer's Name (If Applicable)	Applicant name, address & telephone:	Cost Of Work: \$ <i>1570</i> Fee: \$ <i>37</i>
Current Specific use: <u><i>STORAGE</i></u>		
Proposed Specific use: <u><i>STORAGE</i></u>		
Project description: <i>8 X 12 STORAGE SHED. TOTAL COST FOR MATERIALS, LABOR, AND TAXES @ \$1,570.00.</i>		
Contractor's name, address & telephone: <i>DAVIS WOODWORKING INC., 971 BRIGHTON AVE. PORTLAND, ME (207-774-2045)</i>		
Who should we contact when the permit is ready: _____		
Mailing address:		
Phone:		

Please submit all of the information outlined in the Residential Application Checklist. Failure to do so will result in the automatic denial of your permit.

At the discretion of the Planning and Development Department, additional information may be required prior to permit approval. For further information stop by the Building Inspections office, room 315 City Hall or call 874-8703.

I hereby certify that I am the Owner of record of the named property, or that the owner of record authorizes the proposed work and that I have been authorized by the owner to make this application as his/her authorized agent. I agree to conform to all applicable laws of this jurisdiction. In addition, if a permit for work described in this application is issued, I certify that the Code Official's authorized representative shall have the authority to enter all areas covered by this permit at any reasonable hour to enforce the provisions of the codes applicable to this permit.

Signature of applicant: <i>Leonard W Turcotte</i>	Date: <i>2 May 2003</i>
---	-------------------------

Permit Fee: \$30.00 for the first \$1000.00 Construction Cost, \$7.00 per additional \$1000.00 cost

This is not a Permit; you may not commence any work until the Permit is issued.

DISPLAY THIS CARD ON PRINCIPAL FRONTAGE OF WORK CITY OF PORTLAND

Please Read
Application And
Notes, If Any,
Attached

BUILDING INSPECTION PERMIT

Permit Number: 030431

This is to certify that Turcotte Leonard W &/David Woodworking
has permission to build 8' x 12' shed
AT 20 Woodfield Rd L 182 E003001

provided that the person or persons in charge of the work in accepting this permit shall comply with all of the provisions of the Statutes of the State and of the Ordinances of the City of Portland regulating the construction, maintenance and use of buildings and structures, and of the application on file in this department.

Apply to Public Works for street line and grade if nature of work requires such information.

Classification of inspection must be given and when permission is procured before this building or part thereof is occupied or otherwise closed-in. 4 HOUR NOT REQUIRED.

A certificate of occupancy must be procured by owner before this building or part thereof is occupied.

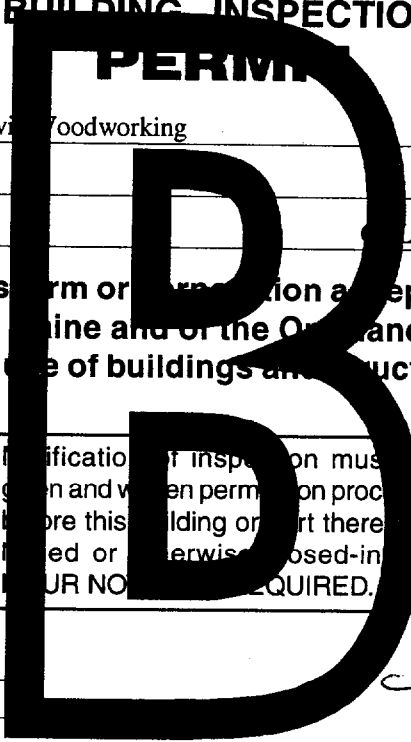

OTHER REQUIRED APPROVALS

Fire Dept. **PERMIT ISSUED**
Health Dept. _____
Appeal Board **MAY 02 2003**
Other _____
Department Name

[Signature]
Director - Building & Inspection Services

CITY OF PORTLAND

PENALTY FOR REMOVING THIS CARD

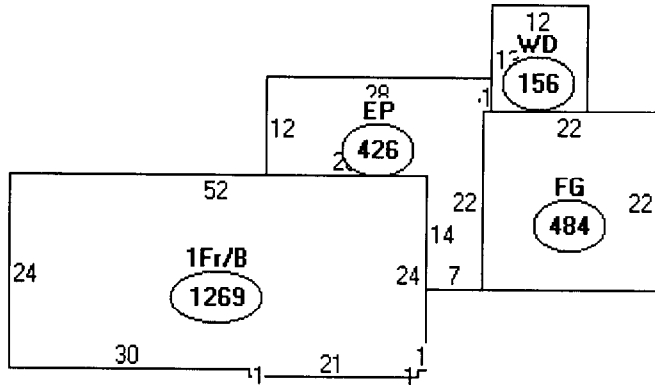

Descriptor/Area

- A: 1Fr/B
1269 sqft
- B: EP
426 sqft
- C: FG
484 sqft
- D: WD
156 sqft

2335 SF currently

Lot cov - 2500

165 SF
Left allowable
lot cov.

R-3

10,000 SF

182-E-3

20 woodfield

8' x 12' --- 96 SF

165
69 SF left

OK

*P-3
11'5" from
property line*

Pin

Pin

Property Line

5 FEET FROM PROPERTY LINE

15 FEET 5 INCHES FROM PROPERTY LINE TO SHED

8 X 12 SHED

11 FEET FROM SHED TO BACK OF GARAGE

2 FEET 6 INCHES FROM SHED TO DECK

Deck
12 X 12
Existing
Structure

Enclosed Porch
Existing Structure

P
R
O
P
E
R
T
Y
L
I
N
E

B
A
C
K
O
F
G
A
R
A
G
E

Rear

Front

Total cost of structure to include materials, labor and applicable taxes is approximately \$1,570.00

Davis Woodworking Inc
971 Brighton Avenue
Portland, Maine

Telephone: 207-774-2045
Owner: Glenn Davis

No electrical or plumbing. Shed is for storage use only.

PROPERTY LINE SHED IS 100 FEET PLUS AWAY FROM THIS LINE

*Plot marked by
Davis Woodworking Inc*

Handwritten initials/signature in the top right corner.

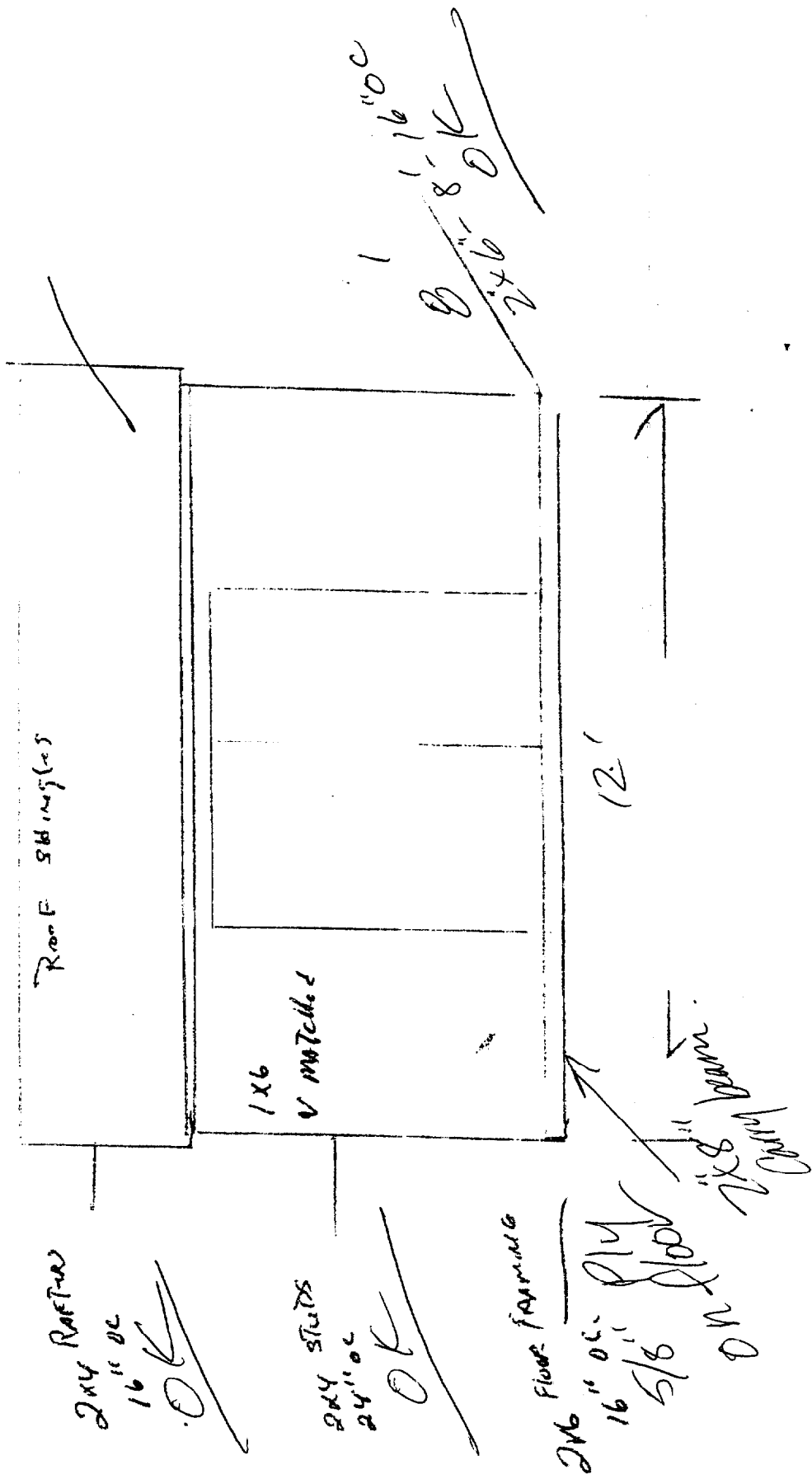

ROOF SIDING

1x6 V MATCHED

2x4 RAFTERS
16" OC
OK

2x4 STUDS
24" OC
OK

2x6 FLOOR FRAMING
16" OC
5/8" PLY
OK

2x8 beam

2x6 8'-0" 16" OC
OK

12'

BUILDING PERMIT INSPECTION PROCEDURES

Please call 874-8703 or 874-8693 to schedule your inspections as agreed upon

Permits expire in 6 months, if the project is not started or ceases for 6 months.

The Owner or their designee is required to notify the inspections office for the following inspections and provide adequate notice. Notice must be called in 48-72 hours in advance in order to schedule an inspection:

By initializing at each inspection time, you are agreeing that you understand the inspection procedure and additional fees from a "Stop Work Order" and "Stop Work Order Release" will be incurred if the procedure is not followed as stated below.

_____ **Pre-construction Meeting:** Must be scheduled with your inspection team upon receipt of this permit. Jay Reynolds, Development Review Coordinator at 874-8632 must also be contacted at this time, before any site work begins on any project other than single family additions or alterations.

Footing/Building Location Inspection: Prior to pouring concrete

_____ **Re-Bar Schedule Inspection:** Prior to pouring concrete

_____ **Foundation Inspection:** Prior to placing ANY backfill

Framing/Rough Plumbing/Electrical: Prior to any insulating or drywalling

Final/Certificate of Occupancy: Prior to any occupancy of the structure or use. NOTE: There is a \$75.00 fee per inspection at this point.

Certificate of Occupancy is not required for certain projects. Your inspector can advise you if your project requires a Certificate of Occupancy. All projects DO require a final inspection

_____ **If any of the inspections do not occur, the project cannot go on to the next phase, REGARDLESS OF THE NOTICE OR CIRCUMSTANCES.**

_____ **CERIFICATE OF OCCUPANICES MUST BE ISSUED AND PAID FOR, BEFORE THE SPACE MAY BE OCCUPIED**

Donald Timothy
Signature of applicant/designee

Date

[Signature]
Signature of Inspections Official

Date

CBL: 182-E-3 Building Permit #: 03-431