

DISPLAY THIS CARD ON PRINCIPAL FRONTAGE OF WORK

CITY OF PORTLAND

Please Read Application And Notes, If Any, Attached

BUILDING DEPARTMENT

PERMIT

Permit Number: 041744

DEC 09 2004

This is to certify that Files Peter C & /Sheds, U.S.A.

has permission to 6x8 shed on cinder blocks

AT 136 Woodfield Rd

182 C002001

CITY OF PORTLAND

provided that the person or persons, firm or corporation accepting this permit shall comply with all of the provisions of the Statutes of Maine and of the ordinances of the City of Portland regulating the construction, maintenance and use of buildings and structures, and of the application on file in this department.

Apply to Public Works for street line and grade if nature of work requires such information.

Notification of inspection must be given and written permission procured before this building or part thereof is altered or closed-in. 24 HOUR NOTICE IS REQUIRED.

A certificate of occupancy must be procured by owner before this building or part thereof is occupied.

OTHER REQUIRED APPROVALS

Fire Dept. _____

Health Dept. _____

Appeal Board _____

Other _____

Department Name

Jeannie Bonke 12/8/04
Director / Building & Inspection Services

PENALTY FOR REMOVING THIS CARD

City of Portland, Maine - Building or Use Permit Application

389 Congress Street, 04101 Tel: (207) 874-8703, Fax: (207) 874-8716

Permit No: 04-1744	Issue Date:	CBL: 182 C002001
-----------------------	-------------	---------------------

Location of Construction: 136 Woodfield Rd	Owner Name: Files Peter C &	Owner Address: 136 Woodfield Rd	Phone:
Business Name:	Contractor Name: Sheds, U.S.A.	Contractor Address: P.O.Box 6622 Portsmouth	Phone: 603 681300
Lessee/Buyer's Name	Phone:	Permit Type: Alterations - Dwellings	Zone: R3
Past Use: Single Family	Proposed Use: Single family shed	Permit Fee: \$39.00	Cost of Work: \$1,437.00
Proposed Project Description: 6x8 shed on cinder blocks		CEO District: 5	
		FIRE DEPT: <input type="checkbox"/> Approved <input type="checkbox"/> Denied INSPECTION: Use Group: R3 Type:	
		Signature	Signature: JMB 12/8/04
PEDESTRIAN ACTIVITIES DISTRICT (P.A.D.)			
Action: <input type="checkbox"/> Approved <input type="checkbox"/> Approved w/Conditions <input type="checkbox"/> Denied			
		Signature:	Date:

Permit Taken By: dmartin	Date Applied For: 11/24/2004	Zoning Approval
-----------------------------	---------------------------------	------------------------

1. This permit application does not preclude the Applicant(s) from meeting applicable State and Federal Rules. 2. Building permits do not include plumbing, septic or electrical work. 3. Building permits are void if work is not started within six (6) months of the date of issuance. False information may invalidate a building permit and stop all work..	Special Zone or Reviews <input type="checkbox"/> Shoreland <input type="checkbox"/> Wetland <input type="checkbox"/> Flood Zone <input type="checkbox"/> Subdivision <input type="checkbox"/> Site Plan Maj <input type="checkbox"/> Minor <input type="checkbox"/> MM <input type="checkbox"/> Date: JMB 12/8/04	Zoning Appeal <input type="checkbox"/> Variance <input type="checkbox"/> Miscellaneous <input type="checkbox"/> Conditional Use <input type="checkbox"/> Interpretation <input type="checkbox"/> Approved <input type="checkbox"/> Denied Date:	Historic Preservation <input checked="" type="checkbox"/> Not in District or Landmark <input type="checkbox"/> Does Not Require Review <input type="checkbox"/> Requires Review <input type="checkbox"/> Approved <input type="checkbox"/> Approved w/Conditions <input type="checkbox"/> Denied Date: JMB
--	---	---	--

CERTIFICATION

I hereby certify that I am the owner of record of the named property, or that the proposed work is authorized by the owner of record and that I have been authorized by the owner to make this application as his authorized agent and I agree to conform to all applicable laws of this jurisdiction. In addition, if a permit for work described in the application is issued, I certify that the code official's authorized representative shall have the authority to enter **all** areas covered by such permit at any reasonable hour to enforce the provision of the code(s) applicable to such permit.

SIGNATURE OF APPLICANT	ADDRESS	DATE	PHONE
RESPONSIBLE PERSON IN CHARGE OF WORK, TITLE		DATE	PHONE



Residential Building Permit Application

If you or the property owner owes real estate or personal property taxes or user charges on any property within the City, payment arrangements must be made before permits of any kind are accepted.

Location/Address of Construction: <u>136 Woodfield Rd, Portland ME 04102</u>		
Total Square Footage of Proposed Structure <u>48 sq ft</u>	Square Footage of Lot <u>100' x 100'</u>	
Tax Assessor's Chart, Block & Lot Chart# <u>182</u> Block# <u>C</u> Lot# <u>002</u>	Owner: <u>Peter C Files, Sharon M Files</u>	Telephone: <u>207 253 5774</u>
Lessee/Buyer's Name (If Applicable)	Applicant name, address & telephone: <u>136 Woodfield Rd Portland, ME 04102</u>	cost Of Work: \$ <u>1437.00</u> Fee: \$ <u>39.00</u>
Current Specific use: <u>none Single Family</u>		
Proposed Specific use: <u>Temporary shed</u>		
Project description: <u>install a 6' x 8' storage shed to be built on cinder blocks.</u>		
Contractor's name, address & telephone: <u>Sheds USA</u>		
Who should we contact when the permit is ready: <u>Peter Files</u>		
Mailing address: <u>Above</u>		
Phone: <u>939-9046</u>		

Please submit all of the information outlined in the Residential Application Checklist. Failure to do so will result in the automatic denial of your permit.

At the discretion of the Planning and Development Department, additional information may be required prior to permit approval. For further information stop by the Building Inspections office, room 315 City Hall or call 874-8703.

I hereby certify that I am the Owner of record of the named property, or that the owner of record authorizes the proposed work and that I have been authorized by the owner to make this application as his/her authorized agent. I agree to conform to all applicable laws of this jurisdiction. In addition, if a permit for work described in this application is issued, I certify that the Code Official's authorized representative shall have the authority to enter all areas covered by this permit at any reasonable hour to enforce the provisions of the codes applicable to this permit.

Signature of applicant: <u>Peter C Files</u>	Date: <u>11/19/04</u>
--	-----------------------

Permit Fee: \$30.00 for the first \$1000.00 Construction Cost, \$9.00 per additional \$1000.00 cost

This is not a Permit; you may not commence any work until the Permit is issued.

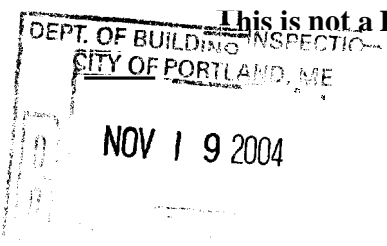

THIS IS NOT A BOUNDARY SURVEY

MORTGAGE INSPECTION OF DEED BOOK 8957 PAGE 223 COUNTY Cumberland
 PLAN BOOK 58 PAGE 9 LOT 94

ADDRESS: 136 Woodfield Road, Portland, Maine

Job Number: 458-54

Inspection Date: 2-24-04

Buyers: Peter C. Files, Sharon Files & Cynthia Weitz

Scale: =

Sellers: Richard F & Virginia B Charron

Client File#: T 7058

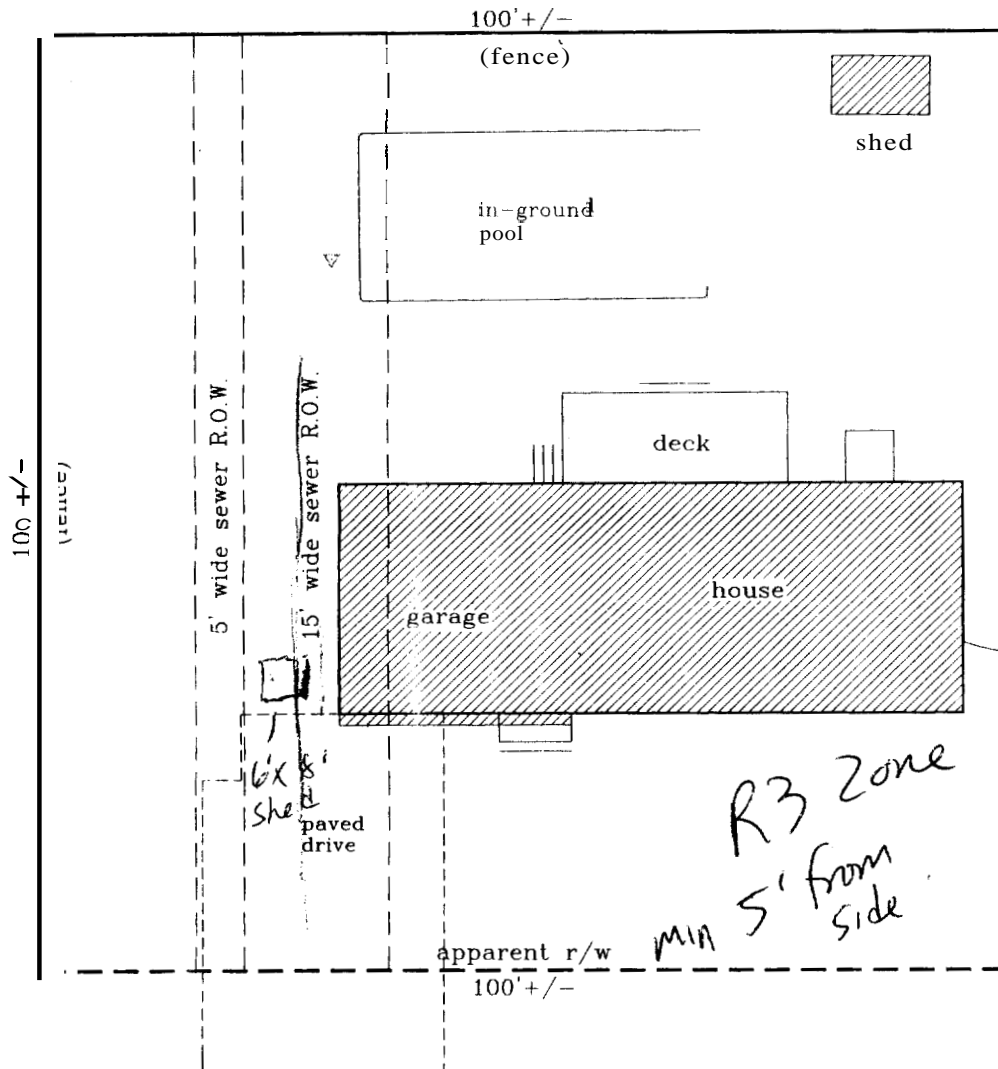

DEPT. OF CHILDREN'S SERVICES
 CITY OF PORTLAND
 NOV 19 2004

1 story wood structure w/ concrete foundation
more than 40yr citygate permission for pool

Woodfield Road to Wayside Rd.

[Handwritten signature]

HEREBY CERTIFY TO Ingraham Title Co Saco Valley Credit

Union and its title insurer
 monuments found did not conflict with the deed description
 the dwelling setbacks do not violate town zoning requirements
 as delineated on the Federal Emergency Management Agency Community
 Panel 230051-0006 B
 the structure does not fall within the special flood hazard zone
 the land does not fall within the special flood hazard zone
 wetlands study has not been performed

APPARENT EASEMENTS AND RIGHTS OF WAY ARE SHOWN. OTHER ENCUMBRANCES, RECORDED OR NOT, MAY EXIST. THIS SKETCH WILL NOT REVEAL ABUTTING DEED CONFLICTS, IF ANY.

copyright © 1994

Livingston - Hughes

Professional Land Surveyors

88 Guinea Road

Kennebunkport - Maine 04046

207-967-9761 phone 207-967-4831 fax

THIS SKETCH IS FOR MORTGAGE PURPOSES ONLY