

City of Portland, Maine – Building or Use Permit Application 389 Congress Street, 04101, Tel: (207) 874-8703, FAX: 874-8716

Location of Construction: 50 Westminister Ave		Owner: Group Main Stream, Inc.		Phone:		Permit No: 470745	
Owner Address: Retco Development		Lessee/Buyer's Name: 56 Summit Park Ave Ptld, ME 04103		Phone: 797-2900		BusinessName: 797-2900	
Contractor Name:		Address:		Phone:		<div style="border: 1px solid black; padding: 5px; text-align: center;"> PERMIT ISSUED JUL 15 1997 CITY OF PORTLAND </div>	
Past Use: 2-fam		Proposed Use: Same		COST OF WORK: \$ 3,700.00 FIRE DEPT. <input type="checkbox"/> Approved <input type="checkbox"/> Denied Signature:		PERMIT FEE: \$ 40.00 INSPECTION: <i>Uc</i> Use Group: <i>R-3</i> Type: <i>5B</i> Signature: <i>Hoffa</i>	
Proposed Project Description: Construct Ramp		PEDESTRIAN ACTIVITIES DISTRICT (P.A.D.)		Action: Approved <input type="checkbox"/> Approved with Conditions: <input type="checkbox"/> Denied <input type="checkbox"/> Signature: _____ Date: _____		Zone: <i>R-3</i> CBL: 181-A-002 Zoning Approval: <i>2-fam. ok per memo v. fuchs</i> Special Zone or Reviews: <input type="checkbox"/> Shoreland <i>7/11/97</i> <input type="checkbox"/> Wetland <input type="checkbox"/> Flood Zone <input type="checkbox"/> Subdivision <input type="checkbox"/> Site Plan maj <input type="checkbox"/> minor <input type="checkbox"/> mm <input type="checkbox"/>	
Permit Taken By: Mary Gresik		Date Applied For: 08 July 1997					

1. This permit application does not preclude the Applicant(s) from meeting applicable State and Federal rules.
2. Building permits do not include plumbing, septic or electrical work.
3. Building permits are void if work is not started within six (6) months of the date of issuance. False information may invalidate a building permit and stop all work..

Zoning Appeal

Variance
 Miscellaneous
 Conditional Use
 Interpretation
 Approved
 Denied

Historic Preservation

Not in District or Landmark
 Does Not Require Review
 Requires Review

Action:

Approved
 Approved with Conditions
 Denied

Date: *8/1/97*

CERTIFICATION

I hereby certify that I am the owner of record of the named property, or that the proposed work is authorized by the owner of record and that I have been authorized by the owner to make this application as his authorized agent and I agree to conform to all applicable laws of this jurisdiction. In addition, if a permit for work described in the application is issued, I certify that the code official's authorized representative shall have the authority to enter all areas covered by such permit at any reasonable hour to enforce the provisions of the code(s) applicable to such permit

SIGNATURE OF APPLICANT *Kathy Tayman* ADDRESS: _____ DATE: 08 July 1997 PHONE: _____

RESPONSIBLE PERSON IN CHARGE OF WORK, TITLE _____ PHONE: _____

White-Permit Desk Green-Assessor's Canary-D.P.W. Pink-Public File Ivory Card-Inspector

[Signature]

CEO DISTRICT 4
A. Powers

City of Portland, Maine – Building or Use Permit Application 389 Congress Street, 04101, Tel: (207) 874-8703, FAX: 874-8716

Location of Construction: 50 Westminister Ave		Owner: Group Main Street, Inc.		Phone:		Permit No: 97074	
Owner Address: Ratco Development		Lessee/Buyer's Name: 56 Summit Park Ave Prld, ME 04103		Phone: 797-2900		BusinessName: 797-2900	
Contractor Name:		Address:		Phone:		<div style="border: 2px solid black; padding: 5px; text-align: center;"> PERMIT ISSUED Permit Issued: JUL 15 1997 CITY OF PORTLAND </div>	
Past Use: 2-fam		Proposed Use: Same		COST OF WORK: \$ 3,700.00 PERMIT FEE: \$ 40.00			
Proposed Project Description: Construct Ramp		FIRE DEPT. <input type="checkbox"/> Approved <input type="checkbox"/> Denied Signature:		INSPECTION: <i>LI</i> Use Group: Type:		Zone: <i>R-3</i> CBL: 181-A-002	
				PEDESTRIAN ACTIVITIES DISTRICT (P.A.D.) Action: Approved <input type="checkbox"/> Approved with Conditions: <input type="checkbox"/> Denied <input type="checkbox"/> Signature: Date:		Zoning Approval: <i>2/1/99</i> Special Zone or Reviews: <input type="checkbox"/> Shoreland <i>7/1/97</i> <input type="checkbox"/> Wetland <input type="checkbox"/> Flood Zone <input type="checkbox"/> Subdivision <input type="checkbox"/> Site Plan maj <input type="checkbox"/> minor <input type="checkbox"/> mm <input type="checkbox"/>	
Permit Taken By: Mary Gresik		Date Applied For: 08 July 1997				Zoning Appeal <input type="checkbox"/> Variance <input type="checkbox"/> Miscellaneous <input type="checkbox"/> Conditional Use <input type="checkbox"/> Interpretation <input type="checkbox"/> Approved <input type="checkbox"/> Denied	

1. This permit application does not preclude the Applicant(s) from meeting applicable State and Federal rules.
2. Building permits do not include plumbing, septic or electrical work.
3. Building permits are void if work is not started within six (6) months of the date of issuance. False information may invalidate a building permit and stop all work..

CERTIFICATION

I hereby certify that I am the owner of record of the named property, or that the proposed work is authorized by the owner of record and that I have been authorized by the owner to make this application as his authorized agent and I agree to conform to all applicable laws of this jurisdiction. In addition, if a permit for work described in the application is issued, I certify that the code official's authorized representative shall have the authority to enter all areas covered by such permit at any reasonable hour to enforce the provisions of the code(s) applicable to such permit

SIGNATURE OF APPLICANT <i>Kathy Toyman</i>	ADDRESS:	DATE: 08 July 1997	PHONE:
RESPONSIBLE PERSON IN CHARGE OF WORK, TITLE			PHONE:

White-Permit Desk Green-Assessor's Canary-D.P.W. Pink-Public File Ivory Card-Inspector

CEO DISTRICT



COMMENTS

7-15-97 Handicap ramp constructed prior to obtaining permit. Had to relocate meters because of the clearance violation contractor created. Ramp was constructed per submitted.

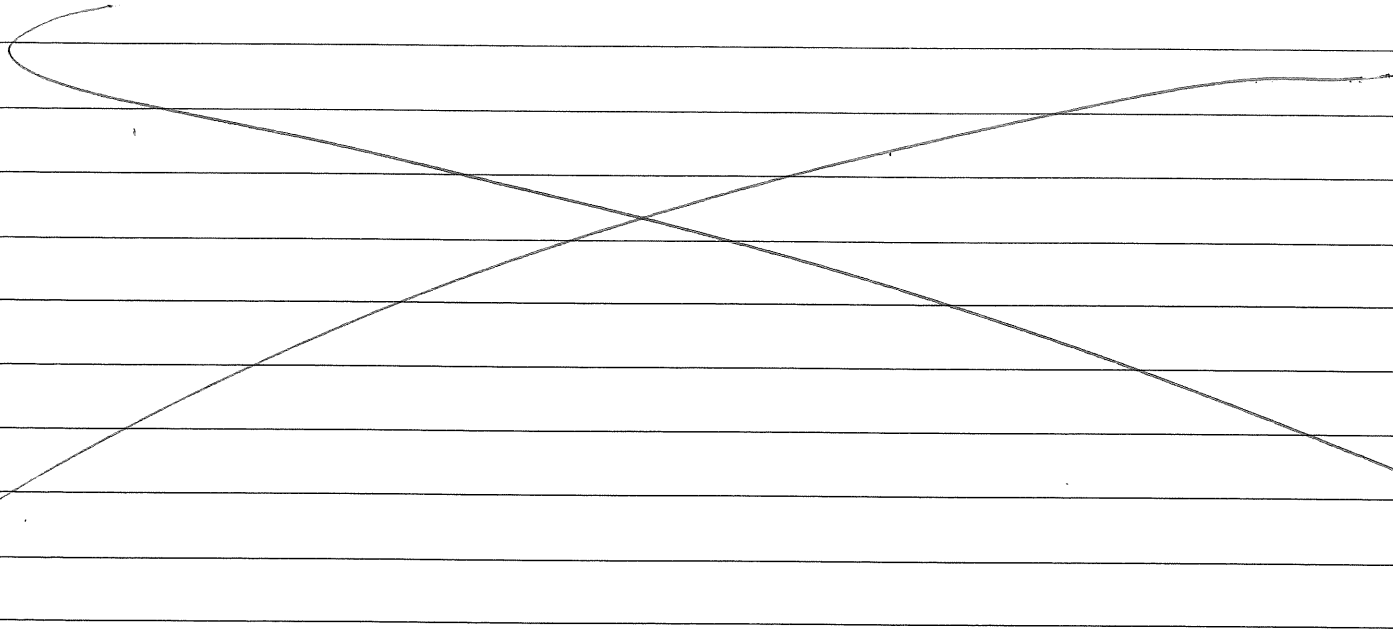

Inspection Record

Type	Date
Foundation: _____	_____
Framing: _____	_____
Plumbing: _____	_____
Final: _____	_____
Other: _____	_____

north ↑

Proposed Ramp 50-52
Westminister

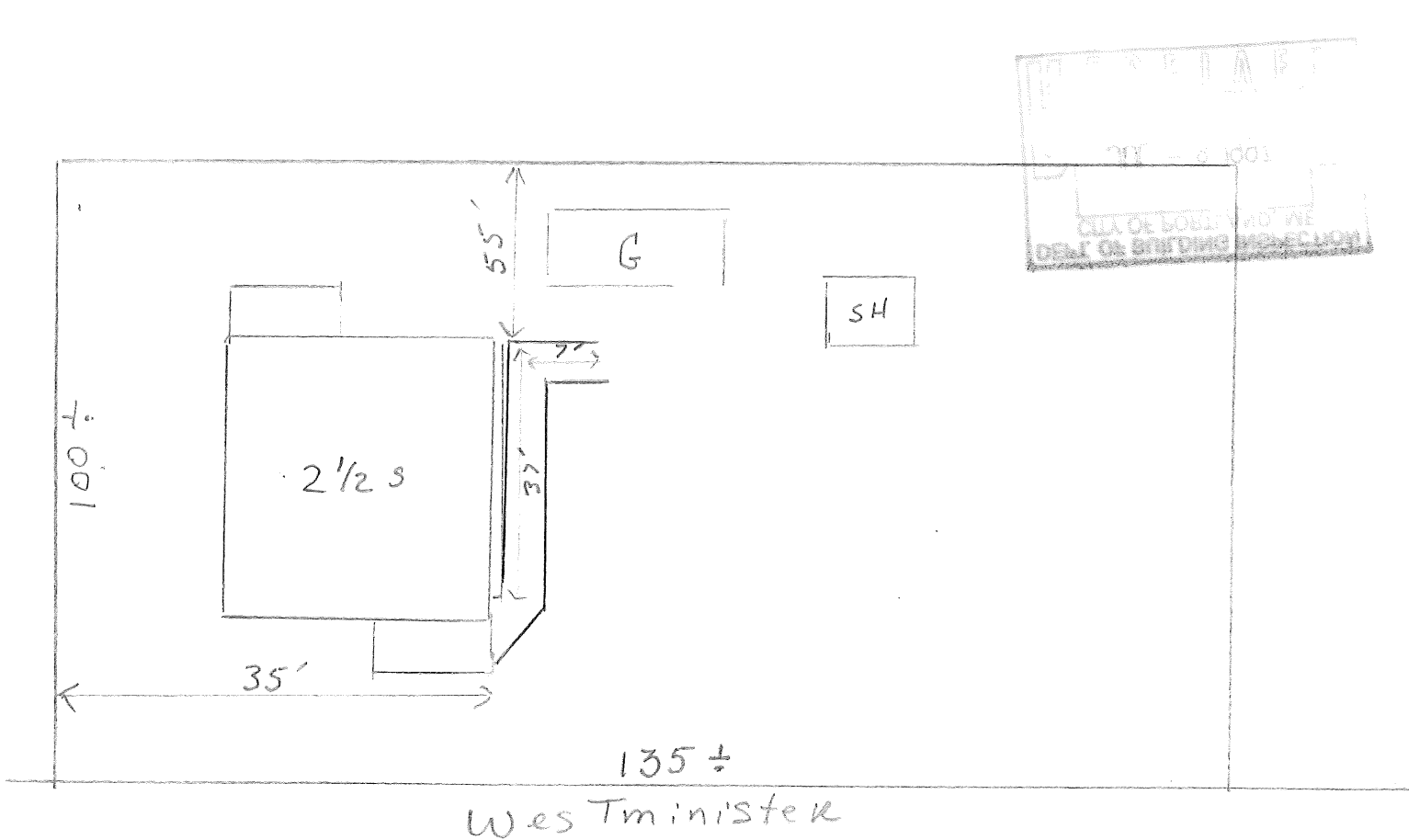

25' rear req - 55'
20' side req - 50'
shown

RAMP SPECIFICATIONS

50-52 WESTMINISTER AVE.

PORTLAND, ME.

1. LENGTH OF RAMP - 37 FEET
2. INSIDE WIDTH OF RAMP - 4 FEET
3. DESCENT OF RAMP - 1 INCH PER FOOT
12 FEET OF DESCENT TO 5 FOOT LEVEL PLATFORM (2)
4. 4 X 4 PRESSURE TREATED SUPPORT POSTS EVERY 5 FEET
5. RAILING HEIGHT AS PER LOCAL AND STATE BOCA CODE
6. BALUSTERS 4 INCHES ON CENTER
7. SUPPORT POSTS 4 FEET TO FROST LEVEL
8. ALL MATERIALS ARE PRESSURE TREATED WITH GALVANIZED
FASTENERS

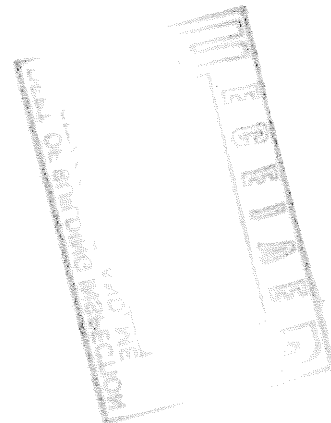

ELECTRICAL PERMIT

City of Portland, Me.



To the Chief Electrical Inspector, Portland Maine:
 The undersigned hereby applies for a permit to make electrical installations
 in accordance with the laws of Maine, the City of Portland Electrical Ordinance,
 National Electrical Code and the following specifications:

Date 10 July 1997

LOCATION: 50-52 Westminster Ave

Permit # 7764

OWNER Group Main Stream Inc. ADDRESS _____

								TOTAL EACH FEE	
OUTLETS	Telephone		Data		CATV				.20
	Receptacles		Switches		Smoke Detector				.20
FIBER OPTICS									15.00
FIXTURES	incandescent		fluorescent						.20
	fluorescent strip								.20
SERVICES	Overhead				TTL AMPS TO	800	200	15.00	15.00
	Underground					800		15.00	
Temporary Service	Overhead				AMPS OVER	800		25.00	
	Underground					800		25.00	
METERS	(number of)						2	1.00	2.00
MOTORS	(number of)							2.00	
RESID/COM	Electric units							1.00	
HEATING	oil/gas units		Interior		Exterior			5.00	
APPLIANCES	Ranges		Cook Tops		Wall Ovens			2.00	
	Insta-Hot	Water heaters	Fans		Dryers			2.00	
Disposals	Dishwasher		Compactors		Others (denote)			2.00	
MISC. (number of)	Air Cond/win							3.00	
	Air Cond/cent				Pools			10.00	
	HVAC		EMS		Thermostat			5.00	
	Signs							10.00	
	Alarms/res							5.00	
	Alarms/com							15.00	
	Heavy Duty(CRKT)							2.00	
	Circus/Carnv							25.00	
	Alterations							5.00	
	Fire Repairs							15.00	
	E Lights							1.00	
	E Generators							20.00	
PANELS	Service		Remote		Main			4.00	
TRANSFORMER	0-25 Kva							5.00	
	25-200 Kva							8.00	
	Over 200 Kva							10.00	
TOTAL AMOUNT DUE									
MINIMUM FEE/COMMERCIAL 35.00						MINIMUM FEE		25.00	25.00

INSPECTION: Will be ready 7/11 11:30 or will call _____

CONTRACTORS NAME Dick McDuffie MASTER LIC. # 7764
 ADDRESS P.O. Box 6517 Ptld LIMITED LIC. # _____
 TELEPHONE 839-7048

SIGNATURE OF CONTRACTOR *Dick McDuffie*

