

NOTE: BEAM JOINTS SHIP LAPPED AND SPIKED.

FRONT Deck/Porch (Existing)

Revised: 22 JUL 2014 **MJM**

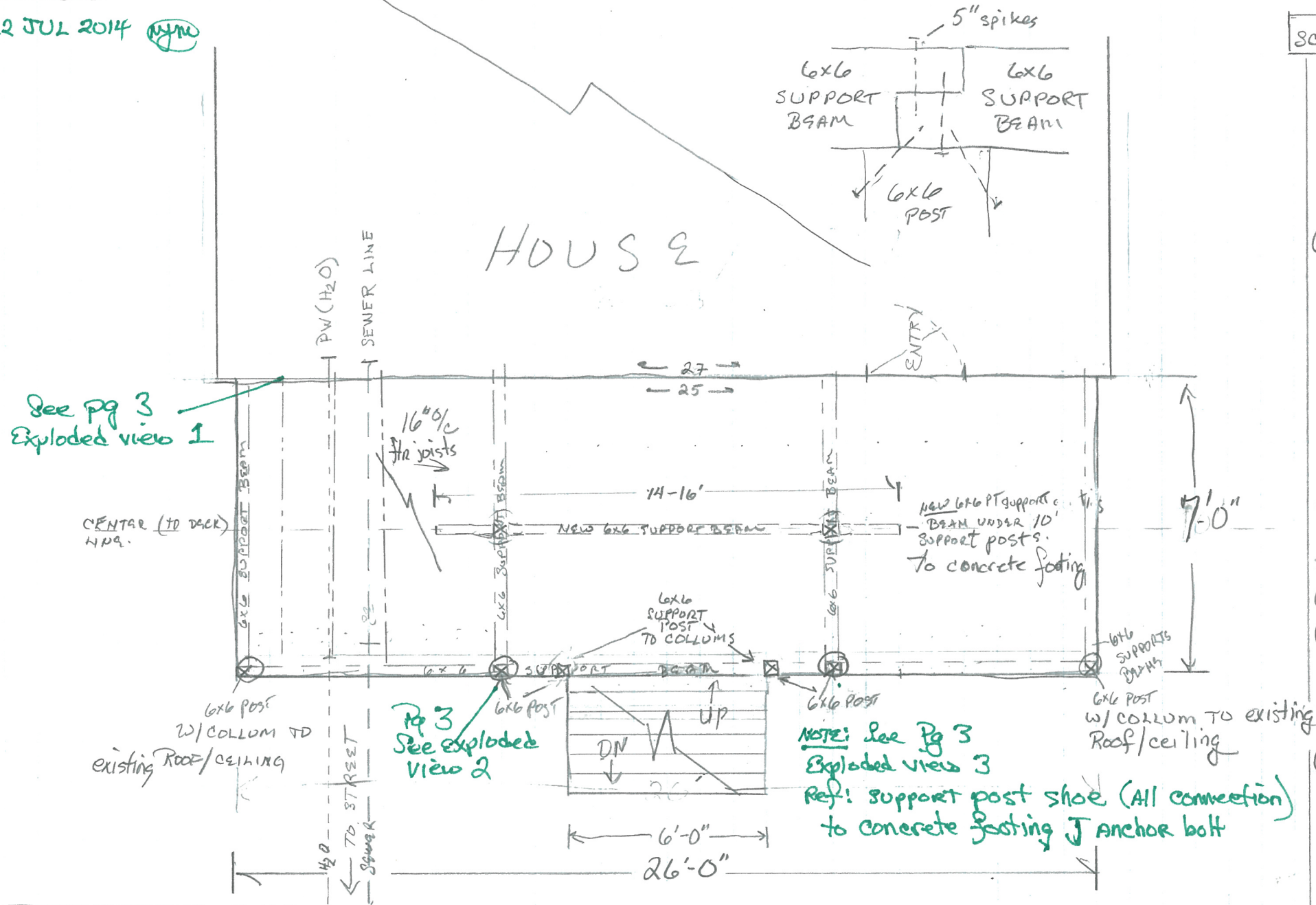

SCOPE of work to be performed:

- ① Remove Rotting lumber/decking and joists/ support posts and or sections of beams.
- ② Replace sections of support beam at step and column load support sections
- ③ Leave in place/support beams not deteriorated by rott.
- ④ Install ~~new~~ concrete frost supports at beam & column support locations ~~(PIER) (2) OR (6) frost protected supports for ctr.lin.beams~~
- ⑤ Install 6x6 P.T. support posts from concrete footings AND support junction to support beams and column locations. (columns: end corners and near stair well openings) AND support beams junctions at center line flooring supports)
- ⑥ Replace 10' section of most fund support beam with new 6x6 P.T. beam. at stairwell location.
- ⑦ Install 6x6 P.T. beam at center line (to deck) with 6x6 P.T. support posts to a concrete 8'10" foundation footing (surface) w/ 16" o/c of crushed stone as base to footings.
- ⑧ Install 2x8 P.T. flr joist at 16" o/c.
- ⑨ Install 2x10x25' P.T. to header board attached to house. w metal flashing and weather shield. (18-20 joists)
- ⑩ Install decking 7/8x6 P.T.
- ⑪ Install existing stairs to 2009 IRC 7'4" x 10'-0" (rise/run), with Guards 34-38" w/handrails
- ⑫ Install metal flashing to step and deck, header board.

NOTE: All exterior structure will have positive support anchors according to 2009 IRC and local codes.

- NOTES: ① NEED PLOT, BUILDING PLAN FOR PERMIT
 ② HAVE DIG SAFE MARK AREA OF CONCERN FROM STREET TO HOME. (CALLED 24 JUN 2014) 27 JUN after 2pm. Confirmation # 2014 2605847
 ③ DIG SAFE completed by all utilities 26 JUN 2014.

Property of:
 SUSAN Cassidy and Mark McCarthy
 46 Columbia Road
 Portland, ME.
 C: (207) 232-1035 (SUSAN)

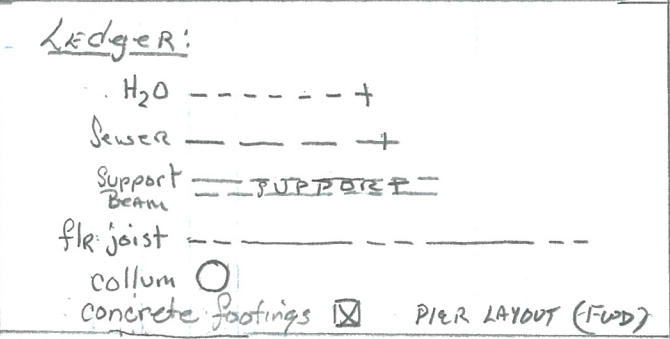

REVISED (22 JUL 2014) **MJM**

PLANS by:
 (1 JUL 2014)
 Michael McLeod C: (207) 232-6158
 Painting Maine & Improvement
 97 Verail Street, Portland, ME 04108