

Plan view

Truss are TO1GE TO1 TO1 TO1A ← TO2 → TO2GE

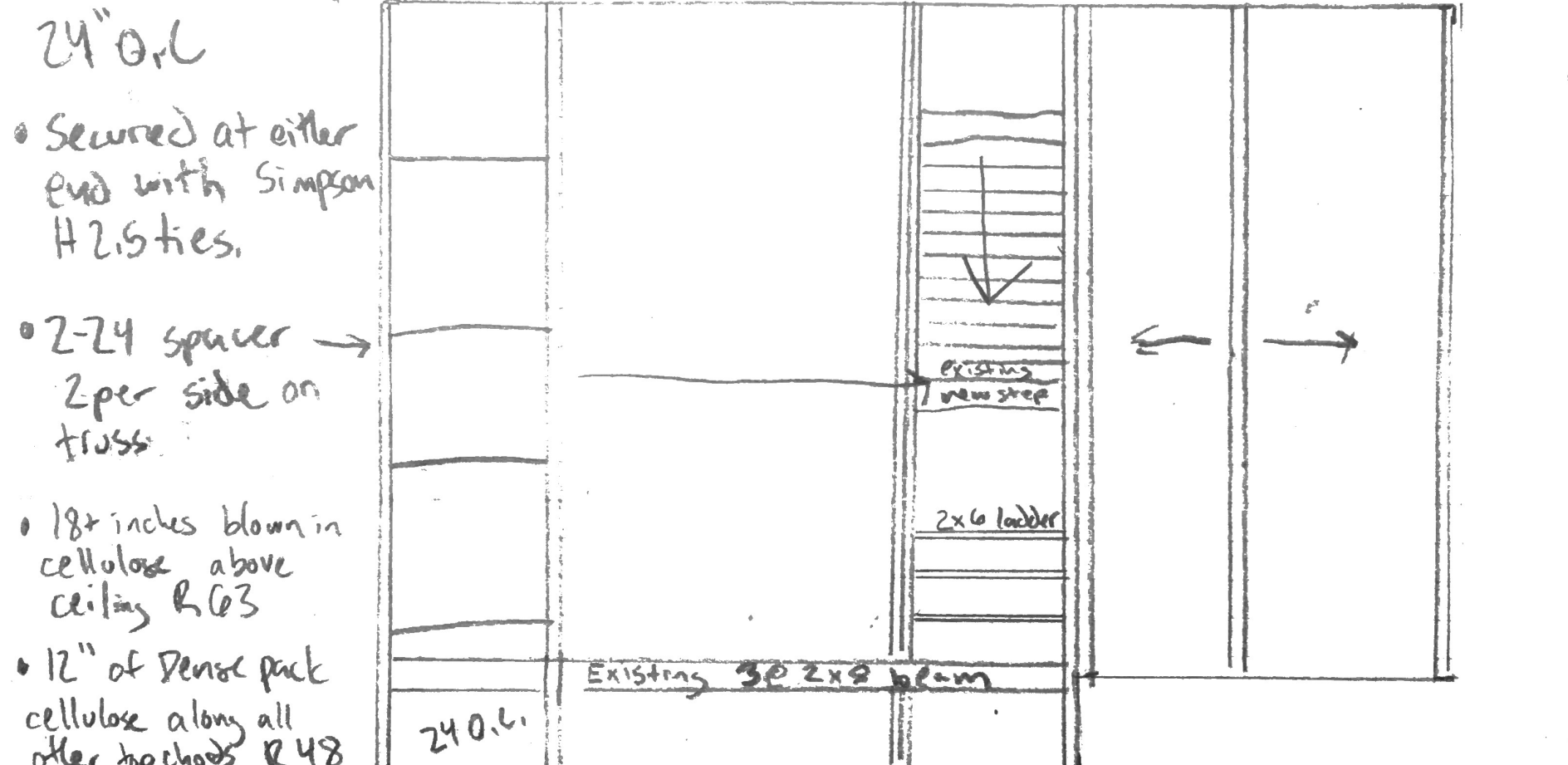

- Truss are 24" O.C
- Secured at either end with Simpson H2.5 ties.
- 2-24 spacer → 2 per side on truss.
- 18+ inches blown in cellulose above ceiling R63
- 12" of Dense pack cellulose along all other top chords R48

- Roof will be metal
- New step added to top of stairs due to increase of truss bottom chord
- Hand rail will extend full length of stair

Trusses doubled up either side of stair well per manufacturers recommendation

2x6 ladder runs 16" O.C in between doubled up trusses up to peak.