

City of Portland, Maine – Building or Use Permit Application 389 Congress Street, 04101, Tel: (207) 874-8703, FAX: 874-8716

Location of Construction: 85 Edgeworth Ave		Owner: Katherine J. Jean	Phone: 879-2575	Permit No: 990180
Owner Address: SAA 04103	Lessee/Buyer's Name:	Phone:	BusinessName:	PERMIT ISSUED Permit Issued: MAR - 5 1999 CITY OF PORTLAND
Contractor Name:	Address:	Phone:		
Past Use: 1-Family	Proposed Use: Same	COST OF WORK: \$ 550	PERMIT FEE: \$ 25.00	Zoning Approval: Special Zone or Reviews: <input type="checkbox"/> Shoreland <input type="checkbox"/> Wetland <input type="checkbox"/> Flood Zone <input type="checkbox"/> Subdivision <input type="checkbox"/> Site Plan maj <input type="checkbox"/> minor <input type="checkbox"/> mm <input type="checkbox"/>
		FIRE DEPT. <input type="checkbox"/> Approved <input type="checkbox"/> Denied	INSPECTION: Use Group: Type:	
Proposed Project Description: Add new door		PEDESTRIAN ACTIVITIES DISTRICT (P.A.D.) Action: Approved <input type="checkbox"/> Approved with Conditions: <input type="checkbox"/> Denied <input type="checkbox"/> Signature: _____ Date: _____		
Permit Taken By: E SP	Date Applied For: February 25, 1999			Zoning Appeal <input type="checkbox"/> Variance <input type="checkbox"/> Miscellaneous <input type="checkbox"/> Conditional Use <input type="checkbox"/> Interpretation <input type="checkbox"/> Approved <input type="checkbox"/> Denied

1. This permit application does not preclude the Applicant(s) from meeting applicable State and Federal rules.
2. Building permits do not include plumbing, septic or electrical work.
3. Building permits are void if work is not started within six (6) months of the date of issuance. False information may invalidate a building permit and stop all work..

CERTIFICATION

I hereby certify that I am the owner of record of the named property, or that the proposed work is authorized by the owner of record and that I have been authorized by the owner to make this application as his authorized agent and I agree to conform to all applicable laws of this jurisdiction. In addition, if a permit for work described in the application is issued, I certify that the code official's authorized representative shall have the authority to enter all areas covered by such permit at any reasonable hour to enforce the provisions of the code(s) applicable to such permit

February 25, 1999

SIGNATURE OF APPLICANT	ADDRESS:	DATE:	PHONE:
RESPONSIBLE PERSON IN CHARGE OF WORK, TITLE			PHONE:

White-Permit Desk Green-Assessor's Canary-D.P.W. Pink-Public File Ivory Card-Inspector

CEO DISTRICT



COMMENTS

Lined area for handwritten comments.

Inspection Record

	Type	Date
Foundation:		
Framing:	New Door 1. Reinforcement	4-2-99
Plumbing:		
Final:		
Other:		

THIS IS NOT A PERMIT/CONSTRUCTION CANNOT COMMENCE UNTIL THE PERMIT IS ISSUED

**Building or Use Permit Pre-Application
Additions/Alterations/Accessory Structures
To Detached Single Family Dwelling**

In the interest of processing your application in the quickest possible manner, please complete the Information below for a Building or Use Permit.

NOTEIf you or the property owner owes real estate or personal property taxes or user charges on any property within the City, payment arrangements must be made before permits of any kind are accepted.**

Location/Address of Construction: <u>85 EDGEWORTH AVE PORTLAND ME 04103</u>			
Tax Assessor's Chart, Block & Lot Number Chart# <u>181</u> Block# <u>B</u> Lot# <u>020</u>		Owner: <u>KATHERINE J. JEAN</u>	
Owner's Address: <u>85 EDGEWORTH AVE</u>		Telephone#: <u>879-2575</u>	
Lessee/Buyer's Name (If Applicable)		Cost Of Work: <u>\$ 550</u>	Fee <u>\$ 25</u>
Proposed Project Description:(Please be as specific as possible) <u>NEW DOOR OPENING</u>			
Contractor's Name, Address & Telephone <u>N/A</u>		Rec'd By: 	

Separate permits are required for Internal & External Plumbing, HVAC and Electrical installation.

- All construction must be conducted in compliance with the 1996 B.O.C.A. Building Code as amended by Section 6-Art II.
- All plumbing must be conducted in compliance with the State of Maine Plumbing Code.
- All Electrical Installation must comply with the 1996 National Electrical Code as amended by Section 6-Art III.
- HVAC(Heating, Ventilation and Air Conditioning) installation must comply with the 1993 BOCA Mechanical Code.

You must Include the following with you application:

- 1) A Copy of Your Deed or Purchase and Sale Agreement
- 2) A Copy of your Construction Contract, if available
- 3) A Plot Plan (Sample Attached)

If there is expansion to the structure, a complete plot plan (Site Plan) must include:

- The shape and dimension of the lot, all existing buildings (if any), the proposed structure and the distance from the actual property lines. Structures include decks porches, a bow windows cantilever sections and roof overhangs, as well as, sheds, pools, garages and any other accessory structures.
- Scale and required zoning district setbacks

4) Building Plans (Sample Attached)

A complete set of construction drawings showing all of the following elements of construction:

- Cross Sections w/Framing details (including porches, decks w/ railings, and accessory structures)
- Floor Plans & Elevations
- Window and door schedules
- Foundation plans with required drainage and dampproofing
- Electrical and plumbing layout. Mechanical drawings for any specialized equipment such as furnaces, chimneys, gas equipment, HVAC equipment (air handling) or other types of work that may require special review must be included.

Certification

I hereby certify that I am the Owner of record of the named property, or that the proposed work is authorized by the owner of record and that I have been authorized by the owner to make this application as his/her authorized agent. I agree to conform to all applicable laws of this jurisdiction. In addition, if a permit for work described in this application is issued, I certify that the Code Official's authorized representative shall have the authority to enter all areas covered by this permit at any reasonable hour to enforce the provisions of the codes applicable to this permit.

Signature of applicant: 	Date: <u>2/25/99</u>
---	----------------------

Building Permit Fee: \$25.00 for the 1st \$1000.cost plus \$5.00 per \$1,000.00 construction cost thereafter.

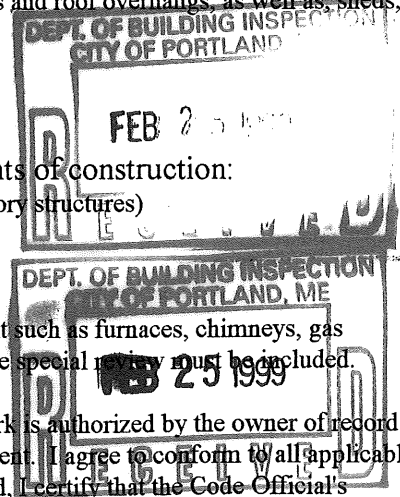

KATHERINE J. JEAN
85 EDGEWORTH AVE
PORTLAND ME 04103-2413
207-791-3130

EXTERIOR (Rear of house)

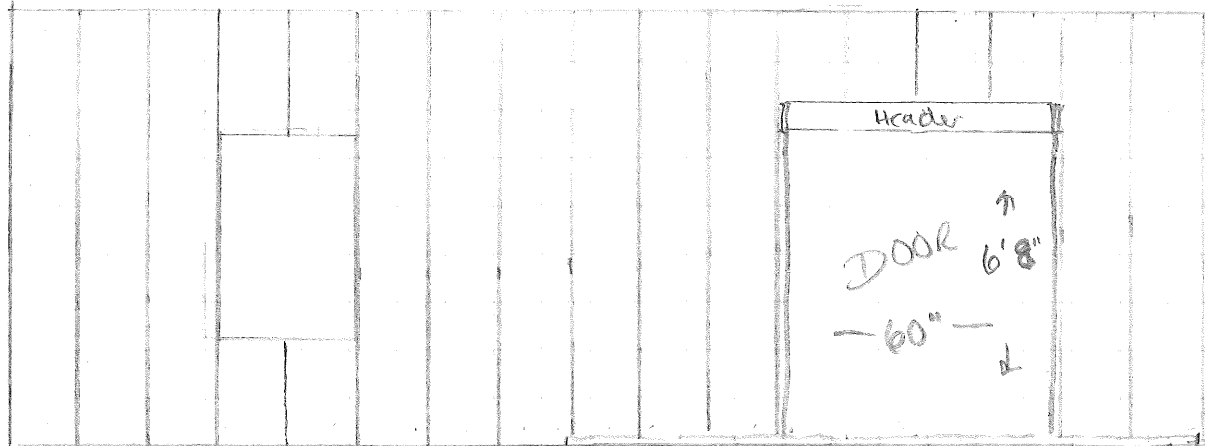

← 25' →

Deck

3/5/99 owner
supposedly took a
permit out for deck
last year - This permit
is just for the door
? is this a New
or Existing
Deck?

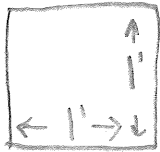

KATHERINE J. JEAN
 85 EDGEWORTH AVE
 PORTLAND ME 04103-2413
 207-791-5130

DOOR	366
SCREEN	54
HRDWARE	53
LUMBER	<u>50</u>
yard)	523
ty	<u>28.77</u>
	551.77

INTERIOR (look out to back

16 1/4

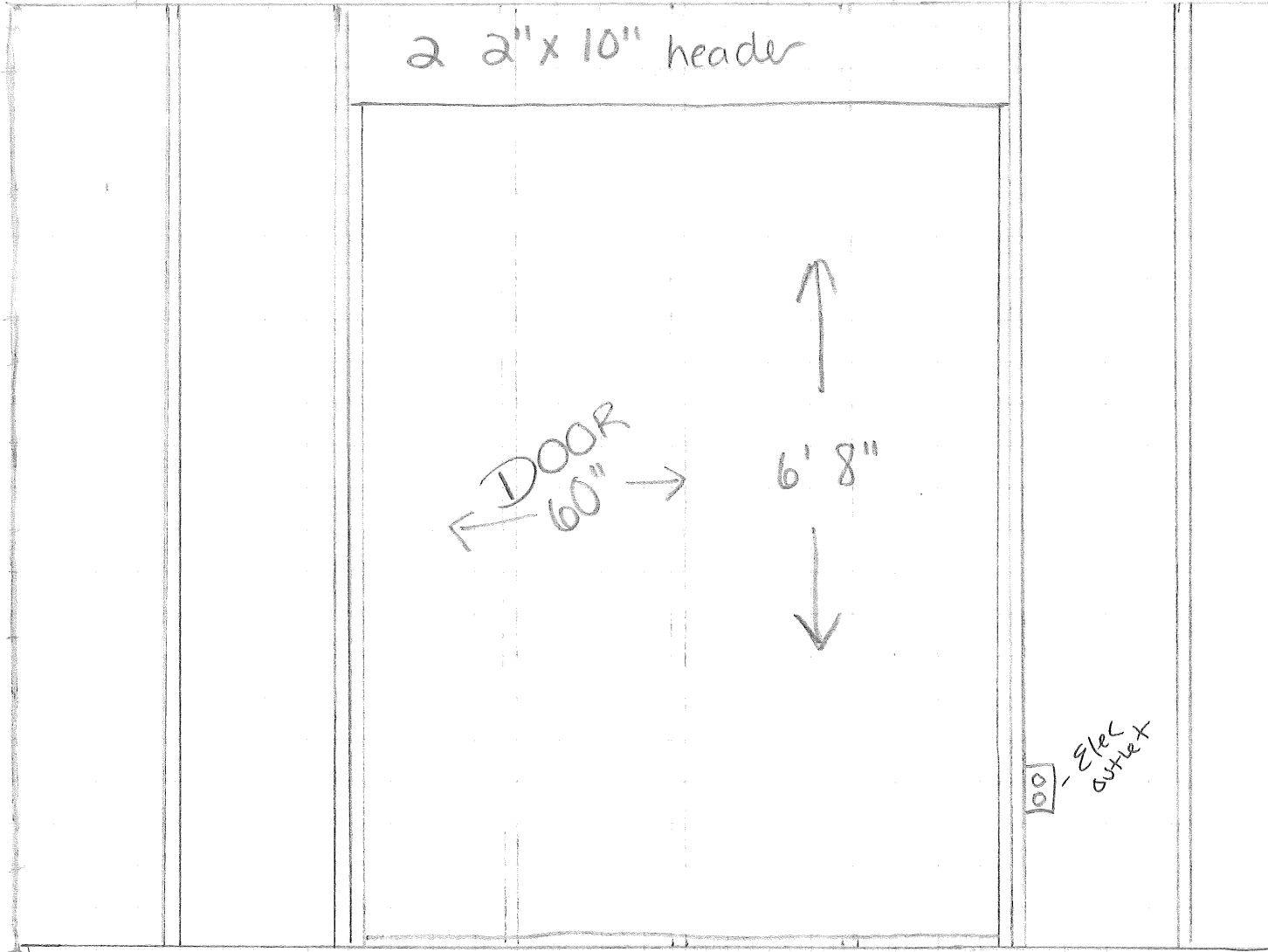

7'7"

10'

10'

72