

TYPICAL ROOF ASSEMBLY (R-50 MIN)
 ASPHALT SHINGLES
 BUILDING WRAP AIR BARRIER
 2 3/8" NAILER ROOF PANEL (R-12 MIN)
 EXT. SEAMS TAPED W/ BUILDING WRAP TAPE
 INT. GAPS FILLED W/ SPRAY FOAM
 WOOD TRUSS TOP CHORD W/
 12" FIBERGLASS BATT INSULATION (R-38 MIN)
 AIR SPACE
 WOOD TRUSS BOTTOM CHORD
 FURRING CHANNELS
 POLY VAPOR BARRIER
 5/8" GWP

120'-11"
 T.O. ROOF

109'-6 1/8"
 ATTIC FFE

109'-0"
 B.O. TRUSS

TYPICAL WALL ASSEMBLY (R-31 MIN)
 FIBER-CEMENT SIDING (SEE ELEVATIONS)
 BUILDING WRAP AIR BARRIER
 2 3/8" NAILER WALL PANEL (R-12 MIN)
 EXT. SEAMS TAPED W/ BUILDING WRAP TAPE
 INT. GAPS FILLED W/ SPRAY FOAM
 2x6 WOOD FRAMING W/
 5 1/2" BATT INSULATION (R-19 MIN)
 POLY VAPOR BARRIER
 5/8" GWP

1x2 FIBER CEMENT TRIM
 (TYP AT SIDING TRANSITION)

100'-0"
 FFE

FOUNDATION WALL - SEE STRUCTURAL
 2" RIGID INSULATION (R-12 MIN)

96'-0"
 FFE

ATTIC FLOOR ASSEMBLY (U.L. 528)
 3/4" T&G PLYWOOD PANELS
 WOOD TRUSS
 FURRING CHANNELS
 POLY VAPOR BARRIER
 5/8" GWP

SLAB ON GRAD - SEE STRUCTURAL

KEY

CONTINUOUS CONNECTION BETWEEN ROOF AIR BARRIER, WALL AIR BARRIER, AND SLAB VAPOR BARRIER.

ATTIC

HALL

53'-6 3/4"

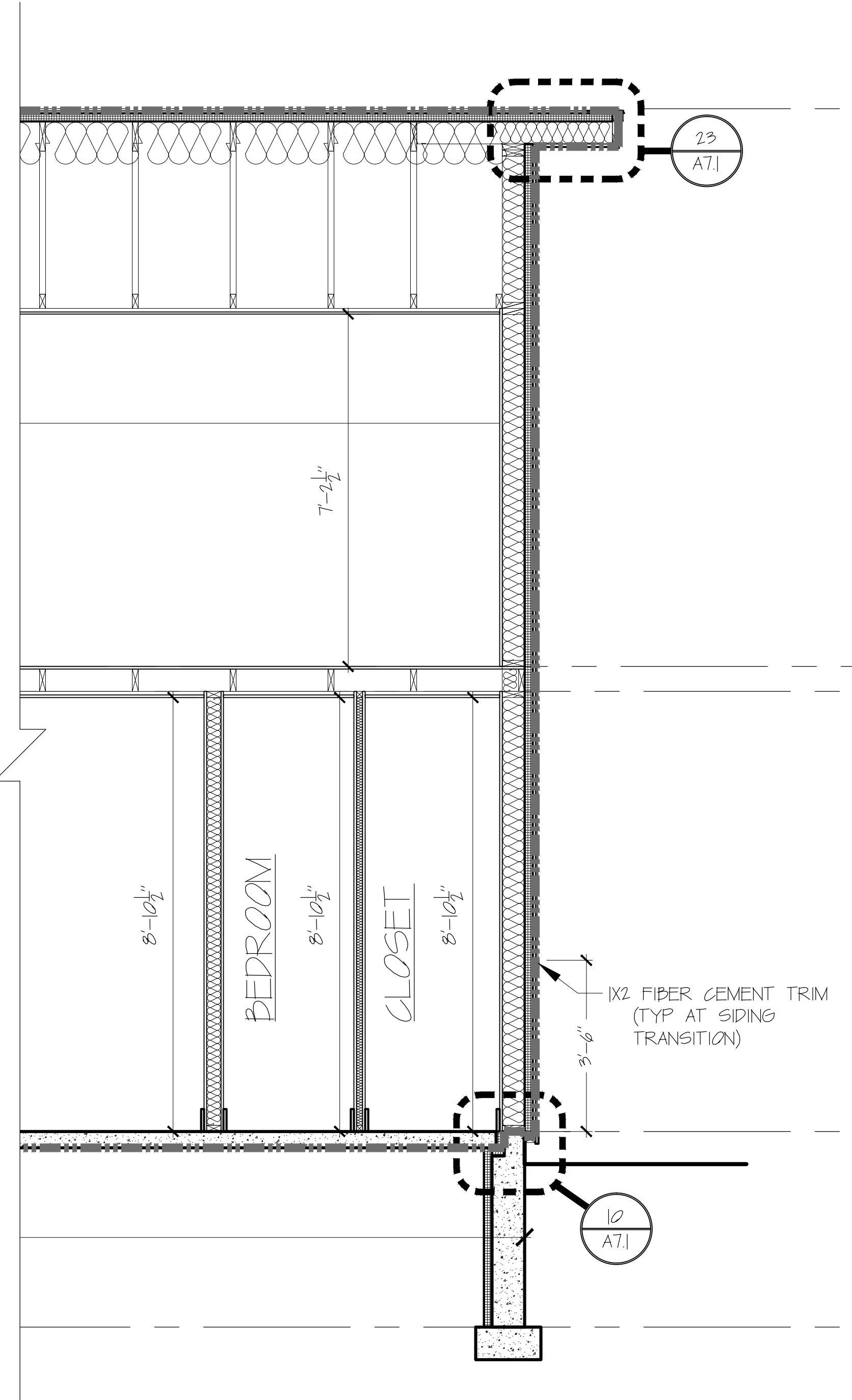

10 HALLWAY BUILDING SECTION
 0 2'-0" SCALE: 1/2" = 1'-0"