

Model No.	Nominal Post Size	Fastener		Allowable Loads (DF/SP)	
		Anch. Dia.	Post Screws	Uplift (160)	Down (100)
ABA44Z	4x4	1/2	6-SD9112	610	6000

### Load Values with Nails

These products are available with additional corrosion protection. Additional products on this page may also be available with this option, check with Simpson Strong-Tie for details.

These models are approved for installation with the Strong-Drive SD Structural-Connector screw. See the load values below.

Model No.	Nominal Post Size	Material		Dimensions (in.)				Anchor Dia. (in.)	Fasteners			Allowable Loads (DF/SP)		
		Base (Ga)	Strap (Ga)	W	L	H	HB <sup>6</sup>		Nails	Post		Uplift (160)		Down (100)
										Machine Bolts	Qty.	Dia.	Nails	
ABA44Z	4x4	16	16	3 <sup>1</sup> / <sub>16</sub>	3 <sup>1</sup> / <sub>8</sub>	3 <sup>1</sup> / <sub>16</sub>	—	1/2	6-10d	—	—	555	—	6000

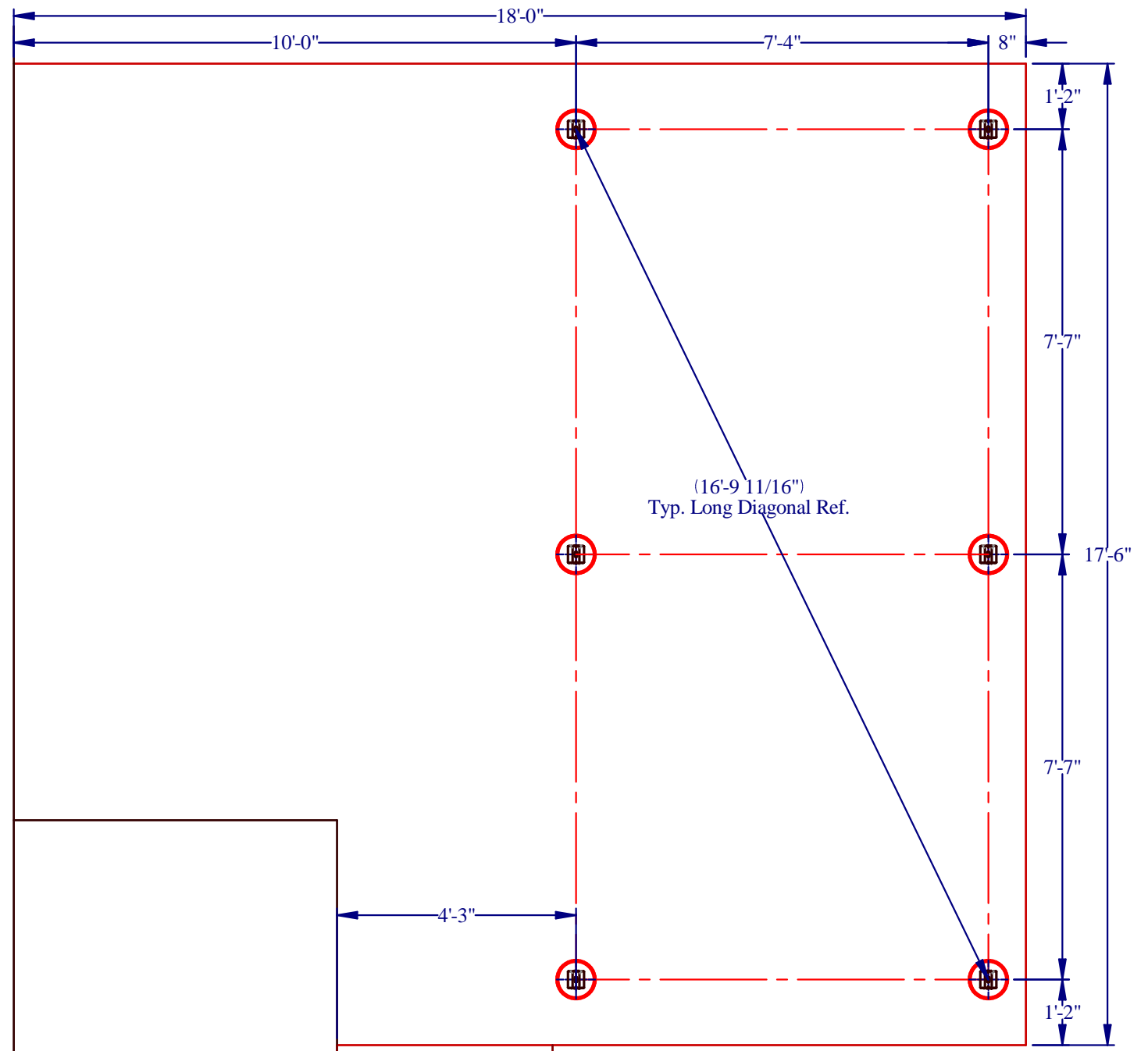

REV	DESCRIPTION	BY	DATE
SHEET 2 OF 4			
<b>44 Westminster Ave. Deck Permit Application</b>			
<b>Foundation Plan</b>			
REF/PCN:	DWG. NO: 44 Westminster.dft		
SIZE: B	DATE: 8/12/2014	DWG. FILE:	REV:
SCALE: 3/8" = 1'-0"	BY: GJC	APPVD:	