

69-71 MABEL STREET



Full cut # 920R • Half cut # 9204R • Third cut # 9203R • Fifth cut # 9205R





# APPLICATION FOR PERMIT

Class of Building or Type of Structure November 1, 1962

Portland, Maine,

REB SUBSTITUTE ZONE

PERMIT ISSUED  
11/15/62

To the INSPECTOR OF BUILDINGS, PORTLAND, MAINE

The undersigned hereby applies for a permit to erect alter repair demolish install the following building structure equipment in accordance with the Laws of the State of Maine, the Building Code and Zoning Ordinance of the City of Portland, plans and specifications, if any, submitted herewith and the following specifications:

Location 71 Kabel Street Within Fire Limits? \_\_\_\_\_ Dist. No. \_\_\_\_\_  
 Owner's name and address Raymond Wardwell, 71 Kabel St. Telephone 4-5372  
 Lessee's name and address \_\_\_\_\_ Telephone \_\_\_\_\_  
 Contractor's name and address Robert Moulton, 122 Kabel St. Tel 3-4225 Telephone \_\_\_\_\_  
 Architect \_\_\_\_\_ Specifications \_\_\_\_\_ Plans yes No. of sheets 1  
 Proposed use of building Dwelling No. families 1  
 Last use \_\_\_\_\_ " \_\_\_\_\_ No. families 1  
 Material frame \_\_\_\_\_ No. stories 2 1/2 Heat \_\_\_\_\_ Style of roof \_\_\_\_\_ Roofing \_\_\_\_\_  
 Other buildings on same lot \_\_\_\_\_  
 Estimated cost \$ 2000. Fee \$ 6.00

### General Description of New Work

To demolish existing 1-story addition 4'x6' front of dwelling and to cut in new window 3'6" wide.  
 To cut in new door on left side of dwelling at grade level.  
 To change size of window making it smaller on left side of dwelling.  
 To construct ~~in~~ 1-story frame addition 10'x12' on rear of dwelling, using existing door in dwelling 4'x8 header over picture window

It is understood that this permit does not include installation of heating apparatus which is to be taken out separately by and in the name of the heating contractor. **PERMIT TO BE ISSUED TO** owner

### Details of New Work

Is any plumbing involved in this work? yes Is any electrical work involved in this work? yes  
 Is connection to be made to public sewer? yes If not, what is proposed for sewage? \_\_\_\_\_  
 Has septic tank notice been sent? \_\_\_\_\_ Form notice sent? yes  
 Height average grade to top of plate 11' Height average grade to highest point of roof 14'  
 Size, front \_\_\_\_\_ depth \_\_\_\_\_ No. stories 1 solid or filled land? solid earth or rock? earth  
 Material of foundation concrete block at least 4' below grade Thickness, top 8" bottom 8" cellar no  
 Kind of roof shed Rise per foot \_\_\_\_\_ Roof covering asphalt roofing Class C Und. Lab.  
 No. of chimneys \_\_\_\_\_ Material of chimneys \_\_\_\_\_ of lining \_\_\_\_\_ Kind of heat \_\_\_\_\_ fuel \_\_\_\_\_  
 Framing Lumber—Kind hemlock Dressed or full size? dressed Corner posts 2-2x6 Sill's 4x6  
 Size Girder \_\_\_\_\_ Columns under girders \_\_\_\_\_ Size \_\_\_\_\_ Max. on centers \_\_\_\_\_  
 Studs (outside walls and carrying partitions) 2x4-16" O. C. Bridging in every floor and flat roof span over 8 feet.  
 Joists and rafters: 1st floor 2x6, 2nd 2x6 ceiling, 3rd \_\_\_\_\_, roof 2x6  
 On centers: 1st floor 16", 2nd 16", 3rd \_\_\_\_\_, roof 16"  
 Maximum span: 1st floor 32'10", 2nd \_\_\_\_\_, 3rd \_\_\_\_\_, roof 10'  
 If one story building with masonry walls, thickness of walls? \_\_\_\_\_ height? \_\_\_\_\_

### If a Garage

No. cars now accommodated on same lot \_\_\_\_\_, to be accommodated \_\_\_\_\_ number commercial cars to be accommodated \_\_\_\_\_  
 Will automobile repairing be done other than minor repairs to cars habitually stored in the proposed building? \_\_\_\_\_

APPROVED:

J. E. M.

### Miscellaneous

Will work require disturbing of any tree on a public street? no  
 Will there be in charge of the above work a person competent to see that the State and City requirements pertaining thereto are observed? yes

391

INSPECTION COPY

Signature of owner

Raymond Wardwell

P-1

NOTES

11-14-62 Footings  
 OK to pour *OK*  
 12-18-62 Rear  
 addition ready to  
 place in *OK*  
 1-7-62 Abaut  
 completed *OK*

*K*

11-27

Permit No. *62/1507*

Location *71 Maple St*

Owner *Richard M. Randall*

Date of permit *11/9/62*

Notif. closing-in

Inspn. closing-in

Final Notif.

Final Inspn.

Cert. of Occupancy issued

Staking Out Notice

Form Check Notice *11/13/62*







R3 RESIDENCE ZONE

### APPLICATION FOR PERMIT

PERMIT ISSUED

SEP 26 1961

CITY OF PORTLAND

Class of Building or Type of Structure Third Class

Portland, Maine, September 19, 1961

To the INSPECTOR OF BUILDINGS, PORTLAND, MAINE

The undersigned hereby applies for a permit to erect alter repair demolish install the following building structure equipment in accordance with the Laws of the State of Maine, the Building Code and Zoning Ordinance of the City of Portland, plans and specifications, if any, submitted herewith and the following specifications:

Location 71 Label Street Within Fire Limits? \_\_\_\_\_ Dist. No. \_\_\_\_\_  
 Owner's name and address Raymond G. Wardwell, 71 Label St. Telephone \_\_\_\_\_  
 Lessee's name and address \_\_\_\_\_ Telephone \_\_\_\_\_  
 Contractor's name and address owner Telephone \_\_\_\_\_  
 Architect \_\_\_\_\_ Specifications \_\_\_\_\_ Plans no No. of sheets \_\_\_\_\_  
 Proposed use of building Dwelling No. families 1  
 Last use \_\_\_\_\_ " \_\_\_\_\_ No. families 1  
 Material frame \_\_\_\_\_ No. stories 2 Heat \_\_\_\_\_ Style of roof pitch Roofing \_\_\_\_\_  
 Other buildings on same lot \_\_\_\_\_  
 Estimated cost \$ 200. Fee \$ 3.00

#### General Description of New Work

To change existing door to <sup>36"</sup> window rear of building and demolish existing platform.  
 To change window to door rear of building - door at grade level.  
 To construct roof over door - to be fastened to building with brackets.  
*Notes for the lot line from camp road door. Lot show road 55'*

It is understood that this permit does not include installation of heating apparatus which is to be taken out separately by and in the name of the heating contractor. **PERMIT TO BE ISSUED TO** owner

#### Details of New Work

Is any plumbing involved in this work? \_\_\_\_\_ Is any electrical work involved in this work? \_\_\_\_\_  
 Is connection to be made to public sewer? \_\_\_\_\_ If not, what is proposed for sewage? \_\_\_\_\_  
 Has septic tank notice been sent? \_\_\_\_\_ Form notice sent? \_\_\_\_\_  
 Height average grade to top of plate \_\_\_\_\_ Height average grade to highest point of roof \_\_\_\_\_  
 Size, front \_\_\_\_\_ depth \_\_\_\_\_ No. stories \_\_\_\_\_ solid or filled land? \_\_\_\_\_ earth or rock? \_\_\_\_\_  
 Material of foundation \_\_\_\_\_ Thickness, top \_\_\_\_\_ bottom \_\_\_\_\_ cellar \_\_\_\_\_  
 Kind of roof shed Rise per foot \_\_\_\_\_ roof covering asphalt roofing Class C Und. Lab.  
 No. of chimneys \_\_\_\_\_ Material of chimneys \_\_\_\_\_ of lining \_\_\_\_\_ Kind of heat \_\_\_\_\_ fuel \_\_\_\_\_  
 Framing Lumber—Kind board Dressed or full size? dressed Corner posts \_\_\_\_\_ Sills \_\_\_\_\_  
 Size Girder \_\_\_\_\_ Columns under girders \_\_\_\_\_ Size \_\_\_\_\_ Max. on centers \_\_\_\_\_  
 Studs (outside walls and carrying partitions) 2x4-16" O. C. Bridging in every floor and flat roof span over 8 feet.  
 Joists and rafters: 1st floor \_\_\_\_\_, 2nd \_\_\_\_\_, 3rd \_\_\_\_\_, roof 2x4  
 On centers: 1st floor \_\_\_\_\_, 2nd \_\_\_\_\_, 3rd \_\_\_\_\_, roof 16"  
 Maximum span: 1st floor \_\_\_\_\_, 2nd \_\_\_\_\_, 3rd \_\_\_\_\_, roof 4'  
 If one story building with masonry walls, thickness of walls? \_\_\_\_\_ height? \_\_\_\_\_

#### If a Garage

No. cars now accommodated on same lot \_\_\_\_\_, to be accommodated \_\_\_\_\_ number commercial cars to be accommodated \_\_\_\_\_  
 Will automobile repairing be done other than minor repairs to cars habitually stored in the proposed building? \_\_\_\_\_

APPROVED: G. E. M.

#### Miscellaneous

Will work require disturbing of any tree on a public street? no  
 Will there be in charge of the above work a person competent to see that the State and City requirements pertaining thereto are observed? yes

CS 301

INSPECTION COPY

Signature of owner

Raymond G. Wardwell

PH

NOTES

10-11-61 Not started

- cancel -

10-11-61

Permit No. 61/1248

Location 71 Maple St.

Owner Richard S. Handcock

Date of permit 9/26/61

Notif. closing-in

Inspn. closing-in

Final Notif.

Final Inspn.

Cert. of Occupancy issued

Staking Out Notice

Form Che. & Notice





FILL IN AND SIGN WITH INK

APPLICATION FOR PERMIT FOR HEATING, COOKING OR POWER EQUIPMENT

Portland, Maine, October 25, 1960

01641  
OCT 27 1960  
CITY OF PORTLAND

To the INSPECTOR OF BUILDINGS, PORTLAND, ME.

The undersigned hereby applies for a permit to install the following heating, cooking or power equipment in accordance with the Laws of Maine, the Building Code of the City of Portland, and the following specifications:

Location 71 Mabel St. Use of Building Dwelling No. Stories 2 Building Existing " " Name and address of owner of appliance Raymond G Wardwell, 71 Mabel St. Installer's name and address Portland Gas Light Co. 5 Temple St. Telephone 2-8321

General Description of Work

To install suspended Gas-fired Floor furnace Model TAB-65-TT Jenitrol in place of coal-fired hot air furnace.

IF HEATER, OR POWER BOILER

Location of appliance suspended Any burnable material in floor surface or beneath? none If so, how protected? Kind of fuel? gas Minimum distance to burnable material, from top of appliance or casing top of furnace register From top of smoke pipe 9" From front of appliance over 4' From sides or back of appliance over 3' Size of chimney flue 8x8 Other connections to same flue gas water heater If gas fired, how vented? thru chimney Rated maximum demand per hour 65,000 Will sufficient fresh air be supplied to the appliance to insure proper and safe combustion? yes

IF OIL BURNER

Name and type of burner Labelled by underwriters' laboratories? Will operator be always in attendance? Does oil supply line feed from top or bottom of tank? Type of floor beneath burner Size of vent pipe Location of oil storage Number and capacity of tanks Low water shut off Make No. Will all tanks be more than five feet from any flame? How many tanks enclosed? Total capacity of any existing storage tanks for furnace burners

IF COOKING APPLIANCE

Location of appliance Any burnable material in floor surface or beneath? If so, how protected? Height of legs, if any Skirting at bottom of appliance? Distance to combustible material from top of appliance? From front of appliance From sides and back From top of smokepipe Size of chimney flue Other connections to same flue Is hood to be provided? If so, how vented? Forced or gravity? If gas fired, how vented? Rated maximum demand per hour

MISCELLANEOUS EQUIPMENT OR SPECIAL INFORMATION

Gas-fired appliance to be equipped with device which will automatically shut off all gas supply in case pilot flame is extinguished.

Amount of fee enclosed? 2.00 (\$2.00 for one heater, etc., 50 cents additional for each additional heater, etc., in same building at same time.)

APPROVED: [Signature] 10-26-60, [Signature]

Will there be in charge of the above work a person competent to see that the State and City requirements pertaining thereto are observed? yes

Portland Gas Light Company

Signature of Installer by:

[Signature]

CS 300

INSPECTION COPY

Fm



RS RESIDENCE ZONE



APPLICATION FOR PERMIT

Class of Building or Type of Structure Third Class

Portland, Maine, May 1, 1959

PERMIT ISSUED

MAY 1 1959

CITY OF PORTLAND

To the INSPECTOR OF BUILDINGS, PORTLAND, MAINE

The undersigned hereby applies for a permit to erect alter repair demolish install the following building structure equipment in accordance with the Laws of the State of Maine, the Building Code and Zoning Ordinance of the City of Portland, plans and specifications, if any, submitted herewith and the following specifications:

Location 71 Mabel Street Within Fire Limits? \_\_\_\_\_ Dist. No. \_\_\_\_\_
Owner's name and address Raymond G. Wardwell, 71 Mabel St. Telephone \_\_\_\_\_
Lessee's name and address \_\_\_\_\_ Telephone \_\_\_\_\_
Contractor's name and address owner Telephone \_\_\_\_\_
Architect \_\_\_\_\_ Specifications \_\_\_\_\_ Plans yes No. of sheets 1
Proposed use of building Dwelling No. families 1
Last use \_\_\_\_\_ No. families 1
Material frame \_\_\_\_\_ No. stories \_\_\_\_\_ Heat \_\_\_\_\_ Style of roof \_\_\_\_\_ Roofing \_\_\_\_\_
Other buildings on same lot none
Estimated cost \$ 450. Fee \$ 2.00

General Description of New Work

To demolish existing front porch 4' x 10' and
To construct front porch 4' x 4' - with roof
To window to door on rear of dwelling and to construct 4' x 6' porch with roof

4x4 plate - 6' span

It is understood that this permit does not include installation of heating apparatus which is to be taken out separately by and in the name of the heating contractor. PERMIT TO BE ISSUED TO owner

Details of New Work

Is any plumbing involved in this work? \_\_\_\_\_ Is any electrical work involved in this work? \_\_\_\_\_
Is connection to be made to public sewer? \_\_\_\_\_ If not, what is proposed for sewage? \_\_\_\_\_
Has septic tank notice been sent? \_\_\_\_\_ Form notice sent? \_\_\_\_\_
Height average grade to top of plate 8' Height average grade to highest point of roof 13'
Size, front \_\_\_\_\_ depth \_\_\_\_\_ No. stories 1 solid or filled land? solid earth or rock? earth
Material of foundation 9" Sonotubes at least 4" below grade thickness, top \_\_\_\_\_ bottom \_\_\_\_\_ cellar \_\_\_\_\_
Material of underpinning \_\_\_\_\_ Height \_\_\_\_\_ Thickness \_\_\_\_\_
Kind of roof pitch Rise per foot \_\_\_\_\_ Roof covering asphalt roofing Class C Und. Job.
No. of chimneys \_\_\_\_\_ Material of chimneys \_\_\_\_\_ of lining \_\_\_\_\_ Kind of heat \_\_\_\_\_ fuel \_\_\_\_\_
Framing Lumber-Kind hemlock Dressed or full size? dressed Corner posts 4x4 Sills 4x6
Size Girder \_\_\_\_\_ Columns under girders \_\_\_\_\_ Size \_\_\_\_\_ Max. on centers one piece
Kind and thickness of outside sheathing of exterior walls? \_\_\_\_\_
Studs (outside walls and carrying partitions) 2x4-16" O. C. Bridging in every floor and flat roof span over 8 feet.
Joists and rafters: 1st floor 2x6, 2nd \_\_\_\_\_, 3rd \_\_\_\_\_, roof 2x6
On centers: 1st floor 16", 2nd \_\_\_\_\_, 3rd \_\_\_\_\_, roof 16"
Maximum span: 1st floor 6', 2nd \_\_\_\_\_, 3rd \_\_\_\_\_, roof 3'
If one story building with masonry walls, thickness of walls? \_\_\_\_\_ height? \_\_\_\_\_

If a Garage

No. cars now accommodated on same lot \_\_\_\_\_, to be accommodated \_\_\_\_\_ number commercial cars to be accommodated \_\_\_\_\_
Will automobile repairing be done other than minor repairs to cars habitually stored in the proposed building? \_\_\_\_\_

APPROVED:

012-5/1/59-AGJ

Miscellaneous

Will work require disturbing of any tree on a public street? no
Will there be in charge of the above work a person competent to see that the State and City requirements pertaining thereto are observed? yes

INSPECTION COPY

Signature of owner

Raymond G. Wardwell

NOTES

2-13-59 started on  
 Front *OP*

6-24-59 Front door  
 poorly framed. *OP*

7-10-59 Not started in  
 rear *OP*

9-14-59 Digging out  
 in rear *OP*

1-6-60 Addition over  
 bulkhead framed  
 poorly. *OP*

Rear porch not started *OP*

INSPECTION NOT COMPLETED *OP*

2-25 6-24 5-0 6-2

Perm. No. 59/451 9-24

Location 71 *OP*

Owner Raymond Woodcock

Date of permit 5/1/59

Notif. closing-in

Ins. # closing-in

Final Notif.

Final Inspn.

Cert. of Occupancy issued

Staking Out Notice

Form Check Notice

Blank lined area for additional notes or signatures.

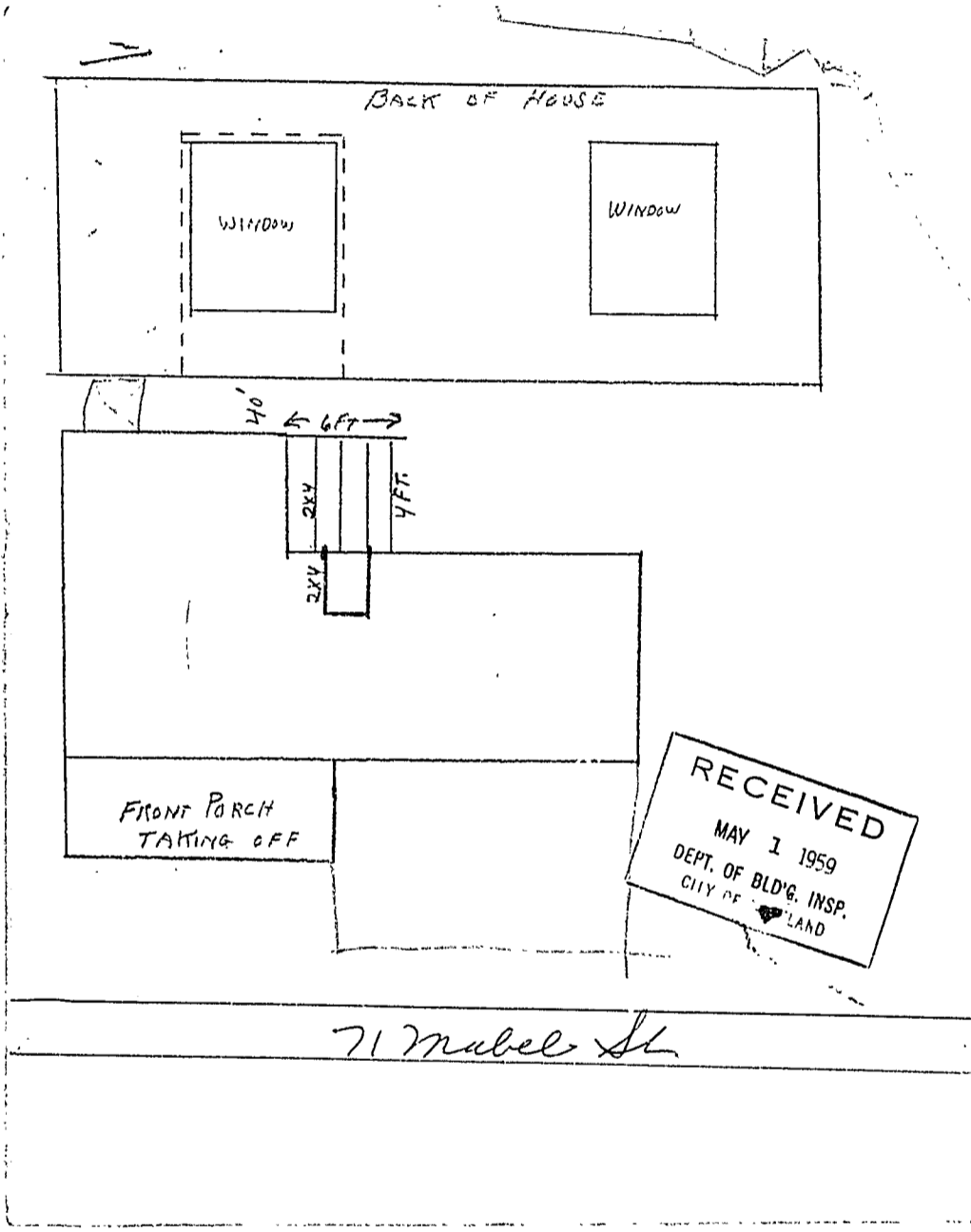

RECEIVED  
MAY 1 1959  
DEPT. OF BLD'G. INSP.  
CITY OF OREGON

71 Mabel St



FILL IN COMPLETELY AND SIGN WITH INK

PERMIT ISSUED

Permit No. \_\_\_\_\_

APPLICATION FOR PERMIT FOR HEATING, COOKING OR POWER EQUIPMENT

Portland, Maine, July 9, 1945

To the INSPECTOR OF BUILDINGS, PORTLAND, ME.

The undersigned hereby applies for a permit to install the following heating, cooking or power equipment in accordance with the Laws of Maine, the Building Code of the City of Portland, and the following specifications:

Location 71 Mable Street Use of Building Dwelling No. Stories 1 1/2 New Building Existing " Name and address of owner of appliance W. D. Graham, 71 Mabel Street Installer's name and address: Gilman Furnace Co., 57 Union St Telephone 2-2661

General Description of Work

To install forced warm air heater in place of one-pipe furnace

IF HEATER, POWER BOILER OR COOKING DEVICE

Is appliance or source of heat to be in cellar? Yes If not, which story Kind of Fuel coal Material of supports of appliance (concrete floor or what kind) concrete Minimum distance to wood or combustible material, from top of appliance or casing top of furnace, 18" from top of smoke pipe 15" from front of appliance Over 1' from sides or back of appliance Over 3'

IF OIL BURNER

Name and type of burner Labeled and approved by Underwriters' Laboratories? Will operator be always in attendance? Type of oil feed (gravity or pressure) Location oil storage No. and capacity of tanks Will all tanks be more than seven feet from any flame? How many tanks fireproofed?

Amount of fee enclosed? 1.00 (\$1.00 for one heater, etc., 50 cents additional for each additional heater, etc., in same building at same time.)

Signature of Installer Frank W. Gilman

ORIGINAL

CERTIFICATE OF OCCUPANCY REQUIREMENT IS WAIVED

OK 7-9-45

Permit No. 457-723

Location 711 Mabel Street

Owner H. O. Graham

Date of Permit 7/10/45

Post Card sent

Notif. for inapn. 7-23-45 V.F.M.F.

Approval Tag issued

Oil Burner Check List (date)

1. Kind of heat
2. Label
3. Anti-siphon
4. Oil storage
5. Tank Distance
6. Vent Pipe
7. Fill Pipe
8. Gauge
9. Rigidity
10. Feed safety
11. Pipe sizes and material
12. Control valve
13. Ash pit vent
14. Temp. or pressure safety
15. Instruction card
- 16.

NOTES

7-23-45 call install  
Just cold air registers.  
V.F.M.F.

TABLER OFF

MAY 1 1964  
DEPT. OF BLD'G. INSP.  
CITY OF HAWAII

71 Mabel St.



IF OIL BURNER

Name and type of burner \_\_\_\_\_ Labeled and approved by Underwriters' Laboratories? \_\_\_\_\_

Will operator be always in attendance? \_\_\_\_\_ Type of oil feed (gravity or pressure) \_\_\_\_\_

Location oil storage \_\_\_\_\_ No. and capacity of tanks \_\_\_\_\_

Will all tanks be more than seven feet from any flame? \_\_\_\_\_ How many tanks fireproofed? \_\_\_\_\_

Amount of fee enclosed? 1.00 (\$1.00 for one heater, etc., 50 cents additional for each additional heater, etc., in same building at same time.)

Signature of Installer Frank W. Johnson

ORIGINAL

9. Read by
10. Field safety
11. Pipe sizes and material
12. Control valve
13. Ash pit vent
14. Temp. or pressure safety
15. Instruction card
- 16.

NOTES

1.25 for all instr. if  
but cold air reg. for  
1.25