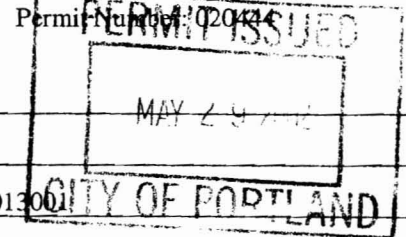

DISPLAY THIS CARD ON PRINCIPAL FRONTAGE OF WORK

**CITY OF PORTLAND**

Please Read  
Application And  
Notes, If Any,  
Attached

B DIVISION

**PERMIT**This is to certify that Dill David A & Michelle A J Sebago Inc Poolshas permission to Install 24' Above Ground PoolAT 30 Hamblet Ave

179 B013001

provided that the person or persons, firm or corporation accepting this permit shall comply with all of the provisions of the Statutes of Maine and of the ordinances of the City of Portland regulating the construction, maintenance and use of buildings and structures, and of the application on file in this department.

Apply to Public Works for street line and grade if nature of work requires such information.

Notification of inspection must be given and when permission is procured before this building or part thereof is altered or closed-in. 48 HOUR NOTICE IS REQUIRED.

A certificate of occupancy must be procured by owner before this building or part thereof is occupied.

**OTHER REQUIRED APPROVALS**

Fire Dept. \_\_\_\_\_  
Health Dept. \_\_\_\_\_  
Appeal Board \_\_\_\_\_  
Other \_\_\_\_\_  
Department Name \_\_\_\_\_

*[Signature]*  
Director - Building & Inspection Services

**PENALTY FOR REMOVING THIS CARD****EXPIRE**

# BUILDING PERMIT INSPECTION PROCEDURES

Please call 874-8703 or ~~874-8698~~ to schedule your inspections as agreed upon

Permits expire in 6 months, if the project is not started or ceases for 6 months.

The Owner or their designee is required to notify the inspections office for the following inspections and provide adequate notice. Notice must be called in 48-72 hours in advance in order to schedule an inspection:

By initializing at each inspection time, you are agreeing that you understand the inspection procedure and additional fees from a "Stop Work Order" and "Stop Work Order Release" will be incurred if the procedure is not followed as stated below.

☒ **Pre-construction Meeting:** Must be scheduled with your inspection team upon receipt of this permit. Jay Reynolds, Development Review Coordinator at 874-8632 must also be contacted at this time, before any site work begins on any project other than single family additions or alterations.

☒ **Footing/Building Location Inspection:** Prior to pouring concrete

N/A **Re-Bar Schedule Inspection:** Prior to pouring concrete

N/A **Foundation Inspection:** Prior to placing ANY backfill

☒ **Framing/Rough Plumbing/Electrical:** Prior to any insulating or drywalling

☒ **Final/Certificate of Occupancy:** Prior to any occupancy of the structure or use. NOTE: There is a \$75.00 fee per inspection at this point.

Certificate of Occupancy is not required for certain projects. Your inspector can advise you if your project requires a Certificate of Occupancy. All projects DO require a final inspection

       If any of the inspections do not occur, the project cannot go on to the next phase, REGARDLESS OF THE NOTICE OR CIRCUMSTANCES.

N/A **CERTIFICATE OF OCCUPANCIES MUST BE ISSUED AND PAID FOR, BEFORE THE SPACE MAY BE OCCUPIED**

X-7-1 A. P. d  
Signature of applicant/designee

5/29/02  
Date

[Signature]  
Signature of Inspections Official

5/29/02  
Date

CBL: 179B013001 Building Permit #: 020444

## ABOVE GROUND SWIMMING POOL

ELECTRICAL WIRING REQUIREMENTS PER  
ARTICLE 680 OF THE NATIONAL ELECTRICAL  
CODE AND UNDERWRITERS LABORATORIES LISTING

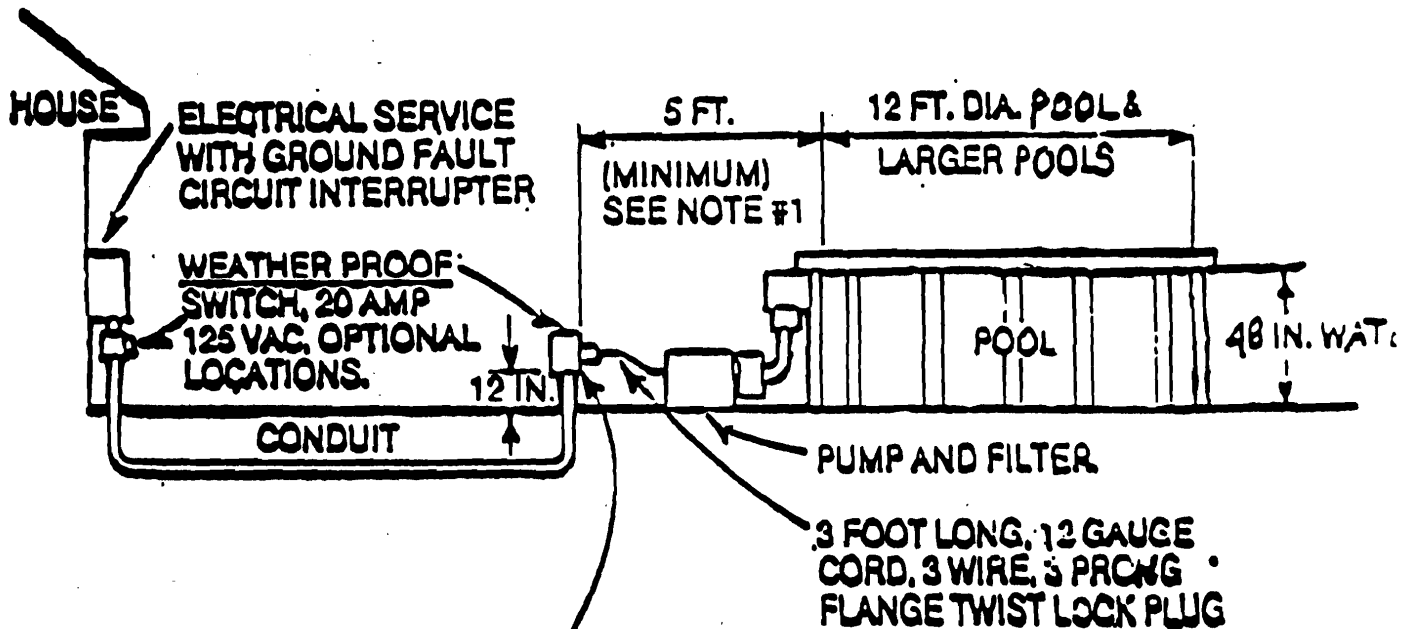

RECEPTACLE BOX WITH A  
HUBBELL NO. 2310 RECEPTACLE,  
20A, 125VAC OR AN EQUIVALENT  
TWIST LOCK RECEPTACLE THAT  
MEETS NEMA LS-2 CONFIGURATION.

**NOTE: 1** DO NOT LOCATE RECEPTACLE BOX FURTHER THAN OR  
CLOSER THAN 5 FEET FROM INSIDE POOL WALL OR INSTALLATION  
WILL NOT BE IN COMPLIANCE WITH ARTICLE 680 OF THE N.E.C.  
ELECTRICAL CODE NOR WILL FILTER AND PUMP HOSES  
REACH FOR A PROPER INSTALLATION.

**NOTE:** OUR PUMPS ARE DOUBLE INSULATED AND GROUNDED. DEAD METAL PARTS ARE  
NOT IN CONTACT WITH POOL WATER AND, NORMALLY, ADDITIONAL BONDING  
SHOULD NOT BE REQUIRED. ADDITIONAL BONDING OR GROUNDING OF THE  
PUMP MOTOR WILL DEFEAT THE DOUBLE INSULATION DESIGN.

# Riviera

## ROUND POOL SIZES

12 ft.  
15 ft.  
18 ft.  
21 ft.  
24 ft.  
27 ft.  
30 ft.

## OVAL POOL SIZES

18 ft. x 12 ft.  
24 ft. x 12 ft.  
24 ft. x 15 ft.  
30 ft. x 15 ft.  
33 ft. x 18 ft.  
45 ft. x 18 ft.

48"

ALL SIZES AVAILABLE  
IN 48" & 52" DEEP MODELS

52"



**WARNING!**  
POOLS ARE NOT DESIGNED  
FOR DIVING OR JUMPING!



**35  
Year**  
Limited Warranty  
First 3 seasons  
no charge for parts



## SPECIFICATIONS

**Wall:** Gray prism wall with Crystex Coat  
**Covers:** Full contoured molded resin - Gray color  
**Ledges:** 7" roll-formed vinyl coated steel deluxe - textured gray  
**Verticals:** 6" roll-formed vinyl coated steel deluxe box - Gray  
**Rails:** 1" steel universal top and bottom rails - resin coated  
**Plates:** Steel universal top and bottom plates - resin coated  
**Hardware:** Stainless steel

## LAYERS OF TREATMENT:

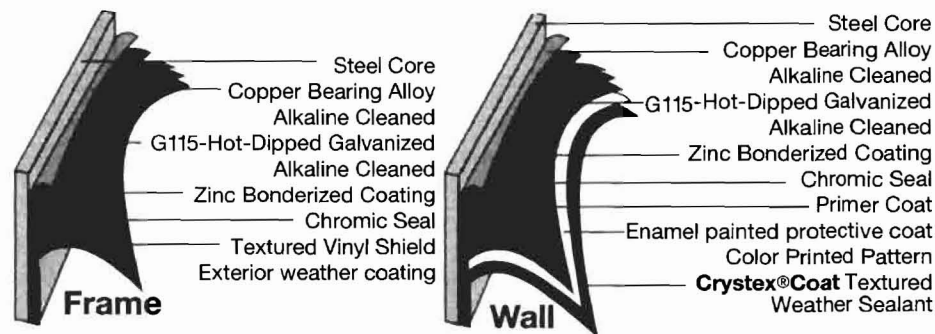

**Swim'n Play, Inc.**  
Makers of Fine Above Ground Pools®

313 Regina Avenue  
Rahway, New Jersey 07065-  
Phone: (732) 574-1500  
Fax: (732) 574-1551  
www.swimnplay.com  
E-mail: info@swimnplay.co

**DISTRIBUTED BY**

**SEBAGO LAKE POOLS**  
Frost N' Flame  
629 Main Street  
GORHAM, ME 04038  
(207) 856-1000 • (207) 856-7000

**100% Easy Financing Available**

# Sebago Lake Pools



**629 Lower Main St., (Rte. 25) Gorham, ME 04038**

**207-856-1000 OR 207-856-7000 Fax 856-1164**

***Known by our Reputation & Service - 2 Year Installation Warranty Included***  
**Only at Sebago Lake Pools**

**Deluxe Above Ground Pool Kits**  
**Solar Heated**

**Home of the Extra Deep Jumbo Pools!!!**  
**62" Deep (Round Only) Option**

**Warning: No Diving or Jumping Allowed**

1. Customer Choice of Pool
2. Winterized Heavy Duty 20 Gauge Liner Pebble Bottom w/ 20 Year Warranty & Expandable Bottom up to 10" Deeper
3. Automatic Built in Wall Skimmer and Directional Water Inlet
4. Hayward 1 Horse Power - Flo Pump and Polymeric Sand Filter or D-E Unit (Energy Saving)
5. Heavy Duty Resin A - frame or Deck Ladder - Best Available
6. Vacuum Kit complete with Hose, Pole, Vacuum Head, Nylon Brush, Leaf Skimmer & Skim Vac
7. Deluxe 3 in 1 Chemical Test Kit
8. Ladder Mat and Thermometer
9. Automatic Pool Sanitizer
10. Solar Cover

## **100% Complete Pool Kit**

## **Pool Construction If Done by Sebago Lake Pools Full Time Pool Employees**

1. Labor includes Pool Construction
  - A. Filter and Pump Installation
  - B. Chemical Water Balance Included
  - C. Customer is Taught Pool Operation at the Shop
2. 4 1/2 Yards of Above Ground Pool Base Material
3. Spreading of Pool Base Material
4. Pool Construction in 25 Mile Radius
5. Pile Empty Boxes in Yard.
6. Concrete Blocks Under Uprights
7. Assembly of Ladder - Customer fastens to pool.
8. 2 Yr. Installation Warranty on Installation, if pool is opened & closed by Sebago Lake Pool.

### **NOTE: WHAT IS NOT INCLUDED**

1. Permit for Pool
2. Water for Pool Not Covered Under Warranty
3. Electrical Work
4. Excavation - Additional Fill if Needed or Material Removed from Site
5. Landscaping or Ledge Removal
6. Crushed Rock or Other Material to Prevent Erosion outside of Pool Wall at least 4" up pool wall.
7. Note: No above ground pool is warrantied for winter damage by ice, snow or frost heaving by Sebago Lake Pools or any other manufacturer.

## **Installed Pool Options Available**

- |                                                                                     |                                                            |
|-------------------------------------------------------------------------------------|------------------------------------------------------------|
| 1. Crushed Rock 2 ft around Pool -<br>Rock & Labor 24 or 27 ft.....\$285.00         | 4. Double Side Walk In Steps & Gate .....\$599.00          |
| 2. Above Ground Pool Lights<br>12 Volt Halogen<br>(Elec. not Included).....\$295.00 | 5. Solar Reel System.....\$295.00                          |
| 3. Walk In Steps (each) 1 side.....\$349.00                                         | 6. Auto Pool Vacuum .....\$275.00                          |
|                                                                                     | 7. Pool Fountain.....\$125.00                              |
|                                                                                     | 8. L.P. Pool Heater 200,000 BTU (installed).....\$1,899.00 |
|                                                                                     | 9. Winter Cover                                            |

## **Deck Packages Available - Aluminum Decks**

3 pc Fan Deck & Fencing	End Decks & Fencing Oval	Side Deck & Fencing Oval	Special Decks - Walk Around
18 ft.....\$1,775.00	12 x 24.....\$2,225.00	12 x 24.....\$1,650.00	24ft..... \$3,250.00
24ft.....\$1,875.00	15 x 24.....\$2,455.00	15x24.....\$1,695.00	15ft x 30 ft.....\$5,250.00
27ft.....\$1,975.00	15 x 30.....\$2,555.00	15 x 30.....\$1,875.00	
	18 x 30.....\$3,125.00	18 x 30.....\$1,975.00	

## **Installation Prices: With 2 year In-House Installation Warranty**

### **Not Warrantied for Ice & Snow Damage**

18 ft Round.....\$895.00	12 x 24 Oval.....\$1,125.00	Decking & Fence
21 ft Round.....\$975.00	15 x 24 Oval.....\$1,135.00	3 pc Decks Round.....\$575.00

field/cemetery

Swing Set

Rear- 25' Req.  
Side- 8' Req.

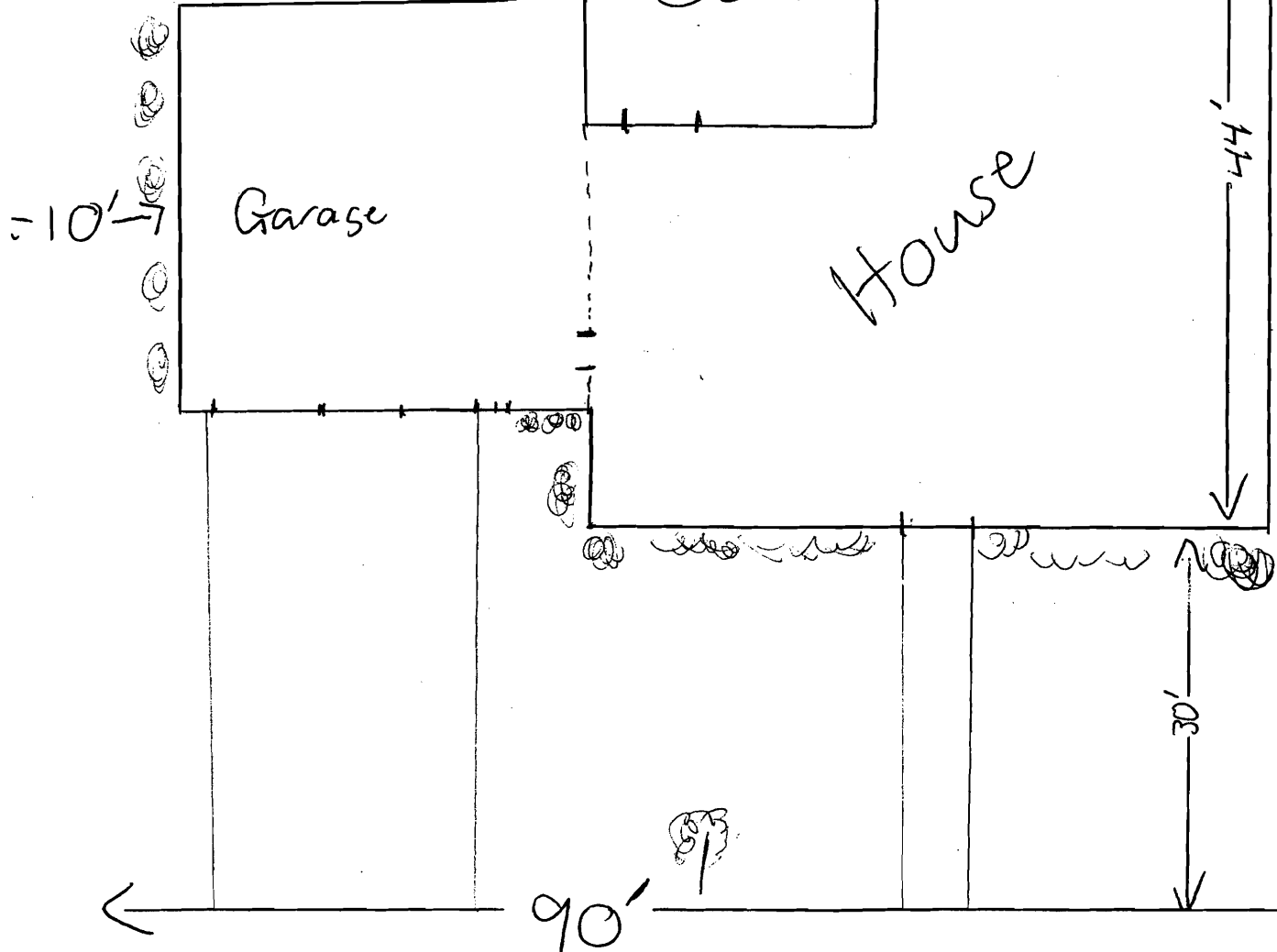
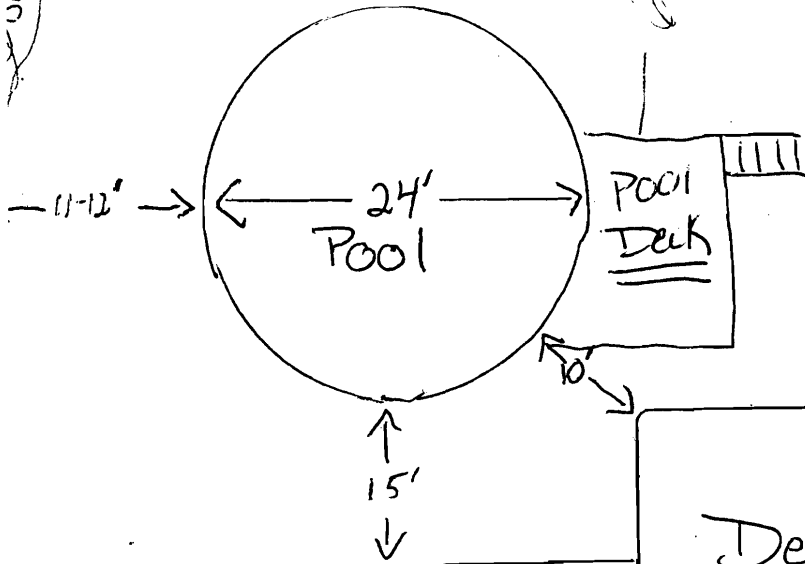

# EASY INCLINE DECK LADDER



**EASY INCLINE DECK LADDER**  
 "Extra high" and "low" positions  
 • Extra high, extra strong, extra wide hand placement and extra grip  
 • Over sized hand holds and side rails  
 • High density structural aluminum alloy  
 350 lbs.

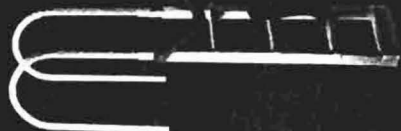

**Pro Series Deck Ladder**  
 "Extra high" and "low" positions  
 • Extra high, extra strong, extra wide hand placement and extra grip  
 • With adjustable side rails and hand holds  
 • High density structural aluminum alloy  
 250 lbs.

This is the  
 Lowly  
 Ladder

David  
 11-09-11