



Double 1-3/4" x 14" VERSA-LAM® 2.0 3100 SP Wall Header\16' OHD HEADER

Dry | 1 span | No cantilevers | 0/12 slope
16-00-00 OCS

November 23, 2015 09:44:27

BC CALC® Design Report



Build 4137

Job Name: PORTLAND GARAGE

Address:

City, State, Zip: ,

Customer:

Code reports: ESR-1040

File Name: BC CALC Project

Description: Designs\16' OHD HEADER

Specifier:

Designer:

Company:

Misc:

Connection Diagram

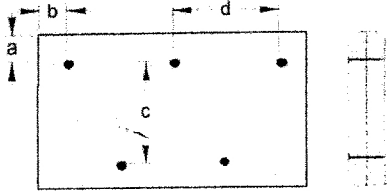

a minimum = 2" c = 10"
b minimum = 3" d = 24"

Member has no side loads.

Connectors are: 16d Sinker Nails

Disclosure

Completeness and accuracy of input must be verified by anyone who would rely on output as evidence of suitability for particular application. Output here based on building code-accepted design properties and analysis methods. Installation of BOISE engineered wood products must be in accordance with current Installation Guide and applicable building codes. To obtain Installation Guide or ask questions, please call (800)232-0788 before installation.

BC CALC®, BC FRAMER®, AJS™, ALLJOIST®, BC RIM BOARD™, BCI®, BOISE GLULAM™, SIMPLE FRAMING SYSTEM®, VERSA-LAM®, VERSA-RIM PLUS®, VERSA-RIM®, VERSA-STRAND®, VERSA-STUD® are trademarks of Boise Cascade Wood Products L.L.C.