

Plan North

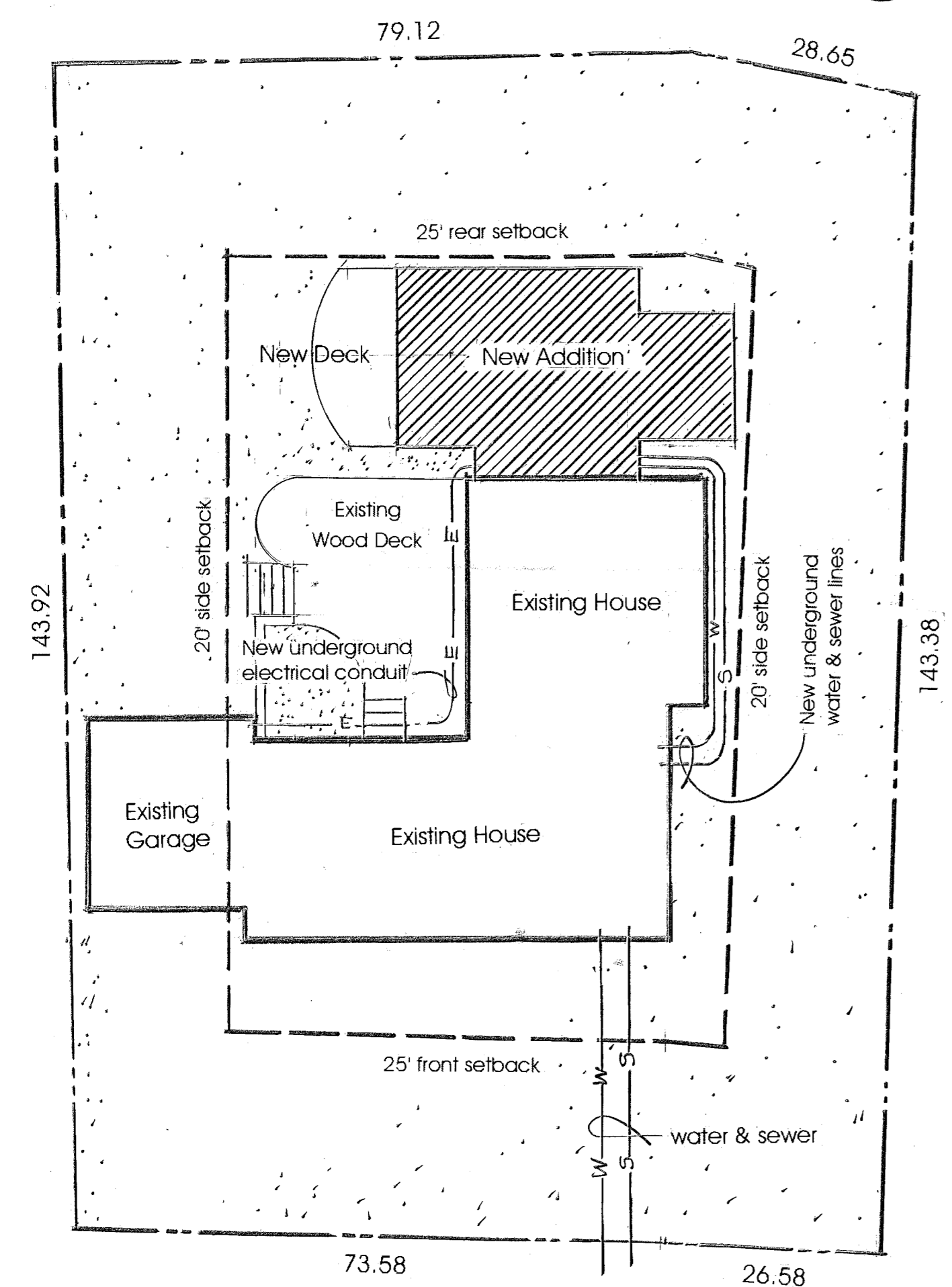
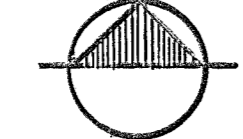

21 Redlon Road

**Site Plan** scale: 1/16" = 1'-0"

- Zoning : R - 3
- Lot Size : 14,814 S.F.
- 35% Max. Lot Coverage : 5,185 S.F.
- Existing House / Garage : 2,736 S.F.
- Existing Deck : 772 S.F.
- Existing Lot Coverage 3,508 S.F. ( 23.7% )
- New Addition : 936 S.F.
- New Deck : 209 S.F.
- New Lot Coverage: 1,145 S.F.
- Total Lot Coverage: 4,653 S.F. ( 31.4% )

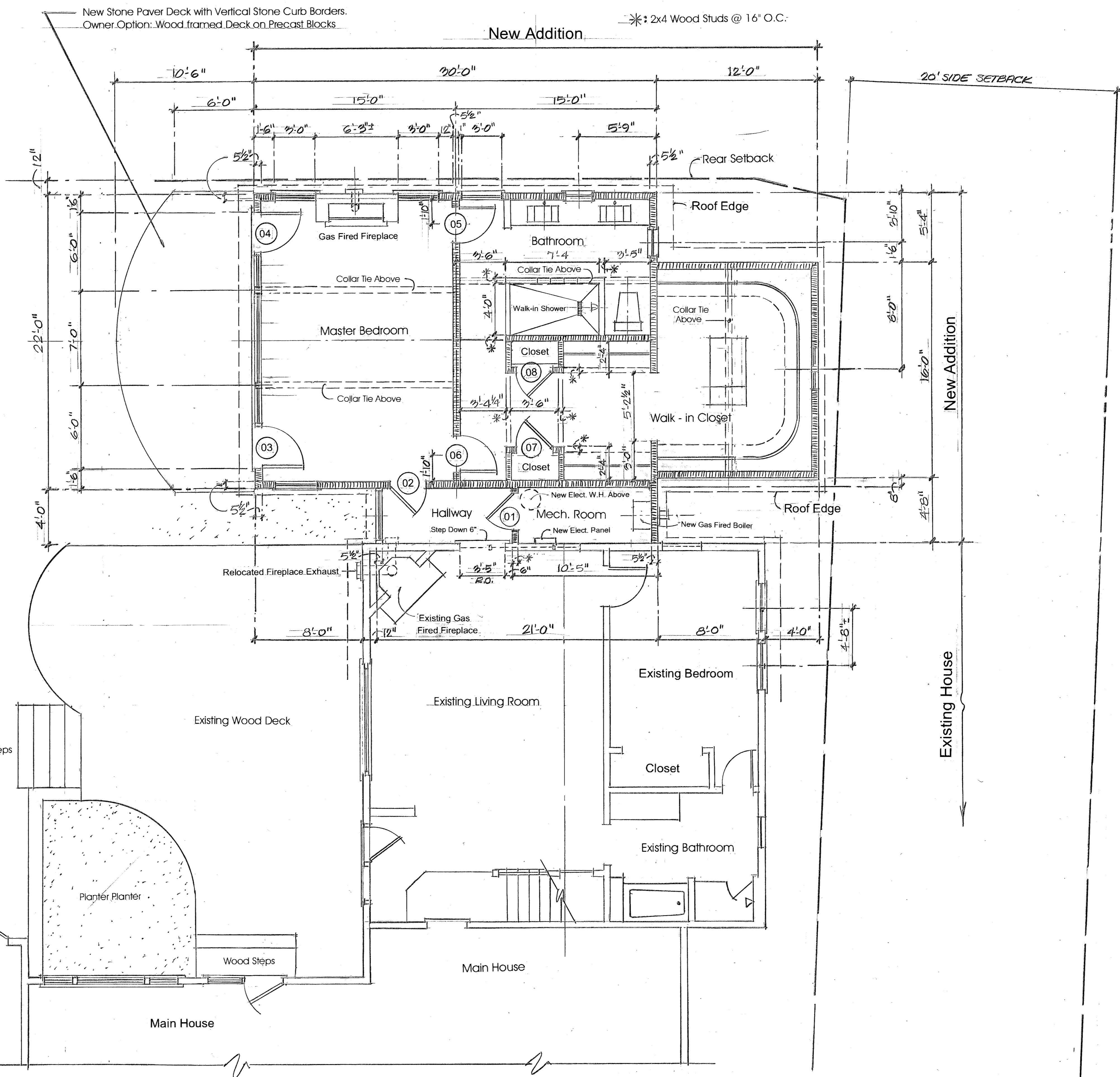

**Floor Plan - New and Partial Existing**

scale: 1/4" = 1'-0"

brian e. duffy  
associates  
architecture to build by  
65 falmouth road  
falmouth, me 04105  
tel: 207-838-9500

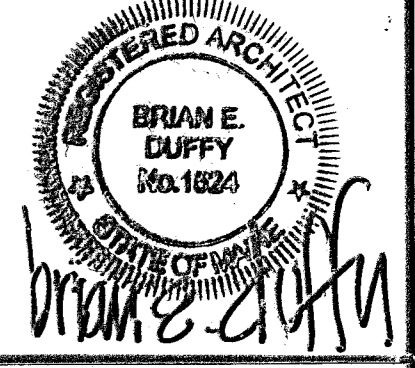

**NEW ADDITION**  
for:  
John and Beth DiMillo  
21 Redlon Road  
Portland, Maine 04012

date : June 13, 2017

drawn by : B. E. DUFFY

scale: AS NOTED

sheet title :  
**FLOOR PLAN  
&  
SITE PLAN**

sheet:  
**A-1**  
OF 3