

PERMIT ISSUED

City of Portland, Maine - Building or Use Permit Application
 389 Congress Street, 04101 Tel: (207) 874-8703, Fax: (207) 874-8716

Permit No: 02-0420 Issue Date: MAY 17 2002
 CBL: 761-0650 176 H012001 X246

Location of Construction: 296 Stevens Ave	Owner Name: Soper Judith M & David A Jts	Owner Address: 296 Stevens Ave CITY OF PORTLAND	Phone: 207-871-8098
Business Name:	Contractor Name: no contractor / self	Contractor Address: Portland	Phone:
Lessee/Buyer's Name	Phone:	Permit Type: Change of Use Home Occupation	Zone: R-5

Past Use: single family	Proposed Use: adding use of "home occupation" produce crafts, no structural change	Permit Fee: \$105.00	Cost of Work: \$0.00	CEO District: 3
----------------------------	--	-------------------------	-------------------------	--------------------

Proposed Project Description: home occupation "produce crafts" (handmade cards - notes etc)	FIRE DEPT: <input type="checkbox"/> Approved <input checked="" type="checkbox"/> Denied N/A	INSPECTION: Use Group: R3 Type: SB BOCA 1999
	Signature:	Signature:

PEDESTRIAN ACTIVITIES DISTRICT (P.A.D.)

Action: Approved Approved w/Conditions Denied

Signature: _____ Date: _____

Permit Taken By: jodinea	Date Applied For: 04/25/2002	Zoning Approval	
-----------------------------	---------------------------------	------------------------	--

1. This permit application does not preclude the Applicant(s) from meeting applicable State and Federal Rules. 2. Building permits do not include plumbing, septic or electrical work. 3. Building permits are void if work is not started within six (6) months of the date of issuance. False information may invalidate a building permit and stop all work..	Special Zone or Reviews <input type="checkbox"/> Shoreland <input type="checkbox"/> Wetland <input type="checkbox"/> Flood Zone <input type="checkbox"/> Subdivision <input type="checkbox"/> Site Plan Maj <input type="checkbox"/> Minor <input type="checkbox"/> MM <input type="checkbox"/> Date: 5/5/02	Zoning Appeal <input type="checkbox"/> Variance <input type="checkbox"/> Miscellaneous <input type="checkbox"/> Conditional Use <input type="checkbox"/> Interpretation <input type="checkbox"/> Approved <input type="checkbox"/> Denied Date:	Historic Preservation <input checked="" type="checkbox"/> Not in District or Landmark <input type="checkbox"/> Does Not Require Review <input type="checkbox"/> Requires Review <input type="checkbox"/> Approved <input type="checkbox"/> Approved w/Conditions <input type="checkbox"/> Denied Date:
--	--	---	--

return to scan!

CERTIFICATION

I hereby certify that I am the owner of record of the named property, or that the proposed work is authorized by the owner of record and that I have been authorized by the owner to make this application as his authorized agent and I agree to conform to all applicable laws of this jurisdiction. In addition, if a permit for work described in the application is issued, I certify that the code official's authorized representative shall have the authority to enter all areas covered by such permit at any reasonable hour to enforce the provision of the code(s) applicable to such permit.

SIGNATURE OF APPLICANT	ADDRESS	DATE	PHONE
RESPONSIBLE PERSON IN CHARGE OF WORK, TITLE		DATE	PHONE

DISPLAY THIS CARD ON PRINCIPAL FRONTAGE OF WORK CITY OF PORTLAND

Please Read
Application And
Notes, If Any,
Attached

BUILDING DEPARTMENT PERMIT

Permit Number: 020420

This is to certify that Soper Judith M & David A J to contract for self

has permission to home occupation "produce c...

AT 296 Stevens Ave 176 H012001

provided that the person or persons, firm or corporation accepting this permit shall comply with all of the provisions of the Statutes of Maine and of the ordinances of the City of Portland regulating the construction, maintenance and use of buildings and structures, and of the application on file in this department.

Apply to Public Works for street line and grade if nature of work requires such information.

Notification of inspection must be given and when permission is procured before this building or part thereof is altered or closed-in. 24 HOUR NOTICE IS REQUIRED.

A certificate of occupancy must be procured by owner before this building or part thereof is occupied.

OTHER REQUIRED APPROVALS

Fire Dept. _____

Health Dept. _____

Appeal Board _____

Other _____
Department Name

Director - Building & Inspection Services

PENALTY FOR REMOVING THIS CARD

Application ID Number: 2-0420

Department: Zoning

Status: Approved with Conditions

Applicant: Marge Schmuckal

Comments: 296 Stevens Ave

Approval Date: 05/16/2002

Issue Date: 05/01/2002

OK to Issue Permit By: Marge Schmuckal Date: 05/16/2002 Page: 3

Conditions Section:

During its existence, all aspects of the Home Occupations criteria, Section 14-410, shall be maintained. There shall be NO retail transactions performed on site.

Separate permits shall be required for any new signage, under the home occupation guidelines.

Create Date: 04/30/2002 By: jodinea Update Date: 05/16/2002 By: mes



... jms creations ...
Portland, Maine

Unique and enjoyable handmade
Cards, announcements, invitations,
Calendars, and other fine gifts.

E-mail: jsoper@maine.rr.com
Phone: (207) 871-8098

is this a home
crafts involved?
left message 5/14/02
4/15/02
voice mail
yes is the
answer
received
4/25/02

April 21, 2002

Marge Schmuckal
Zoning Administrator
Department of Urban Development
City of Portland
389 Congress Street
Portland, Maine 04101

Dear Ms. Schmuckal,

I am requesting a permit to allow me use of my residence at 296 Stevens Avenue for a home occupation. I intend to produce crafts that will be sold in local shops and at craft fairs. In effect, my work will be home crafts, an acceptable home occupation listed as item "b 15" under Section 14-410 of the Portland Zoning Ordinance. The following is an explanation of how my home occupation meets the criteria listed under item "a" of the same Section.

1. My home occupation will occupy approximately 173 square feet (18%) of floor area of the residence.
2. No goods will be stored, displayed, or be visible from outside the residence.
3. Storage of material necessary to perform my occupation is minimal and included in the 173 square feet of floor space listed above.
4. I am not planning to use exterior signage.
5. No exterior alterations to the residence are necessary.
6. No additional parking is necessary, as I will not be selling products from my home.
7. No objectionable effects such as smoke, vibration, or dust will result from my home occupation.
8. I will not require the services of any employees.
9. Since I will not be selling products from my residence, no additional traffic will be generated by my home occupation.
10. No vehicles even nearing a gross vehicle weight of 6,000 pounds are necessary for my home occupation.

As you can see, my home occupation is a secondary and incidental use of my residence. The external activity level and impact is negligible and in keeping with the residential character of the neighborhood.

Attached you will find a copy of a floor plan showing the dimensions and area of home occupation space. Thank you for your assistance in this matter.

Sincerely,

Judy Soper

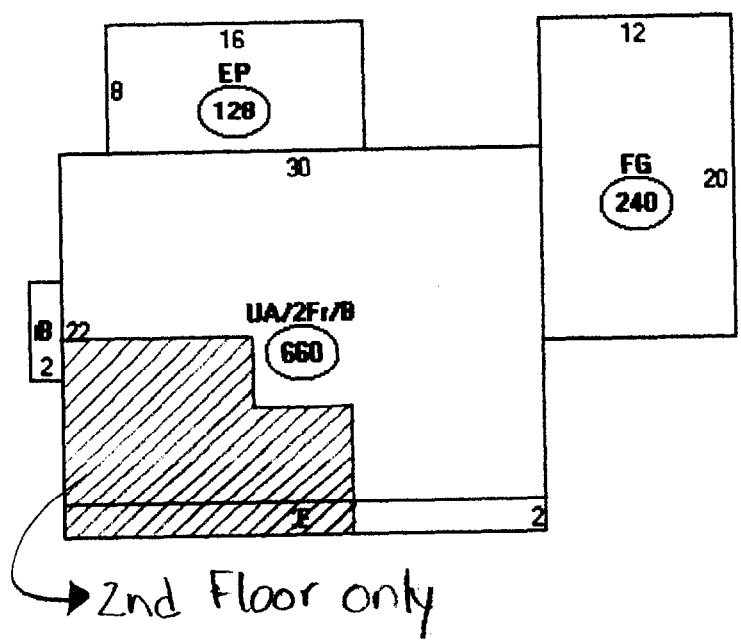

Descriptor/Area

- A: UA/2Fr/B
660 sqft
- B: FBAY
12 sqft
- C: EP
128 sqft
- D: FG
240 sqft
- E: FOH
60 sqft

02-0420

THIS IS NOT A PERMIT; CONSTRUCTION, DEMOLITION, SITE CLEARING OR ALTERATION OF THE SITE CANNOT COMMENCE UNTIL THE PERMIT IS ISSUED.

All Purpose Building Permit Application

If you or the property owner owes real estate or personal property taxes or user charges on any property within the City, payment arrangements must be made before permits of any kind are accepted.

Location/Address of Construction: 296 Stevens Ave., Portland, Me.

Total Square Footage of Proposed Structure: no change
Square Footage of Lot: no change

Tax Assessor's Chart, Block & Lot Number: 176 H 012 001
Owner: Judith M. David A. Soper
Telephone#: 871-8098
Chart#: 176 Block#: H Lot#: 012

Lessee/Buyer's Name (If Applicable):
Owner's/Purchaser/Lessee Address:
Cost Of Work: \$
Fee: \$35.00

Current use: home
If the location is currently vacant, what was prior use:
Approximately how long has it been vacant:
Proposed use:
Project description: Change of Use for a home occupation, to add:
173 Sq Ft to produce Crafts

Contractor's Name, Address & Telephone: N/A
Applicants Name, Address & Telephone:
Who should we contact when the permit is ready:
Telephone:
If you would like the permit mailed, what mailing address should we use:

IF THE REQUIRED INFORMATION IS NOT INCLUDED IN THE SUBMISSIONS THE PERMIT WILL BE AUTOMATICALLY DENIED.
AT THE DISCRETION OF THE BUILDING/PLANNING DEPARTMENT, WE MAY REQUIRE ADDITIONAL INFORMATION IN ORDER TO APPROVE THIS PERMIT.

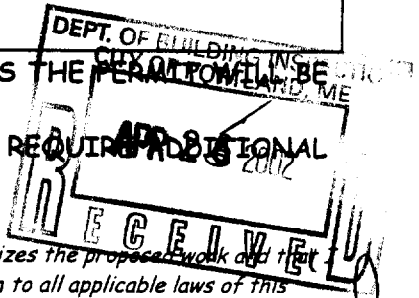

Certification

I hereby certify that I am the Owner of record of the named property, or that the owner of record authorizes the proposed work and that have been authorized by the owner to make this application as his/her authorized agent. I agree to conform to all applicable laws of this jurisdiction. In addition, if a permit for work described in this application is issued, I certify that the Code Official's authorized representative shall have the authority to enter all areas covered by this permit at any reasonable hour to enforce the provisions of the codes applicable to this permit.

Signature of applicant: Judith M Soper Date: 4/11/02

This is an application for change of use only.



Certificate of Occupancy

LOCATION 296 Stevens Ave

CBL 176 H012001

Issued to Soper Judith M & David A Jts/no contractor / self

Date of Issue 05/29/2002

This is to certify that the building, premises, or part thereof, at the above location, built — altered — changed as to use under Building Permit No. 02-0420 , has had final inspection, has been found to conform substantially to requirements of Zoning Ordinance and Building Code of the City, and is hereby approved for occupancy or use, limited or otherwise, as indicated below.

PORTION OF BUILDING OR PREMISES

APPROVED OCCUPANCY

2nd Floor

Home Occupation/Production of Crafts

Limiting Conditions:

This certificate supersedes certificate issued

Approved:

5/29/02
(Date)

[Signature]
Inspector

[Signature] 5/29/02
Inspector of Buildings

[Handwritten mark]

Notice: This certificate identifies lawful use of building or premises, and ought to be transferred from owner to owner when property changes hands. Copy will be furnished to owner or lessee for one dollar.

176-H-012

BUILDING PERMIT INSPECTION PROCEDURES

Please call 874-8703 or 874-8693 to schedule your inspections as agreed upon

Permits expire in 6 months, if the project is not started or ceases for 6 months.

The Owner or their designee is required to notify the inspections office for the following inspections and provide adequate notice. Notice must be called in 48-72 hours in advance in order to schedule an inspection:

874-8703

By initializing at each inspection time, you are agreeing that you understand the inspection procedure and additional fees from a "Stop Work Order" and "Stop Work Order Release" will be incurred if the procedure is not followed as stated below.

DPMS ~~Pre-construction Meeting: Must be scheduled with your inspection team upon receipt of this permit. Jay Reynolds, Development Review Coordinator at 874-8632 must also be contacted at this time, before any site work begins on any project other than single family additions or alterations.~~ N/A

N/A Footing/Building Location Inspection: Prior to pouring concrete

N/A Re-Bar Schedule Inspection: Prior to pouring concrete

N/A Foundation Inspection: Prior to placing ANY backfill

N/A Framing/Rough Plumbing/Electrical: Prior to any insulating or drywalling

Final/Certificate of Occupancy: Prior to any occupancy of the structure or use. NOTE: There is a \$75.00 fee per inspection at this point.

Certificate of Occupancy is not required for certain projects. Your inspector can advise you if your project requires a Certificate of Occupancy. All projects DO require a final inspection

DPMS If any of the inspections do not occur, the project cannot go on to the next phase, REGARDLESS OF THE NOTICE OR CIRCUMSTANCES.

DPMS CERTIFICATE OF OCCUPANCIES MUST BE ISSUED AND PAID FOR, BEFORE THE SPACE MAY BE OCCUPIED

Matthew Lopez
Signature of applicant/designee

5/21/02
Date

[Signature]
Signature of Inspections Official

5/21/02
Date

CBL: 176-H-012 Building Permit #: 011-0400