

SCALE: 1/4" = 1' WHEN PRINTED ON 11X17 PAPER

BASED ON THE INTERNATIONAL RESIDENTIAL CODE

STAIR FOOTING REQUIREMENTS  
WHERE THE STAIRWAY MEETS GRADE, ATTACH THE STAIR  
STRINGERS TO THE STAIR GUARD RAIL POSTS. POSTS SHALL  
BEAR ON FOOTINGS

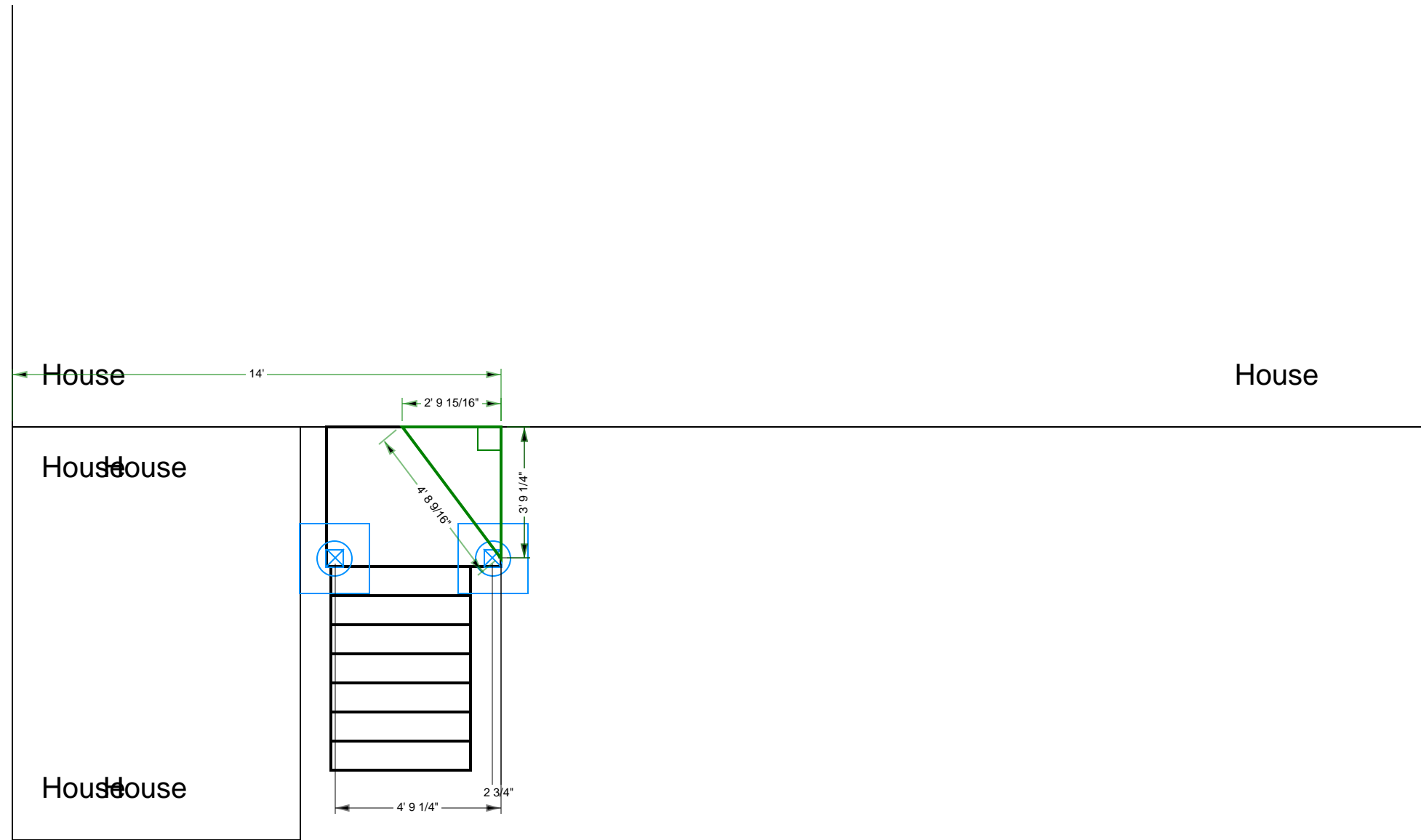

Footings to be installed to 48" depth as is required by your local building ordinance.  
Frost footing sizes based on 55 lbs per square foot tributary loads applied to 1500 psi soil compression capacity



Total Depth: 48  
Base Diameter: 24  
Pier Diameter: 8"

Footings to be installed to 48" depth as is required by your local building ordinance.  
Frost footing sizes based on 55 lbs per square foot tributary loads applied to 1500 psi soil compression capacity (assumed clay soil).  
See footing detail in deck construction guide.

DISCLAIMER: USE ONLY 2,500 PSI CONCRETE FOR FROST FOOTING FOUNDATIONS.

