

COPY

THIS IS NOT A BOUNDARY SURVEY

MORTGAGE INSPECTION OF: DEED BOOK 9312 PAGE 313 COUNTY Cumberland
PLAN BOOK --- PAGE --- LOT ---

ADDRESS: 435 Woodford Street, Portland, Maine

Job Number: 263-49

Inspection Date: 11-30-99

Buyers: Edward & Sarah Leonard

Scale: 1" = 20'

Seller: Rose Marasco

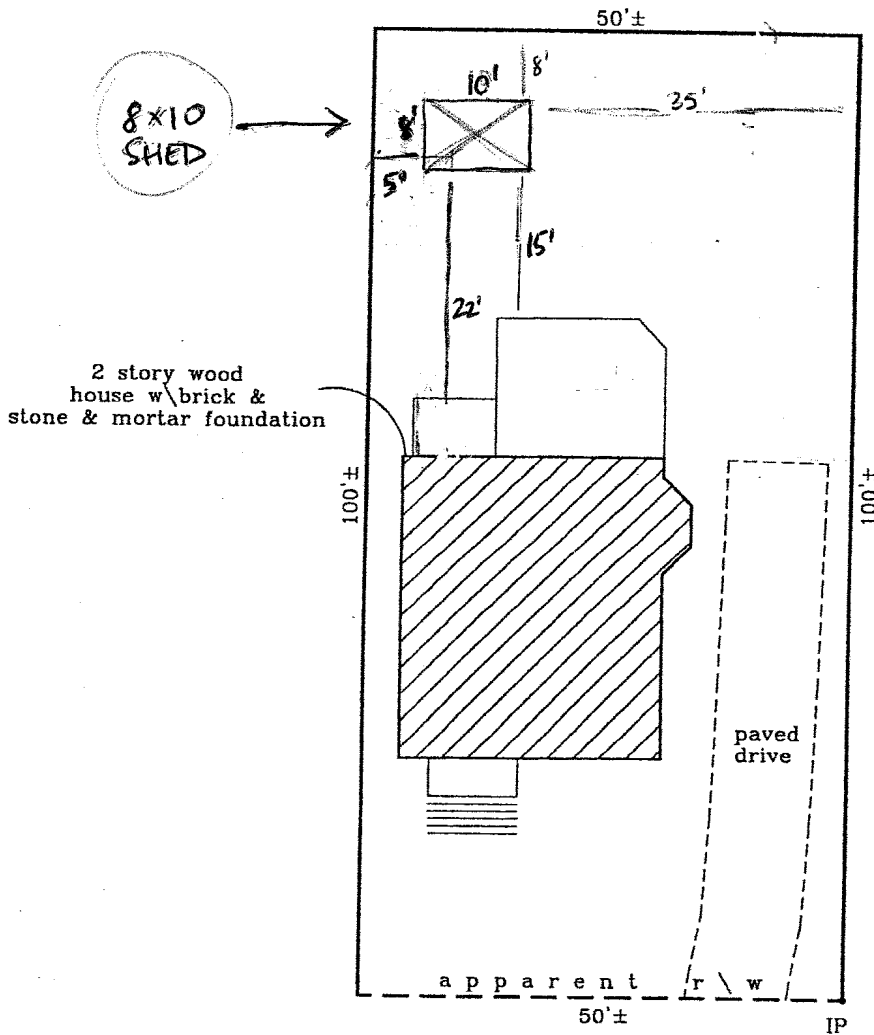

Woodford Street

[Handwritten signature]

I HEREBY CERTIFY TO: Hopkinson & Abbondanza, P. A., the Lender,
and its title insurer.

- Monuments found did not conflict with the deed description.
- The dwelling setbacks do not violate town zoning requirements.
- As delineated on the Federal Emergency Management Agency Community Panel :
- The structure does not fall within the special flood hazard zone.
- The land does not fall within the special flood hazard zone.
- A wetlands study has not been performed.

APPARENT EASEMENTS AND RIGHTS OF WAY ARE SHOWN. OTHER ENCUMBRANCES, RECORDED OR NOT, MAY EXIST. THIS SKETCH WILL NOT REVEAL ABUTTING DEED CONFLICTS, IF ANY.

copyright © 1994

Livingston - Hughes
Professional Land Surveyors & Foresters
88 Guinea Road
Kennebunkport - Maine 04046
207-967-9761 phone 207-967-4831 fax

THIS SKETCH IS FOR MORTGAGE PURPOSES ONLY