

DISPLAY THIS CARD ON PRINCIPAL FRONTAGE OF WORK CITY OF PORTLAND

BUILDING INSPECTION

PERMIT

Please Read Application And Notes, If Any, Attached

Permit Number: 070690
PERMIT ISSUED
JUN 20 2007
CITY OF PORTLAND

This is to certify that RUTHENBURG CLARE S. DAVID A COBB ITS/Joel Folsom
has permission to New door, window and exterior and exterior stairs
AT 34 CALDWELL ST City of Portland 176 B021001

provided that the person or persons, firm or corporation accepting this permit shall comply with all of the provisions of the Statutes of Maine and of the Ordinances of the City of Portland regulating the construction, maintenance and use of buildings and structures, and of the application on file in this department.

Apply to Public Works for street line and grade if nature of work requires such information.

Notification of inspection must be given and when permission procured before this building or part thereof is placed or closed-in. **24 HOUR NOTICE IS REQUIRED.**

A certificate of occupancy must be procured by owner before this building or part thereof is occupied.

OTHER REQUIRED APPROVALS

Fire Dept. _____
Health Dept. _____
Appeal Board _____
Other _____
Department Name

6/19/07 *Cheryl M*
Director - Building & Inspection Services

PENALTY FOR REMOVING THIS CARD

City of Portland, Maine - Building or Use Permit Application

389 Congress Street, 04101 Tel: (207) 874-8703, Fax: (207) 874-8716

Permit No: 07-0690	Issue Date:	CBL: 176 B021001
-----------------------	-------------	---------------------

Location of Construction: 34 CALDWELL ST	Owner Name: RUTHENBURG CLARE S & DAV	Owner Address: 34 CALDWELL ST	Phone:
Business Name:	Contractor Name: Joe Folsom	Contractor Address: 12 Raymond Raymond	Phone 2078311378
Lessee/Buyer's Name	Phone:	Permit Type: Alterations - Dwellings	Zone: R-5

Past Use: Single Family	Proposed Use: Single Family New door window and exterior stairs	Permit Fee:	Cost of Work: 1,000.00	CEO District: 3
Proposed Project Description: New door, window and exterior and exterior stairs		FIRE DEPT: <input type="checkbox"/> Approved <input type="checkbox"/> Denied	INSPECTION: Use Group: R-3 Type: SB IRC-2003	
		Signature: 6/19/07 CLRL		
		PEDESTRIAN ACTIVITIES DISTRICT (P.A.D.) Action: <input type="checkbox"/> Approved <input type="checkbox"/> Approved w/Conditions <input type="checkbox"/> Denied Signature: Date:		

Permit Taken By: dmartin	Date Applied For: 06/13/2007	Zoning Approval
-----------------------------	---------------------------------	------------------------

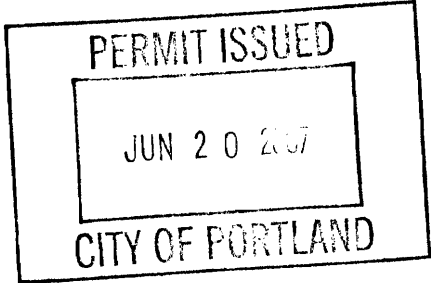
<ol style="list-style-type: none"> This permit application does not preclude the Applicant(s) from meeting applicable State and Federal Rules. Building permits do not include plumbing, septic or electrical work. Building permits are void if work is not started within six (6) months of the date of issuance. False information may invalidate a building permit and stop all work.. 	Special Zone or Reviews <input type="checkbox"/> Shoreland <input type="checkbox"/> Wetland <input type="checkbox"/> Flood Zone <input type="checkbox"/> Subdivision <input type="checkbox"/> Site Plan Maj <input type="checkbox"/> Minor <input type="checkbox"/> MM <input type="checkbox"/> Date:	Zoning Appeal <input type="checkbox"/> Variance <input type="checkbox"/> Miscellaneous <input type="checkbox"/> Conditional Use <input type="checkbox"/> Interpretation <input type="checkbox"/> Approved <input type="checkbox"/> Denied Date:	Historic Preservation <input type="checkbox"/> Not in District or Landmark <input type="checkbox"/> Does Not Require Review <input type="checkbox"/> Requires Review <input type="checkbox"/> Approved <input type="checkbox"/> Approved w/Conditions <input type="checkbox"/> Denied Date:
			

CERTIFICATION

I hereby certify that I am the owner of record of the named property, or that the proposed work is authorized by the owner of record and that I have been authorized by the owner to make this application as his authorized agent and I agree to conform to all applicable laws of this jurisdiction. In addition, if a permit for work described in the application is issued, I certify that the code official's authorized representative shall have the authority to enter all areas covered by such permit at any reasonable hour to enforce the provision of the code(s) applicable to such permit.

SIGNATURE OF APPLICANT	ADDRESS	DATE	PHONE
RESPONSIBLE PERSON IN CHARGE OF WORK, TITLE		DATE	PHONE

City of Portland, Maine - Building or Use Permit

389 Congress Street, 04101 Tel: (207) 874-8703, Fax: (207) 874-8716

Permit No: 07-0690	Date Applied For: 06/13/2007	CBL: 176 B021001
-----------------------	---------------------------------	---------------------

Location of Construction: 34 CALDWELL ST	Owner Name: RUTHENBURG CLARE S & DAV	Owner Address: 34 CALDWELL ST	Phone:
Business Name:	Contractor Name: Joe Folsom	Contractor Address: 12 Raymond Raymond	Phone (207) 831-1378
Lessee/Buyer's Name	Phone:	Permit Type: Alterations - Dwellings	

Proposed Use: Single Family New door window and exterior stairs	Proposed Project Description: New door, window and exterior and exterior stairs
--	--

Dept: Zoning **Status:** Approved with Conditions **Reviewer:** Chris Hanson **Approval Date:** 06/19/2007

Note: **Ok to Issue:**

- 1) As discussed during the review process, the property must be clearly identified prior to pouring concrete and compliance with the required setbacks must be established. Due to the proximity of the setbacks of the proposed addition, it may be required to be located by a surveyor.
- 2) This permit is being approved on the basis of plans submitted. Any deviations shall require a separate approval before starting that work.

Dept: Building **Status:** Approved with Conditions **Reviewer:** Chris Hanson **Approval Date:** 06/19/2007

Note: **Ok to Issue:**

- 1) Permit approved based on the plans submitted and reviewed w/owner/contractor, with additional information as agreed on and as noted on plans.
- 2) Fastener schedule per the IRC 2003

Comments:

6/13/2007-csh: Needs to change layout of stairs to be code compliant CSH called joe 6/13/07

34 CALDWELL ST
PORTLAND, ME

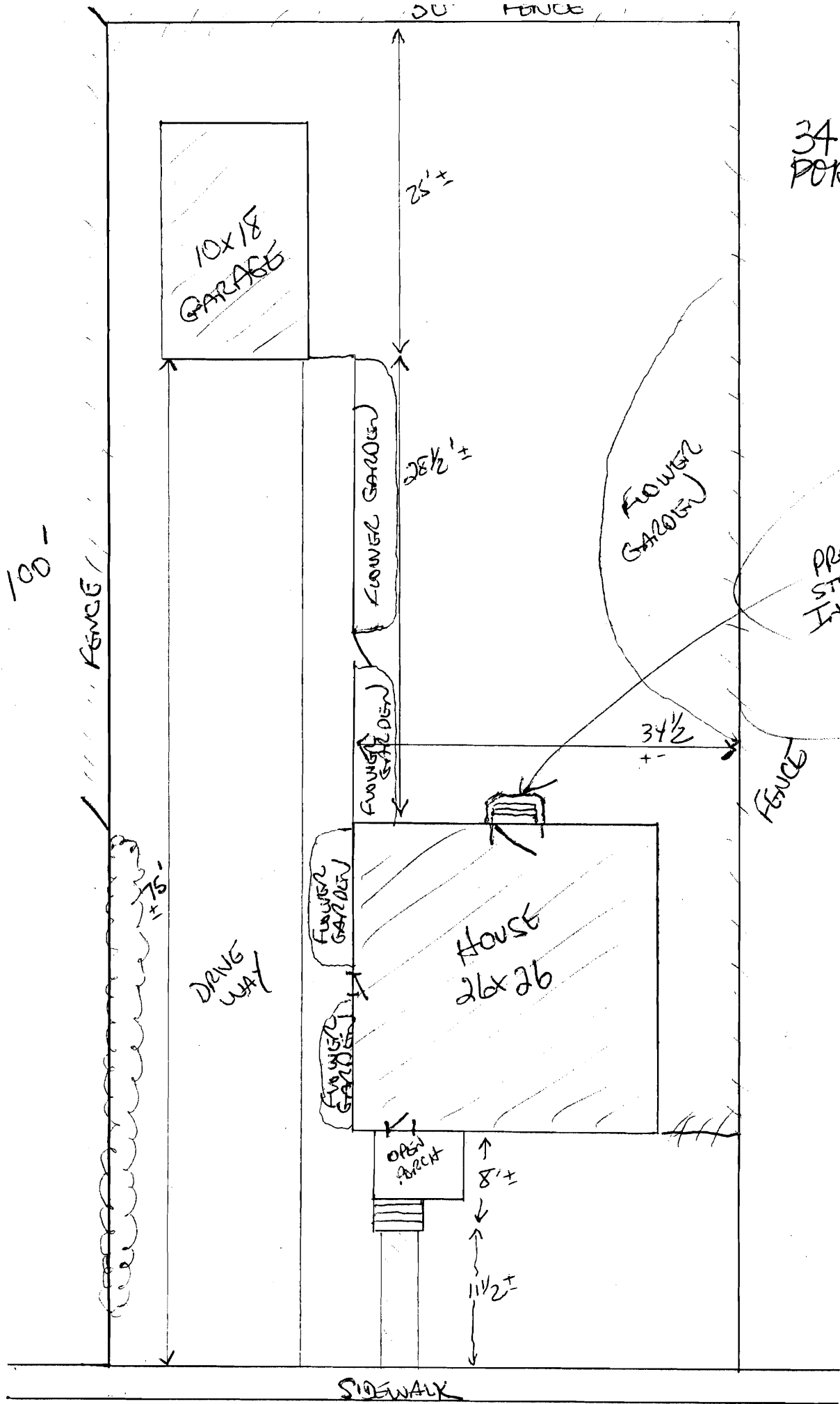

100'

FENCE

20' FENCE

10x18
GARAGE

25'±

FLOWER GARDEN

28 1/2'±

FLOWER GARDEN

PROPOSED STEPS FROM INSTALLED DOOR

FLOWER GARDEN

34 1/2'±

FENCE

DRIVE WAY

FLOWER GARDEN

FLOWER GARDEN

House
26x26

OPEN PORCH

8'±

11 1/2'±

SIDEWALK

ATTN. CHRIS HANSON

FAX # 874-8949

RE. RUTHENBURG
34 COLDWELL ST.

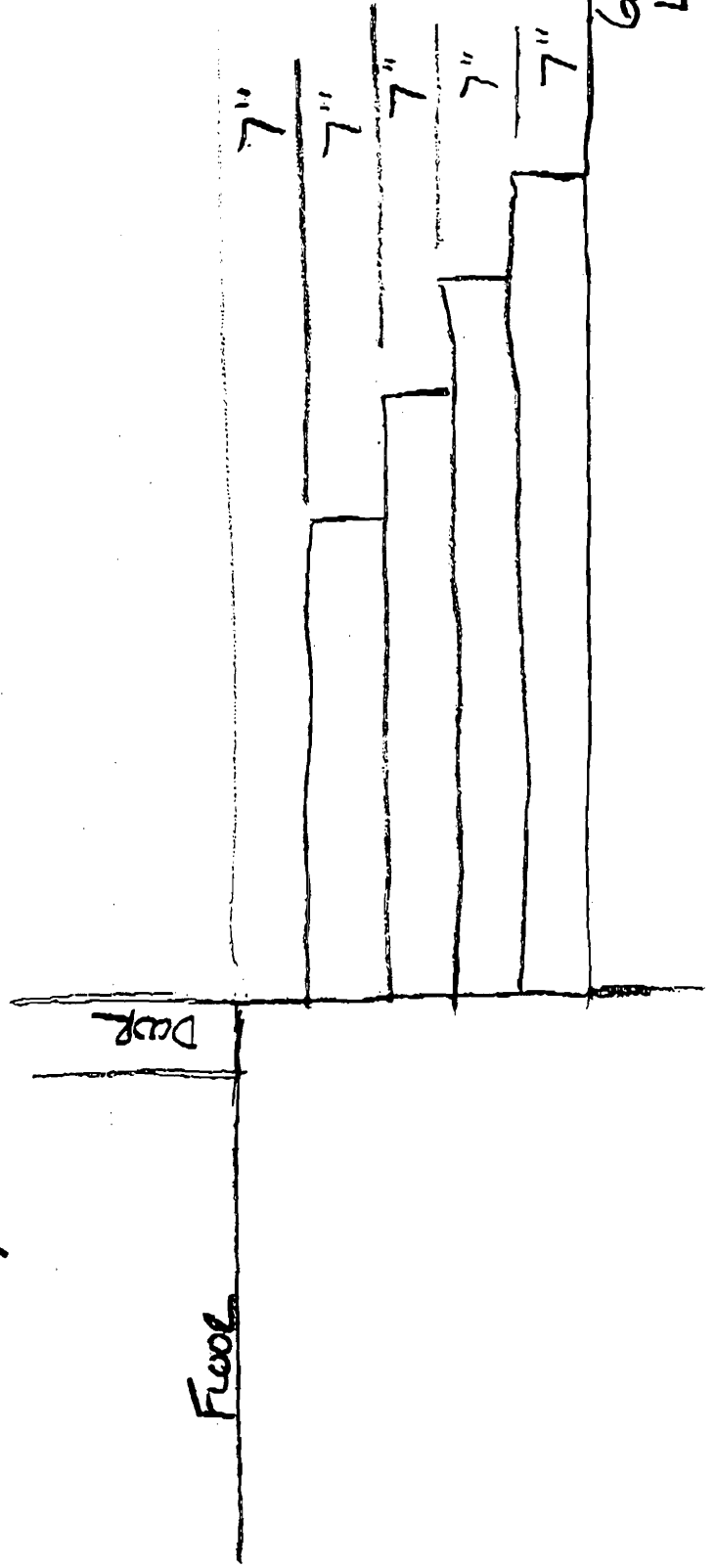
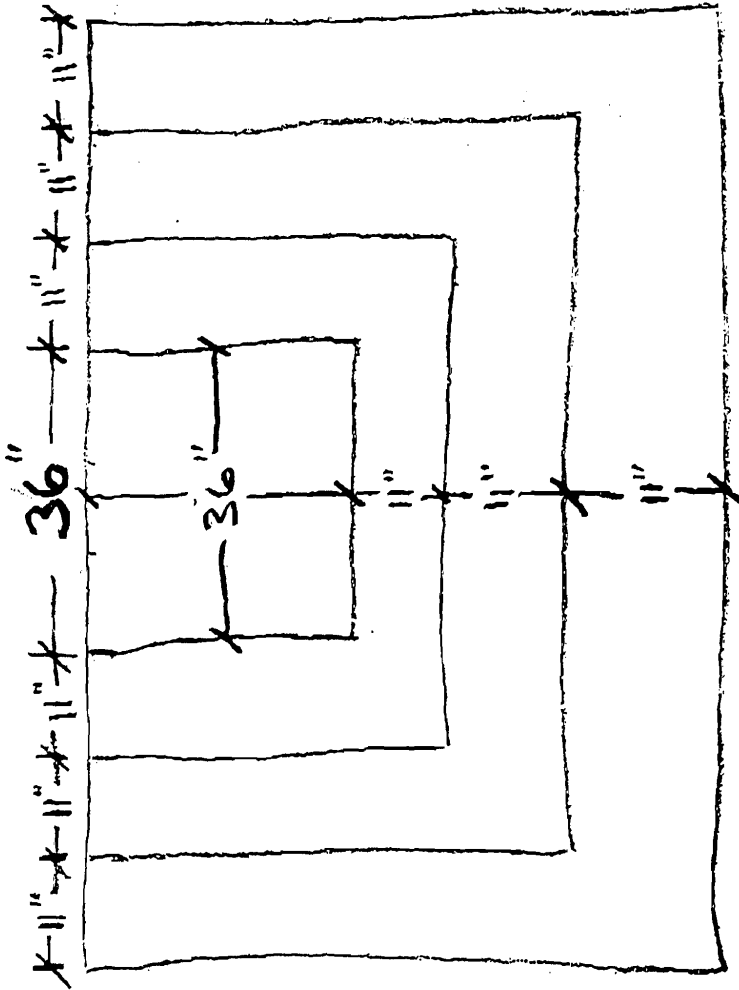

ATTN: TAMMY MUNSON (INSPECTIONS)

RE: WILL THIS DESIGN WORK WITHOUT RAILS?

PLEASE CONTACT JOE FOLSOM

831-1378

34 CAUDWELL ST. PORTLAND

FAX# 874-8949

DOOR SILL
36" X 36" Platform

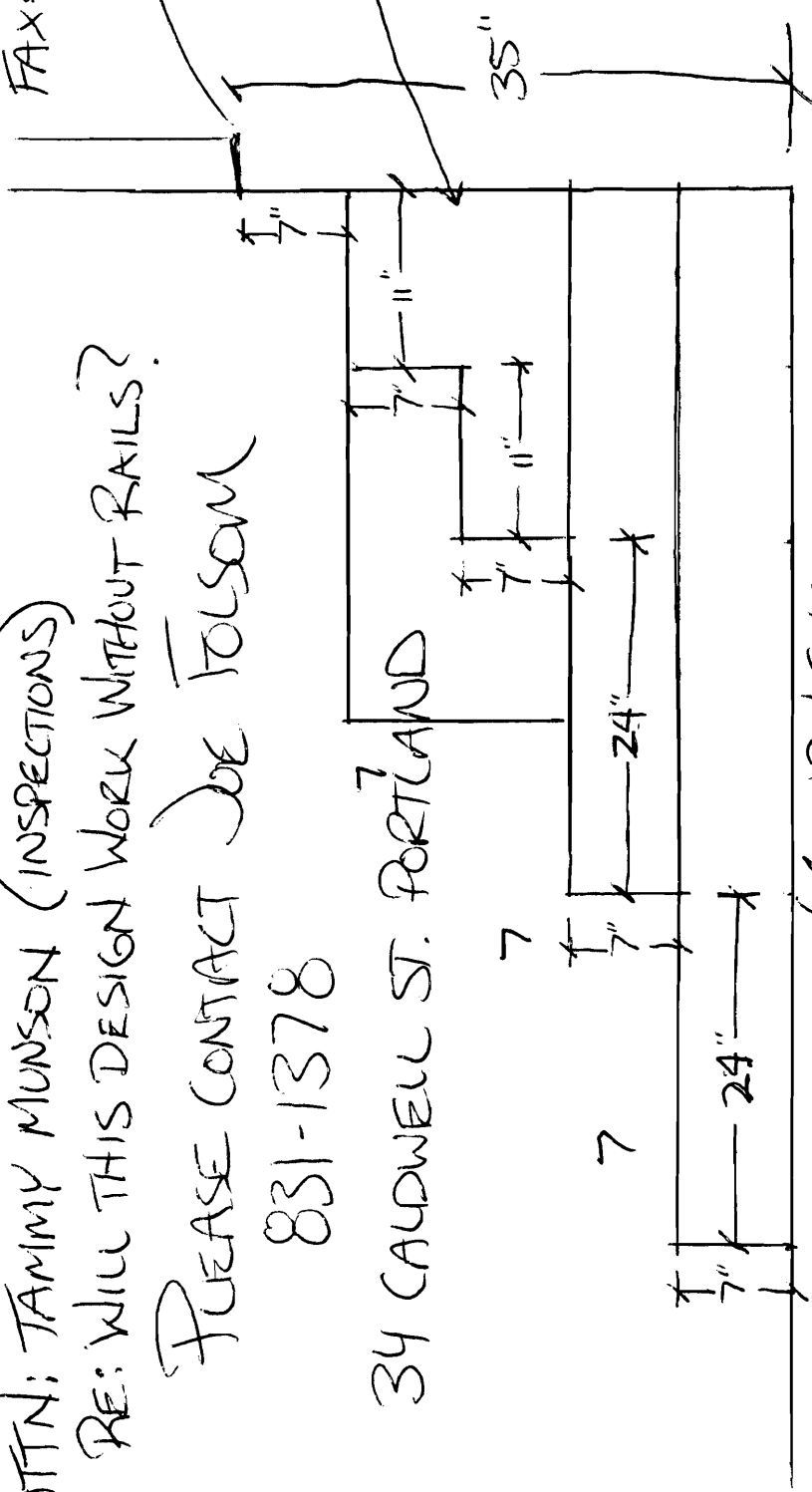

TWO STEPS

DOOR

PLATFORM

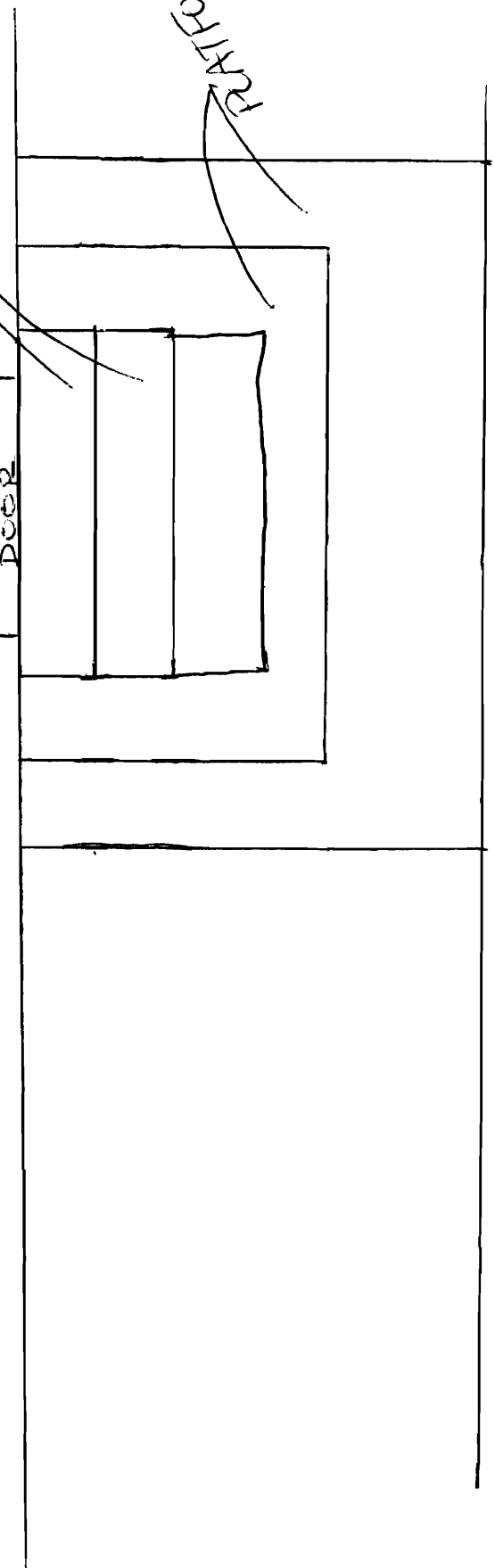

CLARE & DAVID RUTHEBURG
34 CALDWELL ST. PORTLAND

PLEASE CONTACT JOE FOULSON
@ 831-1378 WITH ANY QUESTIONS

• INSTALLING NEW EXTERIOR DOOR

Andersen® single panel hinged patio doors have one panel that swings in or out.

Series

Model



400 Series Frenchwood® Hinged
Patio Door ▲

Interior Finishes:



Exterior Colors:



with Stormwatch™
protection

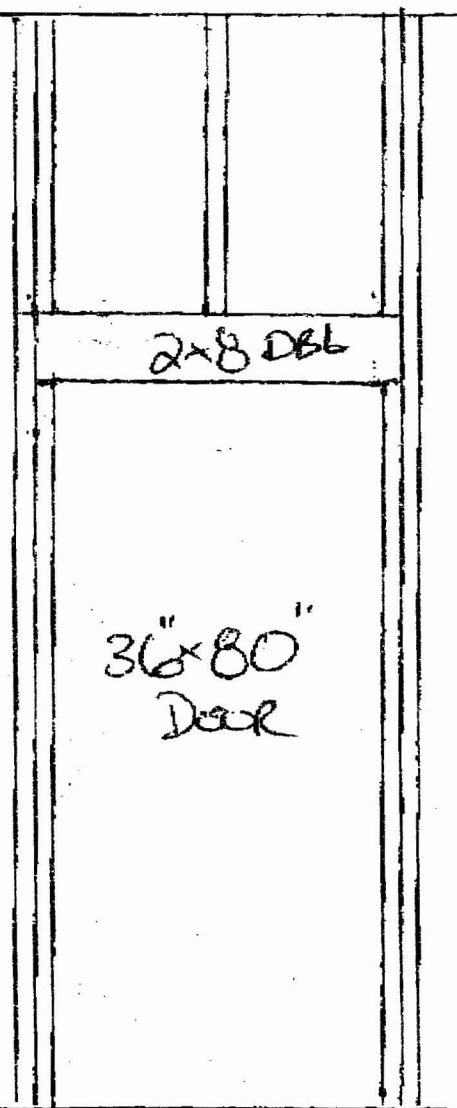

June 13, 2007

Dear City Hall Friends,

My husband is delivering our building permit application this a.m. Is it possible to meet with Chris Hanson late today or sometime after noon tomorrow? (or between 8-9 a.m.?)

I will call this a.m. or I may be reached at Lyeth School (874-8215). I spoke with Tammy Munson at the office on Monday & she felt this plan was worthy of being submitted.

THANKS SO MUCH FOR YOUR HELP!

Sincerely,

Clare S. Puthenburg

Please call our contractor, Joe Folsom, with any questions. Cell 831-1378



Permitting By Appointment

As part of Portland's city-wide effort to improve customer service and help streamline doing business within the City, the Inspections Division has developed a new permitting system for qualified properties and for specific construction projects. Under this new program, you may be eligible to receive a building permit on the day you have a scheduled appointment with Inspection staff.

This permitting program applies only to existing one and two family homes not located within a historic district or shore land zone.

Eligible Projects

Please submit a complete application with the required plans

- Interior renovations, gut rehabs including structural changes
- Attached and detached garages
- Additions, decks, sheds, pools, dormers (two family addition must be less than 500 s.f.)
- Rebuild of any exterior structure ^{deck/steps} listed above

Inspections are still required per City Code of Ordinance.

In order to be sure the City fully understands the full scope of the project, the Planning and Development Department may request additional information prior to the issuance of a permit. For further information visit us on-line at www.portlandmaine.gov, stop by the Building Inspections office, room 315 City Hall or call 874-8703.

I hereby certify that this project meets the above criteria and that the work performed will not go beyond these parameters.

Signature of applicant: <i>Christina Anthony</i>	Date: <i>6/13/07</i>
--	----------------------

This is not a permit; you may not commence ANY work until the permit is issued.