

DISPLAY THIS CARD ON PRINCIPAL FRONTAGE OF WORK



CITY OF PORTLAND

BUILDING PERMIT

This is to certify that SPENCER B BEAN

Located At 22 CALDWELL ST

Job ID: 2012-03-3635-ALTR

CBL: 176- B-018-001

2012-42547-DEMO

has permission to Demolition of existing 10 x 18 foot Garage (Single Family Residence).

provided that the person or persons, firm or corporation accepting this permit shall comply with all of the provisions of the Statutes of Maine and of the Ordinances of the City of Portland regulating the construction, maintenance and use of the buildings and structures, and of the application on file in the department.

Notification of inspection and written permission procured before this building or part thereof is lathed or otherwise closed-in. 48 HOUR NOTICE IS REQUIRED.

A final inspection must be completed by owner before this building or part thereof is occupied. If a certificate of occupancy is required, it must be

04/11/2012

Fire Prevention Officer

Code Enforcement Officer / Plan Reviewer

THIS CARD MUST BE POSTED ON THE STREET SIDE OF THE PROPERTY
PENALTY FOR REMOVING THIS CARD

BUILDING PERMIT INSPECTION PROCEDURES

Please call 874-8703 or 874-8693 (ONLY)

or email: buildinginspections@portlandmaine.gov

With the issuance of this permit, the owner, builder or their designee is required to provide adequate notice to the city of Portland Inspections Services for the following inspections. Appointments must be requested 48 to 72 hours in advance of the required inspection. The inspection date will need to be confirmed by this office.

- **Please read the conditions of approval that is attached to this permit!! Contact this office if you have any questions.**
 - **Permits expire in 6 months. If the project is not started or ceases for 6 months.**
 - **If the inspection requirements are not followed as stated below additional fees may be incurred due to the issuance of a "Stop Work Order" and subsequent release to continue.**
1. Pre-Demolition
 2. See Inspection Requirements under Permit # 2012-03-3635-ALTR

The project cannot move to the next phase prior to the required inspection and approval to continue, REGARDLESS OF THE NOTICE OF CIRCUMSTANCES.

IF THE PERMIT REQUIRES A CERTIFICATE OF OCCUPANCY, IT MUST BE PAID FOR AND ISSUED TO THE OWNER OR DESIGNEE BEFORE THE SPACE MAY BE OCCUPIED.



PORTLAND MAINE

Strengthening a Remarkable City, Building a Community for Life • www.portlandmaine.gov

Acting Director of Planning and Urban Development
Gregory Mitchell

Job ID: 2012-03-3635-ALTR

Located At: 22 CALDWELL ST

CBL: 176- B-018-001

Conditions of Approval:

Zoning

1. Your present structure is legally nonconforming as to setbacks. If you are to demolish this structure on your own volition, you will only have one (1) year to replace it in the same footprint (no expansions), with the same height, and same use. Any changes to any of the above shall require that this structure meet the current zoning standards. The one (1) year starts at the time of removal. It shall be the owner's responsibility to contact the Code Enforcement Officer and notify them of that specific date.
2. This property shall remain a single family dwelling. Any change of use shall require a separate permit application for review and approval.

Building

1. Application approval based upon information provided by applicant. Any deviation from approved plans requires separate review and approval prior to work.
2. Demolition permits are valid for a period of 30 days from the date of issuance. A written request must be submitted and granted for an extension to this time period. Dust prevention shall be controlled per Chapter 6 of the Municipal Ordinance and demolition per Section 3303 of the IBC 2009 (MUBEC).

City of Portland, Maine - Building or Use Permit Application

389 Congress Street, 04101 Tel: (207) 874-8703, FAX: (207) 8716

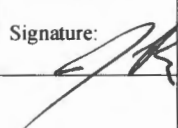
Job No: 2012-03-3635-ALTR 2012-42547-DEMO	Date Applied: 4/4/2012	CBL: 176- B-018-001	
Location of Construction: 22 CALDWELL ST	Owner Name: SPENCER B BEAN	Owner Address: 22 CALDWELL ST PORTLAND, ME 04103	Phone: 207-329-8910
Business Name:	Contractor Name: Owner	Contractor Address:	Phone:
Lessee/Buyer's Name:	Phone:	Permit Type: BLDG - Demo	Zone: R-5
Past Use: Single family	Proposed Use: Same -Single family – demolish existing 10' x 18' shed/garage – rebuild under job#2012-03-3635	Cost of Work: 5000.000000	CEO District:
		Fire Dept: <input type="checkbox"/> Approved <input type="checkbox"/> Denied <input type="checkbox"/> N/A Signature:	Inspection: Use Group: R3 Type: ✓ MUBEC Signature: 
Proposed Project Description: demo 10' x 18' shed		Pedestrian Activities District (P.A.D.)	
Permit Taken By:		Zoning Approval	

	Special Zone or Reviews	Zoning Appeal	Historic Preservation
1. This permit application does not preclude the Applicant(s) from meeting applicable State and Federal Rules. 2. Building Permits do not include plumbing, septic or electrical work. 3. Building permits are void if work is not started within six (6) months of the date of issuance. False informatin may invalidate a building permit and stop all work.	<input type="checkbox"/> Shoreland <input type="checkbox"/> Wetlands <input type="checkbox"/> Flood Zone <input type="checkbox"/> Subdivision <input type="checkbox"/> Site Plan ___ Maj ___ Min ___ MM Date: 04/04/12 <i>ABU</i>	<input type="checkbox"/> Variance <input type="checkbox"/> Miscellaneous <input type="checkbox"/> Conditional Use <input type="checkbox"/> Interpretation <input type="checkbox"/> Approved <input type="checkbox"/> Denied Date:	<input checked="" type="checkbox"/> Not in Dist or Landmark <input type="checkbox"/> Does not Require Review <input type="checkbox"/> Requires Review <input type="checkbox"/> Approved <input type="checkbox"/> Approved w/Conditions <input type="checkbox"/> Denied Date: <i>AGM</i>

CERTIFICATION

I hereby certify that I am the owner of record of the named property, or that the proposed work is authorized by the owner of record and that I have been authorized by the owner to make this application as his authorized agent and I agree to conform to all applicable laws of this jurisdiction. In addition, if a permit for work described in the appication is issued, I certify that the code official's authorized representative shall have the authority to enter all areas covered by such permit at any reasonable hour to enforce the provision of the code(s) applicable to such permit.

SIGNATURE OF APPLICANT	ADDRESS	DATE	PHONE
RESPONSIBLE PERSON IN CHARGE OF WORK, TITLE		DATE	PHONE

4-10-12 DWM Spencer 329-8910 Pre Demo OK
no utilities

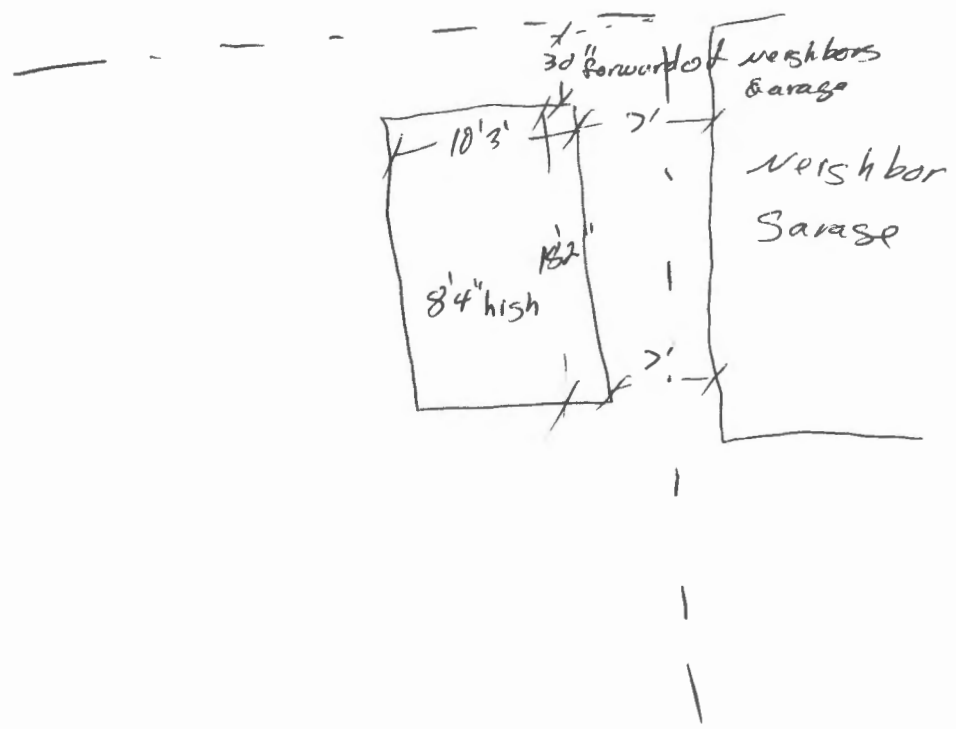



Demolition of a Structure Permit Application

Entered 4/4/12 (B)

See 2012-03-3685-ALTR Child 2012-42547
If you or the property owner owes real estate or personal property taxes or user charges on any property within the City, payment arrangements must be made before permits of any kind are accepted.

Location/Address of Construction: <u>22 CALDWELL ST.</u>		
Total Square Footage of Proposed Structure <u>180 SF</u>	Square Footage of Lot: <u>5000 SF</u>	
Tax Assessor's Chart, Block & Lot: Chart# Block# Lot# <u>176 B018</u>	Owner: <u>Spencer Bean</u>	Telephone: <u>329-8910</u>
Lessee/Buyer's Name (If Applicable)	Applicant name, address & telephone: <u>22 Caldwell St Portland, ME 04103</u>	Cost Of Work: <u>\$1000.-</u> Fee: \$ _____
Current legal use: (i.e. garage, warehouse) <u>shed/garage</u> If vacant, what was the previous use? _____ How long has it been vacant? _____		
Project description: <u>Demo Failing Existing shed/garage</u> permit 2012-03-3685 to demol.		
Contractor's name, address & telephone: <u>Spencer Bean 22 Caldwell St Portland ME 04103</u>		
Who should we contact when the permit is ready : _____ Mailing address: <u>22 Caldwell St.</u> Telephone: <u>329-8910</u>		

Electronic files in pdf format are also required

RECEIVED

Please submit all of the information outlined in the Demolition call list. Failure to do so will result in the automatic denial of your permit.

In order to be sure the City fully understands the full scope of the project, the Planning and Development Department may request additional information prior to the issuance of a permit. For further information or to download copies of this form and other applications visit the Inspections Division on-line at www.portlandmaine.gov, or stop by the Inspections Division office, room 315 City Hall or call 874-8703.

I hereby certify that I am the Owner of record of the named property, or that the owner of record authorizes the proposed work and that I have been authorized by the owner to make this application as his/her authorized agent. I agree to conform to all applicable laws of this jurisdiction. In addition, if a permit for work described in this application is issued, I certify that the Code Official's authorized representative shall have the authority to enter all areas covered by this permit at any reasonable hour to enforce the provisions of the codes applicable to this permit.

Signature of applicant: _____	Date: _____
-------------------------------	-------------

This is not a permit; you may not commence ANY work until the permit is issued.



PORTLAND MAINE

Strengthening a Remarkable City, Building a Community for Life • www.portlandmaine.gov

Receipts Details:

Tender Information: Check , Check Number: 1243

Tender Amount: 30.00

Receipt Header:

Cashier Id: bsaucier

Receipt Date: 4/4/2012

Receipt Number: 42548

Receipt Details:

Referance ID:	5947	Fee Type:	UI-MI
Receipt Number:	0	Payment Date:	
Transaction Amount:	30.00	Charge Amount:	30.00
Job ID: Job ID: 2012-03-3635-ALTR - shed replacement 12' x 24'			
Additional Comments: 22 Caldwell demo			

Thank You for your Payment!



Demolition Call List & Requirements

Site Address: 22 Caldwell St.

Owner: Spencer Bean

Structure Type: Shed/Garage

Contractor: Spencer Bean

Utility Approvals	Number	Contact Name/Date
Central Maine Power	1-800-750-4000/0	<u>Coleen / 3/29/12</u>
Unitil	1-207-541-2533	<u>Berbra / 3/29/12</u>
Portland Water District	761-8310	<u>Alisa / 3/29/12</u>
Dig Safe	1-888-344-7233	<u>Cathy / 3/29/12 #20121308511</u>

After calling Dig Safe, you must wait 72 business hours before digging can begin.

DPW/ Traffic Division (L. Cote)	874-8891	<u>N/A</u>
DPW/ Sealed Drain Permit (C. Merritt)	874-8822	<u>N/A</u>
Historic Preservation	874-8726	<u>N/A</u>
DEP – Environmental (Augusta)	287-2651	<u>N/A</u>

Additional Requirements

- 1) Written notice to adjoining owners *(Included)*
- 2) A photo of the structure(s) to be demolished *(Included)*
- 3) A plot plan or site plan of the property *(Included)*
- 4) Certification from an asbestos abatement company *(N/A)*
- 5) Electronic files in pdf format are also required in addition to hard copy

Permit Fee: \$30.00 for the first \$1000.00 construction cost, \$10.00 per additional \$1000.00 cost

All construction and demolition debris generated in Portland must be delivered to Riverside Recycling Facility at 910 Riverside Street. Source separated salvage materials placed in specifically designated containers are exempt from this provision. For more information contact Troy Moon @ 874-8467.

U.S. EPA Region 1 – No Phone call required. Just mail copy of State notification to:

Demo / Reno Clerk
US EPA Region I (SEA)
JFK Federal Building
Boston, MA 02203

I have contacted all of the necessary companies/departments as indicated above and attached all required documentation.

Signed: _____ Date: _____

or more information or to download this form and other permit applications visit the Inspections Division on our website at www.portlandmaine.gov

Spencer Bean
22 Caldwell St.
Portland, ME 04103

March 29, 2012

City of Portland
Planning and Development Department
389 Congress Street
Room 315
Portland ME 04103

Attention: Ann Machado - Planning and Development Department

Reference: R-5 22 Caldwell St. – Prefabricated Shed

I have notified in writing my abutting neighbors regarding the demolition of my existing dilapidated shed/garage.

List of abutting neighbors:

Fiorello & Dorothy Ventresco
18 Caldwell St.
Portland me 04103

Charles & Ruth Schott
26 Caldwell St.
Portland me 04103

Amy Mulkerin & John Jordan
426 forest Ave.
Portland me 04101

Please contact me if you need further assistance.

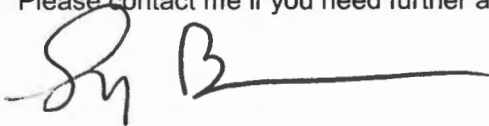
A handwritten signature in black ink, appearing to read 'Spencer B.', followed by a long horizontal line extending to the right.

Spencer B. Bean, PE
Senior Mechanical Engineer
Tel: (207) 887-3418
Cel:(207) 887-3418
sbean41@maine.rr.com

