

U.S. Cellular

The way people talk around here. SM

SITE NAME: ROSEMONT (DEERING H.S.)

SITE NO 853418

LATITUDE: 43 40' 16.48"

LONGITUDE: 70 17 45.08"

SITE NUMBER:	853418
SITE NAME:	ROSEMONT (DEERING H.S.)
TOWER TYPE:	70' ROOF TOP TOWER (PROPOSED)
GROUND ELEVATION:	95' ABOVE MEAN SEA LEVEL
ROOF TOP ELEVATION:	134' ABOVE MEAN SEA LEVEL
SITE ADDRESS:	370 STEVENS AVE PORTLAND, ME 04103
PROPERTY OWNER:	CITY OF PORTLAND 389 CONGRESS ST PORTLAND, ME 04101
MAP & LOT:	175/B/1
APPLICANT:	U.S. CELLULAR c/o K&K WIRELESS 127 RIDGE ROAD NASHUA, NH 03062

PROJECT SUMMARY

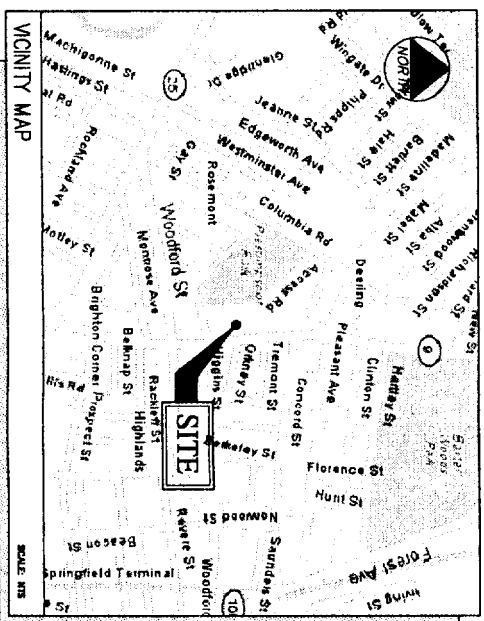

VICINITY MAP

FROM GANNETT DRIVE SOUTH PORTLAND. PROCEED NORTH ON GANNETT DRIVE TOWARDS CLIMMINGS ROAD. TURN RIGHT ONTO CLIMMINGS ROAD AND PROCEED 4.35 MILES TO RUNNING HILL ROAD. TURN LEFT ONTO RUNNING HILL ROAD AND PROCEED 4.23 MILES. TURN LEFT ONTO MAINE MALL ROAD AND PROCEED 3.40 MILES TO WESTERN AVE (ROUTE 9). TURN LEFT ONTO WESTERN AVE AND PROCEED 2.80 MILES. BEAR LEFT ONTO FROST STREET AND PROCEED 1.05 MILES. KEEP RIGHT ONTO CAPSIC STREET AND PROCEED .64 MILES TO STEVENS AVE (ROUTE 8). TURN LEFT ONTO STEVENS AVE AND PROCEED .59 MILES TO DEERING HIGH SCHOOL. LOCATED ON THE LEFT.

SHEET NO.	DESCRIPTION	DATE	REV. NO.
T-1	TITLE SHEET	3/1/06	2
C-1	PLOT PLAN	3/1/06	1
D-1	DEMOLITION PLAN	3/1/06	0
S-1	ROOF PLAN	2/3/06	1
S-2	TOWER ELEVATION & PLAN	3/1/06	2
S-3	FLOOR PLAN, DETAILS AND SECTIONS	3/1/06	2
G-1	GENERAL NOTES	2/3/06	0

SHEET INDEX

BUILDING REQUIREMENTS: BUILDING IS HANDED OFF AND NOT FOR HUMAN HABITATION. HANDICAPPED ACCESS REQUIREMENTS NOT REQUIRED. PLUMBING REQUIREMENTS: PLUMBING HAS NO PLUMBING. FACILITY HAS NO PLUMBING.

Michael DeBerry
 MICHAEL DEBERRY
 PROFESSIONAL ENGINEER
 No. 5083

THIS DRAWING WAS CREATED FOR A FULL SIZE OF 22"x34". IT HAS BEEN REDUCED 50% FOR SUBMISSION PURPOSES.

REVISIONS NO. DATE DESCRIPTION	SITE NAME: ROSEMONT (DEERING H.S.)	Associates, Inc. <small>343 Durbin Road - South Portland, ME 04106</small> engineers architects surveyors construction managers (207) 761-1770 FAX: (207) 774-1248 OEST PROJ. NO 413.46.01	R.F. _____	U.S. Cellular <i>The way people talk around here.</i> 288 Route 101, 2nd Floor, Bedford, NH 03110
	SITE NUMBER: 853418		SA/ZN _____	
ADDRESS: 370 STEVENS AVE. PORTLAND, ME. 04103	DRAWING TITLE: TITLE SHEET	U.S.C.C. _____	CONST. _____	
DATE: 2/3/06	AS NOTED 4/3 4.6.01	P.M. _____		

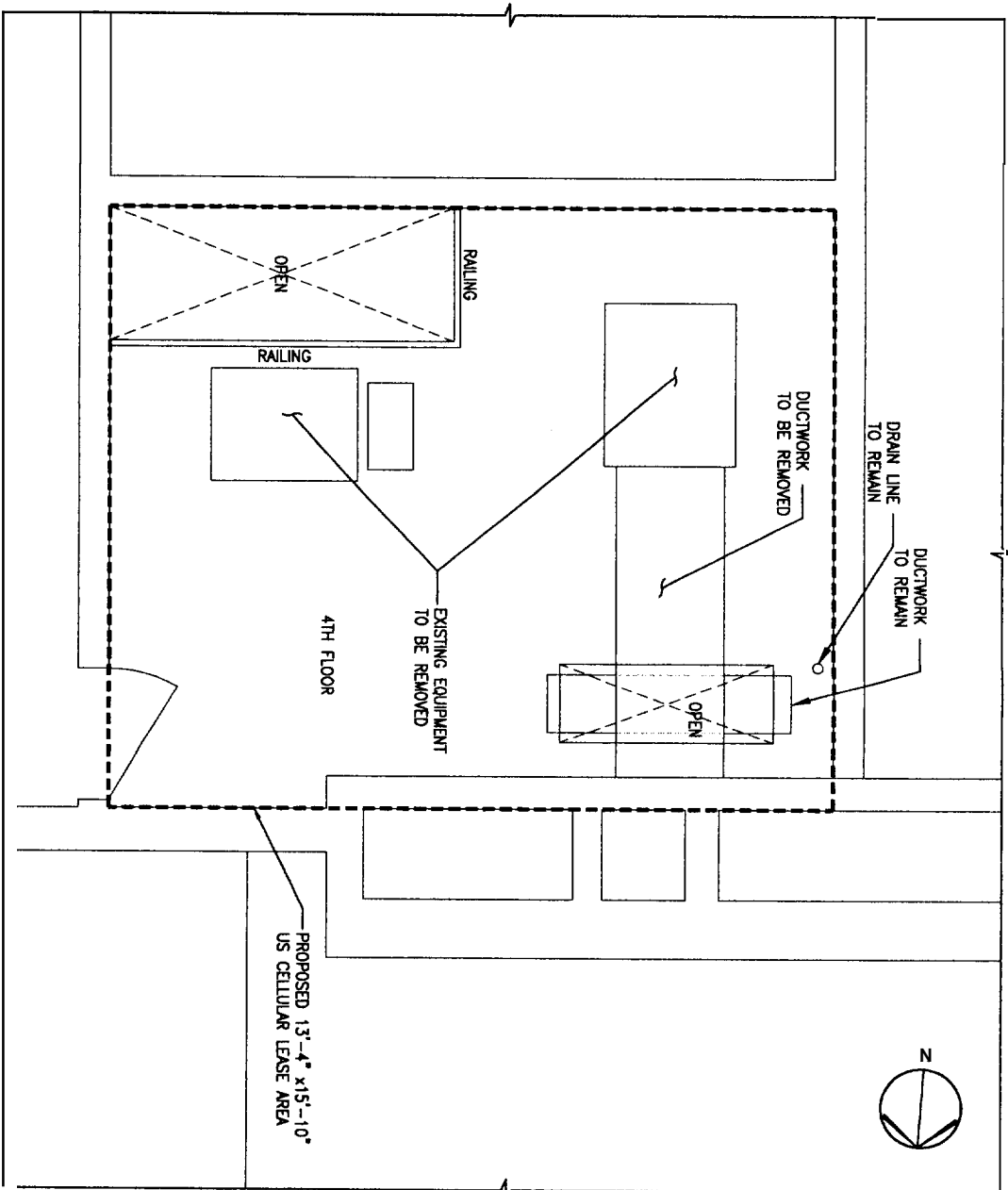

1 DEMOLITION PLAN
SCALE: 1/2" = 1'

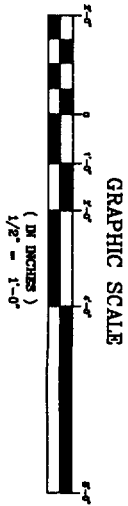

PROPOSED 13'-4" x 15'-10"
US CELLULAR LEASE AREA

Michael S. Letensky
MICHAEL S. LETENSKY
PROFESSIONAL ENGINEER
No. 5023

D-1	SITE NAME: ROSEMONT (DEERING H.S.)	OEST Associates, Inc. <small>343 Gorkham Road • South Portland, ME 04106</small> <small>engineers • architects • surveyors • interior designers</small> TEL: (207) 761-1770 FAX: (207) 774-1246 OEST PROJ. NO: 413.46.01	 U.S. Cellular. <i>The way people talk around here. .</i> 288 Route 101, 2nd Floor, Bedford, NH 03110																		
	SITE NUMBER: 853418																				
	ADDRESS: 370 STEVENS AVE. PORTLAND, ME 04103																				
	DRAWING TITLE: DEMOLITION PLAN																				
<table border="1"> <thead> <tr> <th>NO.</th> <th>REVISIONS</th> <th>DATE</th> </tr> </thead> <tbody> <tr> <td> </td> <td> </td> <td> </td> </tr> <tr> <td> </td> <td> </td> <td> </td> </tr> <tr> <td> </td> <td> </td> <td> </td> </tr> </tbody> </table>	NO.	REVISIONS	DATE										<table border="1"> <tr> <td> DESIGNED BY: NSD </td> <td> DATE: 03/01/06 </td> </tr> <tr> <td> DRAWN BY: ENB </td> <td> SCALE: AS NOTED </td> </tr> <tr> <td> CHECKED BY: NSD </td> <td> PROJECT NO.: 413.46.01 </td> </tr> <tr> <td> DRAWING NO.: </td> <td> FOR CONSTRUCTION USE: </td> </tr> </table>	DESIGNED BY: NSD	DATE: 03/01/06	DRAWN BY: ENB	SCALE: AS NOTED	CHECKED BY: NSD	PROJECT NO.: 413.46.01	DRAWING NO.:	FOR CONSTRUCTION USE:
NO.	REVISIONS	DATE																			
DESIGNED BY: NSD	DATE: 03/01/06																				
DRAWN BY: ENB	SCALE: AS NOTED																				
CHECKED BY: NSD	PROJECT NO.: 413.46.01																				
DRAWING NO.:	FOR CONSTRUCTION USE:																				