

Garages

	Vinyl siding	T-1-11 Siding
24' x 24' Pleasant		
8/12 Pitch	\$12,900	\$11,590
10/12 Pitch Attic Truss	\$15,160	\$13,600
24' x 36' Saddleback		
8/12 Pitch	\$17,400	\$15,590
10/12 Pitch Attic Truss	\$20,520	\$18,370
28' x 28' Katahdin		
8/12 Pitch	\$16,800	\$15,060
10/12 Pitch Attic Truss	\$19,900	\$18,711
26' x 40' Cadillac		
8/12 Pitch	\$21,600	\$19,330
10/12 Pitch Attic Truss	\$25,700	\$22,980
28' x 36' Sugarloaf		
	\$30,800	\$27,520

**Garage Package includes**

- light excavation & back fill poured slab with existing soil. Any fill needed is extra!
- 4" Floating slab with rebar and wire mesh, pitched at door for water run Troweled floor finish.
- 2"x4"x8' wall framing 16" OC. P.T. bottom plates lagged to slab with sill seal
- Wall sheathing is 7/16" osb with house wrap under vinyl siding or unfinished T-1-11
- Roof trusses are set 24" OC with 5/8' sheathing.
- Non insulated 9'x7' high garage doors with no openers
- Single hung Hancock Classic Windows
- 35 year Architectural Asphalt Shingles
- Drip Edge on rakes and eaves
- Ridge vent for ventilation

**Garage Upgrades**

- Metal Roofing
- Insulated garage door upgrade from non insulated 20% of base price
- Garage door openers \$225
- Additional 9 lite Steel entry door \$295
- Additional Vinyl single hung window \$335
- 2"x6" wall framing 5% of base price
- 10' Tall studs 4% of base price

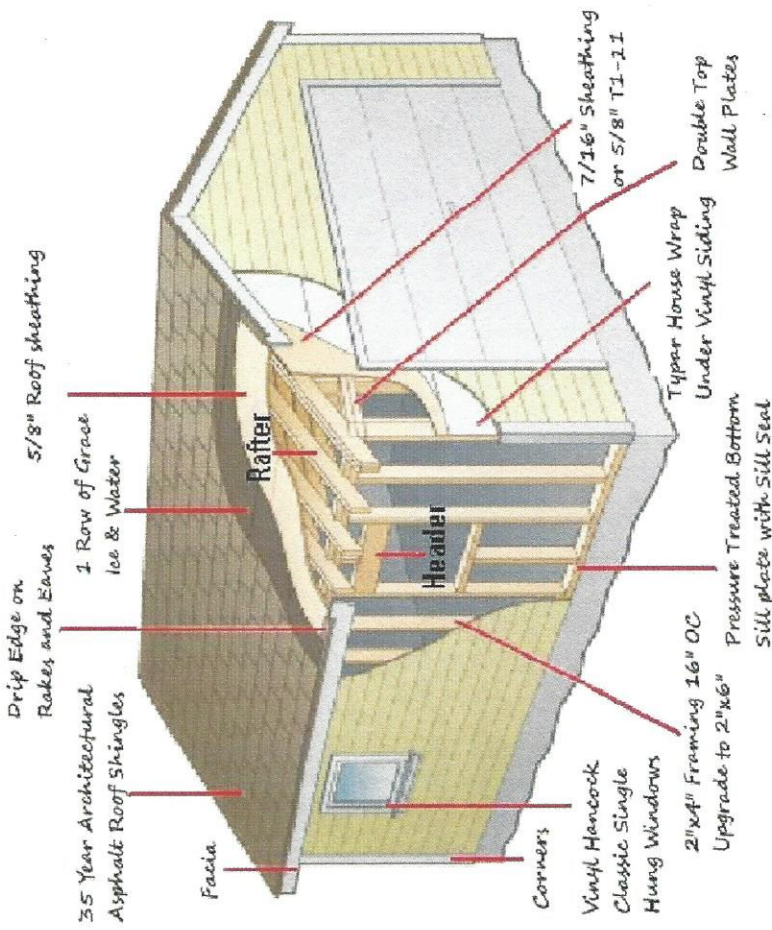

**Floating Monolithic Concrete Slab**  
Galvanized

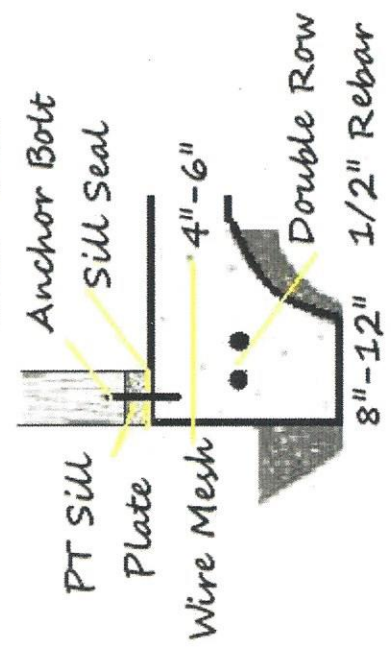

[WWW.ShedHappens.Com](http://WWW.ShedHappens.Com)