

Issue/Revision	Date	Mark	Description
Project ID	2010020		
CAD File Name			
Drawn By			
Checked By			
Issue Date	5-17-11		
Plot Date			
Reviewed by			
Designed by	reh		
Submitted By			
Drawing Code			
Sheet Title	Life Safety Review Plan		
Drawing No.	<b>LS-101</b>		

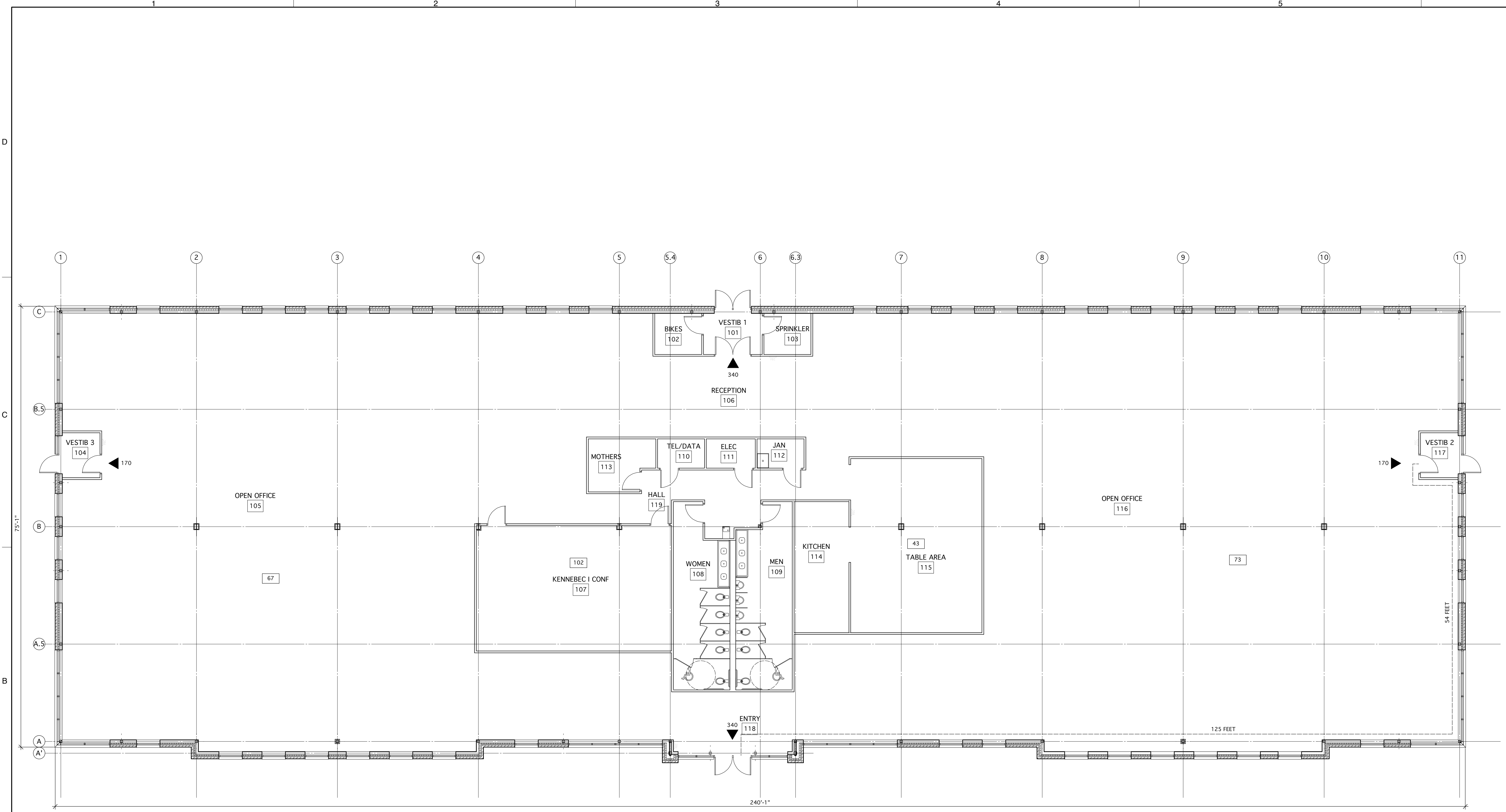

**TOTAL OCCUPANT LOAD = 350**

**KEY**

XX	OCCUPANT LOAD OF SPACE
XX ▶	EGRESS CAPACITY
XX	TRAVEL DISTANCE

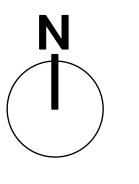
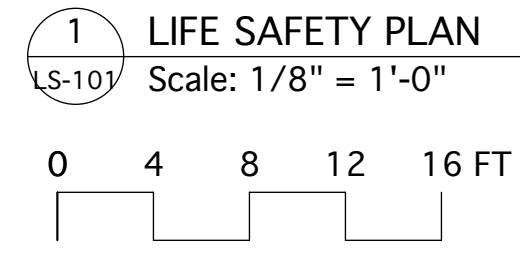

J.B. BROWN NEW OFFICE BUILDING  
 WASHINGTON AVENUE  
 PORTLAND, MAINE

SCOPE OF WORK: NEW GENERAL OFFICE BUILDING  
 DESIGN CRITERIA AS FOLLOWS:  
 OCCUPANCY USE GROUP: IBC: GROUP B BUSINESS  
 BUILDING CONSTRUCTION TYPE: II B  
 BUILDING HEIGHT: 1 STORY, 15'-4" +/-  
 BUILDING AREA: FIRST FLOOR 18,266 SF  
 BUILDING OCCUPANCY: 100 GSF/OCCUPANT

APPLICABLE CODES:  
 IBC: 2009  
 NFPA 101 2006  
 NFPA 13  
 MAINE STATE PLUMBING CODE  
 ADA GUIDELINES  
 MAINE HUMAN RIGHTS ACT

FIRE PROTECTION: FULLY SPRINKLERED PER NFPA 13  
 APPROVED SUPERVISED FIRE ALARM SYSTEM

SITE CRITERIA: OPEN DESIGNATED SITE  
 > 25% BUILDING PERIMETER OPEN SPACE  
 > 10' SEPARATION ADJACENT STRUCTURES

TYPE II B STRUCTURAL ELEMENTS RATINGS (IBC 2009, Table 601, 602):  
 STRUCTURAL FRAME: 0 hr  
 EXTERIOR BEARING & NONBEARING WALLS: 0 hr  
 INTERIOR NONBEARING WALLS AND PARTITIONS: 0 hr  
 FLOOR CONSTRUCTION: 0 hr  
 ROOF CONSTRUCTION: 0 hr

LIFE SAFETY EXITS PROVIDED:  
 BUILDING FLOOR: 4  
 MINIMUM NUMBER OF EXITS - 2

PATH OF TRAVEL REQUIREMENTS: BUSINESS GROUP B  
 DEAD END PROTECTED: 50'  
 COMMON PATH PROTECTED: 100'  
 MAXIMUM TRAVEL PROTECTED: 250' PER IBC