

PLAN GENERAL NOTES

1. VERIFY ALL EXISTING CONDITIONS AND DIMENSIONS. PROCEED WITH THE WORK ONLY AFTER DISCREPANCY HAS BEEN RESOLVED.
2. ALL NEW OPENINGS INTO EXISTING CMU WALLS FOR MECHANICAL OR ELECTRICAL PENETRATIONS SHALL RECEIVE A LINTEL.
3. FLOORING AND FLOOR FINISHES SHALL BE INSTALLED TO A MAXIMUM DIFFERENTIAL OF 1/16" BETWEEN DISSIMILAR MATERIALS. PROVIDE TRANSITION STRIPS OR THRESHOLDS (1/2" MAXIMUM) OF SAME MATERIAL AS FLOORING AND/OR AS NOTED ON THE DRAWINGS.
4. TYPICAL DETAILS:
 THE FOLLOWING DETAILS ARE TYPICAL THROUGHOUT THIS PROJECT AND APPLY IN ALL CASES UNLESS SPECIFICALLY NOTED OTHERWISE. PLEASE NOTE THAT THESE DETAILS MAY NOT BE DIRECTLY REFERENCED FROM THE PLANS OR OTHER DETAILS.
 - ALL COLUMNS ADJACENT TO OR INTEGRAL WITH EXTERIOR WALL CONSTRUCTION SHALL BE ENCLOSED WITHIN THE WALL CONSTRUCTION UNLESS NOTED OTHERWISE.
 - ALL FREESTANDING COLUMNS SHALL BE WRAPPED.
 - ALL GNB PARTITIONS INTERSECTING MASONRY PARTITIONS, EITHER NEW OR EXISTING, SHALL BE FINISHED WITH A "J" BEAD AND SEALANT.
 - ALL NEW OPENINGS INTO EXISTING MASONRY WALLS FOR EITHER WINDOWS OR DOORS SHALL BE TOOTHED IN AT THE JAMBS.
 - ALL COLUMNS LOCATED ADJACENT TO OR INTEGRAL WITH GNB PARTITION OR WALLS SHALL BE ENCLOSED WITHIN THE WALL CONSTRUCTION.
 - ALL ROOF LEADERS, HEAT PIPING, SPRINKLER RISERS OR MISCELLANEOUS PIPING SHALL BE ENCLOSED WITHIN THE WALL CONSTRUCTION.
 - ALL DUCT PENETRATIONS THROUGH FLOORS SHALL BE ENCLOSED IN A CHASE.
 - UNLESS NOTED OTHERWISE, THE LOCATION OF DOORFRAMES SHALL BE:
 - 4" FROM ADJACENT WALL TO THE HINGE SIDE IN METAL STUD PARTITIONS.
 - MAINTAIN A CLEAR DIMENSION OF 1'-6" FROM ALL ADJACENT CONSTRUCTION TO THE LATCH (PULL) SIDE OF THE DOOR.
 - MAINTAIN OTHER CLEAR DIMENSIONS IN ACCORDANCE WITH THE LATEST VERSION OF THE ADA ACCESSIBILITY GUIDELINES (ADAAS).

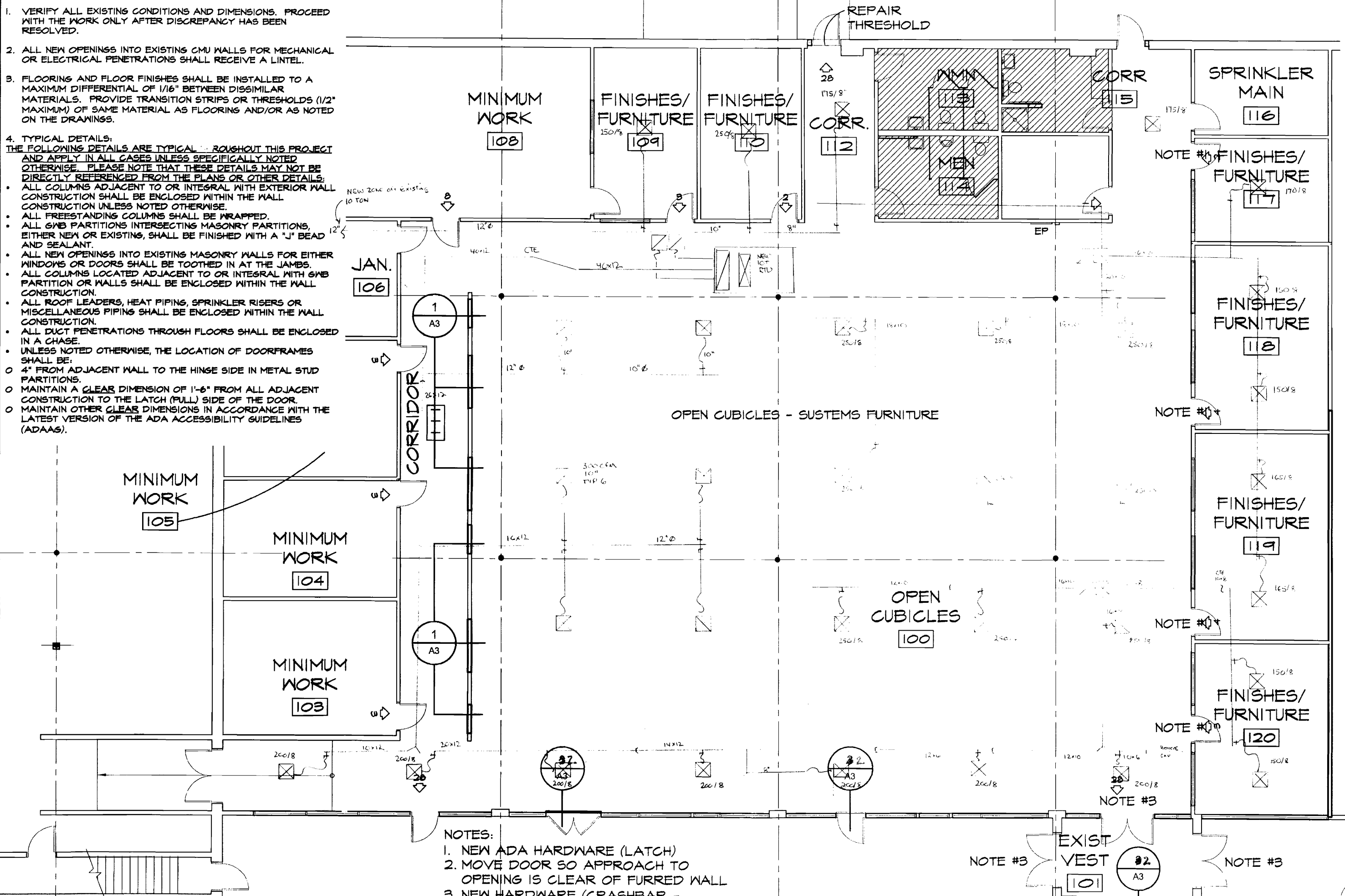

- NOTES:**
1. NEW ADA HARDWARE (LATCH)
 2. MOVE DOOR SO APPROACH TO OPENING IS CLEAR OF FURRED WALL
 3. NEW HARDWARE (CRASHBAR -

Martin's Point

Former Andover College Space Interior Fit-Up
 901 WASHINGTON AVE - PORTLAND - MAINE

TITLE FLOOR PLAN

SHEET A1

JOB NO 09-010
 DATE 19 FEBRUARY 2009
 SCALE 1/8"=1'-0"

© 2009 PDT Architects

ARCHITECTURE
 INTERIOR DESIGN
 PLANNING
 49 DARTMOUTH STREET
 PORTLAND, MAINE 04101
 www.pdtarchts.com

TECTS