

Location of Construction: 39 Byfield Rd		Owner: Mrs. Avis Conley		Phone:		Permit No: 971024	
Owner Address: SAA Pctd, ME 04103		Lessee/Buyer's Name:		Phone:		Business Name:	
Contractor Name: Maine Window & Siding		Address: 62 Portland Rd Kennebunk, ME		Phone: 04043 985-2300		Permit Issued: SEP 24 1997	
Past Use: 1-fam		Proposed Use: Same		COST OF WORK: \$ 7,200.00		PERMIT FEE: \$ 55.00	
				FIRE DEPT. <input type="checkbox"/> Approved <input type="checkbox"/> Denied		INSPECTION: Use Group: Type:	
				Signature:		Signature:	
Proposed Project Description: Construct Breezeway (10 x 17)				PEDESTRIAN ACTIVITIES DISTRICT (P.A.D.)			
				Action: Approved <input type="checkbox"/> Approved with Conditions: <input type="checkbox"/> Denied <input type="checkbox"/>			
				Signature:		Date:	
Permit Taken By: Mary Greik		Date Applied For: 12 September 1997					

**PERMIT ISSUED**  
SEP 24 1997  
**CITY OF PORTLAND**

Zone: CBL:  
170-D-001  
Zoning Approval:  
Special Zone or Reviews:  
 Shoreland  
 Wetland  
 Flood Zone  
 Subdivision  
 Site Plan maj  minor  mm

**Zoning Appeal**  
 Variance  
 Miscellaneous  
 Conditional Use  
 Interpretation  
 Approved  
 Denied

**Historic Preservation**  
 Not in District or Landmark  
 Does Not Require Review  
 Requires Review

**Action:**  
 Approved  
 Approved with Conditions  
 Denied

Date: \_\_\_\_\_

**PERMIT ISSUED WITH REQUIREMENTS**

**CERTIFICATION**

I hereby certify that I am the owner of record of the named property, or that the proposed work is authorized by the owner of record and that I have been authorized by the owner to make this application as his authorized agent and I agree to conform to all applicable laws of this jurisdiction. In addition, if a permit for work described in the application is issued, I certify that the code official's authorized representative shall have the authority to enter all areas covered by such permit at any reasonable hour to enforce the provisions of the code(s) applicable to such permit

SIGNATURE OF APPLICANT: Bill Sargent ADDRESS: \_\_\_\_\_ DATE: 12 September 1997 PHONE: \_\_\_\_\_

RESPONSIBLE PERSON IN CHARGE OF WORK, TITLE \_\_\_\_\_ PHONE: \_\_\_\_\_

CEO DISTRICT 7

**City of Portland, Maine – Building or Use Permit Application** 389 Congress Street, 04101, Tel: (207) 874-8703, FAX: 874-8716

Location of Construction: 39 Byfield Rd		Owner: Mrs. Avis Conley		Phone:		Permit No: <b>971024</b>	
Owner Address: SAA Ptld, ME 04103		Lessee/Buyer's Name:		Phone:		BusinessName:	
Contractor Name: Maine Window & Siding		Address: 62 Portland Rd Kennebunk, ME		Phone: 04043 985-2300		Permit Issued: <b>SEP 24 1997</b>	
Past Use: 1-fam		Proposed Use: Same		COST OF WORK: \$ 7,200.00		PERMIT FEE: \$ <del>XXXXXX</del> 55.00	
Proposed Project Description:  Construct Breezeway (10 x 17)		Signature:		FIRE DEPT. <input type="checkbox"/> Approved <input type="checkbox"/> Denied		INSPECTION: Use Group: <i>R3</i> Type: <i>5B</i>	
				Signature: <i>[Signature]</i>		Signature: <i>[Signature]</i>	
PEDESTRIAN ACTIVITIES DISTRICT (P.A.D.)		Action:		Approved <input type="checkbox"/>		Approved with Conditions: <input type="checkbox"/>	
		Denied <input type="checkbox"/>		Signature:		Date:	
Permit Taken By: Mary Gresik		Date Applied For: 12 September 1997					

**PERMIT ISSUED**  
SEP 24 1997  
**CITY OF PORTLAND**

Zone: *K-3* CBL: 170-D-001  
Zoning Approval: *OK [Signature] 9/23/97*  
**Special Zone or Reviews**  
 Shoreland  
 Wetland  
 Flood Zone  
 Subdivision  
 Site Plan maj  minor  mm

1. This permit application does not preclude the Applicant(s) from meeting applicable State and Federal rules.
2. Building permits do not include plumbing, septic or electrical work.
3. Building permits are void if work is not started within six (6) months of the date of issuance. False information may invalidate a building permit and stop all work..

**Zoning Appeal**

Variance  
 Miscellaneous  
 Conditional Use  
 Interpretation  
 Approved  
 Denied

**Historic Preservation**

Not in District or Landmark  
 Does Not Require Review  
 Requires Review

**PERMIT ISSUED WITH REQUIREMENTS**

**CERTIFICATION**

I hereby certify that I am the owner of record of the named property, or that the proposed work is authorized by the owner of record and that I have been authorized by the owner to make this application as his authorized agent and I agree to conform to all applicable laws of this jurisdiction. In addition, if a permit for work described in the application is issued, I certify that the code official's authorized representative shall have the authority to enter all areas covered by such permit at any reasonable hour to enforce the provisions of the code(s) applicable to such permit

*[Signature: William Sargent]*  
SIGNATURE OF APPLICANT **William Sargent**

12 September 1997

ADDRESS: \_\_\_\_\_ DATE: \_\_\_\_\_ PHONE: \_\_\_\_\_

Action:  
 Approved  
 Approved with Conditions  
 Denied

Date: *9/10/97*  
*[Signature]*

RESPONSIBLE PERSON IN CHARGE OF WORK, TITLE \_\_\_\_\_ PHONE: \_\_\_\_\_

CEO DISTRICT 7  
*K. Carroll*

## BUILDING PERMIT REPORT

DATE: 23 Sept 97 ADDRESS: 39 Bayfield Rd.  
REASON FOR PERMIT: To Construct 10x17 Breezeway  
BUILDING OWNER: Mrs. Avis Cosley  
CONTRACTOR: Maine Window & Siding  
PERMIT APPLICANT: Bill Sargent APPROVAL: xl  
USE GROUP: R-3 BOCA 1996 CONSTRUCTION TYPE: 5-B

### CONDITION(S) OF APPROVAL

1. This permit does not excuse the applicant from meeting applicable State and Federal rules and laws.
2. Before concrete for foundation is placed, approvals from the Development Review Coordinator and Inspection Services must be obtained. (A 24 hour notice is required prior to inspection)
3. Precaution must be taken to protect concrete from freezing.
4. It is strongly recommended that a registered land surveyor check all foundation forms before concrete is placed. This is done to verify that the proper setbacks are maintained.
5. Private garages located beneath habitable rooms in occupancies in Use Group R-1, R-2, R-3 or I-1 shall be separated from adjacent interior spaces by fire partitions and floor/ceiling assembly which are constructed with not less than 1-hour fire resisting rating. Private garages attached side-by-side to rooms in the above occupancies shall be completely separated from the interior spaces and the attic area by means of ½ inch gypsum board or the equivalent applied to the garage means of ½ inch gypsum board or the equivalent applied to the garage side. (Chapter 4 Section 407.0 of the BOCA/1996)
6. All chimneys and vents shall be installed and maintained as per Chapter 12 of the City's Mechanical Code. (The BOCA National Mechanical Code/1993) U.L. 103.
7. Sound transmission control in residential building shall be done in accordance with Chapter 12 section 1214.0 of the city's building code.
8. Guardrail & Handrails A guardrail system is a system of building components located near the open sides of elevated walking surfaces for the purpose of minimizing the possibility of an accidental fall from the walking surface to the lower level. Minimum height all Use Groups 42", except Use Group R which is 36". In occupancies in Use Group A, B, H-4, I-1, I-2 M and R and public garages and open parking structures, open guards shall have balusters or be of solid material such that a sphere with a diameter of 4" cannot pass through any opening. Guards shall not have an ornamental pattern that would provide a ladder effect.
9. Headroom in habitable space is a minimum of 7'6" ..
10. Stair construction in Use Group R-3 & R-4 is a minimum of 10" tread and 7 3/4" maximum rise. All other Use group minimum 11" tread. 7" maximum rise.
11. The minimum headroom in all parts of a stairway shall not be less than 80 inches.
12. Every sleeping room below the fourth story in buildings of use Groups R and I-1 shall have at least one operable window or exterior door approved for emergency egress or rescue. The units must be operable from the inside without the use of special knowledge or separate tools. Where windows are provided as means of egress or rescue they shall have a sill height not more than 44 inches (1118mm) above the floor. All egress or rescue windows from sleeping rooms shall have a minimum net clear opening height dimension of 24 inches (610mm). The minimum net clear opening width dimension shall be 20 inches (508mm), and a minimum net clear opening of 5.7 sq. ft.
13. Each apartment shall have access to two (2) separate, remote and approved means of egress. A single exit is acceptable when it exits directly from the apartment to the building exterior with no communications to other apartment units.
14. All vertical openings shall be enclosed with construction having a fire rating of at least one (1) hour, including fire doors with self closer's.
15. The boiler shall be protected by enclosing with (1) hour fire-rated construction including fire doors and ceiling, or by providing automatic extinguishment.
16. All single and multiple station smoke detectors shall be of an approved type and shall be installed in accordance with the provisions of the City's Building Code Chapter 9, Section 19, 920.3.2 (BOCA National Building Code/1996), and NFPA 101 Chapter 18 & 19. (Smoke detectors shall be installed and maintained at the following locations):
  - In the immediate vicinity of bedrooms
  - In all bedrooms
  - In each story within a dwelling unit, including basements

In addition to the required AC primary power source, required smoke detectors in occupancies in Use Groups R-2, R-3 and I-1 shall receive power from a battery when the AC primary power source is interrupted. (Interconnection is required)

- 17. A portable fire extinguisher shall be located as per NFPA #10. They shall bear the label of an approved agency and be of an approved type.
- 18. The Fire Alarm System shall be maintained to NFPA #72 Standard.
- 19. The Sprinkler System shall maintained to NFPA #13 Standard.
- 20. All exit signs, lights, and means of egress lighting shall be done in accordance with Chapter 10 Section & Subsections 1023. & 1024. Of the City's building code. (The BOCA National Building Code/1996)
- 21. No construction or demolition work shall begin until you have obtained permits for dumpsters or containers. A work Stop Order shall be issued if this requirement is not met.
- 22. Section 25-135 of the Municipal Code for the City of Portland states, "No person or utility shall be granted a permit to excavate or open any street or sidewalk from the time of November 15 of each year to April 15 of the following year".
- 23. The builder of a facility to which Section 4594-C of the Maine State Human Rights Act Title 5 MRSA refers, shall obtain a certification from a design professional that the plans commencing construction of the facility, the builder shall submit the certification to the Division of Inspection Services.
- 24. This permit does not excuse the applicant from obtaining any license which may be needed from the City Clerk's office.
- 25. Ventilation shall meet the requirements of Chapter 12 Sections 1210. of the City's Building Code.
- 26. All electrical and plumbing permits must be obtained by a Master Licensed holders of their trade.
- 27. All requirements must be met before a final Certificate of Occupancy is issued.
- 28. All building elements shall meet the fastening schedule as per Table 2305.2 of the City's Building Code. (The BOCA National Building Code/1996).
- 29. Ventilation of spaces within a building shall be done in accordance with the City's Mechanical Code (The BOCA National Mechanical Code/1993).
- 30. *This permit is being issued with the understanding that the proposed roof panels meet the requirements of the City's building code (The BOCA National Building Code /1996.)*
- 31. \_\_\_\_\_
- 32. \_\_\_\_\_
- 33. \_\_\_\_\_
- 34. \_\_\_\_\_

  
P. Samuel Hoffes, Code Enforcement

cc: Lt. McDougall, PFD  
Marge Schmuckal

Avis Conley

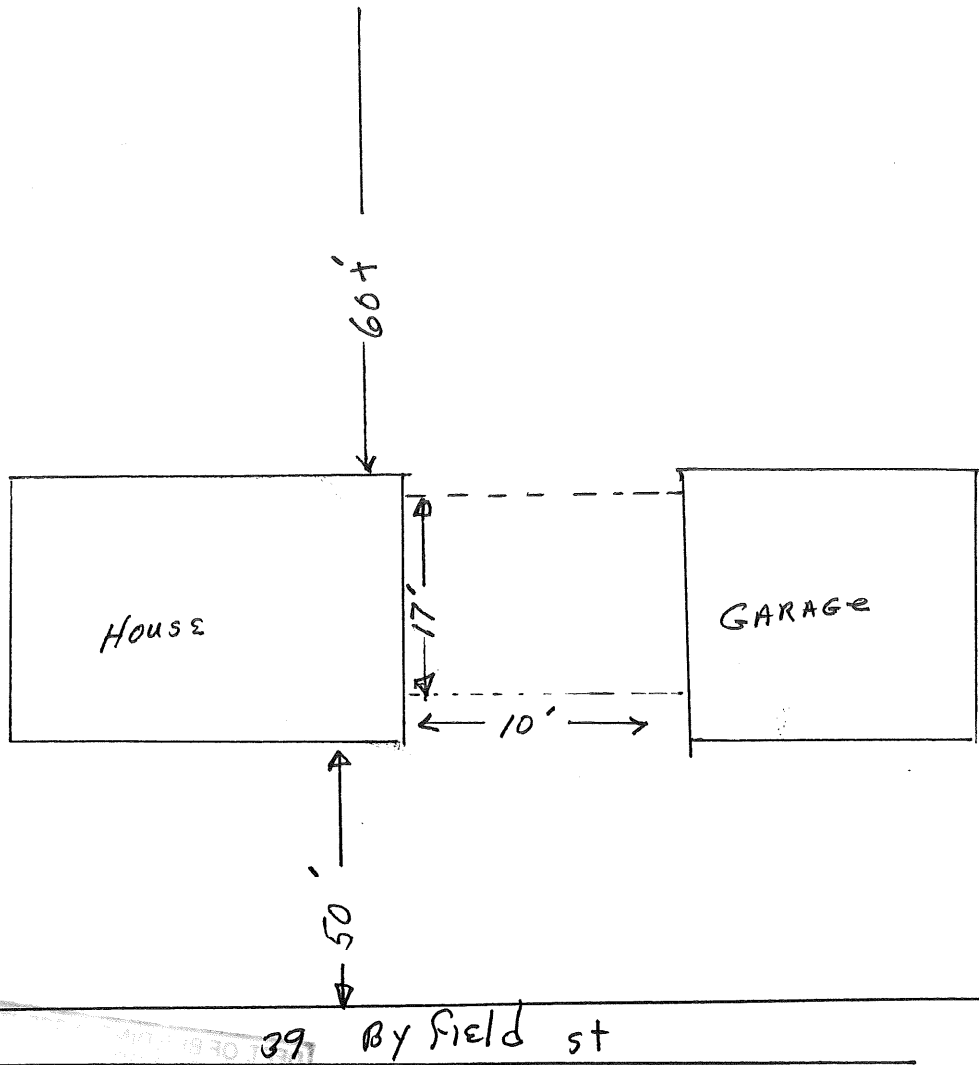

10' x 17' DECK  
ANCHORED TO  
FOUNDATION OF HOUSE  
AND FROSTWALL OF  
GARAGE  
2' x 10' PT 16" ON CENTER  
5/4 x 6" PT DECKING  
BUILD 10' x 17' 3 SEASON  
PATIO ROOM (1 STORY)  
ON DECK CONSTRUCTED  
OF 3" HONEYCOMB PANELS  
AND TEMPERED GLASS  
ALL FRAMING TO  
BE ASTM 6063  
TENSILE STRENGTH  
39,000 P.S.I.

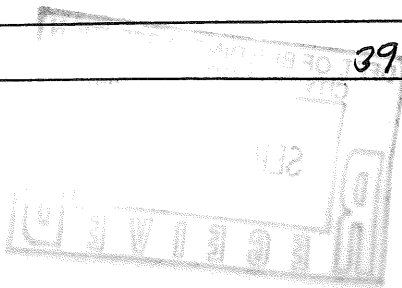

## TABLE 22-1 - CONFORMANCE SPECIFICATIONS FOR 3" THICK HONEYCOMB PANELS

### PHYSICAL PROPERTIES OF 3" THICK HONEYCOMB PANELS AND ATTACHING EXTRUSIONS

COMPONENT	MATERIAL	SIZE / PROPERTIES	STRENGTH
FACING	1. A.S.T.M. 3003 H194 2. A.S.T.M. 3004 H374 3. A.S.T.M. 3105 H194 ALUMINUM ALLOY	WIDTH = 37.2" ± 0.02" THICKNESS = 0.024" ± 0.001" DENSITY = 168 ± 3.0 PCF COEF. TH. EXP. = 0.000013	1. TENSILE ULTIMATE STRENGTH = 27,000-33,000 PSI 2. TENSILE ULTIMATE STRENGTH = 35,000-41,000 PSI 3. TENSILE ULTIMATE STRENGTH = 32,000-38,000 PSI ELONGATION 1% TO 3%
CORE	HONEYCOMB 99# KRAFT PAPER 1. 11% ± 2% RESIN CONTENT 2. 18% ± 2% RESIN CONTENT	WIDTH = 35.0" ± 0.5" THICKNESS = 2.95" ± 0.01" CELL SIZE = 0.75" ± 0.15" DENSITY = 1.7 ± 0.25 PCF COEF. TH. EXP. = 0.000089 ADSORPTION > 3%	1. COMPRESSIVE ULT. STRENGTH (DRY) = 57-77 PSI 1. COMPRESSIVE ULT. STRENGTH (WET) = 20-28 PSI 1. SHEAR ULTIMATE STRENGTH (L) = 37-51 PSI 1. SHEAR ULTIMATE STRENGTH (T) = 20-28 PSI
ADHESIVE	MOISTURE CURING, ONE-PART, 100% SOLIDS, NON-VOLATILE, TYPE II URETHANE ADHESIVE	DENSITY = 68.5 PCF	FLEXURAL YIELD STRENGTH (L, AL-HC) = 922 PSI FLEXURAL YIELD STRENGTH (T, AL-HC) = 668 PSI
EXTRUSIONS	A.S.T.M. 6063 T6	A-FRAME SUPPORT PANEL HANGER H-, U-, C-, F-CHANNELS CORNER POST THERMAL BREAK H, HANGER	TENSILE ULTIMATE STRENGTH = 30,000 PSI TENSILE YIELD STRENGTH = 25,000 PSI COMPRESSIVE YIELD STRENGTH = 25,000 PSI SHEAR ULTIMATE STRENGTH = 19,000 PSI SHEAR YIELD STRENGTH = 14,000 PSI BEARING ULTIMATE STRENGTH = 63,000 PSI BEARING YIELD STRENGTH = 40,000 PSI MODULUS OF ELASTICITY = 10,100,000 PSI
PANEL	HONEYCOMB SANDWICH PANEL	WIDTH = 35.9" ± 0.1" THICKNESS = 3.0" ± 0.01" R-FACTOR = 4	STRENGTH CHARACTERISTICS TABULATED BELOW FLAME SPREAD INDEX = 40 SMOKE DEVELOPED INDEX = 335

### TRANSVERSE LOAD TABLE FOR 3" THICK HONEYCOMB PANELS

LOAD DESCRIPTION	ROOF LOADS (psf) FOR PANEL SPANS			
	8 ft	10 ft	12 ft	14 ft
<b>ULT. TRANSVERSE LOADS/FACTOR OF SAFETY</b>				
1. ROOF LOAD AT ULTIMATE TRANSVERSE LOAD / 1.0	170	140	105	82
2. ROOF LOAD AT ULTIMATE TRANSVERSE LOAD / 2.0	85	70	52	41
3. ROOF LOAD AT ULTIMATE TRANSVERSE LOAD / 2.5	68	58	42	33
4. ROOF LOAD AT ULTIMATE TRANSVERSE LOAD / 3.0	57	47	35	27
<b>DEFLECTION LOADS</b>				
5. ROOF LOAD AT PANEL DEFLECTION OF SPAN / 60	187	102	61	42
6. ROOF LOAD AT PANEL DEFLECTION OF SPAN / 120	94	51	30	21
7. ROOF LOAD AT PANEL DEFLECTION OF SPAN / 180	62	34	20	14