

PERMIT ISSUED

City of Portland, Maine - Building or Use Permit Application
 389 Congress Street, 04101 Tel: (207) 874-8703, Fax: (207) 874-8716

| | | |
|-----------------------|-----------------------------------|---------------------|
| Permit No: 03-1174 | Issue Date: SEP 25 2003 | CBL: 170 B004001 |
|-----------------------|-----------------------------------|---------------------|

| | | | |
|---|------------------------------------|--|----------------------|
| Location of Construction: 910 Washington Ave | Owner Name: Deraspe Jocelyne | Owner Address: 910 Washington CITY OF PORTLAND | Phone: 653-6760 |
| Business Name: | Contractor Name: Charles Colson | Contractor Address: Portland | Phone: 2073536760 |
| Lessee/Buyer's Name: | Phone: | Permit Type: Sheds | Zone: R5 |

| | | | | |
|---|------------------------------------|--|---------------------------|---|
| Past Use: Two Family | Proposed Use: Two Family w/shed | Permit Fee: \$30.00 | Cost of Work: \$975.00 | CEO District: 2 |
| Proposed Project Description: Install 8x10 wood frame shed | | FIRE DEPT: <input type="checkbox"/> Approved <input type="checkbox"/> Denied | | INSPECTION: Use Group: R3 Type: Accessory shed |
| | | Signature: | | Signature: JMB 9/25/03 |

| | | |
|---|--|---------------------------------|
| PEDESTRIAN ACTIVITIES DISTRICT (P.A.D.) | | |
| Action: <input type="checkbox"/> Approved | <input type="checkbox"/> Approved w/Conditions | <input type="checkbox"/> Denied |
| Signature: | Date: | |

| | | |
|-------------------------|---------------------------------|-----------------|
| Permit Taken By: jmb | Date Applied For: 09/25/2003 | Zoning Approval |
|-------------------------|---------------------------------|-----------------|

| | | | |
|--|--|---|--|
| 1. This permit application does not preclude the Applicant(s) from meeting applicable State and Federal Rules. 2. Building permits do not include plumbing, septic or electrical work. 3. Building permits are void if work is not started within six (6) months of the date of issuance. False information may invalidate a building permit and stop all work.. | Special Zone or Reviews <input type="checkbox"/> Shoreland <input type="checkbox"/> Wetland <input type="checkbox"/> Flood Zone <input type="checkbox"/> Subdivision <input type="checkbox"/> Site Plan Maj <input type="checkbox"/> Minor <input type="checkbox"/> MM <input type="checkbox"/> Date: JMB 9/25/03 | Zoning Appeal <input type="checkbox"/> Variance <input type="checkbox"/> Miscellaneous <input type="checkbox"/> Conditional Use <input type="checkbox"/> Interpretation <input type="checkbox"/> Approved <input type="checkbox"/> Denied Date: | Historic Preservation <input checked="" type="checkbox"/> Not in District or Landmark <input type="checkbox"/> Does Not Require Review <input type="checkbox"/> Requires Review <input type="checkbox"/> Approved <input type="checkbox"/> Approved w/Conditions <input type="checkbox"/> Denied Date: |
|--|--|---|--|

CERTIFICATION

I hereby certify that I am the owner of record of the named property, or that the proposed work is authorized by the owner of record and that I have been authorized by the owner to make this application as his authorized agent and I agree to conform to all applicable laws of this jurisdiction. In addition, if a permit for work described in the application is issued, I certify that the code official's authorized representative shall have the authority to enter all areas covered by such permit at any reasonable hour to enforce the provision of the code(s) applicable to such permit.

| | | | |
|---|---------|------|-------|
| SIGNATURE OF APPLICANT | ADDRESS | DATE | PHONE |
| RESPONSIBLE PERSON IN CHARGE OF WORK, TITLE | | DATE | PHONE |

03-
#1174

All Purpose Building Permit Application

If you or the property owner owes real estate or personal property taxes or user charges on any property within the City, payment arrangements must be made before permits of any kind are accepted.

| | | |
|--|---|--|
| Location/Address of Construction: <u>910 Washington Ave</u> | | |
| Total Square Footage of Proposed Structure <u>80</u> | Square Footage of Lot <u>6324</u> | |
| Tax Assessor's Chart, Block & Lot Chart# Block# Lot# <u>170 - B - 004 - 001</u> | Owner: <u>Jacelyne Deraspe</u> | Telephone: <u>653-6760</u> |
| Lessee/Buyer's Name (If Applicable) | Applicant name, address & telephone: <u>Jacelyne DERASPE</u> <u>910 WASHINGTON AVE.</u> <u>Portland ME</u> | Cost Of Work: \$ <u>975.00</u> Fee: \$ <u>30.00</u> |
| Current use: <u>Shed</u> <u>Portland ME</u> <u>04103</u> | | |
| If the location is currently vacant, what was prior use: _____ | | |
| Approximately how long has it been vacant: _____ | | |
| Proposed use: <u>shed - located in backyard to store</u> | | |
| Project description: <u>LAWN CARE EQUIPMENT</u> | | |
| Contractor's name, address & telephone: <u>Charlie Colson 353-2660</u> | | |
| Who should we contact when the permit is ready: <u>Jacelyne Deraspe</u> | | |
| Mailing address: <u>910 WASHINGTON AVE.</u> <u>Portland, ME 04103</u> | | |
| We will contact you by phone when the permit is ready. You must come in and pick up the permit and review the requirements before starting any work, with a Plan Reviewer. A stop work order will be issued and a \$100.00 fee if any work starts before the permit is picked up. PHONE: <u>653-6760</u> | | |

IF THE REQUIRED INFORMATION IS NOT INCLUDED IN THE SUBMISSIONS THE PERMIT WILL BE AUTOMATICALLY DENIED AT THE DISCRETION OF THE BUILDING/PLANNING DEPARTMENT, WE MAY REQUIRE ADDITIONAL INFORMATION IN ORDER TO APPROVE THIS PERMIT.

I hereby certify that I am the Owner of record of the named property, or that the owner of record authorizes the proposed work and that I have been authorized by the owner to make this application as his/her authorized agent. I agree to conform to all applicable laws of this jurisdiction. In addition, if a permit for work described in this application is issued, I certify that the Code Official's authorized representative shall have the authority to enter all areas covered by this permit at any reasonable hour to enforce the provisions of the codes applicable to this permit.

| | |
|---|---------------------|
| Signature of applicant: <u>Jacelyne Deraspe</u> | Date: <u>9-2-03</u> |
|---|---------------------|

This is NOT a permit, you may not commence ANY work until the permit is issued. If you are in a Historic District you may be subject to additional permitting and fees with the Planning Department on the 4th floor of City Hall

5 x 6 1/2 Piped Roof Sheat

Seton 6x8x16 Cement Blocks

Roof:

2x6-16oc

3/4" OSB Plywood

Walls-2x4-16oc

Plates

2x4- Single Bottom

2x4- Doubles Top

Rafters-

2x4-16oc

Roof-

7/16 OSB

Shingles

2x4

Studs

5/8 2x11

Utility Sheds, Decks & Steps

353-2660

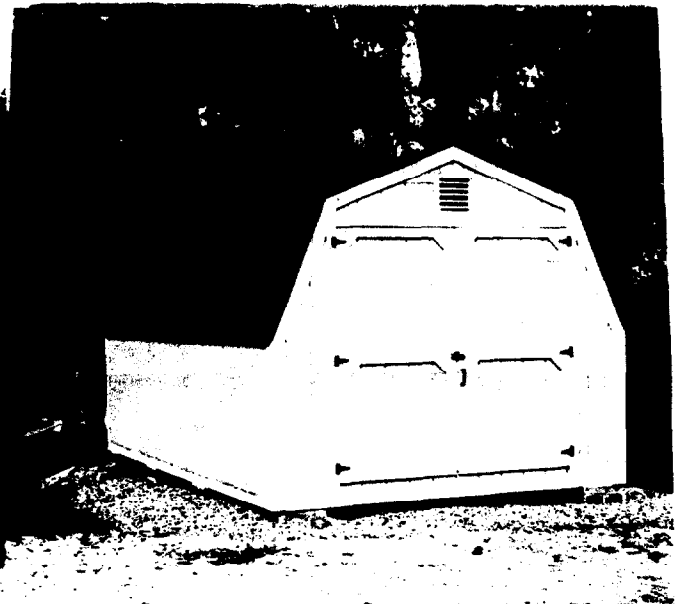
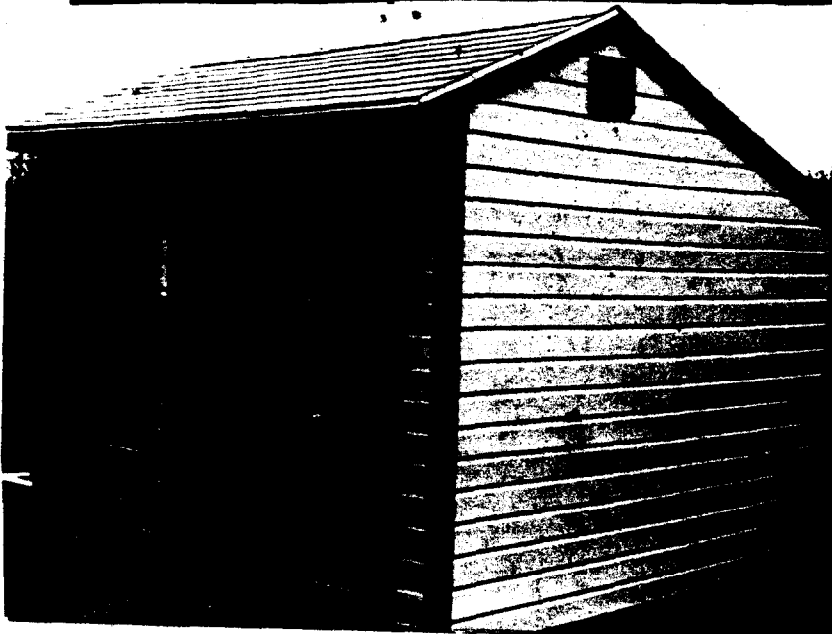

Utility Sheds

Available in 3 Different Styles:

Gambrel

A-Frame

&

Salt Box

All available in 8ft Or 10ft widths

Custom Built

Steps & Decks on request

For Hard to Reach Areas

We will Build on Site



May Be Seen on Rt. 196,
Lisbon, Maine

(Across From the Dormer Motel)

Charles Colson - owner

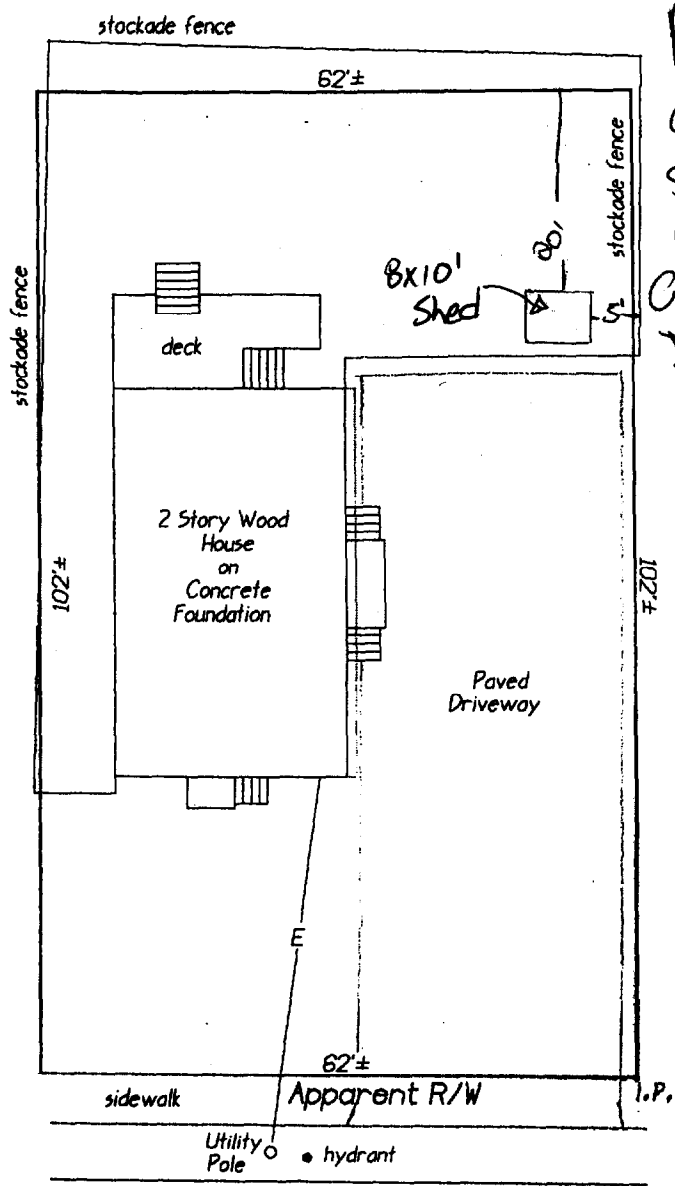
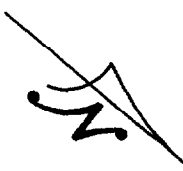

R.S zone
accessory
structures 100'±
under can be
a min. of 5' from
Property Lines

910 Washington Avenue Conco

PORTLAND, MAINE 04103

owner = Jocelyne Deraspe

This page contains a detailed description of the Parcel ID you selected. Press the **New Search** button at the bottom of the screen to submit a new query.

Current Owner Information

| | |
|----------------------|---|
| Card Number | 1 of 1 |
| Parcel ID | 170 8004001 |
| Location | 910 WASHINGTON AVE |
| Land Use | TWO FAMILY |
| | |
| Owner Address | DERASPE JOCELYNE 910 WASHINGTON AVE PORTLAND ME 04103 |
| | |
| Book/Page | 17378/280 |
| Legal | 170-B-4 WASHINGTON AVE 908-910 6324 SF |

Valuation Information

| | | |
|-------------|-----------------|--------------|
| Land | Building | Total |
| \$31,610 | \$89,670 | \$121,280 |

Property Information

| | | | | | |
|-------------------|-------------------|---------------------|--------------------|--------------------|-----------------|
| Year Built | Style | Story Height | Sq. Ft. | Total Acres | |
| 1987 | Duplex | 2 | 1720 | 0.145 | |
| | | | | | |
| Bedrooms | Full Baths | Half Baths | Total Rooms | Attic | Basement |
| 4 | 2 | 2 | 10 | None | Full |

Outbuildings

| | | | | | |
|-------------|-----------------|-------------------|-------------|--------------|------------------|
| Type | Quantity | Year Built | Size | Grade | Condition |
|-------------|-----------------|-------------------|-------------|--------------|------------------|

Sales Information

| | | | |
|-------------|---------------|--------------|------------------|
| Date | Type | Price | Book/Page |
| 03/01/2002 | LAND + BLDING | \$177,000 | 17378-280 |
| 06/01/1994 | LAND + BLDING | | 11501-001 |

Picture and Sketch

| | |
|----------------|---------------|
| <u>Picture</u> | <u>Sketch</u> |
|----------------|---------------|

[Click here](#) to view Tax Roll Information.

Any information concerning tax payments should be directed to the Treasury office at 874-8490 or e-mailed.





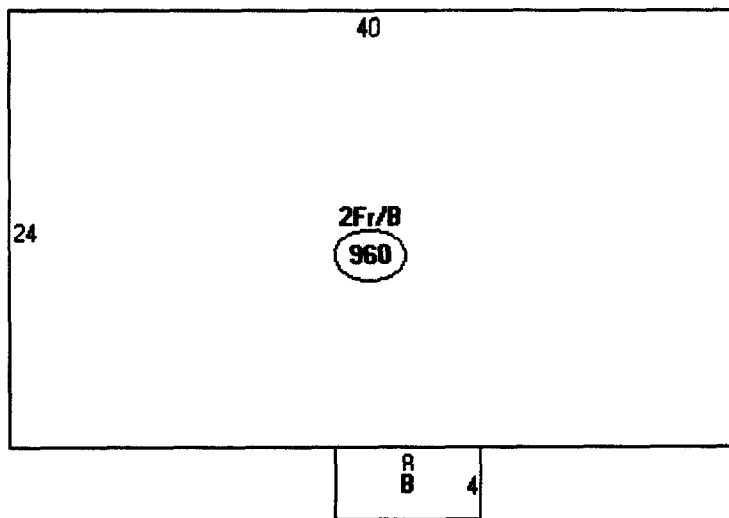

Descriptor/Area

A: 2Fr/B
960 sqft

B: WD
32 sqft

11212 N. Halsted St.

CHICAGO, ILL.

1. Name of Applicant: [Illegible]

2. Name of Contractor: [Illegible]

3. Name of Architect: [Illegible]

4. Name of Engineer: [Illegible]

5. Name of Surveyor: [Illegible]

6. Name of Inspector: [Illegible]

7. Name of Inspector: [Illegible]

8. Name of Inspector: [Illegible]

9. Name of Inspector: [Illegible]

10. Name of Inspector: [Illegible]

11. Name of Inspector: [Illegible]

12. Name of Inspector: [Illegible]

13. Name of Inspector: [Illegible]

14. Name of Inspector: [Illegible]

15. Name of Inspector: [Illegible]

16. Name of Inspector: [Illegible]

17. Name of Inspector: [Illegible]

18. Name of Inspector: [Illegible]

19. Name of Inspector: [Illegible]

20. Name of Inspector: [Illegible]

21. Name of Inspector: [Illegible]

22. Name of Inspector: [Illegible]

23. Name of Inspector: [Illegible]

24. Name of Inspector: [Illegible]

25. Name of Inspector: [Illegible]

26. Name of Inspector: [Illegible]

27. Name of Inspector: [Illegible]

28. Name of Inspector: [Illegible]

29. Name of Inspector: [Illegible]

30. Name of Inspector: [Illegible]

31. Name of Inspector: [Illegible]

32. Name of Inspector: [Illegible]

33. Name of Inspector: [Illegible]

34. Name of Inspector: [Illegible]

35. Name of Inspector: [Illegible]

36. Name of Inspector: [Illegible]

37. Name of Inspector: [Illegible]

38. Name of Inspector: [Illegible]

39. Name of Inspector: [Illegible]

40. Name of Inspector: [Illegible]

41. Name of Inspector: [Illegible]

42. Name of Inspector: [Illegible]

43. Name of Inspector: [Illegible]

44. Name of Inspector: [Illegible]

45. Name of Inspector: [Illegible]

46. Name of Inspector: [Illegible]

47. Name of Inspector: [Illegible]

48. Name of Inspector: [Illegible]

49. Name of Inspector: [Illegible]

50. Name of Inspector: [Illegible]

51. Name of Inspector: [Illegible]

52. Name of Inspector: [Illegible]

53. Name of Inspector: [Illegible]

54. Name of Inspector: [Illegible]

55. Name of Inspector: [Illegible]

56. Name of Inspector: [Illegible]

57. Name of Inspector: [Illegible]

58. Name of Inspector: [Illegible]

59. Name of Inspector: [Illegible]

60. Name of Inspector: [Illegible]

61. Name of Inspector: [Illegible]

62. Name of Inspector: [Illegible]

63. Name of Inspector: [Illegible]

64. Name of Inspector: [Illegible]

65. Name of Inspector: [Illegible]

66. Name of Inspector: [Illegible]

67. Name of Inspector: [Illegible]

68. Name of Inspector: [Illegible]

69. Name of Inspector: [Illegible]

70. Name of Inspector: [Illegible]

71. Name of Inspector: [Illegible]

72. Name of Inspector: [Illegible]

73. Name of Inspector: [Illegible]

74. Name of Inspector: [Illegible]

75. Name of Inspector: [Illegible]

76. Name of Inspector: [Illegible]

77. Name of Inspector: [Illegible]

78. Name of Inspector: [Illegible]

79. Name of Inspector: [Illegible]

80. Name of Inspector: [Illegible]

81. Name of Inspector: [Illegible]

82. Name of Inspector: [Illegible]

83. Name of Inspector: [Illegible]

84. Name of Inspector: [Illegible]

85. Name of Inspector: [Illegible]

86. Name of Inspector: [Illegible]

87. Name of Inspector: [Illegible]

88. Name of Inspector: [Illegible]

89. Name of Inspector: [Illegible]

90. Name of Inspector: [Illegible]

91. Name of Inspector: [Illegible]

92. Name of Inspector: [Illegible]

93. Name of Inspector: [Illegible]

94. Name of Inspector: [Illegible]

95. Name of Inspector: [Illegible]

96. Name of Inspector: [Illegible]

97. Name of Inspector: [Illegible]

98. Name of Inspector: [Illegible]

99. Name of Inspector: [Illegible]

100. Name of Inspector: [Illegible]

PAID INSURED
WHEELABRATED

CHICAGO BUILDING PERMIT APPLICATION



THE HONGKONG & SHANGHAI BANKING CORPORATION

Change of the under Bonding...
Annually, & requirements of...
Company of Ltd. limited to...
Company of Bonding...

General conditions

Particular conditions

Articles

1923

DISPLAY THIS CARD ON PRINCIPAL FRONTAGE OF WORK

CITY OF PORTLAND

BUILDING INSPECTION

PERMIT

PERMIT ISSUED

Permit Number: 031174

SEP 25 2003

Please Read Application And Notes, if Any, Attached

This is to certify that Deraspe Jocelyne /Charles on

has permission to Install 8x10 wood frame she

CITY OF PORTLAND

AT 910 Washington Ave L 170 B004001

provided that the person or persons who accept this permit shall comply with all of the provisions of the Statutes of the State and of the Ordinances of the City of Portland regulating the construction, maintenance and use of buildings and structures, and of the application on file in this department.

Apply to Public Works for street line and grade if nature of work requires such information.

Notification of inspection must be given and when permission proceeds before this building or part thereof is issued or service closed-in. YOUR NOTICE REQUIRED.

A certificate of occupancy must be procured by owner before this building or part thereof is occupied.

OTHER REQUIRED APPROVALS

Fire Dept. _____

Health Dept. _____

Appeal Board _____

Other _____
Department Name

Janie Bowke 9/25/03
Director - Building & Inspection Services

PENALTY FOR REMOVING THIS CARD