

**City of Portland, Maine - Building or Use Permit Application**  
 389 Congress Street, 04101 Tel: (207) 874-8703, Fax: (207) 874-8716

<b>Permit No:</b> 07-1230	<b>Issue Date:</b>	<b>CBL:</b> 169 A031001
------------------------------	--------------------	----------------------------

<b>Location of Construction:</b> 33 PROVIDENCE ST	<b>Owner Name:</b> PLOURDE MARK	<b>Owner Address:</b> 33 PROVIDENCE ST	<b>Phone:</b>
<b>Business Name:</b>	<b>Contractor Name:</b> Jim White	<b>Contractor Address:</b> 2 Farwell Court Westbrook	<b>Phone</b> 2078784621
<b>Lessee/Buyer's Name</b>	<b>Phone:</b>	<b>Permit Type:</b> Additions - Dwellings	<b>Zone:</b>

<b>Past Use:</b> Single Family Home	<b>Proposed Use:</b> Single Family Home - Add front porch w/ roof	<b>Permit Fee:</b> \$50.00	<b>Cost of Work:</b> \$2,900.00	<b>CEO District:</b> 4
<b>Proposed Project Description:</b> Add front porch w/ roof		<b>FIRE DEPT:</b> <input type="checkbox"/> Approved <input type="checkbox"/> Denied	<b>INSPECTION:</b> Use Group: Type	
		Signature:	Signature:	
<b>PEDESTRIAN ACTIVITIES DISTRICT (P.A.D.)</b>				
Action <input type="checkbox"/> Approved <input type="checkbox"/> Approved w/Condition <input type="checkbox"/> Denied				
		Signature:	Date:	

<b>Permit Taken By:</b> ldobson	<b>Date Applied For:</b> 10/01/2007	<b>Zoning Approval</b>		
------------------------------------	--	------------------------	--	--

1. This permit application does not preclude the Applicant(s) from meeting applicable State and Federal Rules.
2. Building permits do not include plumbing, septic or electrical work.
3. Building permits are void if work is not started within six (6) months of the date of issuance. False information may invalidate a building permit and stop all work..

<b>Special Zone or Reviews</b>	<b>Zoning Appeal</b>	<b>Historic Preservation</b>
<input type="checkbox"/> Shoreland	<input type="checkbox"/> Variance	<input type="checkbox"/> Not in District or Landma
<input type="checkbox"/> Wetland	<input type="checkbox"/> Miscellaneous	<input type="checkbox"/> Does Not Require Revie
<input type="checkbox"/> Flood Zon	<input type="checkbox"/> Conditional Us	<input type="checkbox"/> Requires Review
<input type="checkbox"/> Subdivision	<input type="checkbox"/> Interpretatio	<input type="checkbox"/> Approved
<input type="checkbox"/> Site Plan	<input type="checkbox"/> Approved	<input type="checkbox"/> Approved w/Condition
Maj <input type="checkbox"/> Mino <input type="checkbox"/> MM <input type="checkbox"/>	<input type="checkbox"/> Denied	<input type="checkbox"/> Denied
Date:	Date:	Date:

**CERTIFICATION**

I hereby certify that I am the owner of record of the named property, or that the proposed work is authorized by the owner of record and that I have been authorized by the owner to make this application as his authorized agent and I agree to conform to all applicable laws of this jurisdiction. In addition, if a permit for work described in the application is issued, I certify that the code official's authorized representative shall have the authority to enter all areas covered by such permit at any reasonable hour to enforce the provision of the code(s) applicable to such permit.

SIGNATURE OF APPLICAN	ADDRESS	DATE	PHO
RESPONSIBLE PERSON IN CHARGE OF WORK, TIT		DATE	PHO

<b>Location of Construction:</b> 33 PROVIDENCE ST	<b>Owner Name:</b> PLOURDE MARK	<b>Owner Address:</b> 33 PROVIDENCE ST	<b>Phone:</b>
<b>Business Name:</b>	<b>Contractor Name:</b> Jim White	<b>Contractor Address:</b> 2 Farwell Court Westbrook	<b>Phone</b> 2078784621
<b>Lessee/Buyer's Name</b>	<b>Phone:</b>	<b>Permit Type:</b> Additions - Dwellings	<b>Zone:</b>

<b>Dept:</b> Zoning	<b>Status:</b> Pending	<b>Reviewer:</b> Tom Markley	<b>Approval Date:</b>	<b>Ok to Issue:</b> <input type="checkbox"/>
<b>Note:</b>				
<b>Dept:</b> Building	<b>Status:</b> Pending	<b>Reviewer:</b>	<b>Approval Date:</b>	<b>Ok to Issue:</b> <input type="checkbox"/>
<b>Note:</b>				

### CERTIFICATION

I hereby certify that I am the owner of record of the named property, or that the proposed work is authorized by the owner of record and that I have been authorized by the owner to make this application as his authorized agent and I agree to conform to all applicable laws of this jurisdiction. In addition, if a permit for work described in the application is issued, I certify that the code official's authorized representative shall have the authority to enter all areas covered by such permit at any reasonable hour to enforce the provision of the code(s) applicable to such permit.

---

SIGNATURE OF APPLICAN

ADDRESS

DATE

PHO

---

RESPONSIBLE PERSON IN CHARGE OF WORK, TIT

DATE

PHO

# DISPLAY THIS CARD ON PRINCIPAL FRONTAGE OF WORK CITY OF PORTLAND

BUILDING DEPARTMENT

## PERMIT

Permit Number: 071230

Please Read  
Application And  
Notes, if Any,  
Attached

This is to certify that PLOURDE MARK /Jim Wh

has permission to Add front porch w/ roof

AT 33 PROVIDENCE ST

169 A031001

PERMIT ISSUED

OCT - 2

provided that the person or persons, firm or corporation accepting this permit shall comply with all of the provisions of the Statutes of Maine and of the Ordinances of the City of Portland regulating the construction, maintenance and use of buildings and structures, and of the application on file in this department.

Apply to Public Works for street line and grade if nature of work requires such information.

Notification of inspection must be given and written permission procured before this building or part thereof is altered or closed-in. **HEAR NOTICE IS REQUIRED.**

A certificate of occupancy must be procured by owner before this building or part thereof is occupied.

### OTHER REQUIRED APPROVALS

Fire Dept. \_\_\_\_\_

Health Dept. \_\_\_\_\_

Appeal Board \_\_\_\_\_

Other \_\_\_\_\_

Department Name

*Thomas M. Morley* 10/2/07  
Director - Building & Inspection Services

**PENALTY FOR REMOVING THIS CARD**

**City of Portland, Maine - Building or Use Permit Application**

389 Congress Street, 04101 Tel: (207) 874-8703, Fax: (207) 874-8716

Permit No: 07-1230	Issue Date:	CBL: 169 A031001
-----------------------	-------------	---------------------

Location of Construction: 33 PROVIDENCE ST	Owner Name: PLOURDE MARK	Owner Address: 33 PROVIDENCE ST	Phone:
Business Name:	Contractor Name: Jim White	Contractor Address: 2 Farwell Court Westbrook	Phone 2078784621
Lessee/Buyer's Name	Phone:	Permit Type: Additions - Dwellings	Zone: R5

Past Use: Single Family Home	Proposed Use: Single Family Home - Add front porch w/ roof	Permit Fee: \$50.00	Cost of Work: \$2,900.00	CEO District: 4
Proposed Project Description: Add front porch w/ roof		FIRE DEPT: <input type="checkbox"/> Approved <input type="checkbox"/> Denied	INSPECTION: Use Group: R3 Type: SB IRC 2003 Signature: Jm 10/02/07	

PEDESTRIAN ACTIVITIES DISTRICT (P.A.D.)

Action:  Approved  Approved w/Conditions  Denied

Signature: \_\_\_\_\_ Date: \_\_\_\_\_

Permit Taken By: ldobson	Date Applied For: 10/01/2007	<b>Zoning Approval</b>	
-----------------------------	---------------------------------	------------------------	--

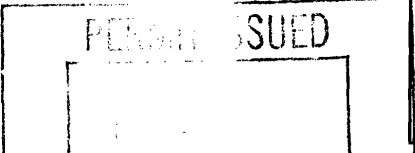
<p>1. This permit application does not preclude the Applicant(s) from meeting applicable State and Federal Rules.</p> <p>2. Building permits do not include plumbing, septic or electrical work.</p> <p>3. Building permits are void if work is not started within six (6) months of the date of issuance. False information may invalidate a building permit and stop all work..</p>	<p><b>Special Zone or Reviews</b></p> <p><input type="checkbox"/> Shoreland</p> <p><input type="checkbox"/> Wetland</p> <p><input type="checkbox"/> Flood Zone</p> <p><input type="checkbox"/> Subdivision</p> <p><input type="checkbox"/> Site Plan</p> <p>Maj <input type="checkbox"/> Minor <input type="checkbox"/> MM <input type="checkbox"/></p> <p>Date: Jm 10/2/07</p>	<p><b>Zoning Appeal</b></p> <p><input type="checkbox"/> Variance</p> <p><input type="checkbox"/> Miscellaneous</p> <p><input type="checkbox"/> Conditional Use</p> <p><input type="checkbox"/> Interpretation</p> <p><input type="checkbox"/> Approved</p> <p><input type="checkbox"/> Denied</p> <p>Date: _____</p>	<p><b>Historic Preservation</b></p> <p><input checked="" type="checkbox"/> Not in District or Landmark</p> <p><input checked="" type="checkbox"/> Does Not Require Review</p> <p><input type="checkbox"/> Requires Review</p> <p><input type="checkbox"/> Approved</p> <p><input type="checkbox"/> Approved w/Conditions</p> <p><input type="checkbox"/> Denied</p> <p>Date: Jm 10/2/07</p>
			

**CERTIFICATION**

I hereby certify that I am the owner of record of the named property, or that the proposed work is authorized by the owner of record and that I have been authorized by the owner to make this application as his authorized agent and I agree to conform to all applicable laws of this jurisdiction. In addition, if a permit for work described in the application is issued, I certify that the code official's authorized representative shall have the authority to enter all areas covered by such permit at any reasonable hour to enforce the provision of the code(s) applicable to such permit.

SIGNATURE OF APPLICANT	ADDRESS	DATE	PHONE
RESPONSIBLE PERSON IN CHARGE OF WORK, TITLE		DATE	PHONE

**City of Portland, Maine - Building or Use Permit**

389 Congress Street, 04101 Tel: (207) 874-8703, Fax: (207) 874-8716

<b>Permit No:</b> 07-1230	<b>Date Applied For:</b> 10/01/2007	<b>CBL:</b> 169 A031001
------------------------------	--	----------------------------

<b>Location of Construction:</b> 33 PROVIDENCE ST	<b>Owner Name:</b> PLOURDE MARK	<b>Owner Address:</b> 33 PROVIDENCE ST	<b>Phone:</b>
<b>Business Name:</b>	<b>Contractor Name:</b> Jim White	<b>Contractor Address:</b> 2 Farwell Court Westbrook	<b>Phone</b> (207) 878-4621
<b>Lessee/Buyer's Name</b>	<b>Phone:</b>	<b>Permit Type:</b> Additions - Dwellings	

<b>Proposed Use:</b> Single Family Home - Add front porch w/ roof	<b>Proposed Project Description:</b> Add front porch w/ roof
--	---

<b>Dept:</b> Zoning	<b>Status:</b> Approved with Conditions	<b>Reviewer:</b> Tom Markley	<b>Approval Date:</b> 10/02/2007
<b>Note:</b>			<b>Ok to Issue:</b> <input checked="" type="checkbox"/>
1) This property shall remain a single family dwelling. Any change of use shall require a separate permit application for review and approval.			
2) This permit is being approved on the basis of plans submitted. Any deviations shall require a separate approval before starting that work.			

<b>Dept:</b> Building	<b>Status:</b> Approved with Conditions	<b>Reviewer:</b> Tom Markley	<b>Approval Date:</b> 10/02/2007
<b>Note:</b>			<b>Ok to Issue:</b> <input checked="" type="checkbox"/>
1) Application approval based upon information provided by applicant. Any deviation from approved plans requires separate review and approval prior to work.			
2) Separate permits are required for any electrical, plumbing, or HVAC systems. Separate plans may need to be submitted for approval as a part of this process.			



# General Building Permit Application

If you or the property owner owes real estate or personal property taxes or user charges on any property within the City, payment arrangements must be made before permits of any kind are accepted.

Location/Address of Construction: <u>33 Providence St</u>		
Total Square Footage of Proposed Structure/Area <u>288</u>		Square Footage of Lot <u>12,184</u>
Tax Assessor's Chart, Block & Lot Chart# <u>169</u> Block# <u>A</u> Lot# <u>31</u>	Applicant * <u>must be owner, Lessee or Buyer</u> * Name <u>Mark Plourde</u> Address <u>33 Providence St.</u> City, State & Zip <u>Portland Me 04103</u>	Telephone: <u>415-8683</u>
Lessee/DBA (If Applicable)	Owner (if different from Applicant) Name Address City, State & Zip	Cost Of Work: \$ <u>2900,00</u> C of O Fee: \$ _____ Total Fee: \$ _____
Current legal use (i.e. single family) <u>single family</u> If vacant, what was the previous use? _____ Proposed Specific use: _____ Is property part of a subdivision? <u>No</u> If yes, please name _____ Project description: <u>Front Porch with Roof</u>		
Contractor's name: <u>Jim White</u> Address: <u>2 Farwell Ct.</u> City, State & Zip <u>Westbrook Me 04092</u> Telephone: <u>878-3361</u> Who should we contact when the permit is ready: <u>Mark Plourde</u> Telephone: <u>415-8683</u> Mailing address: <u>33 Providence St. Portland Me 04103</u>		

**Please submit all of the information outlined on the applicable Checklist. Failure to do so will result in the automatic denial of your permit.**

In order to be sure the City fully understands the full scope of the project, the Planning and Development Department may request additional information prior to the issuance of a permit. For further information or to download copies of this form and other applications visit the Inspections Division on-line at [www.portlandmaine.gov](http://www.portlandmaine.gov), or stop by the Inspections Division office, room 315 City Hall or call 874-8703.

I hereby certify that I am the Owner of record of the named property, or that the owner of record authorizes the proposed work and that I have been authorized by the owner to make this application as his/her authorized agent. I agree to conform to all applicable laws of this jurisdiction. In addition, if a permit for work described in this application is issued, I certify that the Code Official's authorized representative shall have the authority to enter all areas covered by this permit at any reasonable hour to enforce the provisions of the codes applicable to this permit.

Signature: [Signature] Date: 10-1-07

**This is not a permit; you may not commence ANY work until the permit is issue**

(2 of 2)

Asphalt Shingles Hip - Roof  $\frac{1}{2}$  Pitch

1' o.H. Roof

Roof  
2x8 Raft.  
16" OC

Door

8'

8" Posts  
Pre-Installed  
Posts

30'

28'

7 1/2' Posts

50" net tread  
4 FT  
4 FT

Minimum 10"

3/4 - 1 1/2 NOSING

Post Tubes

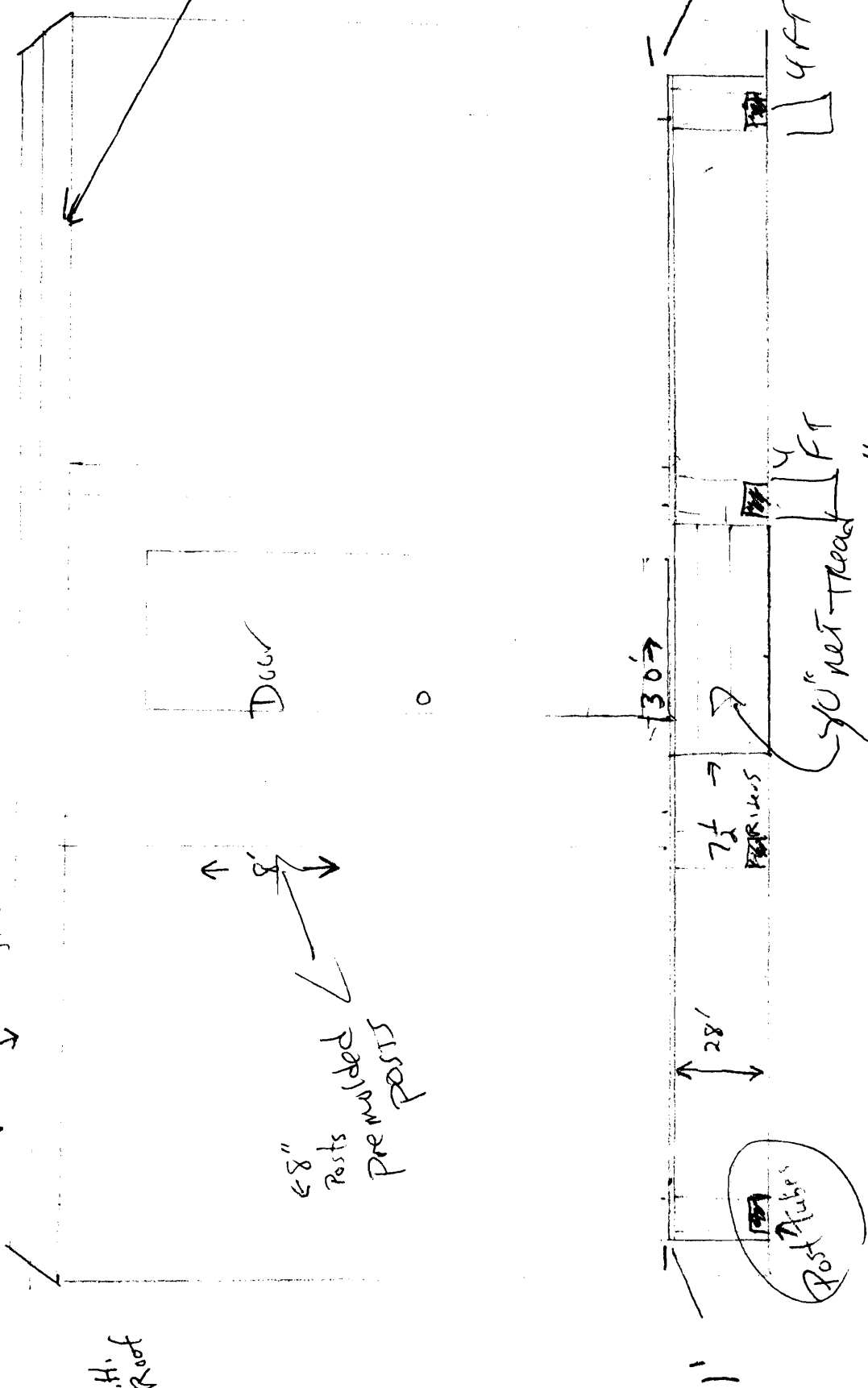

(1 of 2)

← 33 Providence st. →  
↓

- 2x8 T.T. Frame 16" O.C. ✓
- Trick Decking ✓
- (3) Risers 7 1/2 ✓
- Roof 2x8 KD 16" O.C. ✓
- Advanced sheath ✓
- asph/ft shingles ✓

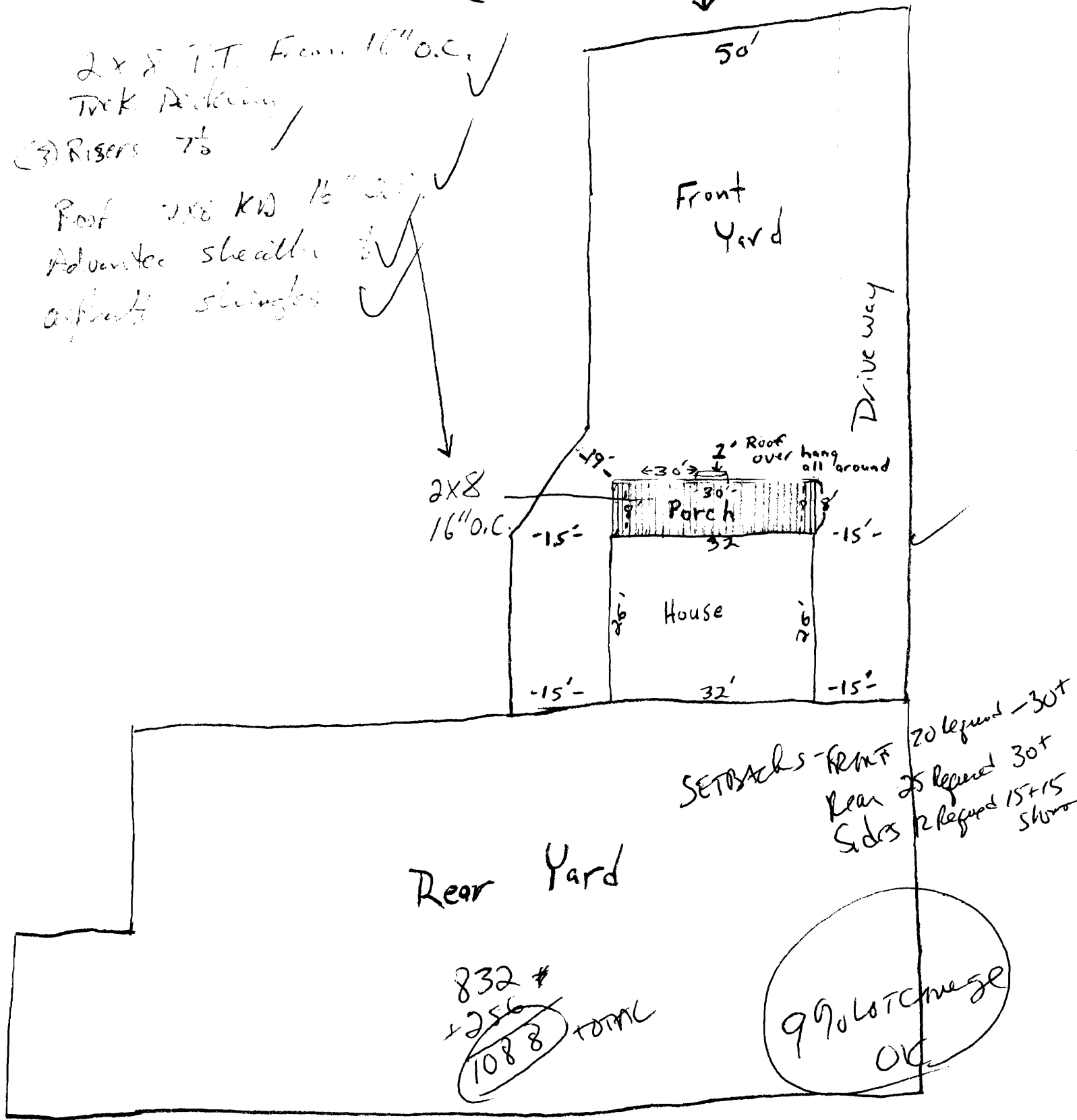

ATT: TOM M...





# DISPLAY THIS CARD ON PRINCIPAL FRONTAGE OF WORK CITY OF PORTLAND

Please Read Application And Notes, If Any, Attached

BUILDING DEPARTMENT

## PERMIT

Permit Number: 071230

PERMIT ISSUED

OCT - 2

This is to certify that PLOURDE MARK /Jim Wh

has permission to Add front porch w/ roof

AT 33 PROVIDENCE ST

169 A031001

provided that the person or persons, firm or corporation accepting this permit shall comply with all of the provisions of the Statutes of Maine and of the Ordinances of the City of Portland regulating the construction, maintenance and use of buildings and structures, and of the application on file in this department.

Apply to Public Works for street line and grade if nature of work requires such information.

Notification of inspection must be given and written permission procured before this building or part thereof is loaded or occupied. CLOSED-IN. HOURS NOTICE IS REQUIRED.

A certificate of occupancy must be procured by owner before this building or part thereof is occupied.

### OTHER REQUIRED APPROVALS

Fire Dept. \_\_\_\_\_

Health Dept. \_\_\_\_\_

Appeal Board \_\_\_\_\_

Other \_\_\_\_\_

Department Name

*Thomas M. Mackley* 10/2/07  
Director - Building & Inspection Services

**PENALTY FOR REMOVING THIS CARD**

**City of Portland, Maine - Building or Use Permit Application**

389 Congress Street, 04101 Tel: (207) 874-8703, Fax: (207) 874-8716

Permit No: 07-1230	Issue Date:	CBL: 169 A031001
-----------------------	-------------	---------------------

Location of Construction: 33 PROVIDENCE ST	Owner Name: PLOURDE MARK	Owner Address: 33 PROVIDENCE ST	Phone:
Business Name:	Contractor Name: Jim White	Contractor Address: 2 Farwell Court Westbrook	Phone 2078784621
Lessee/Buyer's Name	Phone:	Permit Type: Additions - Dwellings	Zone: R5

Past Use: Single Family Home	Proposed Use: Single Family Home - Add front porch w/ roof	Permit Fee: \$50.00	Cost of Work: \$2,900.00	CEO District: 4
		FIRE DEPT: <input type="checkbox"/> Approved <input type="checkbox"/> Denied	INSPECTION: Use Group: R3 Type: SB IRC 2003	

Proposed Project Description: Add front porch w/ roof	Signature:	Signature: <i>Jm 10/02/07</i>
PEDESTRIAN ACTIVITIES DISTRICT (P.A.D.)		
Action: <input type="checkbox"/> Approved <input type="checkbox"/> Approved w/Conditions <input type="checkbox"/> Denied		
Signature:	Date:	

Permit Taken By: Idobson	Date Applied For: 10/01/2007	<b>Zoning Approval</b>
-----------------------------	---------------------------------	------------------------

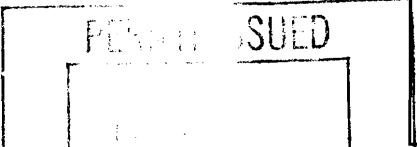
<p>1. This permit application does not preclude the Applicant(s) from meeting applicable State and Federal Rules.</p> <p>2. Building permits do not include plumbing, septic or electrical work.</p> <p>3. Building permits are void if work is not started within six (6) months of the date of issuance. False information may invalidate a building permit and stop all work..</p>	<p>Special Zone or Reviews</p> <input type="checkbox"/> Shoreland <input type="checkbox"/> Wetland <input type="checkbox"/> Flood Zone <b>OK</b> <input type="checkbox"/> Subdivision <input type="checkbox"/> Site Plan Maj <input type="checkbox"/> Minor <input type="checkbox"/> MM <input type="checkbox"/> Date: <i>Jm 10/2/07</i>	<p>Zoning Appeal</p> <input type="checkbox"/> Variance <input type="checkbox"/> Miscellaneous <input type="checkbox"/> Conditional Use <input type="checkbox"/> Interpretation <input type="checkbox"/> Approved <input type="checkbox"/> Denied Date:	<p>Historic Preservation</p> <input checked="" type="checkbox"/> Not in District or Landmark <input checked="" type="checkbox"/> Does Not Require Review <input type="checkbox"/> Requires Review <input type="checkbox"/> Approved <input type="checkbox"/> Approved w/Conditions <input type="checkbox"/> Denied Date: <i>Jm 10/2/07</i>
			

**CERTIFICATION**

I hereby certify that I am the owner of record of the named property, or that the proposed work is authorized by the owner of record and that I have been authorized by the owner to make this application as his authorized agent and I agree to conform to all applicable laws of this jurisdiction. In addition, if a permit for work described in the application is issued, I certify that the code official's authorized representative shall have the authority to enter all areas covered by such permit at any reasonable hour to enforce the provision of the code(s) applicable to such permit.

SIGNATURE OF APPLICANT	ADDRESS	DATE	PHONE
RESPONSIBLE PERSON IN CHARGE OF WORK, TITLE		DATE	PHONE

**City of Portland, Maine - Building or Use Permit**

389 Congress Street, 04101 Tel: (207) 874-8703, Fax: (207) 874-8716

<b>Permit No:</b> 07-1230	<b>Date Applied For:</b> 10/01/2007	<b>CBL:</b> 169 A031001
------------------------------	--	----------------------------

<b>Location of Construction:</b> 33 PROVIDENCE ST	<b>Owner Name:</b> PLOURDE MARK	<b>Owner Address:</b> 33 PROVIDENCE ST	<b>Phone:</b>
<b>Business Name:</b>	<b>Contractor Name:</b> Jim White	<b>Contractor Address:</b> 2 Farwell Court Westbrook	<b>Phone</b> (207) 878-4621
<b>Lessee/Buyer's Name</b>	<b>Phone:</b>	<b>Permit Type:</b> Additions - Dwellings	

<b>Proposed Use:</b> Single Family Home - Add front porch w/ roof	<b>Proposed Project Description:</b> Add front porch w/ roof
--	---

**Dept:** Zoning      **Status:** Approved with Conditions      **Reviewer:** Tom Markley      **Approval Date:** 10/02/2007

**Note:** **Ok to Issue:**

- 1) This property shall remain a single family dwelling. Any change of use shall require a separate permit application for review and approval.
- 2) This permit is being approved on the basis of plans submitted. Any deviations shall require a separate approval before starting that work.

**Dept:** Building      **Status:** Approved with Conditions      **Reviewer:** Tom Markley      **Approval Date:** 10/02/2007

**Note:** **Ok to Issue:**

- 1) Application approval based upon information provided by applicant. Any deviation from approved plans requires separate review and approval prior to work.
- 2) Separate permits are required for any electrical, plumbing, or HVAC systems. Separate plans may need to be submitted for approval as a part of this process.



# General Building Permit Application

If you or the property owner owes real estate or personal property taxes or user charges on any property within the City, payment arrangements must be made before permits of any kind are accepted.

Location/Address of Construction: <u>33 Providence St</u>		
Total Square Footage of Proposed Structure/Area <u>288</u>		Square Footage of Lot <u>12,184</u>
Tax Assessor's Chart, Block & Lot Chart# <u>169</u> Block# <u>A</u> Lot# <u>31</u>	Applicant * <u>must be owner, Lessee or Buyer</u> * Name <u>Mark Plourde</u> Address <u>33 Providence St.</u> City, State & Zip <u>Portland Me 04103</u>	Telephone: <u>415-8683</u>
Lessee/DBA (If Applicable)	Owner (if different from Applicant) Name Address City, State & Zip	Cost Of Work: \$ <u>2900,00</u> C of O Fee: \$ _____ Total Fee: \$ _____
Current legal use (i.e. single family) <u>single family</u> If vacant, what was the previous use? _____ Proposed Specific use: _____ Is property part of a subdivision? <u>No</u> If yes, please name _____ Project description: <u>Front Porch with Roof</u>		
Contractor's name: <u>Jim White</u> Address: <u>2 Firwell Ct.</u> City, State & Zip <u>Westbrook Me 04092</u> Telephone: <u>878-3361</u> Who should we contact when the permit is ready: <u>Mark Plourde</u> Telephone: <u>415-8683</u> Mailing address: <u>33 Providence St. Portland Me 04103</u>		

**Please submit all of the information outlined on the applicable Checklist. Failure to do so will result in the automatic denial of your permit.**

In order to be sure the City fully understands the full scope of the project, the Planning and Development Department may request additional information prior to the issuance of a permit. For further information or to download copies of this form and other applications visit the Inspections Division on-line at [www.portlandmaine.gov](http://www.portlandmaine.gov), or stop by the Inspections Division office, room 315 City Hall or call 874-8703.

I hereby certify that I am the Owner of record of the named property, or that the owner of record authorizes the proposed work and that I have been authorized by the owner to make this application as his/her authorized agent. I agree to conform to all applicable laws of this jurisdiction. In addition, if a permit for work described in this application is issued, I certify that the Code Official's authorized representative shall have the authority to enter all areas covered by this permit at any reasonable hour to enforce the provisions of the codes applicable to this permit.

Signature: [Signature] Date: 10-10-07

**This is not a permit; you may not commence ANY work until the permit is issued**

(2 of 2)

Asphalt Shingles Hip - Roof  $\frac{1}{2}$  Pitch

1' o.H. Roof

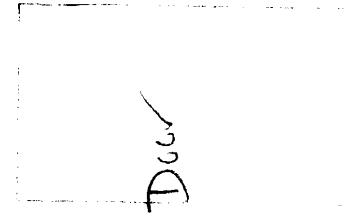

8" Posts  
Pre-welded  
Posts

Roof  
2x8 Ref.  
16" O.C

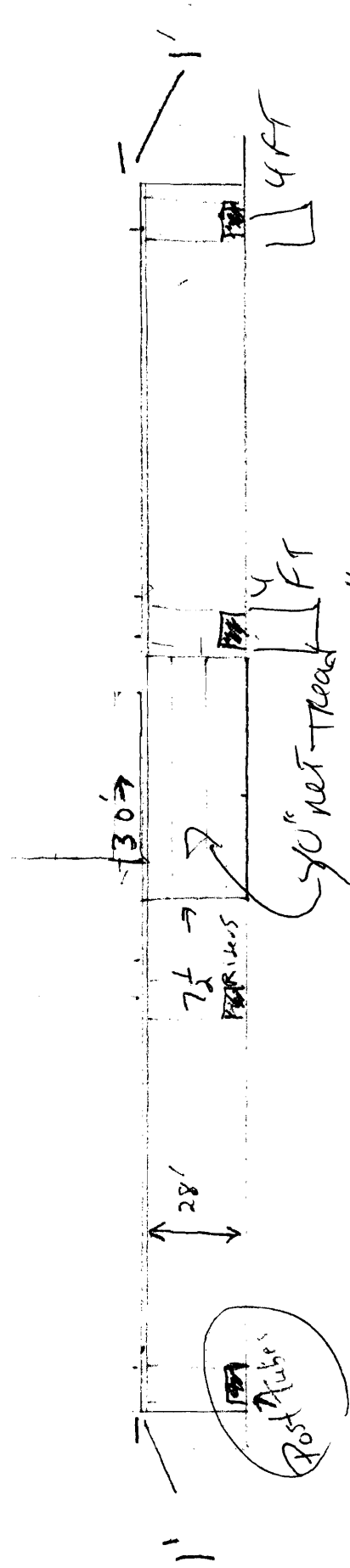

50" net tread  
minimum 10"  
3/4-1 1/2 nosings

(1 of 2)

← 33 Providence st. →

2 x 8 T.T. Frame 16" o.c. ✓  
 Trck Decking ✓  
 (3) Risers 7 1/2 ✓  
 Roof 2 x 8 KD 16" o.c. ✓  
 Advantec sheathing ✓  
 Advantec stringers ✓

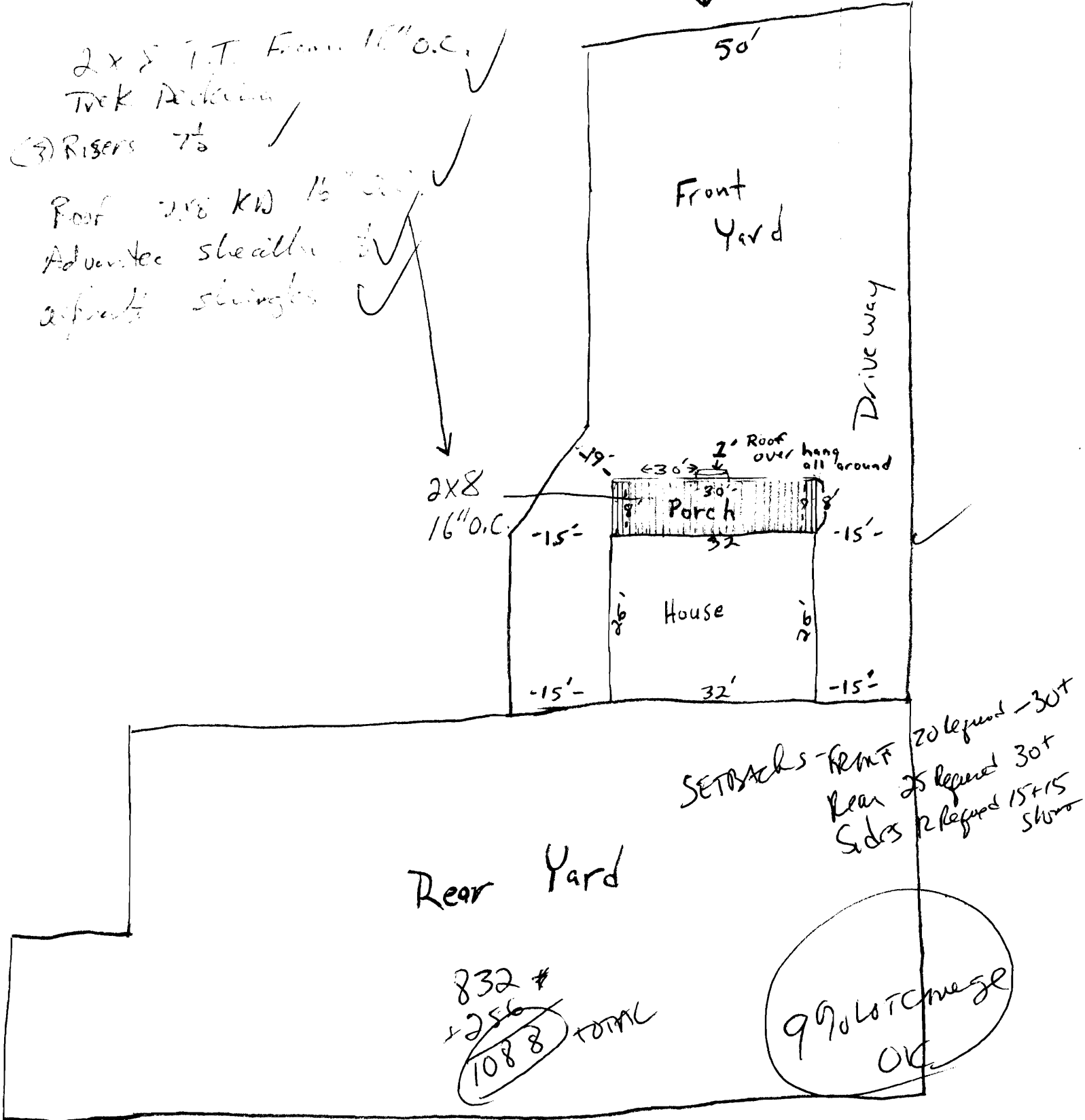

ATT: TOM M...

