

DISPLAY THIS CARD ON PRINCIPAL FRONTAGE OF WORK



CITY OF PORTLAND

BUILDING PERMIT

This is to certify that PATRICIA A POISSANT

Located At 259 SHERWOOD ST

Job ID: 2012-09-4984-ALTR

CBL: 168-H-008-001

has permission to New deck construction

provided that the person or persons, firm or corporation accepting this permit shall comply with all of the provisions of the Statutes of Maine and of the Ordinances of the City of Portland regulating the construction, maintenance and use of the buildings and structures, and of the application on file in the department.

Notification of inspection and written permission procured before this building or part thereof is lathed or otherwise closed-in. 48 HOUR NOTICE IS REQUIRED.

A final inspection must be completed by owner before this building or part thereof is occupied. If a certificate of occupancy is required, it must be

Fire Prevention Officer

Code Enforcement Officer / Plan Reviewer

09-27-12

THIS CARD MUST BE POSTED ON THE STREET SIDE OF THE PROPERTY
PENALTY FOR REMOVING THIS CARD

BUILDING PERMIT INSPECTION PROCEDURES

Please call 874-8703 or 874-8693 (ONLY)

or email: buildinginspections@portlandmaine.gov

With the issuance of this permit, the owner, builder or their designee is required to provide adequate notice to the city of Portland Inspections Services for the following inspections. Appointments must be requested 48 to 72 hours in advance of the required inspection. The inspection date will need to be confirmed by this office.

- **Please read the conditions of approval that is attached to this permit!! Contact this office if you have any questions.**
- **Permits expire in 6 months. If the project is not started or ceases for 6 months.**
- **If the inspection requirements are not followed as stated below additional fees may be incurred due to the issuance of a "Stop Work Order" and subsequent release to continue.**

Footings/Setbacks prior to pouring concrete

Close In Elec/Plmb/Frame prior to insulate or gyp

Final Inspection

The project cannot move to the next phase prior to the required inspection and approval to continue, REGARDLESS OF THE NOTICE OF CIRCUMSTANCES.

IF THE PERMIT REQUIRES A CERTIFICATE OF OCCUPANCY, IT MUST BE PAID FOR AND ISSUED TO THE OWNER OR DESIGNEE BEFORE THE SPACE MAY BE OCCUPIED.



PORTLAND MAINE

Strengthening a Remarkable City, Building a Community for Life • www.portlandmaine.gov

Director of Planning and Urban Development
Jeff Levine

Job ID: 2012-09-4984-ALTR

Located At: 259 SHERWOOD ST

CBL: 168- H-008-001

Conditions of Approval:

Zoning

1. This permit is being approved on the basis of plans submitted. Any deviations shall require a separate approval before starting that work.
2. As discussed during the review process, the property must be clearly identified prior to pouring concrete and compliance with the required setbacks must be established. Due to the proximity of the setbacks of the proposed addition, it may be required to be located by a surveyor.
3. All setbacks are required to be measured from the owner's property lines (not shrubs) to the closest part of the structure. It is the owner's responsibility to know where the property lines are located.
4. This property shall remain a single family dwelling. Any change of use shall require a separate permit application for review and approval.

City of Portland, Maine - Building or Use Permit Application

389 Congress Street, 04101 Tel: (207) 874-8703, FAX: (207) 8716

Job No: 2012-09-4984-ALTR	Date Applied: 9/18/2012	CBL: 168- H-008-001	
Location of Construction: 259 SHERWOOD ST	Owner Name: PATRICIA A POISSANT	Owner Address: 259 SHERWOOD ST PORTLAND, ME 04103	Phone:
Business Name:	Contractor Name: Don Godsoe	Contractor Address: 42 STEPHANIE DR DAYTON, MAINE 04005	Phone: (207) 310-8236
Lessee/Buyer's Name:	Phone:	Permit Type: BLDG ADD	Zone: R-5
Past Use: Single Family Dwelling	Proposed Use: Same: Single Family Dwelling - to install deck on rear & side of house	Cost of Work: \$4,000.00	CEO District:
		Fire Dept: Approved Denied N/A Signature: <i>[Signature]</i>	Inspection: Use Group: R-3 Type: SB IRC 09 Signature: <i>[Signature]</i>
Proposed Project Description: New deck construction		Pedestrian Activities District (P.A.D.)	

Permit Taken By: Brad	Zoning Approval
-----------------------	------------------------

<p>1. This permit application does not preclude the Applicant(s) from meeting applicable State and Federal Rules.</p> <p>2. Building Permits do not include plumbing, septic or electrical work.</p> <p>3. Building permits are void if work is not started within six (6) months of the date of issuance. False informatin may invalidate a building permit and stop all work.</p>	<p>Special Zone or Reviews</p> <p><input type="checkbox"/> Shoreland</p> <p><input type="checkbox"/> Wetlands</p> <p><input type="checkbox"/> Flood Zone</p> <p><input type="checkbox"/> Subdivision</p> <p><input type="checkbox"/> Site Plan</p> <p><input type="checkbox"/> Maj <input type="checkbox"/> Min <input type="checkbox"/> MM</p> <p>Date: <i>ok with condit</i> <i>9/18/12</i></p>	<p>Zoning Appeal</p> <p><input type="checkbox"/> Variance</p> <p><input type="checkbox"/> Miscellaneous</p> <p><input type="checkbox"/> Conditional Use</p> <p><input type="checkbox"/> Interpretation</p> <p><input type="checkbox"/> Approved</p> <p><input type="checkbox"/> Denied</p> <p>Date:</p>	<p>Historic Preservation</p> <p><input checked="" type="checkbox"/> Not in Dist or Landmark</p> <p><input type="checkbox"/> Does not Require Review</p> <p><input type="checkbox"/> Requires Review</p> <p><input type="checkbox"/> Approved</p> <p><input type="checkbox"/> Approved w/Conditions</p> <p><input type="checkbox"/> Denied</p> <p>Date: <i>[Signature]</i></p>
	CERTIFICATION		

I hereby certify that I am the owner of record of the named property, or that the proposed work is authorized by the owner of record and that I have been authorized by the owner to make this application as his authorized agent and I agree to conform to all applicable laws of this jurisdiction. In addition, if a permit for work described in the application is issued, I certify that the code official's authorized representative shall have the authority to enter all areas covered by such permit at any reasonable hour to enforce the provision of the code(s) applicable to such permit.

SIGNATURE OF APPLICANT	ADDRESS	DATE	PHONE
RESPONSIBLE PERSON IN CHARGE OF WORK, TITLE		DATE	PHONE



General Building Permit Application

Extend 9/18/12

If you or the property owner owes real estate or personal property taxes or user charges on any property within the City, payment arrangements must be made before permits of any kind are accepted.

2012-09-4984-ALTER

(B)

Location/Address of Construction: <u>259 Sherwood St Portland</u>		
Total Square Footage of Proposed Structure/Area	Square Footage of Lot <u>80004</u>	Number of Stories
Tax Assessor's Chart, Block & Lot Chart# <u>168</u> Block# <u>H</u> Lot# <u>8 & 9</u>	Applicant *must be owner, Lessee or Buyer* Name <u>Tricia Plasant Poissant</u> Address <u>Same</u> City, State & Zip	Telephone:
Lessee/DBA (If Applicable)	Owner (if different from Applicant) Name Address City, State & Zip	Cost Of Work: \$ <u>4000</u> 2700 C of O Fee: \$ Total Fee: \$ <u>60</u>
<p>RECEIVED SEP 18 2012 Dept. of Building Inspections City of Portland Maine</p>		
Current legal use (i.e. single family) <u>single family</u> Number of Residential Units <u>1</u> If vacant, what was the previous use? Proposed Specific use: <u>leisure</u> Is property part of a subdivision? If yes, please name Project description: <u>install new Deck on Back and side of Houe</u>		
Contractor's name: <u>DON GASSOF</u> Address: <u>42 Stephanie Dr,</u> City, State & Zip: <u>Dayton me 04005</u> Telephone: <u>310-8238</u> Who should we contact when the permit is ready: <u>Home owner</u> Telephone: Mailing address: <u>259 Sherwood St Portland</u>		

Please submit all of the information outlined on the applicable Checklist. Failure to do so will result in the automatic denial of your permit.

In order to be sure the City fully understands the full scope of the project, the Planning and Development Department may request additional information prior to the issuance of a permit. For further information or to download copies of this form and other applications visit the Inspections Division on-line at www.portlandmaine.gov, or stop by the Inspections Division office, room 315 City Hall or call 874-8703.

I hereby certify that I am the Owner of record of the named property, or that the owner of record authorizes the proposed work and that I have been authorized by the owner to make this application as his/her authorized agent. I agree to conform to all applicable laws of this jurisdiction. In addition, if a permit for work described in this application is issued, I certify that the Code Official's authorized representative shall have the authority to enter all areas covered by this permit at any reasonable hour to enforce the provisions of the codes applicable to this permit.

Signature:	Date:
------------	-------

This is not a permit; you may not commence ANY work until the permit is issued



PORTLAND MAINE

Strengthening a Remarkable City, Building a Community for Life • www.portlandmaine.gov

Receipts Details:

Tender Information: Cash
Tender Amount: 60.00

Receipt Header:

Cashier Id: bsaucier
Receipt Date: 9/18/2012
Receipt Number: 48337

Receipt Details:

Reference ID:	8051	Fee Type:	BP-Constr
Receipt Number:	0	Payment Date:	
Transaction Amount:	60.00	Charge Amount:	60.00
Job ID: Job ID: 2012-09-4984-ALTR - New deck construction			
Additional Comments: 259 Sherwood			

Thank You for your Payment!

Stair layout

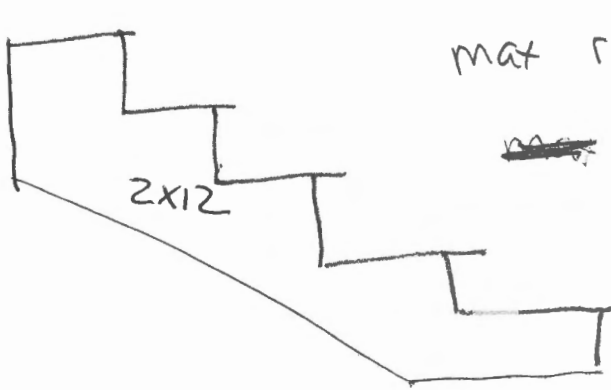

max rise $7\frac{3}{4}$

~~max~~ minimum run 10 inches

one set at 48" wide
one set at 60" wide

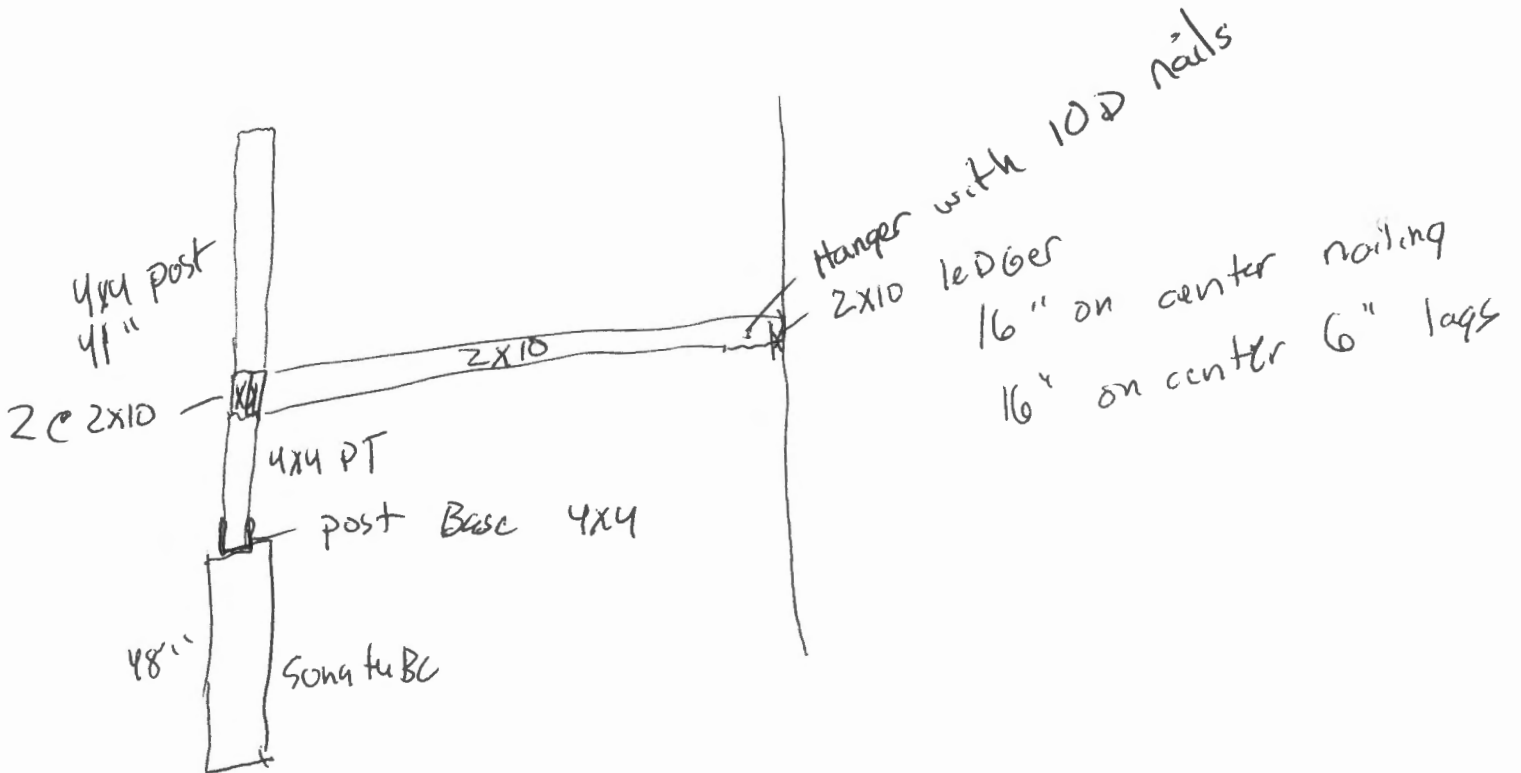
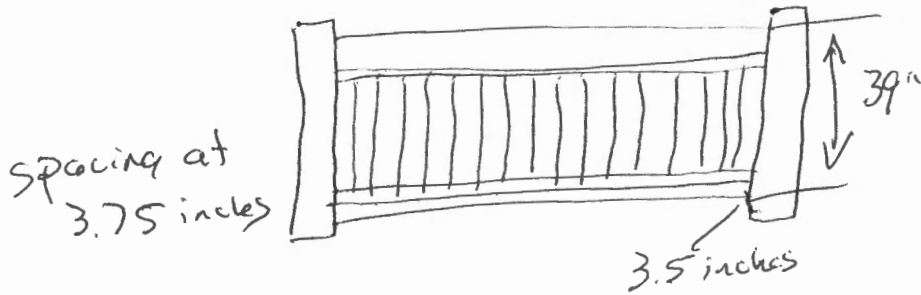

BUILDING A DECK???

INFORMATION REQUIRED WITH YOUR APPLICATION

The following is a guideline of information required for the review of a deck application. It is intended to help you supply proper and complete application packages. Please label all of the following items on your plans. Thank you!

1. A complete plot plan showing all structures & proposed structures with distances to all property lines labeled.

2. Type of foundation system

- a. Diameter of concrete filled tube or pre cast concrete pier size 8' sona tube
- b. depth below grade (minimum 4'-0" below grade) 4'0 Below Ground
- c. anchorage of column to footing Bolt in concrete to 4x4 Base
- d. spacing and location of tubes/piers 2 @ 8' spacing one at 10' spacing

3. Framing Members

- a. Columns - wood size and location (members supporting framing of floor system) 2x10 Beam ^{DOUBLE}
- b. Ledger size attached to building 2x10
- c. Fastener size and spacing attaching ledger nailed 16 in. on center 6" lags at 160.c
- d. Girder Size and spans carrying floor system 10' span on joists 16 O.C.
- e. Joist size, span, and spacing 2x10 10' span 16 O.C.
- f. Joist hangers or ledger

4. Guardrails & Handrail Details

- a. Guardrail height 39"
- b. Baluster spacing 3.75 inches
- c. Handrail height 39"

2 1/2 nags → Hangers to Attach Framing to ledger through nailed on outside EDGE

5. Stair Details

- a. Tread depth (measured nosing to nosing) 11"
- b. Riser height 7 3/4"
- c. Nosing on tread 1"
- d. Width of stairs one at 48" one at 60"

R-S Zone

REAR: 20' min - 30' shown
 Side: 8' min - 10' shown
 Front: 20' min - 30' implied

30 Feet to shrub BS

Existing shop

Property line

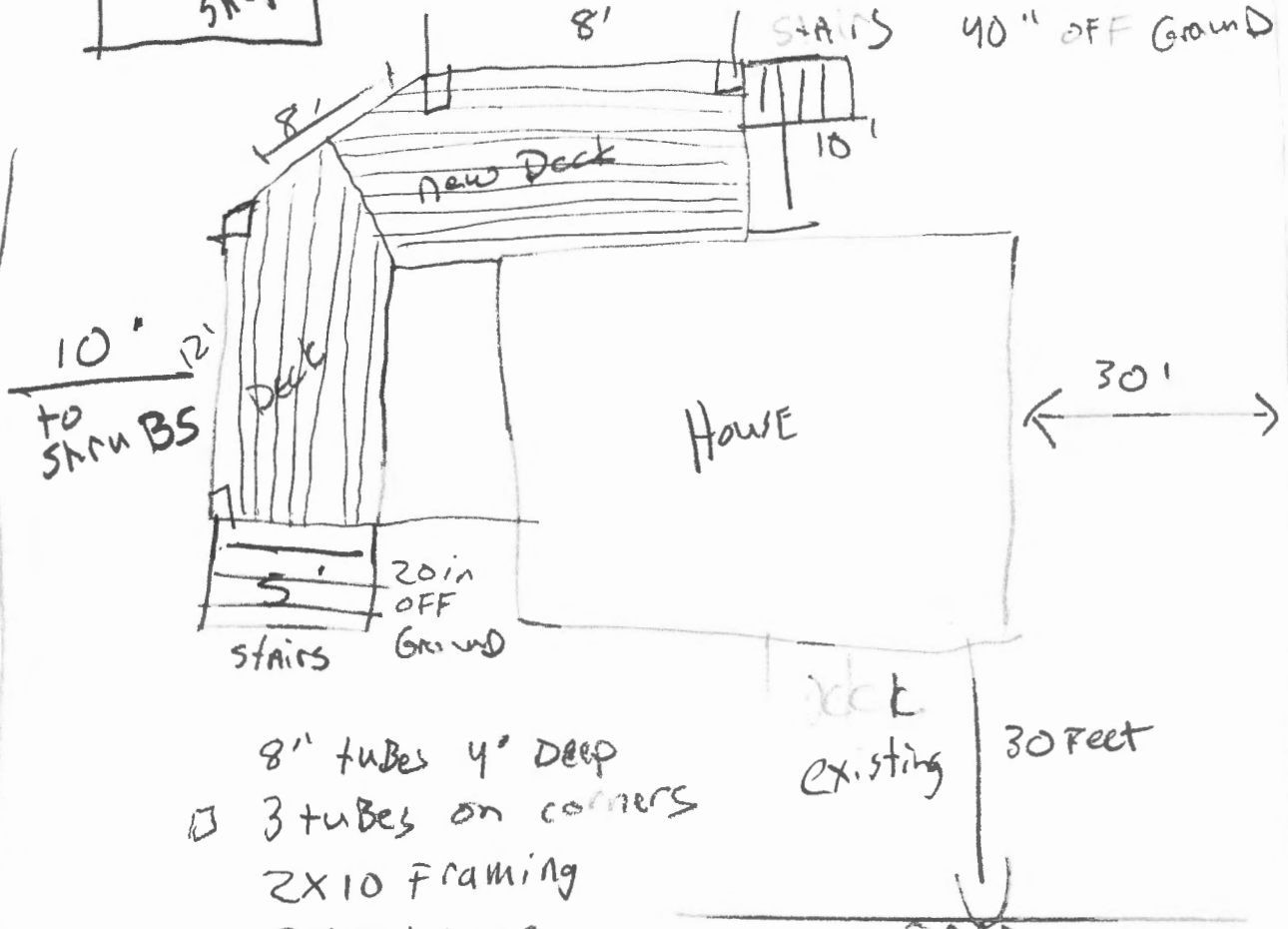

- 8" tubes 4" deep
 - 3 tubes on corners
 - 2x10 Framing
 - 2x10 ledger
 - 6" Grk lag Bolts 16" on center
 - Joists are being hung with 10d nails
 - rails at 39 inches
 - 3, 75" spacing on Balusters
 - 10' treads
 - 7.5 riser
 - Stairs at 40 inches
 - 4x4 columns to support Deck with anchors
- PT Decking