

S1 – Stairs, existing

56 St. Jude street, plot plan with existing stoop (driveway access exterior stairs) highlighted in orange 

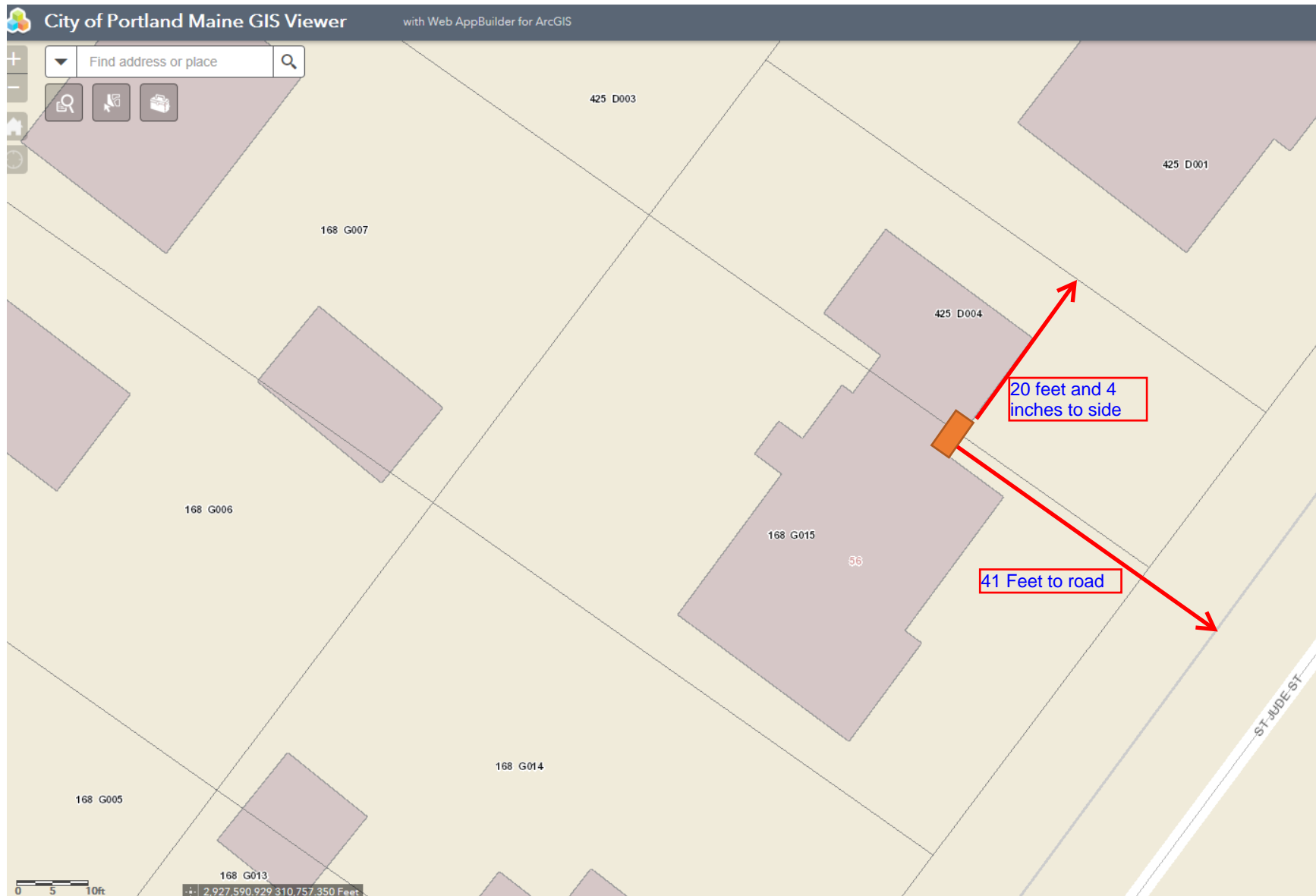

Existing stoop is 67 inches wide, 36 inches deep and 23 inches high, 3 steps at 12 inches deep by 67 inches wide
Bottom step of stated stoop is exactly 33 feet from the town sidewalk