

**City of Portland, Maine - Building or Use Permit Application**

389 Congress Street, 04101 Tel: (207) 874-8703, Fax: (207) 874-8716

Permit No: 01-057	Issue Date: <b>MAY 29 2001</b>	CBL: 168 F017001
----------------------	-----------------------------------	---------------------

Location of Construction: 667 Washington Ave	Owner Name: St Peters Episcopal Church	Owner Address: 10 Alder St Portland, Me 04101	Phone: 207-775-1179
Business Name: St. Peters Church	Contractor Name: Whedon, Ralph	Contractor Address: 82 Curtis Rd Portland	Phone: 2075757067
Lessee/Buyer's Name St. Peters Church	Phone: n/a	Permit Type: Signs- Temporary	Zone: <b>R-5</b>

Past Use: Commercial / Church	Proposed Use: Same: Erect 24 SqFt Signage. Call Ralph at 575-7067 when ready.	Permit Fee:	Cost of Work: \$0.00	CEO District: 2
FIRE DEPT: <input type="checkbox"/> Approved <input type="checkbox"/> Denied INSPECTION: <input checked="" type="checkbox"/> Approved <input type="checkbox"/> Denied Use Group: <b>Signage</b> Type:		Signature: _____ Signature: _____		

Proposed Project Description:  
Erect 24 SqFt Signage.  
*- Temporary only*  
*see time conditions*  
*1 yr or less when fund raiser is complete*

PEDESTRIAN ACTIVITIES DISTRICT (P.A.D.)		
Action: <input type="checkbox"/> Approved	<input type="checkbox"/> Approved w/Conditions	<input type="checkbox"/> Denied
Signature: _____	Date: _____	

Permit Taken By: cih	Date Applied For: 05/18/2001	<b>Zoning Approval</b>		
-------------------------	---------------------------------	------------------------	--	--

1. This permit application does not preclude the Applicant(s) from meeting applicable State and Federal Rules.  2. Building permits do not include plumbing, septic or electrical work.  3. Building permits are void if work is not started within six (6) months of the date of issuance. False information may invalidate a building permit and stop all work..	Special Zone or Reviews <input type="checkbox"/> Shoreland <input type="checkbox"/> Wetland <input type="checkbox"/> Flood Zone <input type="checkbox"/> Subdivision <input type="checkbox"/> Site Plan Maj <input type="checkbox"/> Minor <input type="checkbox"/> MM <input type="checkbox"/> Date: <i>ok with conditions</i> <i>5/25/01</i>	Zoning Appeal <input type="checkbox"/> Variance <input type="checkbox"/> Miscellaneous <input type="checkbox"/> Conditional Use <input type="checkbox"/> Interpretation <input type="checkbox"/> Approved <input type="checkbox"/> Denied Date: _____	Historic Preservation <input checked="" type="checkbox"/> Not in District or Landmark <input type="checkbox"/> Does Not Require Review <input type="checkbox"/> Requires Review <input type="checkbox"/> Approved <input type="checkbox"/> Approved w/Conditions <input type="checkbox"/> Denied Date: _____
--	--	--	---

**PERMIT ISSUED WITH REQUIREMENTS**

**CERTIFICATION**

I hereby certify that I am the owner of record of the named property, or that the proposed work is authorized by the owner of record and that I have been authorized by the owner to make this application as his authorized agent and I agree to conform to all applicable laws of this jurisdiction. In addition, if a permit for work described in the application is issued, I certify that the code official's authorized representative shall have the authority to enter all areas covered by such permit at any reasonable hour to enforce the provision of the code(s) applicable to such permit.

\_\_\_\_\_  
SIGNATURE OF APPLICANT ADDRESS DATE PHONE

\_\_\_\_\_  
RESPONSIBLE PERSON IN CHARGE OF WORK, TITLE DATE PHONE

THIS IS NOT A PERMIT/CONSTRUCTION MAY NOT COMMENCE UNTIL THE PERMIT IS ISSUED

19 MAY 01

# SIGNAGE APPLICATION

THIS IS NOT A PERMIT  
CONSTRUCTION CANNOT NOT COMMENCE UNTIL THE PERMIT IS ISSUED

In the interest of processing your application in the quickest possible manner, please complete the Information below for a Building or Use Permit.

If you or the property owner owes real estate or personal property taxes or user charges on any property within the City, payment arrangements must be made before permits of any kind are accepted.

Location/Address of Construction: 667 WASHINGTON AVENUE

Total Square Footage of Proposed Structure 12' Square Footage of Lot 28,105

Tax Assessor's Chart, Block & Lot Number  
Chart# 168 Block# F Lot# 17  
Owner: ST PETERIS Church  
Telephone #: 775-1179

Lessee/Buyer's Name (If Applicable) ST Peter's Church  
Owner's/Purchaser/Lessee Address: 10 ALTON STREET  
PORTLAND MAINE  
Total s.f of signs 24 x .20 \$4.80, plus \$30.00  
TOTAL\$ 34.80

Current use: CHURCH Proposed use: CHURCH

Project description:  
TEMPORARY SIGN FOR FUNDRAISER

Applicants Name, Address & Telephone: RALPH WHEDON  
82 CURTIS ROAD PORTLAND 575-7067  
Contractor's Name, Address & Telephone: SAME + x COLO  
575-7067  
Who shall we contact when the permit is ready: Ralph Whedon  
Telephone: 575-7067  
If you would like it mailed, what mailing address should we use:  
DEPT. OF BUILDING INSPECTION  
CITY OF PORTLAND, ME  
MAY 18 2001  
3/18/01  
Gay  
Rec'd By:

**THIS IS NOT A PERMIT/CONSTRUCTION MAY NOT COMMENCE UNTIL THE PERMIT IS ISSUED**

**Please check off the following indicating that you have included the below items to expedite the process of this sign application:**

- N/A  "Certification of Liability" listing the City additionally insured if any portion of the sign abuts or encroaches on the public right of way, or can fall into the public right of way  
 Letter of permission from the owner

**A sketch plan indicating the following:**

- Drawing of the property showing all dimensions of the lot  
 Location of all buildings and property setbacks from all buildings  
 Driveways and abutting streets showing street frontage and any right of ways  
 Indicate on drawing the dimensions of all buildings on the lot  
N/A  Define in footage the frontage of your business front  
 Indicate on drawing of existing signage and dimensions of each sign  
 Indicate on drawing all proposed signage and dimension of each sign  
 Sign area height and setback of each existing and proposed freestanding sign
- N/A  Certification of flammability required for awning/canopy at time of application  
N/A  UL # required for lighted signs at the time of Final Inspection. Failure to provide this information will invalidate the Sign Permit.

The Provisions of Section 3102.0 of the City's Building Code "The BOCA National Building Code 1999 edition" shall govern the construction, alteration, repair and maintenance of outdoor signs together with the associated appurtenant and auxiliary devices in respect to structural and fire safety. In accordance to section 3102.4.4 of BOCA construction documents and owners consent is all follows; "Before any permit is issued for the erection of a sign, Construction Documents shall be filed with the code official showing the dimensions, materials and required details of construction, including loads, stresses and anchorage. The applications shall be accompanied by the written contract of the owner or lessees of the premises upon which the sign is to erected. NO PERMIT CAN OR WILL BE ISSUED UNLESS THIS INFORMATION IS SBUMITTED AND APPROVED BY THE INSPECTIONS OFFICE.

**ELECTRICAL SIGNAGE PERMITS/RESPONSIBILITIES**

All sign companies or any persons engaged in the installation, interchange or maintenance of signage in the City of Portland must have the Electrician or Electrical Contractor who provided power to the sign(s) or associated equipment apply for an electrical permit in the Inspections Office.

It is the responsibility of your company to contact your sub-contractor or he owner to inform them of this policy. Whether your company does the final connections, which requires a valid Maine Electricians License or your sub contractor provides this service; permits and inspections shall be required.

Failure to comply with this procedure may result in the denial of sign permits by this office for your company or its representation to install or interchange any future signage in the City of Portland.

**THIS IS NOT A PERMIT/CONSTRUCTION MAY NOT COMMENCE UNTIL THE PERMIT IS ISSUED**

**If the property is located in a HISTORIC DISTRICT, a separate sketch is required indicating the design, dimensions, construction materials and source of illumination if any. A photograph of the building façade should be submitted, showing where each sign is to be installed.**

**Certification**

*I hereby certify that I am the Owner of record of the named property, or that the owner of record authorizes the proposed work and that I have been authorized by the owner to make this application as his/her authorized agent. I agree to conform to all applicable laws of this jurisdiction. In addition, if a permit for work described in this application is issued, I certify that the Code Official's authorized representative shall have the authority to enter all areas covered by this permit at any reasonable hour to enforce the provisions of the codes applicable to this permit.*

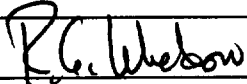
Signature of applicant: 	Date: <b>MAY 19, 2001</b>
---	---------------------------

**Sign Permit Fee: \$30.00 plus \$0.20 per square foot.**

***A building permit is also required for any awning based on cost of work-\$30.00 for the first \$1,000.00 and \$6.00 for each additional \$1,000.00***

**BY FILLING OUT THIS APPLICATION IS DOES NOT MEET THAT YOU WILL BE APPROVED FOR THE AMOUNT OF SIGNAGE YOU ARE APPLYING FOR**

**IT IS SUGGESTED THAT YOU DO NOT ORDER ANY SIGNAGE UNTIL YOU HAVE RECEIVED YOUR SIGN PERMIT THAT HAS BEEN SIGNED BY THE BUILDING, ZONING AND POSSIBLE HISTORICAL OFFICIALS OF THIS OFFICE**

**SIGNAGE PRE-APPLICATION**

PLEASE ANSWER ALL QUESTIONS

ADDRESS: 667 WASHINGTON AVE ZONE: R-5

OWNER: ST PETER'S CHURCH

APPLICANT: RALPH WEBER

ASSESSOR NO. \_\_\_\_\_

PLEASE CIRCLE APPROPRIATE ANSWER

SINGLE TENANT LOT?  YES NO      MULTI-TENANT LOT? YES  NO

FREESTANDING SIGN? (ex. Pole Sign)  YES NO --- DIMENSIONS 3' x 4' HEIGHT 5'

MORE THAN ONE SIGN? YES  NO      DIMENSIONS N/A HEIGHT N/A

SIGN ATTACHED TO BLDG.? YES  NO      DIMENSIONS N/A

MORE THAN ONE SIGN? YES  NO      DIMENSIONS N/A

AWNING: YES  NO IS AWNING BACKLIT? YES  NO HEIGHT OFF SIDEWALK N/A

IS THERE ANY MESSAGE, TRADEMARK OR SYMBOL ON IT?  
N/A

LIST ALL EXISTING SIGNAGE AND THEIR DIMENSIONS:

Distance sign 6.5 x 6'

N/A

\*\*\* TENANT BLDG. FRONTAGE (IN FEET): \_\_\_\_\_  
\*\*\* REQUIRED INFORMATION

24  
9  
48    255  
30    2111  
111    28,105

AREA FOR COMPUTATION

over 100' St. Frontage } not use in a Res. Zone

max sq. footage = 25 ft  
max height = 8'  
setback 5'

12' show  
5' show } ok on  
9' show } Temp. basis

**YOU SHALL PROVIDE:**

**A SITE SKETCH AND BUILDING SKETCH SHOWING EXACTLY WHERE EXISTING AND NEW SIGNAGE IS LOCATED MUST BE PROVIDED. SKETCHES AND/OR PICTURES OF PROPOSED ARE ALSO REQUIRED.**

SIGNATURE OF APPLICANT: R.G. Weber DATE: \_\_\_\_\_

Ralph Wheeler

575-7867

Sally Harris

- 874-8128

51

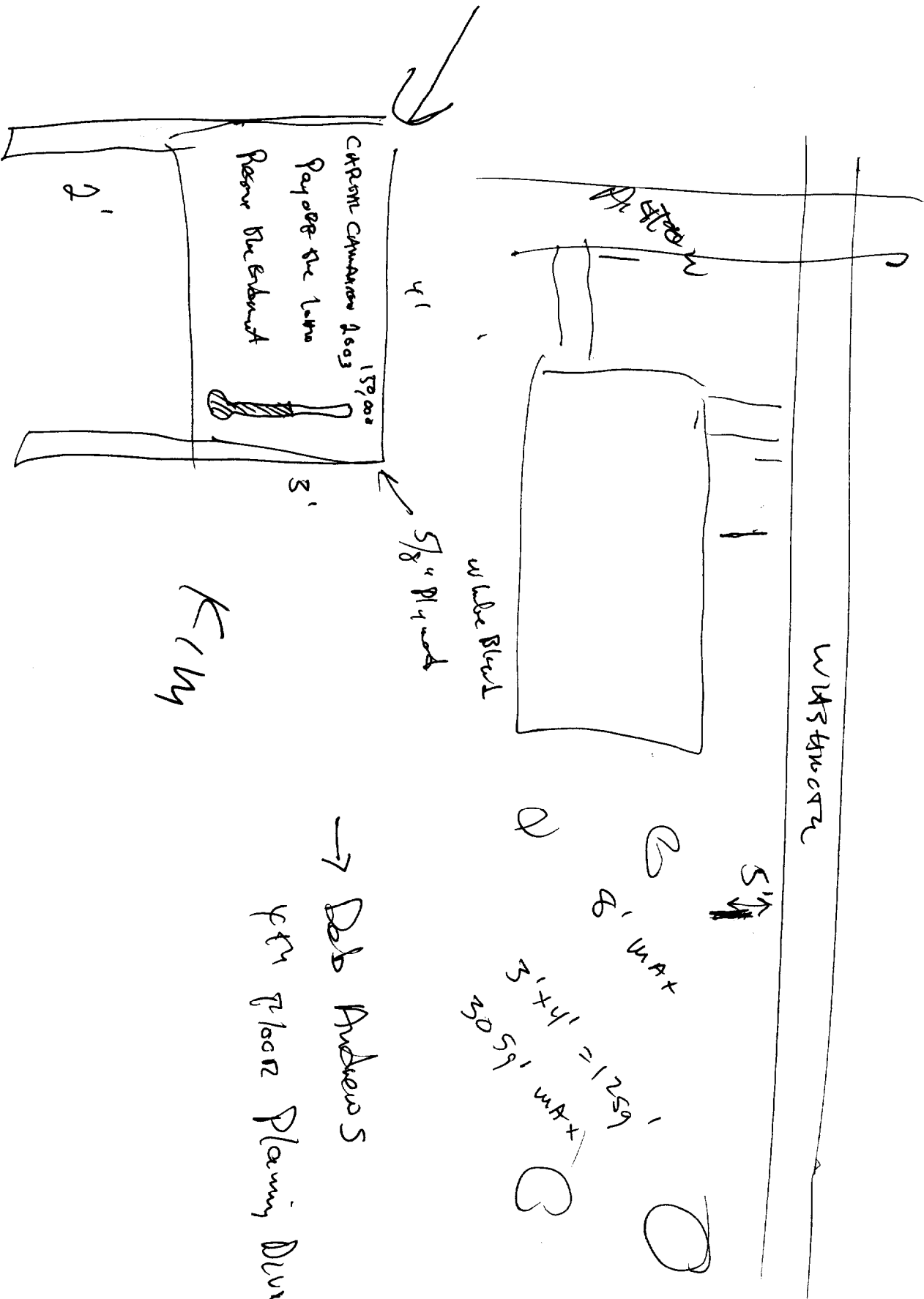

→ Bob Andrews  
 4th Floor Planning Division

KIM

ST.  PETER'S  
EPISCOPAL CHURCH

10 Alton Street  
Portland, Maine 04103  
Rev. Harold G. Birkenhead  
Rector  
(207) 775-1179

May 17, 2001

City of Portland

Dear Sir;

This letter confirms that we are granting permission to have a sign for the Capital Campaign place upon our lot.

Very truly,

  
Rev. Harold G. Birkenhead

WASHINGTON AVENUE  
725'

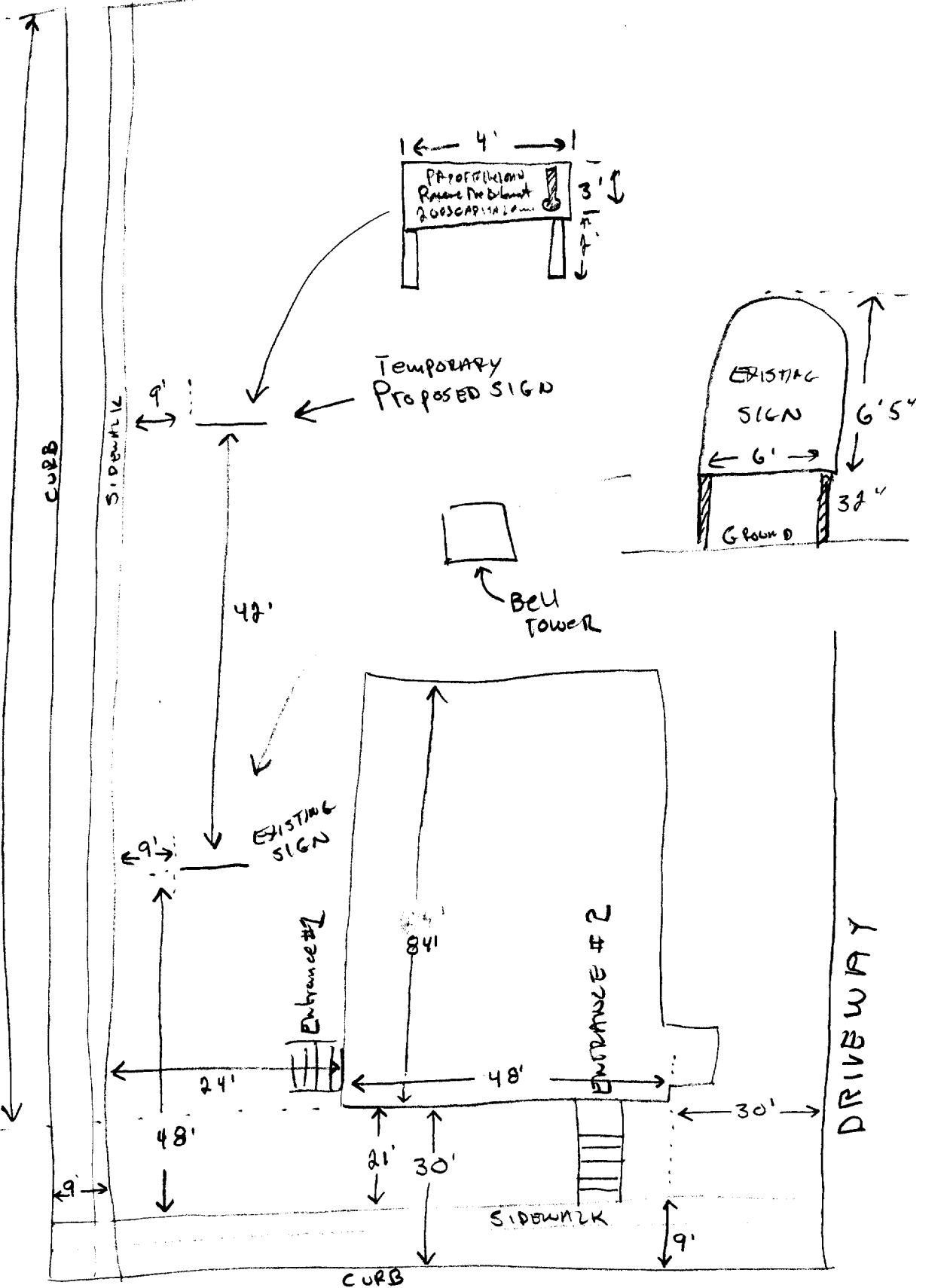

ALTON STREET

NOT TO SCALE



**ACORD**

**CERTIFICATE OF LIABILITY INSURANCE**

DATE (MM/DD/YY)  
05/18/01

PRODUCER CT

THIS CERTIFICATE IS ISSUED AS A MATTER OF INFORMATION ONLY AND CONFERS NO RIGHTS UPON THE CERTIFICATE HOLDER. THIS CERTIFICATE DOES NOT AMEND, EXTEND OR ALTER THE COVERAGE AFFORDED BY THE POLICIES BELOW.

Church Insurance Agency Corp  
10 Tower Lane - 2nd Floor  
Avon, CT 06001-  
800-293-3525

COMPANIES AFFORDING COVERAGE

COMPANY A Church Insurance

INSURED 002311

St Peters Church  
Attn: Ralph Whedon  
678 Washington St  
Portland, ME 04103-

COMPANY B

COMPANY C

COMPANY D

Fax # 2075751113

THIS IS TO CERTIFY THAT THE POLICIES OF INSURANCE LISTED BELOW HAVE BEEN ISSUED TO THE INSURED NAMED ABOVE FOR THE POLICY PERIOD INDICATED. NOTWITHSTANDING ANY REQUIREMENT, TERM OR CONDITION OF ANY CONTRACT OR OTHER DOCUMENT WITH RESPECT TO WHICH THIS CERTIFICATE MAY BE ISSUED OR MAY PERTAIN, THE INSURANCE AFFORDED BY THE POLICIES DESCRIBED HEREIN IS SUBJECT TO ALL THE TERMS, EXCLUSIONS AND CONDITIONS OF SUCH POLICIES. LIMITS SHOWN MAY HAVE BEEN REDUCED BY PAID CLAIMS.

CO LTR	TYPE OF INSURANCE	POLICY NUMBER	POLICY EFFECTIVE DATE (MM/DD/YY)	POLICY EXPIRATION DATE (MM/DD/YY)	LIMITS
A	GENERAL LIABILITY <input checked="" type="checkbox"/> COMMERCIAL GENERAL LIABILITY <input type="checkbox"/> CLAIMS MADE <input checked="" type="checkbox"/> OCCUR <input type="checkbox"/> OWNER'S & CONTRACTOR'S PROT	PIN0240003169	04/01/01	04/01/02	GENERAL AGGREGATE \$
					PRODUCTS - COMPI/OP AGG \$ 1,000,000
					PERSONAL & ADV INJURY \$ 1,000,000
					EACH OCCURRENCE \$ 1,000,000
					FIRE DAMAGE (Any one fire) \$ 200,000
					MED EXP (Any one person) \$ 15,000
	AUTOMOBILE LIABILITY <input type="checkbox"/> ANY AUTO <input type="checkbox"/> ALL OWNED AUTOS <input type="checkbox"/> SCHEDULED AUTOS <input type="checkbox"/> HIRED AUTOS <input type="checkbox"/> NON-OWNED AUTOS				COMBINED SINGLE LIMIT \$
					BODILY INJURY (Per person) \$
					BODILY INJURY (Per accident) \$
					PROPERTY DAMAGE \$
	GARAGE LIABILITY <input type="checkbox"/> ANY AUTO				AUTO ONLY - EA ACCIDENT \$
					OTHER THAN AUTO ONLY:
					EACH ACCIDENT \$
					AGGREGATE \$
	EXCESS LIABILITY <input type="checkbox"/> UMBRELLA FORM <input type="checkbox"/> OTHER THAN UMBRELLA FORM				EACH OCCURRENCE \$
					AGGREGATE \$
					\$
	WORKERS COMPENSATION AND EMPLOYERS' LIABILITY THE PROPRIETOR/PARTNERS/EXECUTIVE OFFICERS ARE: <input type="checkbox"/> INCL <input type="checkbox"/> EXCL				<input type="checkbox"/> WC STATUTORY LIMITS <input type="checkbox"/> OTHER
					EL EACH ACCIDENT \$
					EL DISEASE - POLICY LIMIT \$
					EL DISEASE - EA EMPLOYEE \$
	OTHER				

DESCRIPTION OF OPERATIONS/LOCATIONS/VEHICLES/SPECIAL ITEMS  
RE: Sign on insureds property

CERTIFICATE HOLDER

City of Portland

SHOULD ANY OF THE ABOVE DESCRIBED POLICIES BE CANCELLED BEFORE THE EXPIRATION DATE THEREOF, THE ISSUING COMPANY WILL ENDEAVOR TO MAIL 30 DAYS WRITTEN NOTICE TO THE CERTIFICATE HOLDER NAMED TO THE LEFT, BUT FAILURE TO MAIL SUCH NOTICE SHALL IMPOSE NO OBLIGATION OR LIABILITY OF ANY KIND UPON THE COMPANY, ITS AGENTS OR REPRESENTATIVES.

AUTHORIZED REPRESENTATIVE

*Ralph Whedon*

**BUILDING PERMIT REPORT**

DATE: 19 MAY 2001 ADDRESS: 667 Washington Ave. CBL: 168-F-017

REASON FOR PERMIT: Temp. Sign.

BUILDING OWNER: St. Peter's Church

PERMIT APPLICANT: \_\_\_\_\_ CONTRACTOR Ralph Whedon

USE GROUP: \_\_\_\_\_ CONSTRUCTION TYPE: \_\_\_\_\_ CONSTRUCTION COST: \_\_\_\_\_ PERMIT FEES: \_\_\_\_\_

The City's Adopted Building Code (The BOCA National Building Code/1999 with City Amendments)  
The City's Adopted Mechanical Code (The BOCA National Mechanical Code/1993)

**CONDITION(S) OF APPROVAL**

This permit is being issued with the understanding that the following conditions shall be met: #1, #37, #38

- 1. This permit does not excuse the applicant from meeting applicable State and Federal rules and laws.
- 2. Before concrete for foundation is placed, approvals from the Development Review Coordinator and Inspection Services must be obtained. (A 24 hour notice is required prior to inspection) **"ALL LOT LINES SHALL BE CLEARLY MARKED BEFORE CALLING."**
- 3. Foundation drain shall be placed around the perimeter of a foundation that consists of gravel or crushed stone containing not more than 10 percent material that passes through a No. 4 sieve. The drain shall extend a minimum of 12 inches beyond the outside edge of the footing. The thickness shall be such that the bottom of the drain is not higher than the bottom of the base under the floor, and that the top of the drain is not less than 6 inches above the top of the footing. The top of the drain shall be covered with an approved filter membrane material. Where a drain tile or perforated pipe is used, the invert of the pipe or tile shall not be higher than the floor elevation. The top of joints or top of perforations shall be protected with an approved filter membrane material. The pipe or tile shall be placed on not less than 2" of gravel or crushed stone, and shall be covered with not less than 6" of the same material. Section 1813.5.2
- 4. Foundations anchors shall be a minimum of 1/2" in diameter, 7" into the foundation wall, minimum of 12" from corners of foundation and a maximum 6' O.C. between bolts. Section 2305.17
- 5. Waterproofing and dampproofing shall be done in accordance with Section 1813.0 of the building code.
- 6. Precaution must be taken to protect concrete and masonry. Concrete Sections 1908.9-19.8.10/ Masonry Sections 2111.3-2111.4.
- 7. It is strongly recommended that a registered land surveyor check all foundation forms before concrete is placed. This is done to verify that the proper setbacks are maintained.
- 8. Private garages located beneath habitable rooms in occupancies in Use Group R-1, R-2, R-3 or I-1 shall be separated from adjacent interior spaces by fire partitions and floor/ceiling assembly which are constructed with not less than 1-hour fire resisting rating. Private garages attached side-by-side to rooms in the above occupancies shall be completely separated from the interior spaces and the attic area by means of 1/2 inch gypsum board or the equivalent applied to the garage side. (Chapter 4, Section 407.0 of the BOCA/1999)
- 9. All chimneys and vents shall be installed and maintained as per Chapter 12 of the City's Mechanical Code. (The BOCA National Mechanical Code/1993). Chapter 12 & NFPA 211
- 10. Sound transmission control in residential building shall be done in accordance with Chapter 12, Section 1214.0 of the City's Building Code.
- 11. Guardrails & Handrails: A guardrail system is a system of building components located near the open sides of elevated walking surfaces for the purpose of minimizing the possibility of an accidental fall from the walking surface to the lower level. Minimum height all Use Groups 42". In occupancies in Use Group A, B.H-4, I-1, I-2, M, R, public garages and open parking structures, open guards shall have balusters or be of solid material such that a sphere with a diameter of 4" cannot pass through any opening. Guards shall not have an ornamental pattern that would provide a ladder effect. Handrails shall be a minimum of 34" but not more than 38". Exception: Handrails that form part of a guard shall have a height not less than 36 inches (914 mm) and not more than 42 inches (1067 mm). Handrail grip size shall have a circular cross section with an outside diameter of at least 1 1/4" and not greater than 2". (Sections 1021 & 1022.0). Handrails shall be on both sides of stairway. (Section 1014.7)
- 12. Headroom in habitable space is a minimum of 7'6". (Section 1204.0)
- 13. Stair construction in **Use Group R-3 & R-4 is a minimum of 10" tread and 7 3/4" maximum rise.** All other Use Group minimum 11" tread, 7" maximum rise. (Section 1014.0)
- 14. The minimum headroom in all parts of a stairway shall not be less than 80 inches. (6'8") 1014.4
- 15. The Minimum required width of a corridor shall be determined by the most restrictive of the criteria under section 1011.3 but not less than 36".
- 16. Every sleeping room below the fourth story in buildings of Use Groups R and I-1 shall have at least one operable window or exterior door approved for emergency egress or rescue. The units must be operable from the inside without the use of special knowledge or separate tools. Where windows are provided as means of egress or rescue they shall have a sill height not more than 44 inches (1118mm) above the floor. All egress or rescue windows from sleeping rooms shall have a minimum net clear opening height dimension of 24 inches (610mm). The minimum net clear opening width dimension shall be 20 inches (508mm), and a minimum net clear opening of 5.7 sq. ft. (Section 1010.4)
- 17. Each apartment shall have access to two (2) separate, remote and approved means of egress. A single exit is acceptable when it exits directly from the apartment to the building exterior with no communications to other apartment units. (Section 1010.1)
- 18. All vertical openings shall be enclosed with construction having a fire rating of at least one (1) hour, including fire doors with self closure's. (Over 3 stories in height requirements for fire rating is two (2) hours. (Section 710.0)
- 19. The boiler shall be protected by enclosing with (1) hour fire rated construction including fire doors and ceiling, or by providing automatic extinguishment. (Table 302.1.1)

5/18

20. All single and multiple station smoke detectors shall be of an approved type and shall be installed in accordance with the provisions of the City's Building Code Chapter 9, Section 920.3.2 (BOCA National Building Code/1999), and NFPA 101 Chapter 18 & 19. (Smoke detectors shall be installed and maintained at the following locations):
  - In the immediate vicinity of bedrooms
  - In all bedrooms
  - In each story within a dwelling unit, including basements
21. A portable fire extinguisher shall be located as per NFPA #10. They shall bear the label of an approved agency and be of an approved type. (Section 921.0)
22. The Fire Alarm System shall be installed and maintained to NFPA #72 Standard.
23. The Sprinkler System shall be installed and maintained to NFPA #13 Standard.
24. All exit signs, lights and means of egress lighting shall be done in accordance with Chapter 10 Section & Subsections 1023.0 & 1024.0 of the City's Building Code. (The BOCA National Building Code/1999)
25. Section 25 - 135 of the Municipal Code for the City of Portland states, "No person or utility shall be granted a permit to excavate or open any street or sidewalk from the time of November 15 of each year to April 15 of the following year".
26. The builder of a facility to which Section 4594-C of the Maine State Human Rights Act Title 5 MRSA refers, shall obtain a certification from a design professional that the plans commencing construction of the facility, the builder shall submit the certification the Division of Inspection Services.
27. Ventilation and access shall meet the requirements of Chapter 12 Sections 1210.0 and 1211.0 of the City's Building Code. (Crawl spaces & attics).
28. All electrical, plumbing and HVAC permits must be obtained by Master Licensed holders of their trade. **No closing in of walls until all electrical (min. 72 hours notice) and plumbing inspections have been done.**
29. All requirements must be met before a final Certificate of Occupancy is issued.
30. All building elements shall meet the fastening schedule as per Table 2305.2 of the City's Building Code (The BOCA National Building Code/1996).
31. Ventilation of spaces within a building shall be done in accordance with the City's Mechanical code (The BOCA National Mechanical Code/1993). (Chapter M-16)
32. Please read and implement the attached Land Use Zoning report requirements.
33. Boring, cutting and notching shall be done in accordance with Sections 2305.3, 2305.3.1, 2305.4.4 and 2305.5.1 of the City's Building Code.
34. Bridging shall comply with Section 2305.16.
35. Glass and glazing shall meet the requirements of Chapter 24 of the building code. (Safety Glazing Section 2406.0)
36. All flashing shall comply with Section 1406.3.10.
- X37. All signage shall be done in accordance with Section 3102.0 signs of the City's Building Code, (The BOCA National Building Code/1999).

*38. Sign shall be removed within 1 year or less when the fund raising is completed. To extend time limit, this office shall first be notified.*

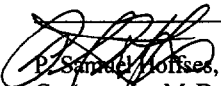
  
 P. Samuel, Building Inspector  
 Cc: Lt. McDougall, PFD  
 Marge Schmuckal, Zoning Administrator  
 Michael Nugent, Inspection Service Manager

PSH 10/1/00

**\*\*This permit is herewith issued, on the basis of plans submitted and conditions placed on these plans, any deviations shall require a separate approval.**

**\*\*\*THIS PERMIT HAS BEEN ISSUED WITH THE UNDERSTANDING THAT ALL THE CONDITIONS OF THE APPROVAL SHALL BE COMPLETED. THEREFORE, BEFORE THE WORK IS COMPLETED A REVISED PLAN OR STATEMENT FROM THE PERMIT HOLDER SHALL BE SUBMITTED TO THIS OFFICE SHOWING OR EXPLAINING THAT THE CONDITIONS HAVE BEEN MET. IF THIS REQUIREMENT IS NOT RECEIVED YOUR CERTIFICATE OF OCCUPANCY SHALL BE WITHHELD. ( You Shall Call for Inspections )**

**\*\*\*\*ALL PLANS THAT REQUIRE A PROFESSIONAL DESIGNER'S SEAL, (AS PER SECTION 114.0 OF THE BUILDING CODE) SHALL ALSO BE PRESENTED TO THIS DIVISION ON AUTO CAD LT. 2000, DXF FORMAT OR EQUIVALENT.**

**\*\*\*\*\*CERTIFICATE OF OCCUPANCY FEE \$50.00**