

DISPLAY THIS CARD ON PRINCIPAL FRONTAGE OF WORK CITY OF PORTLAND

BUILDING DEPARTMENT

PERMIT

Permit Number: 040389

Please Read Application And Notes, If Any, Attached

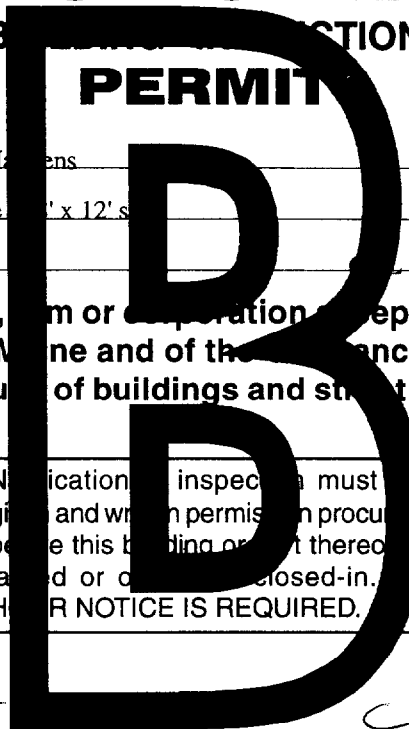

This is to certify that Haskell Daniel K & /Shed H ens
has permission to remove old shed and replace ' x 12' s
AT 18 Inverness St 168 D015001

provided that the person or persons, firm or corporation accepting this permit shall comply with all of the provisions of the Statutes of Maine and of the Ordinances of the City of Portland regulating the construction, maintenance and use of buildings and structures, and of the application on file in this department.

Apply to Public Works for street line and grade if nature of work requires such information.

Notification of inspection must be given and written permission procured before this building or part thereof is altered or closed-in. HEAVY NOTICE IS REQUIRED.

A certificate of occupancy must be procured by owner before this building or part thereof is occupied.

OTHER REQUIRED APPROVALS

Fire Dept. _____
Health Dept. _____
Appeal Board _____
Other _____

PERMIT ISSUED
APR 09 2004
CITY OF PORTLAND

[Signature]
Director - Building & Inspection Services

PENALTY FOR REMOVING THIS CARD

City of Portland, Maine - Building or Use Permit Application

389 Congress Street, 04101 Tel: (207) 874-8703, Fax: (207) 874-8716

PERMIT ISSUED

Permit No: 04-0389	Issue Date: APR 09 2004	CBL: 168 D015001
-----------------------	----------------------------	---------------------

Location of Construction: 18 Inverness St	Owner Name: Haskell Daniel K &	Owner Address: 18 Inverness St	Phone: 207-7724514
Business Name:	Contractor Name: Shed Happens	Contractor Address: 1042 Chadborne Rd. Standish	Phone: 2078923636
Lessee/Buyer's Name	Phone:	Permit Type: Sheds	Zone: R-5

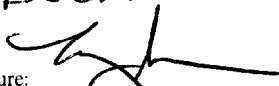
Past Use: single family	Proposed Use: single family - remove old shed and replace w/8' x 12' shed	Permit Fee: \$48.00	Cost of Work: \$2,473.00	CEO District: 4
Proposed Project Description: remove old shed and replace w/8' x 12' shed		FIRE DEPT: <input type="checkbox"/> Approved <input type="checkbox"/> Denied N/A	INSPECTION: Use Group: R-3/U Type: SB BOCA 1999 Signature: 	
		PEDESTRIAN ACTIVITIES DISTRICT (P.A.D.) Action: <input type="checkbox"/> Approved <input type="checkbox"/> Approved w/Conditions <input type="checkbox"/> Denied Signature: _____ Date: _____		

Permit Taken By: tmm	Date Applied For: 04/09/2004	Zoning Approval
-------------------------	---------------------------------	------------------------

- This permit application does not preclude the Applicant(s) from meeting applicable State and Federal Rules.
- Building permits do not include plumbing, septic or electrical work.
- Building permits are void if work is not started within six (6) months of the date of issuance. False information may invalidate a building permit and stop all work..

Special Zone or Reviews <input type="checkbox"/> Shoreland <input type="checkbox"/> Wetland <input type="checkbox"/> Flood Zone <input type="checkbox"/> Subdivision <input type="checkbox"/> Site Plan Maj <input type="checkbox"/> Minor <input type="checkbox"/> MM <input type="checkbox"/> Date: 4/9/04	Zoning Appeal <input type="checkbox"/> Variance <input type="checkbox"/> Miscellaneous <input type="checkbox"/> Conditional Use <input type="checkbox"/> Interpretation <input type="checkbox"/> Approved <input type="checkbox"/> Denied Date:	Historic Preservation <input checked="" type="checkbox"/> Not in District or Landmark <input type="checkbox"/> Does Not Require Review <input type="checkbox"/> Requires Review <input type="checkbox"/> Approved <input type="checkbox"/> Approved w/Conditions <input type="checkbox"/> Denied Date: 4/9/04
--	---	---

PERMIT ISSUED
APR 09 2004
CITY OF PORTLAND

CERTIFICATION

I hereby certify that I am the owner of record of the named property, or that the proposed work is authorized by the owner of record and that I have been authorized by the owner to make this application as his authorized agent and I agree to conform to all applicable laws of this jurisdiction. In addition, if a permit for work described in the application is issued, I certify that the code official's authorized representative shall have the authority to enter all areas covered by such permit at any reasonable hour to enforce the provision of the code(s) applicable to such permit.

SIGNATURE OF APPLICANT	ADDRESS	DATE	PHONE
RESPONSIBLE PERSON IN CHARGE OF WORK, TITLE		DATE	PHONE

BUILDING PERMIT INSPECTION PROCEDURES

Please call 874-8703 or 874-8693 to schedule your inspections as agreed upon

Permits expire in 6 months, if the project is not started or ceases for 6 months.

The Owner or their designee is required to notify the inspections office for the following inspections and provide adequate notice. Notice must be called in 48-72 hours in advance in order to schedule an inspection:

By initializing at each inspection time, you are agreeing that you understand the inspection procedure and additional fees from a "Stop Work Order" and "Stop Work Order Release" will be incurred if the procedure is not followed as stated below.

_____ **Pre-construction Meeting:** Must be scheduled with your inspection team upon receipt of this permit. Jay Reynolds, Development Review Coordinator at 874-8632 must also be contacted at this time, before **any** site work begins on any project other than single family additions or alterations.

_____ **Footing/Building Location Inspection:** Prior to pouring concrete

_____ **Re-Bar Schedule Inspection:** Prior to pouring concrete

_____ **Foundation Inspection:** Prior to placing ANY backfill

_____ **Framing/Rough Plumbing/Electrical:** Prior to any insulating or drywalling

Final/Certificate of Occupancy: Prior to any occupancy of the structure or use. NOTE: There is a \$75.00 fee per inspection at this point.

Certificate of Occupancy is not required for certain projects. Your inspector can advise you if your project requires a Certificate of Occupancy. All projects DO require a final inspection

_____ **If any of the inspections do not occur, the project cannot go on to the next phase, REGARDLESS OF THE NOTICE OR CIRCUMSTANCES.**

_____ **CERIFICATE OF OCCUPANICES MUST BE ISSUED AND PAID FOR, BEFORE THE SPACE MAY BE OCCUPIED**

Signature of Applicant/Designee

4/9/04

Date

Signature of Inspections Official

4/9/04

Date

CBL: 168-D-15

Building Permit #: 04-389

* receipt please *



Residential Building Permit Application

If you or the property owner owes real estate or personal property taxes or user charges on any property within the City, payment arrangements must be made before permits of any kind are accepted.

Location/Address of Construction: <u>18 Inverness Street</u>		
Total Square Footage of Proposed Structure <u>96 sq ft</u>	Square Footage of Lot <u>5150 sq ft</u>	
Tax Assessor's Chart, Block & Lot Chart# <u>168</u> Block# <u>D</u> Lot# <u>15</u>	Owner: <u>Daniel + Natalie Haskell</u>	Telephone: <u>772-4514</u>
Lessee/Buyer's Name (If Applicable) <u>n/a</u>	Applicant name, address & telephone: <u>Daniel + Natalie Haskell</u> <u>15 Inverness St</u> <u>Portland ME</u> <u>772-4514</u>	Cost Of Work: \$ <u>2073-shed</u> Fee: \$ <u>450-dismantle + remove old shed</u>
Current Specific use: <u>shed</u>		
Proposed Specific use: <u>shed</u>		
Project description: <u>we are looking to remove an older metal shed + replace it with a new wooden (smaller) one, 8x12 ft, Gambrel style.</u>		
Contractor's name, address & telephone: <u>purchased from Shed Happens, 892-3636</u> <u>1700 W. Harman 642-2013</u> <u>Natalie Haskell Chadbourne Rd, Standish</u>		
Mailing address: <u>18 Inverness St</u> <u>Portland ME 04103</u> Phone: <u>772-4514</u>		

shed removal - CW Harmon 642-2013
Standish

Please submit all of the information outlined in the Residential Application Checklist. Failure to do so will result in the automatic denial of your permit.

At the discretion of the Planning and Development Department, additional information may be required prior to permit approval. For further information stop by the Building Inspections office, room 315 City Hall or call 874-8703.

I hereby certify that I am the Owner of record of the named property, or that the owner of record authorizes the proposed work and that I have been authorized by the owner to make this application as his/her authorized agent. I agree to conform to all applicable laws of this jurisdiction. In addition, if a permit for work described in this application is issued, I certify that the Code Official's authorized representative shall have the authority to enter all areas covered by this permit at any reasonable hour to enforce the provisions of the codes applicable to this permit.

Signature of applicant: <u>Natalie Haskell</u>	Date: <u>4-9-04</u>
--	---------------------

Permit Fee: \$30.00 for the first \$1000.00 Construction Cost, \$9.00 per additional \$1000.00 cost

This is not a Permit; you may not commence any work until the Permit is issued.

\$48
#2732



Residential Building Permit Application Checklist

All of the following information is required and must be submitted in order to help insure an expeditious permitting process.

A complete set of construction drawings must include:

- Cross sections w/framing details
- Detail of any new walls or permanent partitions
- Floor Plans & Elevations
- Window and door schedules *will ~~also~~ fully assembled in one day*
- Foundation plans with required drainage and damp proofing (if applicable)
- Electrical and plumbing layout. Mechanical drawings for any specialized equipment such as furnaces, chimneys, gas equipment, HVAC equipment (air handling) or other types of work that may require special review must be included.

It is a shed - no electrical or plumbing -
Separate permits are required for internal & external plumbing, HVAC, and electrical installations.

If there are any additions to the footprint or volume of the new or existing structure(s), a plot plan is required and must include:

- The shape and dimension of the lot, footprint of the proposed structure and the distance from the actual property lines drawn to scale. Structures include decks porches; a bow windows cantilever sections and roof overhangs, sheds, pools, garages and any other accessory structures must be shown.
- Boundary survey to scale showing north arrow; zoning district and setbacks
- First floor sill elevation (based on mean sea level datum)
- Location and dimensions of parking areas and driveways
- Location and size of both existing utilities in the street and the proposed utilities serving the building
- Location of areas on the site that will be used to dispose of surface water
- Existing and proposed grade contours
- Silt fence locations

Surveyor's monuments must be in place and the lot staked for a setback inspection.

Please submit all of the information outlined in this Residential Application Checklist. Failure to do so will result in the automatic denial of your permit.

At the discretion of the Planning and Development Department, additional information may be required prior to permit approval. For further information stop by the Building Inspections office, room 315 City Hall or call 874-8703.

Permit Fee: \$30.00 for the first \$1000.00 Construction Cost, \$9.00 per additional \$1000.00 cost

This is not a Permit; you may not commence any work until the Permit is issued.

14' x 16'

\$4,482

Standard Features

- 2 Vents with Gabel & Gamgrel styles sheds
- A Set of 4' or 5' Double Doors
- Many options on Door and window location
- Drip edge on Rakes and Eaves
- Free Delivery within 30 miles
- 2 Windows w/screens on sheds larger than 8' X 12'
- 1 Window w/screen on sheds smaller than 8' X 12'
- 25 year shingles
- 3/4" CDX on floor
- 7/16" OSB sheathing on roof
- 16" OC Studs, Joist and Rafters
- Hemlock full 4"x 4" skids
- 2"x 6" floor joist and 10' and wider
- Kiln dried lumber
- 6 cement blocks
- 1"x 5" Maine milled KD Pine V matched/T&G
- Limited Warranty
- The convenience of a local business for window & door replacment

**Optional
Features**

**Specs &
Notes**

**Warranty
Information**

© Shed Happens, Inc.

SHED HAPPENS INC.

**SHED
HAPPENS
INC.**

Corner of Routes 302 and 115-Windham, ME 04062
207-892-3636 ~ Fax: 207-892-3622
Maine's Largest Shed Manufacturer

Sheds

Gazebos

**Outdoor
Furniture**

**Garden
Arbors**

**Playground
Equipment**

**Vinyl
Swing Sets**

Swing Sets

Gliders

Picnic Tables

**Walking
Bridges**

**Adirondac
Furniture**

Contact Us

Home Page

**Click here
to visit the
Maine-Iy Amish
Website**

Gabel Style Shed



Size	Price
6' x 8'	\$1,225
6' x 10'	\$1,400
6' x 12'	\$1,575
8' x 8'	\$1,475
8' x 10'	\$1,675
8' x 12'	\$1,875
8' x 14'	\$2,125
8' x 16'	\$2,325
10' x 10'	\$1,975
10' x 12'	\$2,225
10' x 14'	\$2,475
10' x 16'	\$2,675
10' x 20'	\$3,475
12' x 12'	\$2,575
12' x 14'	\$2,900
12' x 16'	\$3,100
12' x 20'	\$3,925
14' x 14'	\$3,878
14' x 16'	\$4,382

Gambrel Style Shed



Size	Price
8' x 10'	\$1,775
8' x 12'	\$1,975
8' x 14'	\$2,225
8' x 16'	\$2,425
10' x 10'	\$2,100
10' x 12'	\$2,350
10' x 14'	\$2,625
10' x 16'	\$2,825
10' x 20'	\$3,600
12' x 12'	\$2,725
12' x 14'	\$3,050
12' x 16'	\$3,250
12' x 20'	\$4,075
14' x 14'	\$3,978

SHED HAPPENS INC.

**SHED
HAPPENS
INC.**

Corner of Routes 302 and 115-Windham, ME 04062
207-892-3636 ~ Fax: 207-892-3622
Maine's Largest Shed Manufacturer

Sheds

Gazebos

**Outdoor
Furniture**

**Garden
Arbors**

**Playground
Equipment**

**Vinyl
Swing Sets**

Swing Sets

Gliders

Picnic Tables

**Walking
Bridges**

**Adirondac
Furniture**

Contact Us

Home Page

**Click here
to visit the
Maine-Iy Amish
Website**

Construction Specs and Notes:

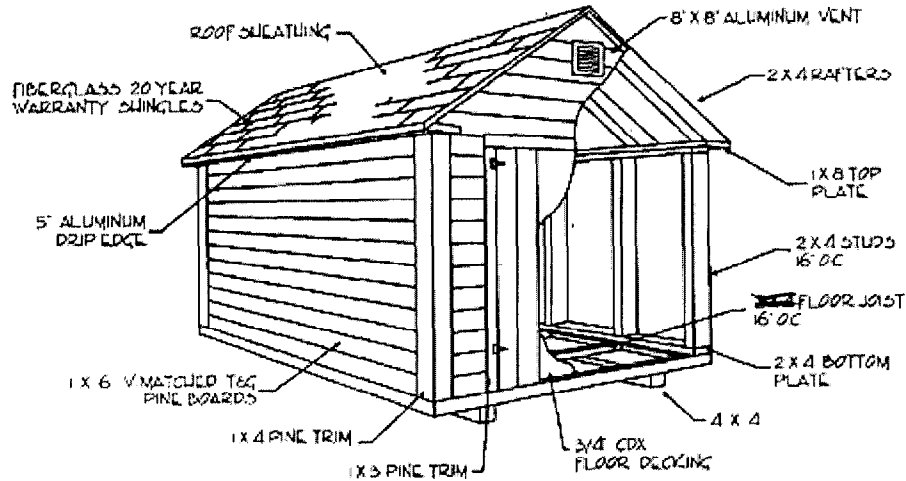

- All sheds are set 4"X 4"
- Delivery is considered to be to driveway only.
- As long as property owner assumes responsibility, we will place your shed where you want it.
- Built on sight, in some cases may be an extra charge. If we have to move rock, rubbish or any other items to have a safe work area we have to charge a minimum of \$25.00.
- Our styles or custom built to your favorite style shed or screen house design.
- Other services available: concrete slab, stone base, excavating your site, stump and rock removal.
- Property owner is fully responsible for all permits and setbacks from property lines.
- Materials are subject to change without notice at manufacturer's discretion.
- All our structures are ordered to your specifications so we shall charge a 20% restocking fee on any canceled orders after construction has begun.

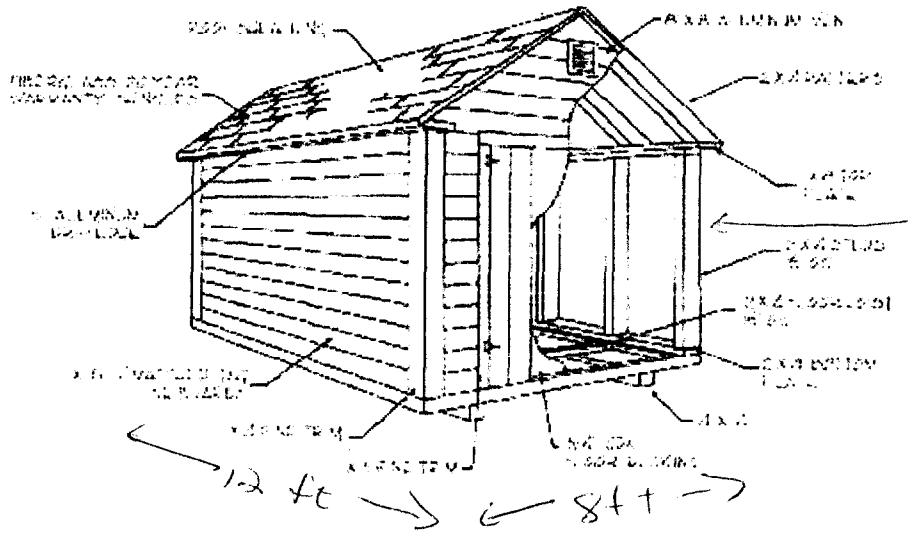

2 windows (metal)
w/ screens

Haskell
18 Inverness St
Portland 04103
772 4514

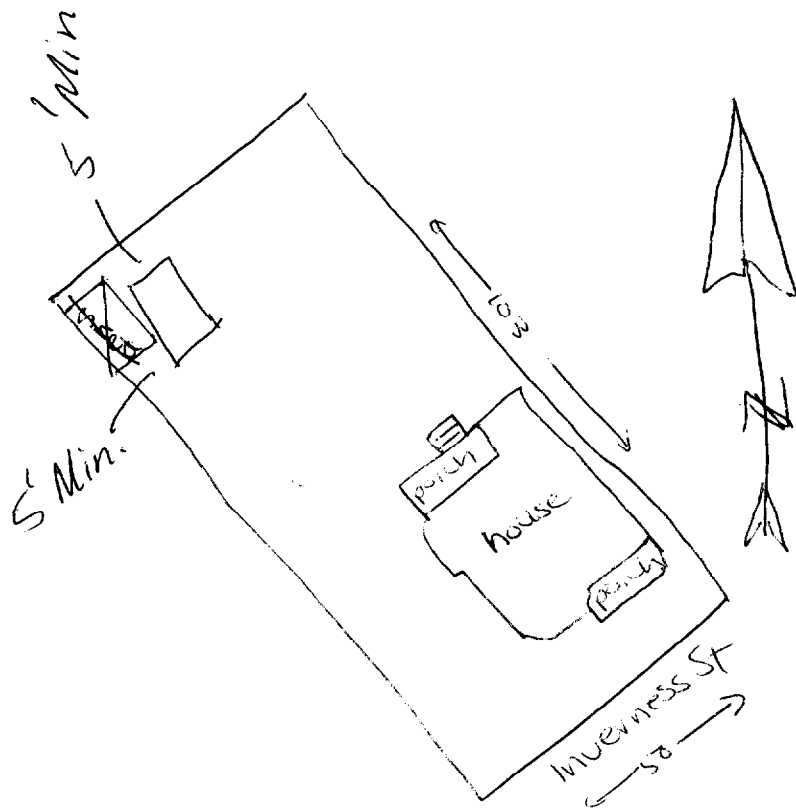

R-S
 Lot cov -
 OK
 5' setbacks

Inch = 30 ft

Haskell
 772-4814
 18 Inverness St