

**City of Portland, Maine - Building or Use Permit Application**  
 389 Congress Street, 04101 Tel: (207) 874-8703, Fax: (207) 874-8716

Permit No. 01-1412	Issue Date	CBL: to 15 167 F013001
--------------------	------------	---------------------------

Location of Construction: 618 Washington Ave	Owner Name: Rainbow United Methodist Church	Owner Address: 618 Washington Ave.	Phone: 207-774-1617
Business Name:	Contractor Name: Applicant	Contractor Address: Portland	Phone:
Lessee/Buyer's Name	Phone:	Permit Type: Signs - Permanent	Zone: R-5

Past Use: Church	Proposed Use: Church	Permit Fee:	Cost of Work: \$32.20	CEO District: 2
---------------------	-------------------------	-------------	--------------------------	--------------------

Proposed Project Description: Replace existing signage	FIRE DEPT: <input type="checkbox"/> Approved <input type="checkbox"/> Denied	INSPECTION: Use Group: N/A Type: <i>[Signature]</i> 11/29/01
	PEDESTRIAN ACTIVITIES DISTRICT (P.A.D.) Action: <input type="checkbox"/> Approved <input type="checkbox"/> Approved w/Conditions <input type="checkbox"/> Denied Signature: Date:	

Permit Taken By: gad	Date Applied For: 11/14/2001	<b>Zoning Approval</b>	
-------------------------	---------------------------------	------------------------	--

1. This permit application does not preclude the Applicant(s) from meeting applicable State and Federal Rules. 2. Building permits do not include plumbing, septic or electrical work. 3. Building permits are void if work is not started within six (6) months of the date of issuance. False information may invalidate a building permit and stop all work..	Special Zone or Reviews <input type="checkbox"/> Shoreland <input type="checkbox"/> Wetland <input type="checkbox"/> Flood Zone <input type="checkbox"/> Subdivision <input type="checkbox"/> Site Plan Maj <input type="checkbox"/> Minor <input type="checkbox"/> MM <input type="checkbox"/>	Zoning Appeal <input type="checkbox"/> Variance <input type="checkbox"/> Miscellaneous <input type="checkbox"/> Conditional Use <input type="checkbox"/> Interpretation <input type="checkbox"/> Approved <input type="checkbox"/> Denied	Historic Preservation <input checked="" type="checkbox"/> Not in District or Landmark <input type="checkbox"/> Does Not Require Review <input type="checkbox"/> Requires Review <input type="checkbox"/> Approved <input type="checkbox"/> Approved w/Conditions <input type="checkbox"/> Denied
	Date: <i>11/20/01</i>	Date: <i>11/20/01</i>	Date:

**CERTIFICATION**

I hereby certify that I am the owner of record of the named property, or that the proposed work is authorized by the owner of record and that I have been authorized by the owner to make this application as his authorized agent and I agree to conform to all applicable laws of this jurisdiction. In addition, if a permit for work described in the application is issued, I certify that the code official's authorized representative shall have the authority to enter all areas covered by such permit at any reasonable hour to enforce the provision of the code(s) applicable to such permit.

SIGNATURE OF APPLICANT	ADDRESS	DATE	PHONE
RESPONSIBLE PERSON IN CHARGE OF WORK, TITLE		DATE	PHONE

01-1412

THIS IS NOT A PERMIT/CONSTRUCTION MAY NOT COMMENCE UNTIL THE PERMIT IS ISSUED

# SIGNAGE APPLICATION

THIS IS NOT A PERMIT  
CONSTRUCTION CANNOT NOT COMMENCE UNTIL THE PERMIT IS ISSUED

In the interest of processing your application in the quickest possible manner, please complete the Information below for a Building or Use Permit.

If you or the property owner owes real estate or personal property taxes or user charges on any property within the City, payment arrangements must be made before permits of any kind are accepted.

Location/Address of Construction: Rainbow Church / 618 Washington Avenue

Total Square Footage of Proposed Structure	Square Footage of Lot
--	-----------------------

Tax Assessor's Chart, Block & Lot Number Chart# <u>167</u> Block# <u>F</u> Lot# <u>13</u>	Owner: <u>Rainbow United Methodist Church</u>	Telephone #: <u>774-1617</u>
--	--	---------------------------------

Lessee/Buyer's Name (If Applicable)	Owner's/Purchaser/Lessee Address:	Total s.f of signs <u>1150</u> <sup>2</sup> .20 \$ _____, plus \$30.00 TOTAL \$ <u>32.20</u>
-------------------------------------	-----------------------------------	--

Current use: destroyed by construction Proposed use: Church sign: to  
people show our identity and worship time

Project description:  
Rainbow United Methodist Church with Methodist Logos

Applicants Name, Address & Telephone: Seok Hwan Hong, Pastor  
618 Washington Avenue, 774-1617 →  
Contractor's Name, Address & Telephone: call

Who shall we contact when the permit is ready: \_\_\_\_\_  
Telephone: 774-1617

If you would like it mailed, what mailing address should we use: same above 11/14/01

Rec'd By: Gau

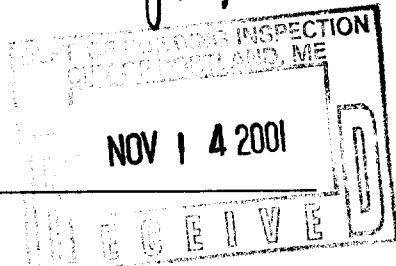

**THIS IS NOT A PERMIT/CONSTRUCTION MAY NOT COMMENCE UNTIL THE PERMIT IS ISSUED**

**If the property is located in a HISTORIC DISTRICT, a separate sketch is required indicating the design, dimensions, construction materials and source of illumination if any. A photograph of the building façade should be submitted, showing where each sign is to be installed.**

**Certification**

*I hereby certify that I am the Owner of record of the named property, or that the owner of record authorizes the proposed work and that I have been authorized by the owner to make this application as his/her authorized agent. I agree to conform to all applicable laws of this jurisdiction. In addition, if a permit for work described in this application is issued, I certify that the Code Official's authorized representative shall have the authority to enter all areas covered by this permit at any reasonable hour to enforce the provisions of the codes applicable to this permit.*

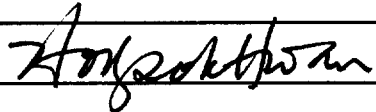
Signature of applicant: 	Date: <i>November 7, 2001</i>
---	-------------------------------

**Sign Permit Fee: \$30.00 plus \$0.20 per square foot.**

***A building permit is also required for any awning based on cost of work-\$30.00 for the first \$1,000.00 and \$6.00 for each additional \$1,000.00***

**BY FILLING OUT THIS APPLICATION IS DOES NOT MEET THAT YOU WILL BE APPROVED FOR THE AMOUNT OF SIGNAGE YOU ARE APPLYING FOR**

**IT IS SUGGESTED THAT YOU DO NOT ORDER ANY SIGNAGE UNTIL YOU HAVE RECEIVED YOUR SIGN PERMIT THAT HAS BEEN SIGNED BY THE BUILDING, ZONING AND POSSIBLE HISTORICAL OFFICIALS OF THIS OFFICE**

**SIGNAGE PRE-APPLICATION**

PLEASE ANSWER ALL QUESTIONS

ADDRESS: 618 Washington Avenue, Portland <sup>04103</sup> ZONE: 7-5

*institutional use  
in Residential zone*

OWNER: Rainbow United Methodist Church

APPLICANT: \_\_\_\_\_

ASSESSOR NO. \_\_\_\_\_

PLEASE CIRCLE APPROPRIATE ANSWER

SINGLE TENANT LOT?  YES NO MULTI-TENANT LOT? YES NO

FREESTANDING SIGN? (ex. Pole Sign) YES NO -- DIMENSIONS \_\_\_\_\_ HEIGHT \_\_\_\_\_

MORE THAN ONE SIGN? YES NO DIMENSIONS \_\_\_\_\_ HEIGHT \_\_\_\_\_

SIGN ATTACHED TO BLDG.? YES  NO DIMENSIONS \_\_\_\_\_  $33 \times 40 = 1584 \div 114 =$

MORE THAN ONE SIGN? YES NO DIMENSIONS \_\_\_\_\_

AWNING: YES  NO IS AWNING BACKLIT? YES NO HEIGHT OFF SIDEWALK \_\_\_\_\_

IS THERE ANY MESSAGE, TRADEMARK OR SYMBOL ON IT? \_\_\_\_\_

LIST ALL EXISTING SIGNAGE AND THEIR DIMENSIONS:

① Information Board (Pastor's name, worship time, and Sermon title)

$11 \# +$   
top  
 $\approx 12 \#$

\*\*\* TENANT BLDG. FRONTAGE (IN FEET): \_\_\_\_\_

\*\*\* REQUIRED INFORMATION

RD Frontage per Assessors = 150'

<u>Legend</u>	<u>Show</u> AREA FOR COMPUTATION
25' max	12' show
8' high	4' high
5' setback	4.5' show

**YOU SHALL PROVIDE:**

A SITE SKETCH AND BUILDING SKETCH SHOWING EXACTLY WHERE EXISTING AND NEW SIGNAGE IS LOCATED MUST BE PROVIDED. SKETCHES AND/OR PICTURES OF PROPOSED ARE ALSO REQUIRED.

SIGNATURE OF APPLICANT: \_\_\_\_\_ DATE: \_\_\_\_\_

Application ID Number: 1-1412

Department: Zoning Status: Approved with Conditions Reviewer: Marge Schmuckal

Comments: 11/28/2001 Jonathan Spence (working in Deb Andrew's capacity) gave an ok on the second sign for this property. Approval Date: 11/28/2001

Given On Date: 11/19/2001

OK to Issue Permit Name: Marge Schmuckal Date: 11/28/2001 Date 2:

Conditions Section: [Redacted]

This sign permit has been approved with the condition that the sign be moved back at least 6 inches so that it will be a minimum of five (5) feet from the front property line. It was understood thru a recent phone call with the church that this would not be a problem.

Create Date: 11/19/2001 By: dgc Update Date: 11/28/2001 By: mes



# Rainbow United Methodist Church

618 Washington Avenue  
PORTLAND, MAINE 04103

SEOK HWAN HONG, Pastor

Telephone (207) 799-0290

**City of Portland  
Sign Inspection Department  
389 Congress Street  
Portland Maine 04101**

**November 14, 2001**

**Dear Sir:**

**We, Rainbow United Methodist Church inform you that it is okay to put the Signboard on in our property. Thank you.**

A handwritten signature in cursive script that reads "Seok Hwan Hong".

**Rev. Seok Hwan Hong, Pastor  
618 Washington Avenue  
Portland, Maine 04103  
207-774-1617**

<b>ACORD</b>		DATE (MM/DD/YY) 7/20/01			
PRODUCER Fred C. Church, Inc. One Merrimack Plaza P.O. Box 1885 Lowell, MA 01853-1885	978-458-1885	THIS CERTIFICATE IS ISSUED AS A MATTER OF INFORMATION ONLY AND CONFERS NO RIGHTS UPON THE CERTIFICATE HOLDER. THIS CERTIFICATE DOES NOT AMEND, EXTEND OR ALTER THE COVERAGE AFFORDED BY THE POLICIES BELOW.			
		<b>COMPANIES AFFORDING COVERAGE</b>			
INSURED New England Annual Conference of The United Methodist Church P. O. Box 249 Lawrence MA 01842		COMPANY A Acadia			
		COMPANY B			
		COMPANY C			
		COMPANY D			
THIS IS TO CERTIFY THAT THE POLICIES OF INSURANCE LISTED BELOW HAVE BEEN ISSUED TO THE INSURED NAMED ABOVE FOR THE POLICY PERIOD INDICATED, NOTWITHSTANDING ANY REQUIREMENT, TERM OR CONDITION OF ANY CONTRACT OR OTHER DOCUMENT WITH RESPECT TO WHICH THIS CERTIFICATE MAY BE ISSUED OR MAY PERTAIN, THE INSURANCE AFFORDED BY THE POLICIES DESCRIBED HEREIN IS SUBJECT TO ALL THE TERMS, EXCLUSIONS AND CONDITIONS OF SUCH POLICIES. LIMITS SHOWN MAY HAVE BEEN REDUCED BY PAID CLAIMS.					
CO LTR	TYPE OF INSURANCE	POLICY NUMBER	POLICY EFFECTIVE DATE (MM/DD/YY)	POLICY EXPIRATION DATE (MM/DD/YY)	LIMITS
A	<b>GENERAL LIABILITY</b> <input checked="" type="checkbox"/> COMMERCIAL GENERAL LIABILITY <input type="checkbox"/> CLAIMS MADE <input checked="" type="checkbox"/> OCCUR <input type="checkbox"/> OWNER'S & CONTRACTOR'S PROT	CPA150069412	8/01/01	8/01/02	GENERAL AGGREGATE \$ 200000 PRODUCTS - COMP/OP AGG \$ 200000 PERSONAL & ADV INJURY \$ 100000 EACH OCCURRENCE \$ 100000 FIRE DAMAGE (Any one fire) \$ 300000 MED EXP (Any one person) \$ 15000
A	<b>AUTOMOBILE LIABILITY</b> <input type="checkbox"/> ANY AUTO <input type="checkbox"/> ALL OWNED AUTOS <input checked="" type="checkbox"/> SCHEDULED AUTOS <input checked="" type="checkbox"/> HIRED AUTOS <input checked="" type="checkbox"/> NON-OWNED AUTOS	MAA150069612	8/01/01	8/01/02	COMBINED SINGLE LIMIT \$ 100000 BODILY INJURY (Per person) \$ BODILY INJURY (Per accident) \$ PROPERTY DAMAGE \$
	<b>GARAGE LIABILITY</b> <input type="checkbox"/> ANY AUTO				AUTO ONLY - EA ACCIDENT \$ OTHER THAN AUTO ONLY: \$ EACH ACCIDENT \$ AGGREGATE \$
A	<b>EXCESS LIABILITY</b> <input checked="" type="checkbox"/> UMBRELLA FORM <input type="checkbox"/> OTHER THAN UMBRELLA FORM	CUA150069712	8/01/01	8/01/02	EACH OCCURRENCE \$ 1000000 AGGREGATE \$ 1000000
A	<b>WORKERS COMPENSATION AND EMPLOYERS' LIABILITY</b> THE PROPRIETOR/PARTNERS/EXECUTIVE OFFICERS ARE: <input type="checkbox"/> INCL <input type="checkbox"/> EXCL	WPA150069813	1/01/01	1/01/02	<input checked="" type="checkbox"/> WC STATUTORY LIMITS <input type="checkbox"/> OTH-ER EL EACH ACCIDENT \$ 500000 EL DISEASE - POLICY LIMIT \$ 500000 EL DISEASE - EA EMPLOYEE \$ 500000
A	<b>OTHER</b> PROPERTY COVERAGE ALL RISK	CPA150069412	8/01/01	8/01/02	REPLACEMENT COST
DESCRIPTION OF OPERATIONS/LOCATIONS/VEHICLES/SPECIAL ITEMS RE: Rainbow UMC, Church#90054					
General Board of Global Ministries of the UMC 955 Riverside St. New York, New York			SHOULD ANY OF THE ABOVE DESCRIBED POLICIES BE CANCELLED BEFORE THE EXPIRATION DATE THEREOF, THE ISSUING COMPANY WILL ENDEAVOR TO MAIL 10 DAYS WRITTEN NOTICE TO THE CERTIFICATE HOLDER NAMED TO THE LEFT, BUT FAILURE TO MAIL SUCH NOTICE SHALL IMPOSE NO OBLIGATION OR LIABILITY OF ANY KIND UPON THE COMPANY, ITS AGENTS OR REPRESENTATIVES.		
			AUTHORIZED REPRESENTATIVE <i>Herman P. Jakeman</i>		

CONTENTS:

\* NOTE: TRANSCRIBE  
 Ⓞ to corresponding  
 page.

- Concrete: Pg. 2
- Pavers: Pg. 3
- LAWN: Pg. 4
- PLANTER BED: Pg. 5

PLANTER → 

KEY → 

CONCRETE → 

GRASS → 

PAVERS → 

GRANITE → 

TREE REMOVAL ⊗  
 HEDGES ~~~~~

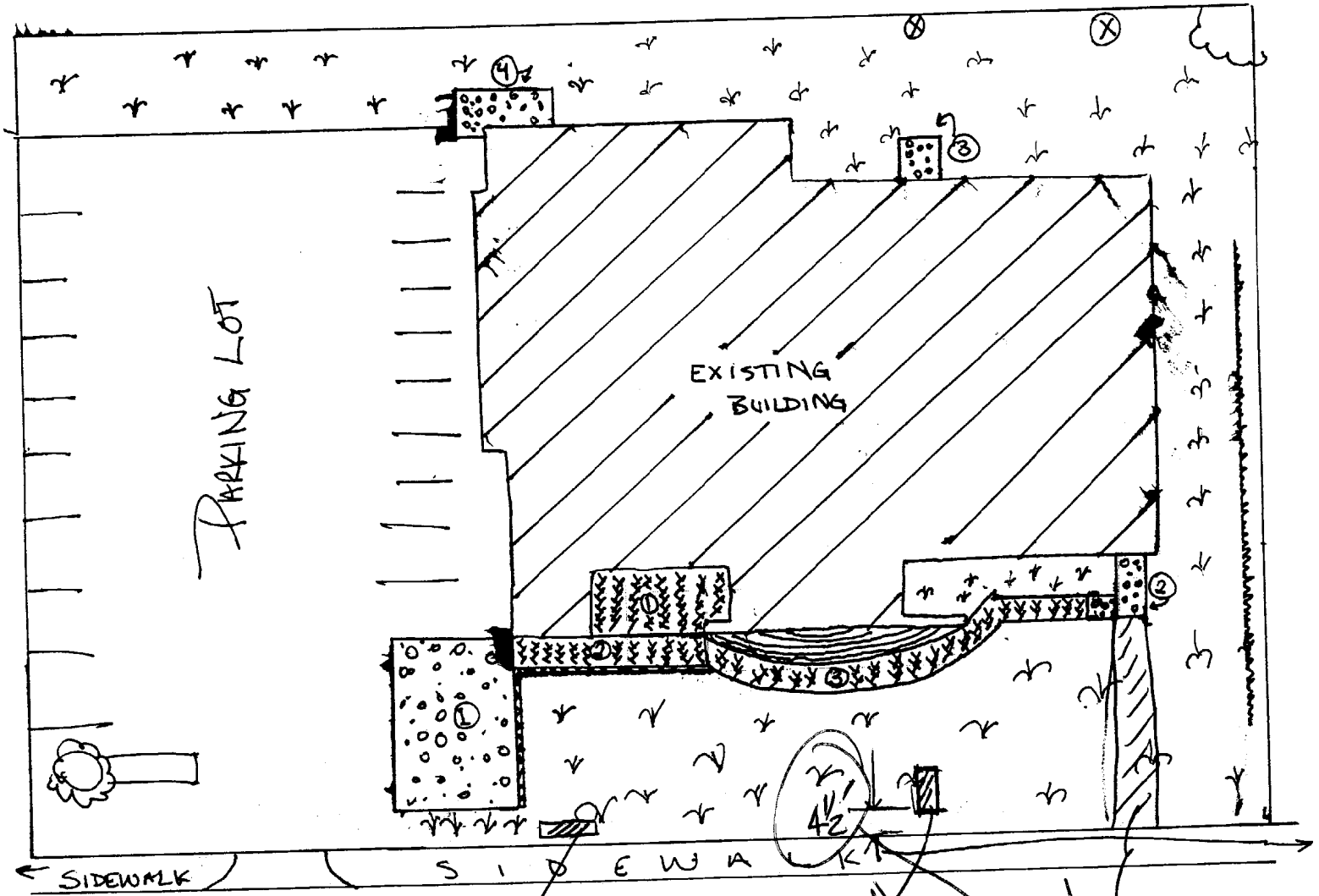

INFORMATION BOARD

CHURCH SIGN BOARD

Req'd to be 5' CEMENT PATH FOR HANDICAPED.

SCALE 1"=20'

150' of frontage per assessors



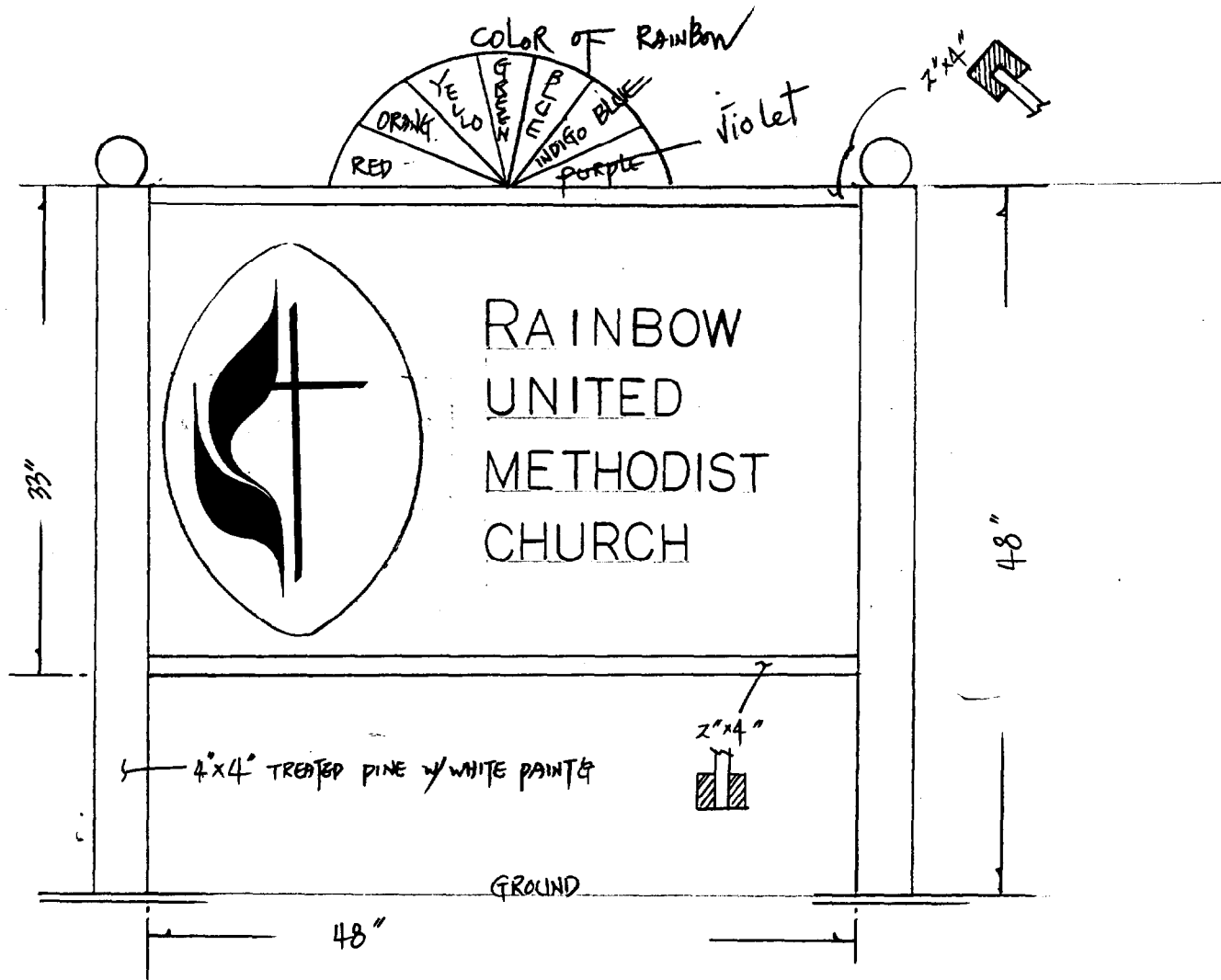

\* WHITE BOARD & BLACK LETTERING

DUPLICATE

GENERAL RECEIPT

CITY OF PORTLAND, MAINE

DEPARTMENT: Inspections DATE: 11/14/01

RECEIVED FROM: [Handwritten Name]

ADDRESS: 65 Washington Ave

UNIT	ITEM	REVENUE CODE	DOLLAR AMOUNT
	Sign 11 SF		32.00
	0		
	Check		
	CBZ 10 F 013		

CASH  CHECK  OTHER

TOTAL 32.00

RECEIVED BY: [Handwritten Signature]