

City of Portland, Maine – Building or Use Permit Application 389 Congress Street, 04101, Tel: (207) 874-8703, FAX: 874-8716

Location of Construction: 606 Washington Ave		Owner: Anania's Inc.		Phone:		Permit No:	
Owner Address: SAA Ptd, ME 04103		Lessee/Buyer's Name: Anania's		Phone:		BusinessName:	
Contractor Name: Sign Design		Address: 799-2000		Phone:		Permit Issued:	
Past Use: Retail		Proposed Use: Same		COST OF WORK: \$ 3,650.00		PERMIT FEE: \$ 59.00	
				FIRE DEPT. <input type="checkbox"/> Approved <input type="checkbox"/> Denied		INSPECTION: Use Group: Type:	
				Signature:		Signature:	
Proposed Project Description: Erect Signage & Awning				PEDESTRIAN ACTIVITIES DISTRICT (P.A.D.)			
				Action: Approved <input type="checkbox"/> Approved with Conditions: <input type="checkbox"/> Denied <input type="checkbox"/>			
				Signature: _____ Date: _____			
Permit Taken By: XXXXXXXX M. Gresik		Date Applied For: 20 May 1997					

1. This permit application does not preclude the Applicant(s) from meeting applicable State and Federal rules.
2. Building permits do not include plumbing, septic or electrical work.
3. Building permits are void if work is not started within six (6) months of the date of issuance. False information may invalidate a building permit and stop all work..

Zone: CBL: 167-F-011

Zoning Approval:

Special Zone or Reviews:

Shoreland
 Wetland
 Flood Zone
 Subdivision
 Site Plan maj minor mm

Zoning Appeal

Variance
 Miscellaneous
 Conditional Use
 Interpretation
 Approved
 Denied

Historic Preservation

Not in District or Landmark
 Does Not Require Review
 Requires Review

Action:

Approved
 Approved with Conditions
 Denied

Date: _____

CERTIFICATION

I hereby certify that I am the owner of record of the named property, or that the proposed work is authorized by the owner of record and that I have been authorized by the owner to make this application as his authorized agent and I agree to conform to all applicable laws of this jurisdiction. In addition, if a permit for work described in the application is issued, I certify that the code official's authorized representative shall have the authority to enter all areas covered by such permit at any reasonable hour to enforce the provisions of the code(s) applicable to such permit

Ed Anania
 SIGNATURE OF APPLICANT Ed Anania ADDRESS: 606 Washington Ave DATE: 20 May 1997 PHONE: 774-4639

RESPONSIBLE PERSON IN CHARGE OF WORK, TITLE PHONE:



SIGNAGE

PLEASE ANSWER ALL QUESTIONS

Address: 606 Washington Av. Zone: R5
Owner: Anania's Inc. Assessors #: 167-F-011
Applicant: Ed Anania, Jr.

Single Tenant Lot?: Yes No

Multi Tenant Lot?: Yes No

Freestanding (Ext pole sign)? Yes No Dimensions 4' X 5'

More than (1) one sign?: Yes No Dimensions _____ ^{less}

Bldg Wall sign (att to bldg)? Yes No Dimensions 2 1/2' X 30'

List all existing signage and their dimensions:

Awning (with arrow pointing to the awning question)

- ① Free Standing sign 5' X 5' to be replaced
- ① Bldg. Wall Sign 4' X 30' to be replaced

old permits show 5' X 6' pole sign

Lot Frontage(feet): 100' Tenant Frontage(feet): _____

Serving The Non-conformity
AWNINGS

Awning?: Yes No *Is Awning Backlit?: Yes No

Is there any communication, message, trademark or symbol on awning?

Height of Awning?: 4'
*2 1/2' X 30 is illumination.
1 1/2' X 30 is not.*

PLEASE NOTE: Approvals for signs on the Public Sidewalk and temporary signs come under different requirements and regulations.

ALSO: See reverse side for additional information, requirements and materials needed for signage application submittal.

Francis
606 Washington Av.
Face Standing Sign

Existing (25 sq Ft)

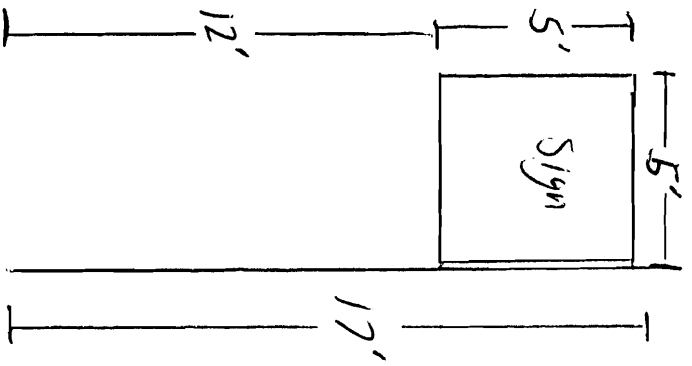

New (20 sq Ft)

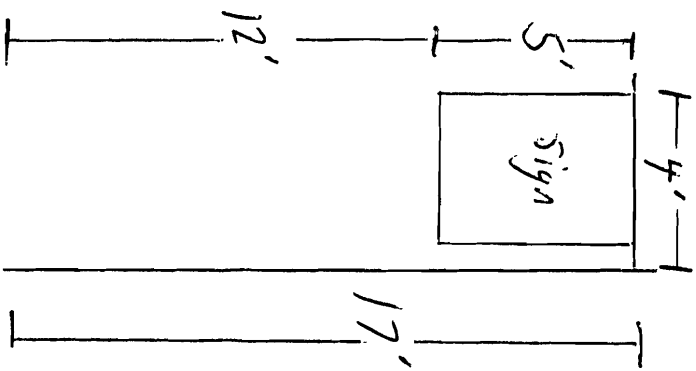

The pole sign is 7 1/2' in front of the Building

← Residence

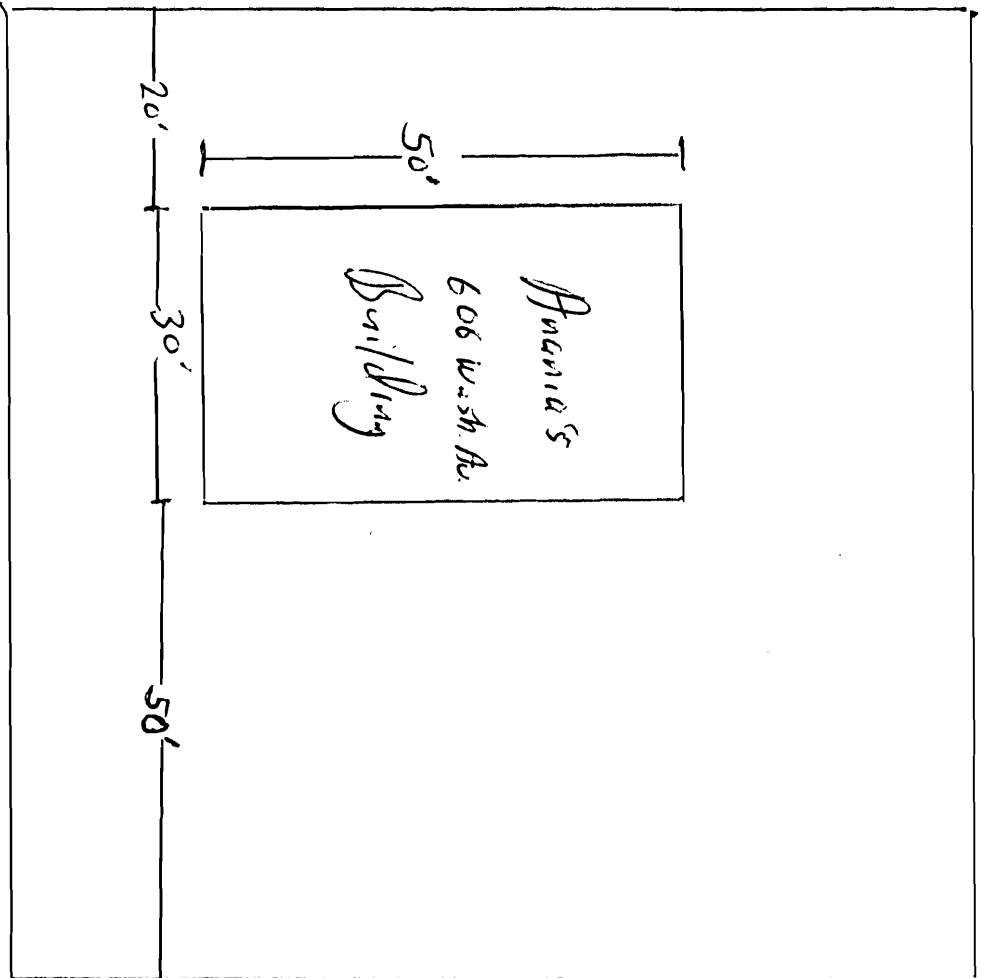

Washington Av (Front)

Church →

Anania's (Formerly LaRosas)
606 Washington Av.
Existing Signage

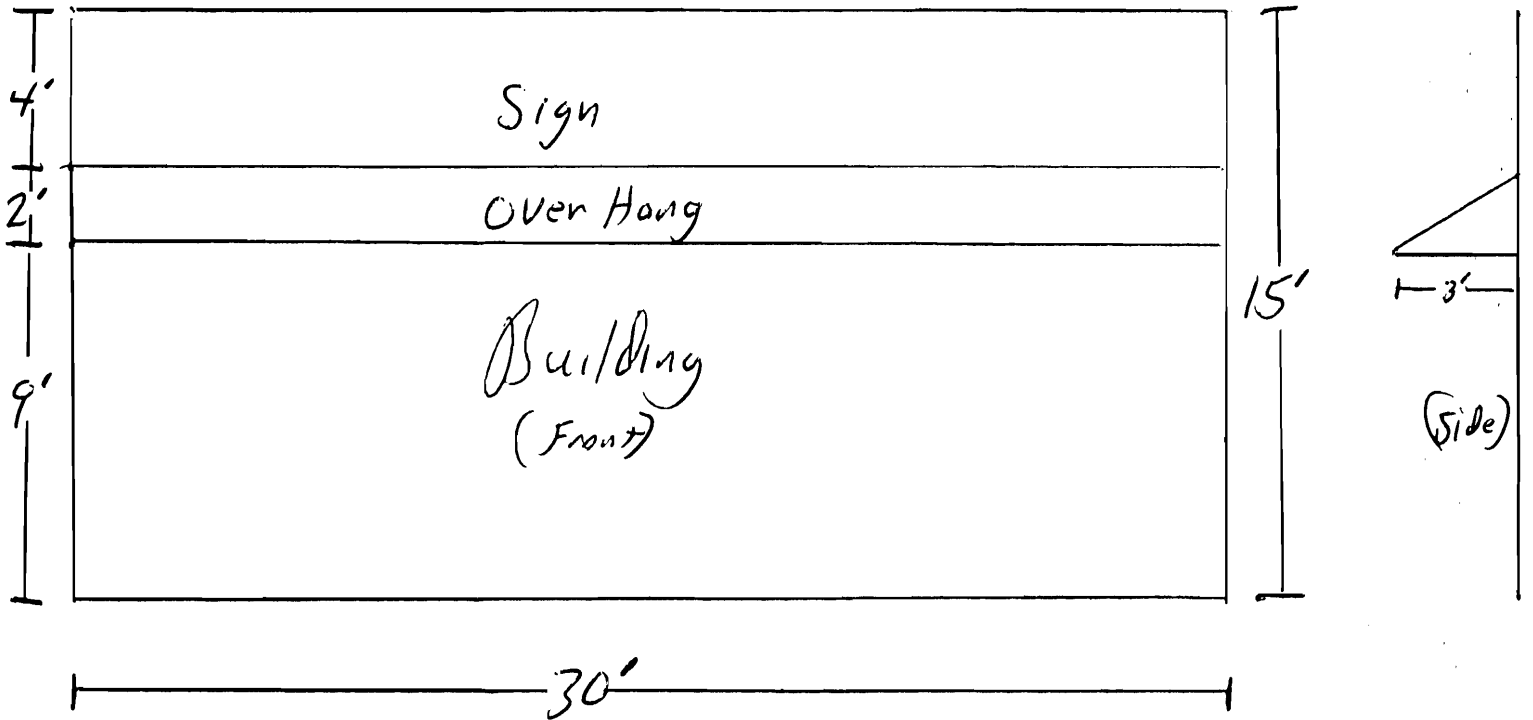

New Signage

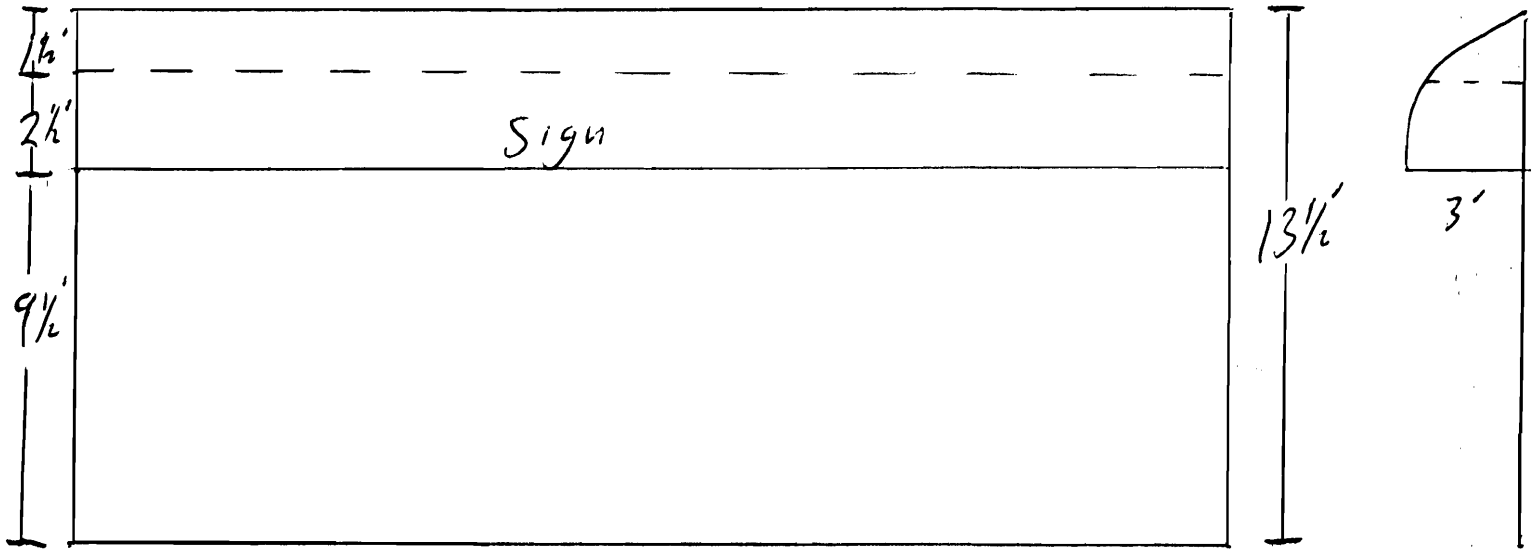

The New Sign/Awning is V with a metal Frame