

A - SIMPSON STRONG TIE BASE ABA462 CONNECTED TO CONCRETE FOOTER

B - 10" DIA. SONOTUBE CONCRETE FOOTER (4)

C - 4x6 BEAM PRESSURE TREATED

D - 4x6 POST PRESSURE TREATED

E - 1" THICK CEDAR DECKING FOR TREADS + LANDING + RISERS

C + D ATTACHED WITH SIMPSON STRONG TIE EPC62 6x END POST CAP

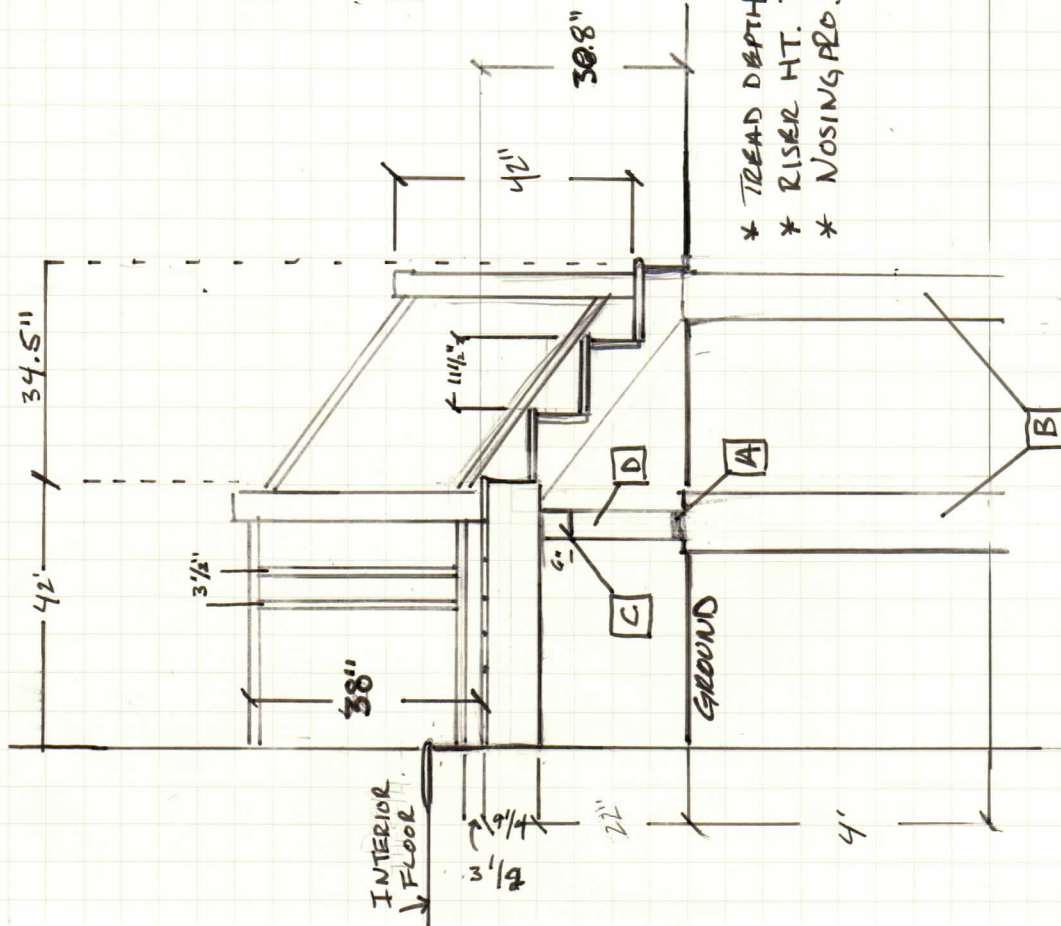

3/8" = 1'