

**City of Portland, Maine – Building or Use Permit Application** 389 Congress Street, 04101, Tel: (207) 874-8703, FAX: 874-8716

Location of Construction: 25 Galvin Street		Owner: Virginia Wilson		Phone: 774-1953		Permit No: <b>000021</b>	
Owner Address: SAA		Lessee/Buyer's Name:		Phone:		BusinessName:	
Contractor Name: <b>**McGreggors Masonry &amp; Chimney Service Inc.</b>		Address: RR1 Box 118, Buxton, ME 04093		Phone: 929-8432		Permit Issued:	
Past Use: 2 Family		Proposed Use: Same		COST OF WORK: \$ 3,300		PERMIT FEE: \$ 48.00	
				FIRE DEPT. <input type="checkbox"/> Approved <input type="checkbox"/> Denied		INSPECTION: Use Group: R-3 Type: 5B BOCA 96	
Proposed Project Description: Remove 25' of chimney/2 fireplaces. Debris will be removed by truck and disposed. Chimney is free standing not a support. Roof, attic, 1st and 2nd floor will be boarded in w/pine 2 x 4 & 2 x 6.		Signature:		Signature: <i>Hoffner</i>		Zone: <b>R-5</b> CBL: 166-E-009	
		PEDESTRIAN ACTIVITIES DISTRICT (P.A.D.)		Action: <input type="checkbox"/> Approved <input type="checkbox"/> Approved with Conditions <input type="checkbox"/> Denied		Zoning Approval: <i>2 units ok per mic review</i> <b>Special Zone or Reviews:</b> <input type="checkbox"/> Shoreland <input type="checkbox"/> Wetland <i>to remain</i> <input type="checkbox"/> Flood Zone <i>2 units only</i> <input type="checkbox"/> Subdivision <input type="checkbox"/> Site Plan maj <input type="checkbox"/> minor <input type="checkbox"/> mm <input type="checkbox"/>	
Permit Taken By: UB		Date Applied For: 1/7/00		Signature:		Date:	

1. This permit application does not preclude the Applicant(s) from meeting applicable State and Federal rules.
2. Building permits do not include plumbing, septic or electrical work.
3. Building permits are void if work is not started within six (6) months of the date of issuance. False information may invalidate a building permit and stop all work..

\*\*\*Send to: McGreggors Masonry & Chimney Services Inc.  
RR1 Box 118  
Buxton, ME 04093

**CERTIFICATION**

I hereby certify that I am the owner of record of the named property, or that the proposed work is authorized by the owner of record and that I have been authorized by the owner to make this application as his authorized agent and I agree to conform to all applicable laws of this jurisdiction. In addition, if a permit for work described in the application is issued, I certify that the code official's authorized representative shall have the authority to enter all areas covered by such permit at any reasonable hour to enforce the provisions of the code(s) applicable to such permit

1-7-00

SIGNATURE OF APPLICANT \_\_\_\_\_ ADDRESS: \_\_\_\_\_ DATE: \_\_\_\_\_ PHONE: \_\_\_\_\_

RESPONSIBLE PERSON IN CHARGE OF WORK, TITLE \_\_\_\_\_ PHONE: \_\_\_\_\_

White-Permit Desk Green-Assessor's Canary-D.P.W. Pink-Public File Ivory Card-Inspector

**Zoning Appeal**

Variance  
 Miscellaneous  
 Conditional Use  
 Interpretation  
 Approved  
 Denied

**Historic Preservation**

Not in District or Landmark  
 Does Not Require Review  
 Requires Review

**Action:**

Approved  
 Approved with Conditions  
 Denied

Date: \_\_\_\_\_ *S*

**CEO DISTRICT** 2  
ub

**THIS IS NOT A PERMIT/CONSTRUCTION CANNOT COMMENCE UNTIL THE PERMIT IS ISSUED**

**Building or Use Permit Pre-Application  
Attached Single Family Dwellings/Two-Family Dwelling  
Multi-Family or Commercial Structures and Additions Thereto**

In the interest of processing your application in the quickest possible manner, please complete the information below for a Building or Use Permit.

**NOTE\*\*If you or the property owner owes real estate or personal property taxes or user charges on ANY PROPERTY within the City, payment arrangements must be made before permits of any kind are accepted.**

Location/Address of Construction (include Portion of Building): <b>25 Galvin St</b>		
Total Square Footage of Proposed Structure	Square Footage of Lot	
Tax Assessor's Chart, Block & Lot Number Chart# <b>166</b> Block# <b>E</b> Lot# <b>009</b>	Owner: <b>Virginia Wilson</b>	Telephone#: <b>774-1953</b>
Owner's Address: <b>25 GALVAN ST. PORTLAND ME.</b>	Lessee/Buyer's Name (If Applicable)	Cost Of Work: <b>\$3300.00</b> Fee: <b>\$398</b>
Proposed Project Description (Please be as specific as possible) <b>To Remove 25' of chimney / 2 Fireplaces. chimney is free standing. NOT a SUPPORT. The ROOF/ATTIC / 1st and 2nd floor will be boarded in w/ 2x4's &amp; 2x6's. Debris will be and removed by truck disposed.</b>		
Contractor's Name, Address & Telephone: <b>McGreggors masonry &amp; Chimney Service INC. BBI Box 118 Buxton ME 04093</b>		Rec'd By: <b>WB</b>
Current Use: <b>2 FAMILY</b>	Proposed Use: <b>same</b>	

Separate permits are required for Internal & External Plumbing, HVAC and Electrical installation.

- All construction must be conducted in compliance with the 1996 B.O.C.A. Building Code as amended by Section 6-Art II.
- All plumbing must be conducted in compliance with the State of Maine Plumbing Code.
- All Electrical Installation must comply with the 1996 National Electrical Code as amended by Section 6-Art III.
- HVAC (Heating, Ventilation and Air Conditioning) installation must comply with the 1993 BOCA Mechanical Code.

You must include the following with your application:

- 1) A Copy of Your Deed or Purchase and Sale Agreement
- 2) A Copy of your Construction Contract, if available
- 3) A Plot Plan/Site Plan

Minor or Major site plan review will be required for the above proposed projects. The attached checklist outlines the minimum standards for a site plan.

**4) Building Plans**

Unless exempted by State Law, construction documents must be designed by a registered design professional.

A complete set of construction drawings showing all of the following elements of construction:

- Cross Sections w/ Framing details (including porches, decks w/ railings, and accessory structures)
- Floor Plans & Elevations
- Window and door schedules
- Foundation plans with required drainage and dampproofing
- Electrical and plumbing layout. Mechanical drawings for any specialized equipment such as furnaces, chimneys, gas equipment, HVAC equipment (air handling) or other types of work that may require special review must be included.

**Certification**

I hereby certify that I am the Owner of record of the named property, or that the proposed work is authorized by the owner of record and that I have been authorized by the owner to make this application as his/her authorized agent. I agree to conform to all applicable laws of this jurisdiction. In addition, if a permit for work described in this application is issued, I certify that the Code Official's authorized representative shall have the authority to enter all areas covered by this permit at any reasonable hour to enforce the provisions of the codes applicable to this permit.

Signature of applicant: <i>[Signature]</i>	Date: <b>1/7/00</b>
--	---------------------

Building Permit Fee: \$30.00 for the 1st \$1000.00 cost plus \$6.00 per \$1,000.00 construction cost thereafter.  
Additional Site review and related fees are attached on a separate addendum



*Pine 2x4 & 2x6*  
*929-8432*

M'Gregg's Masonry  
929-8432

Virginia  
Wilson  
25 Galvan ST  
Portland

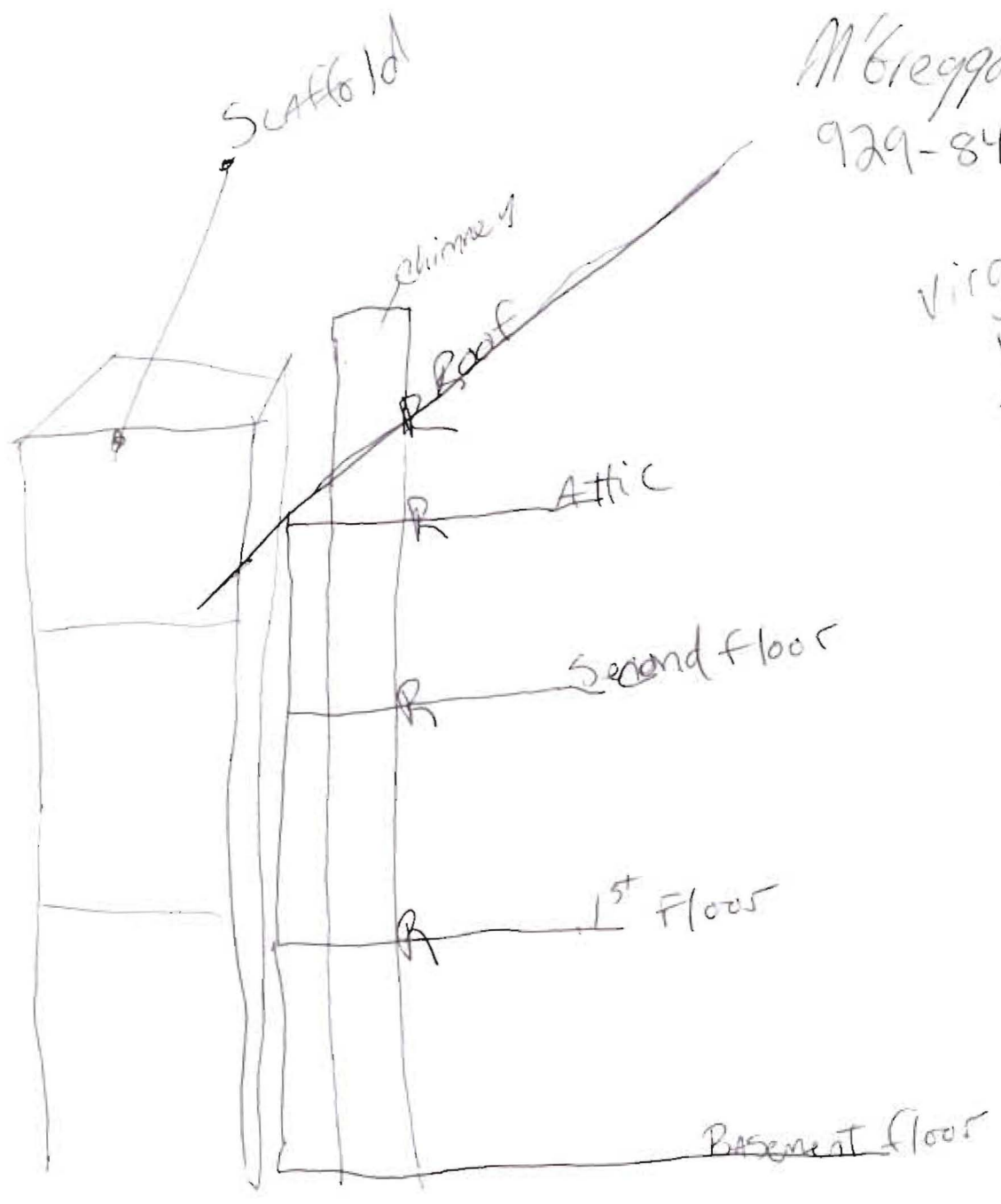

To Remove Chimney  
and ~~replace~~<sup>reinforce</sup> wood floors  
w/ 2x4's and Pine 2x6's (R)

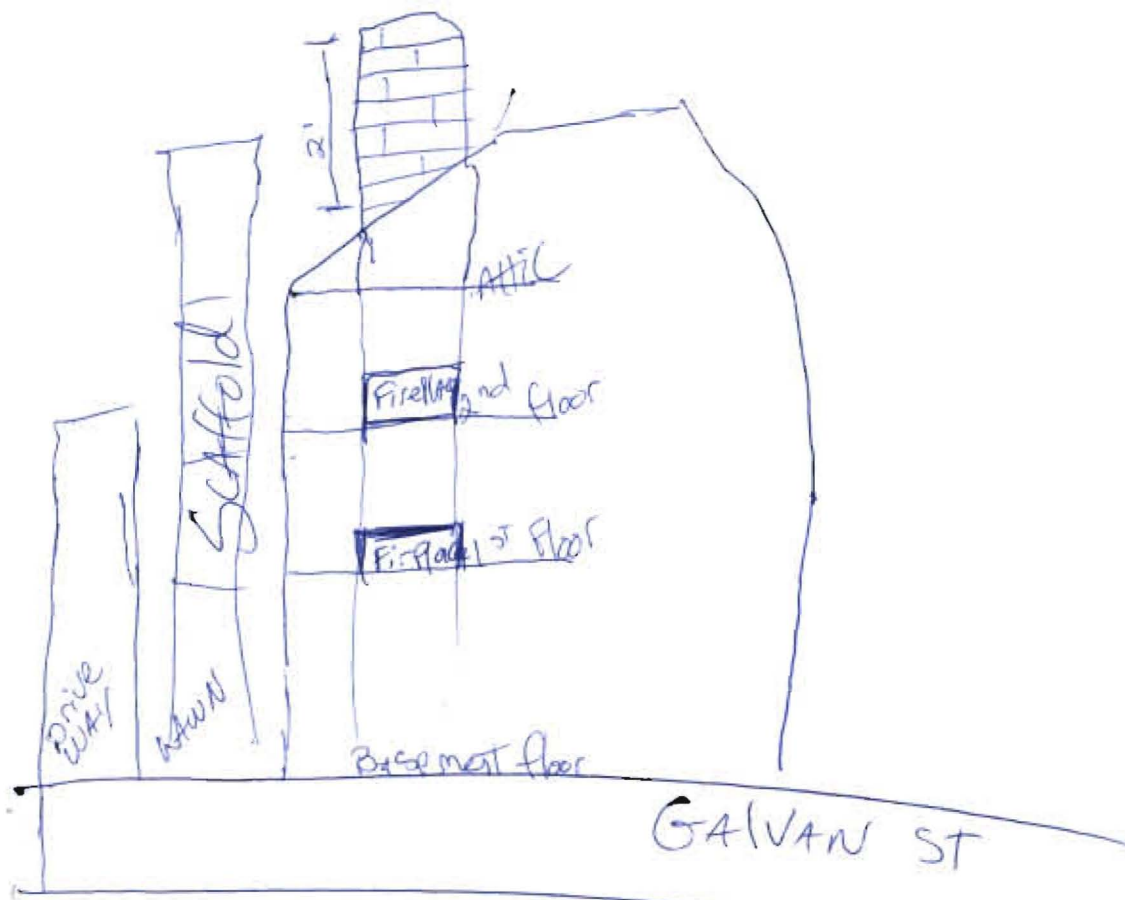

Exterior Chimney will be removed  
by buckets

Inner chimney will be removed  
by fireplace openings

All

People will be standing in front of  
Fireplaces w/ BARACADES and VACUMES  
for Dust,