

1 BITUMINOUS CONCRETE PAVING (VEHICULAR)  
SCALE: 1"=1'-0"

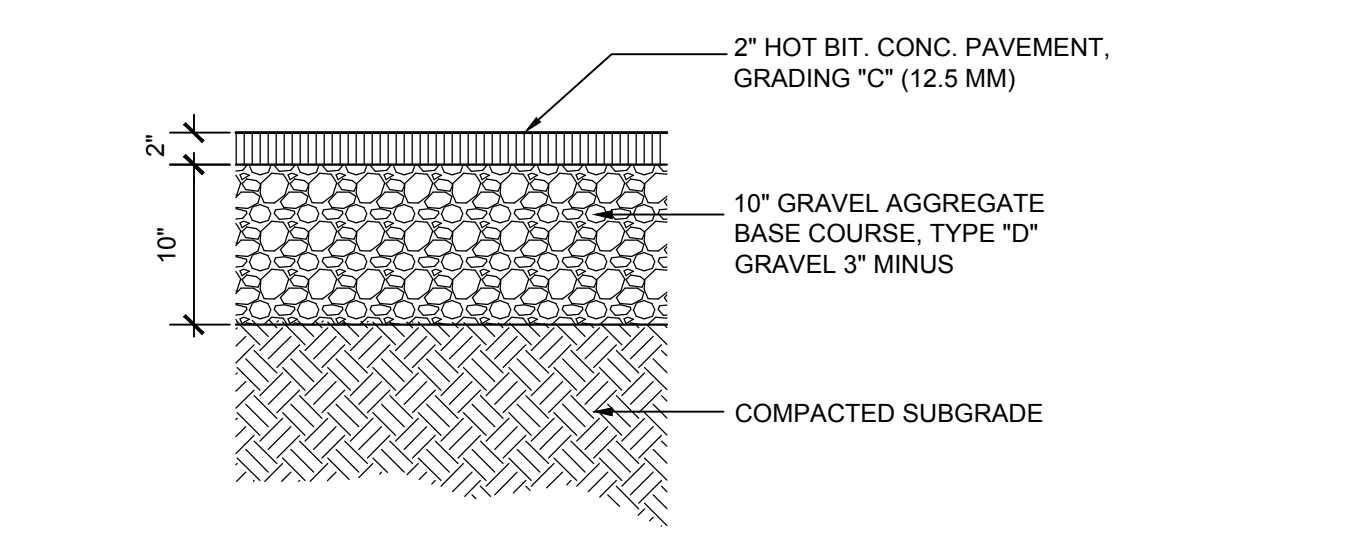

2 BITUMINOUS CONCRETE PAVING (PEDESTRIAN)  
SCALE: 1"=1'-0"

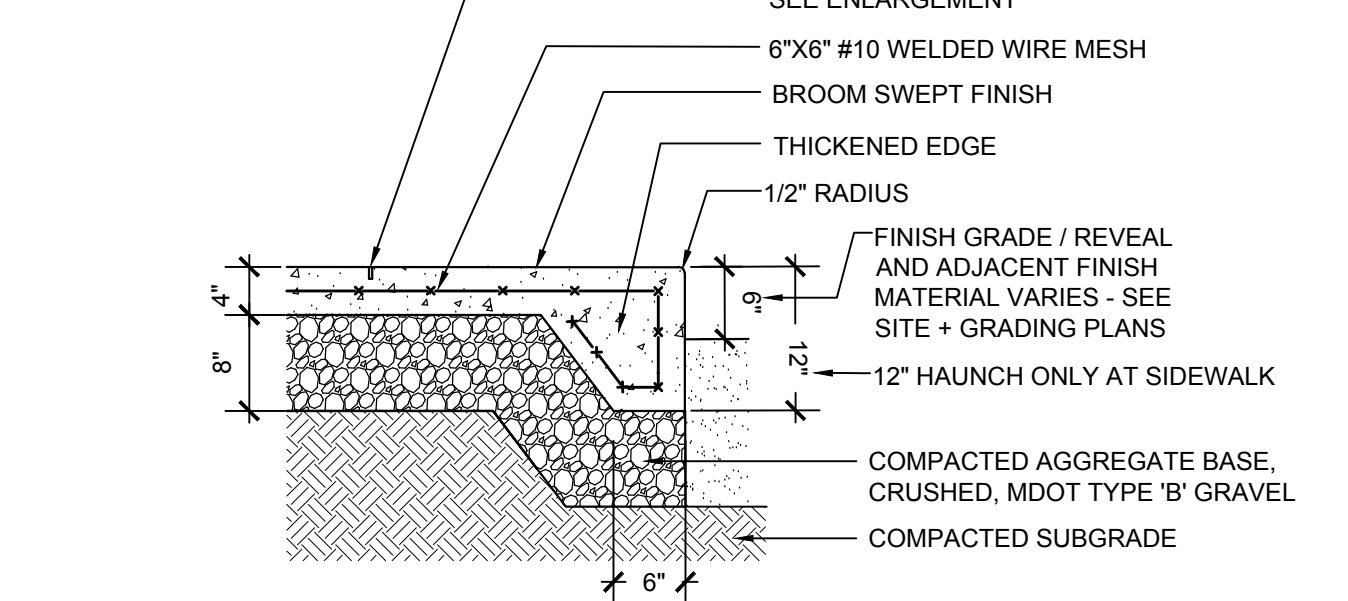
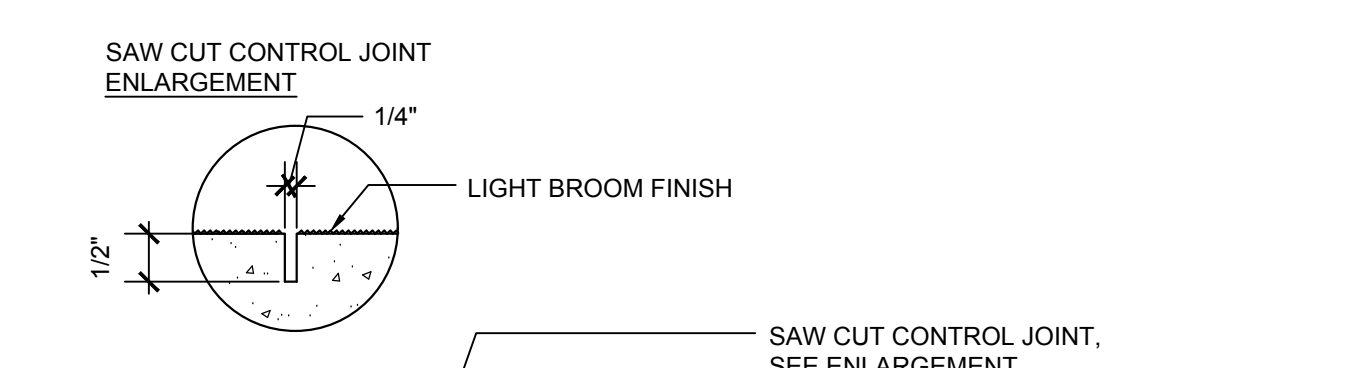

**CONCRETE SPECIFICATION:**  
 • 4000 p.s.i.  
 • 3/4" AGGREGATE  
 • 6-7% AIR ENTRAINMENT  
 • SLUMP: 4" ± 1"

**CONTROL JOINT SPECIFICATION:**  
 • SPACING OF JOINTS  
 • 10 FEET ON CENTER ALONG LENGTH  
 • 6 FEET ON CENTER ALONG WIDTH  
 • SAW CUT JOINTS AT 1/2" MAX. DEPTH

**FINISH SPECIFICATION:**  
 • BROOM SWEEP FINISH  
 • CURE WITH CURE-TO-SPEC MS  
 • AFTER CONSTRUCTION JOINTS HAVE BEEN FILLED AND SEALED, APPLY "CONSOLIDACK SALTGUARD"

**NOTE:**  
 ALL CONCRETE SHALL BE PLACED BY AN A.C.I. FLATWORK CERTIFIED FINISHER

3 CONCRETE PAVING + INTEGRAL CURB  
SCALE: 3/4"=1'-0"

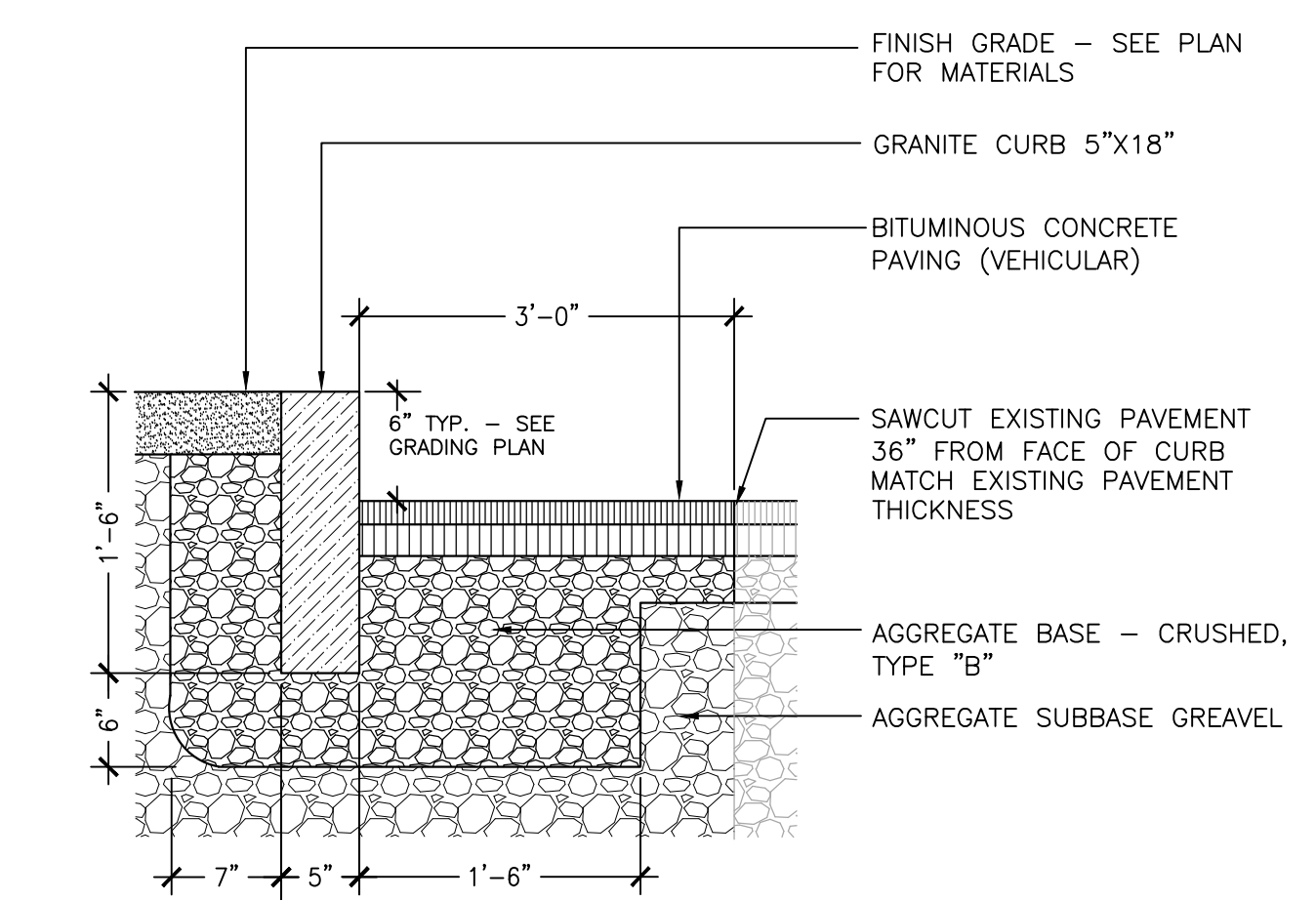

4 GRANITE CURBING (IN CITY R.O.W.)  
SCALE: 1"=1'-0"

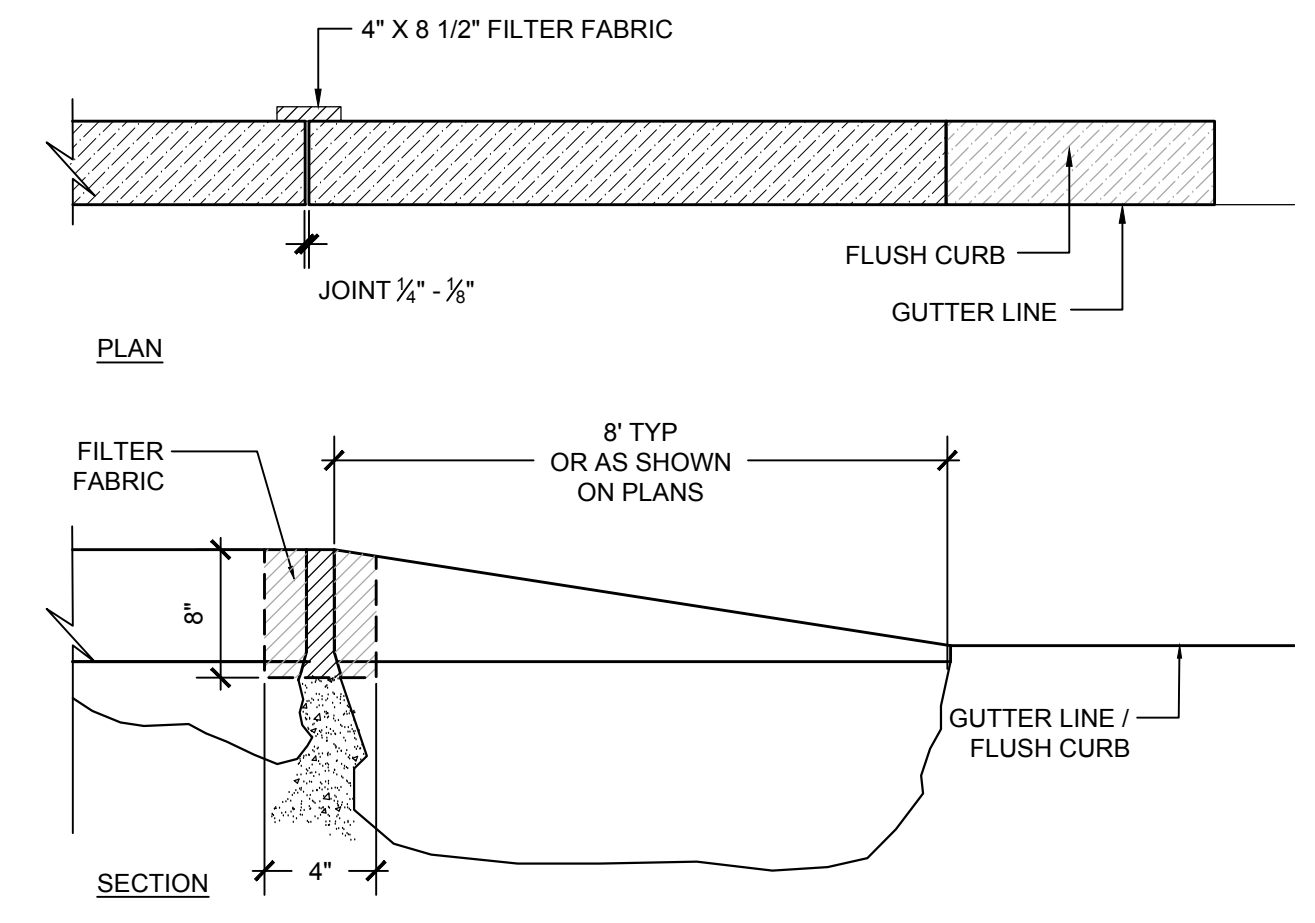

5 TRANSITION CURB  
SCALE: 1"=1'-0"

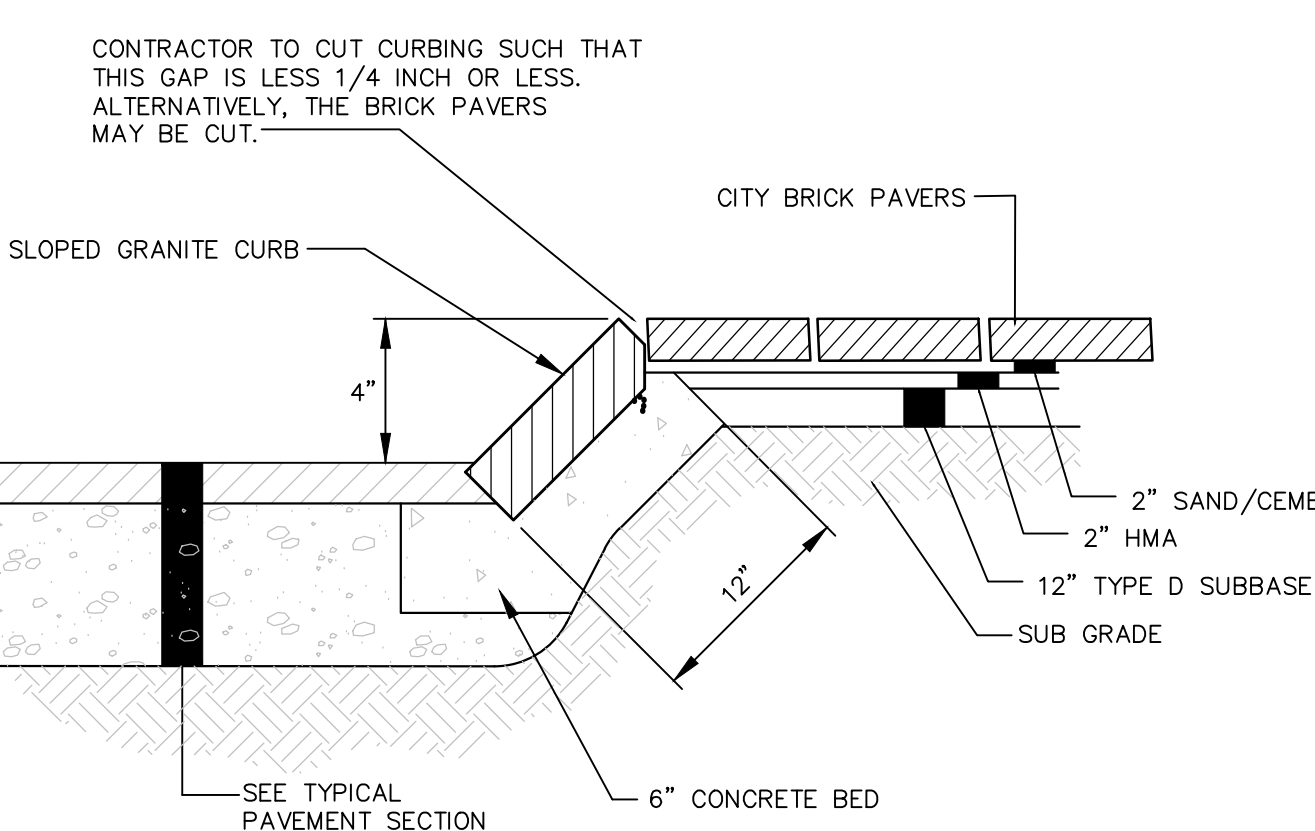

6 SLOPED GRANITE CURB (IN CITY R.O.W. @ W. PRESEUMSCOT & FRONT STREET)  
SCALE: 1"=1'-0"

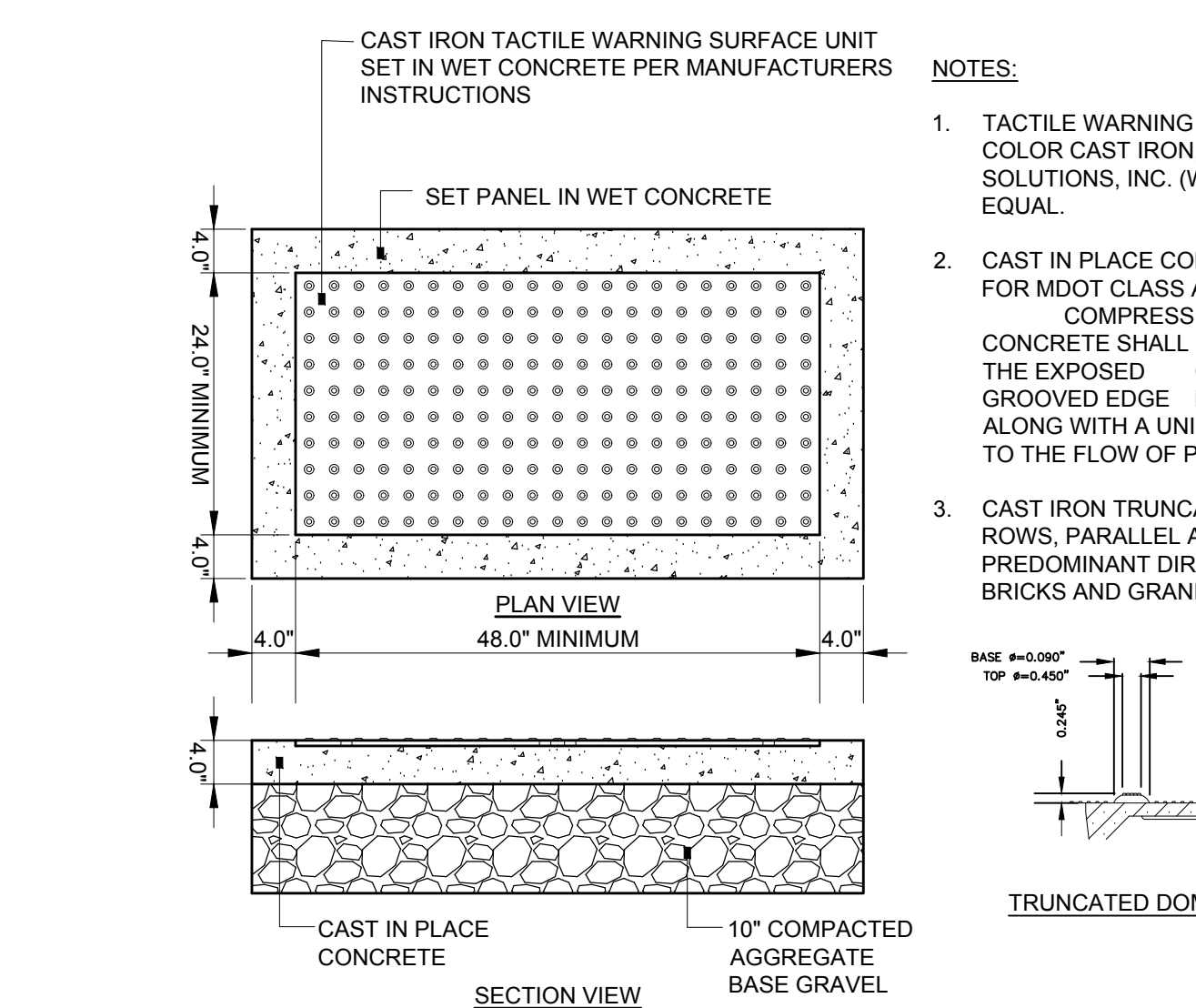

7 DETECTABLE WARNING STRIP (AT STREET CROSSING ONLY)  
SCALE: N.T.S.

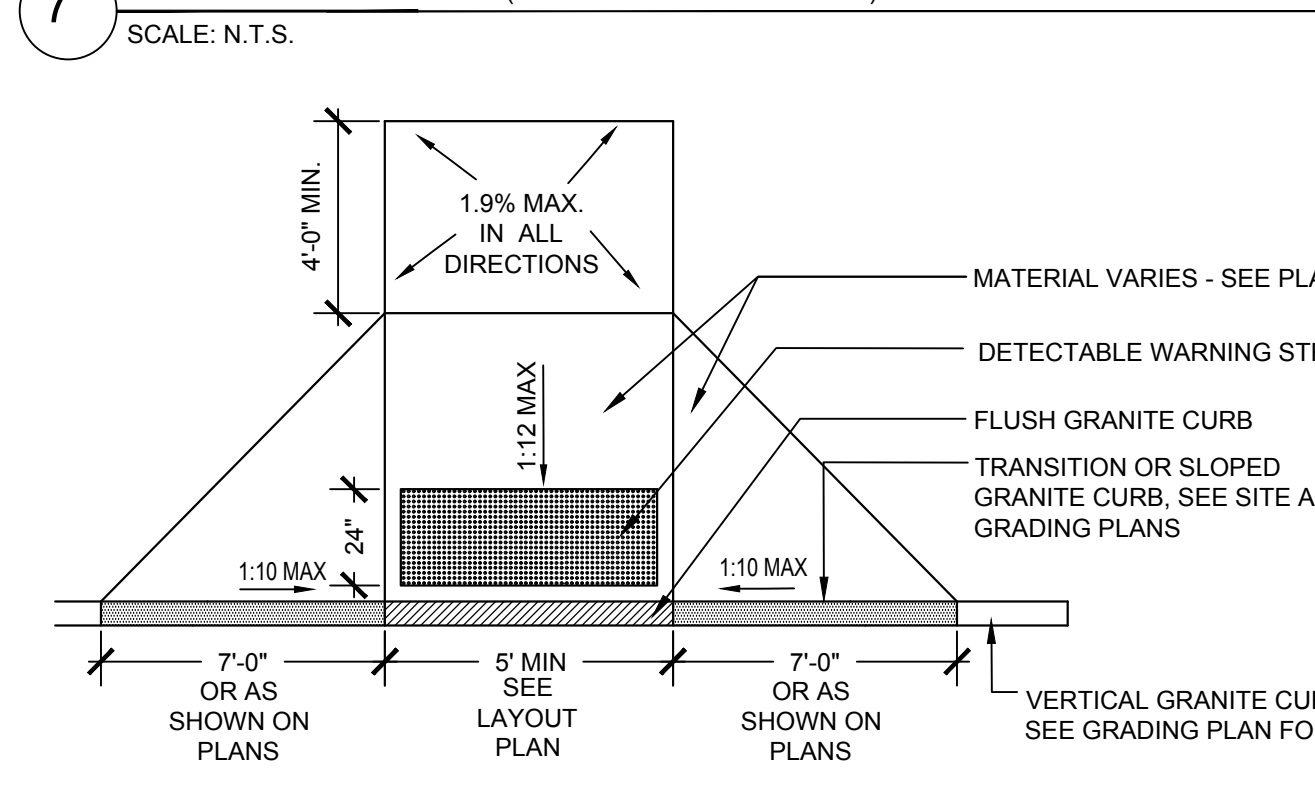

8 CURB RAMPS  
SCALE: 3/8"=1'-0"

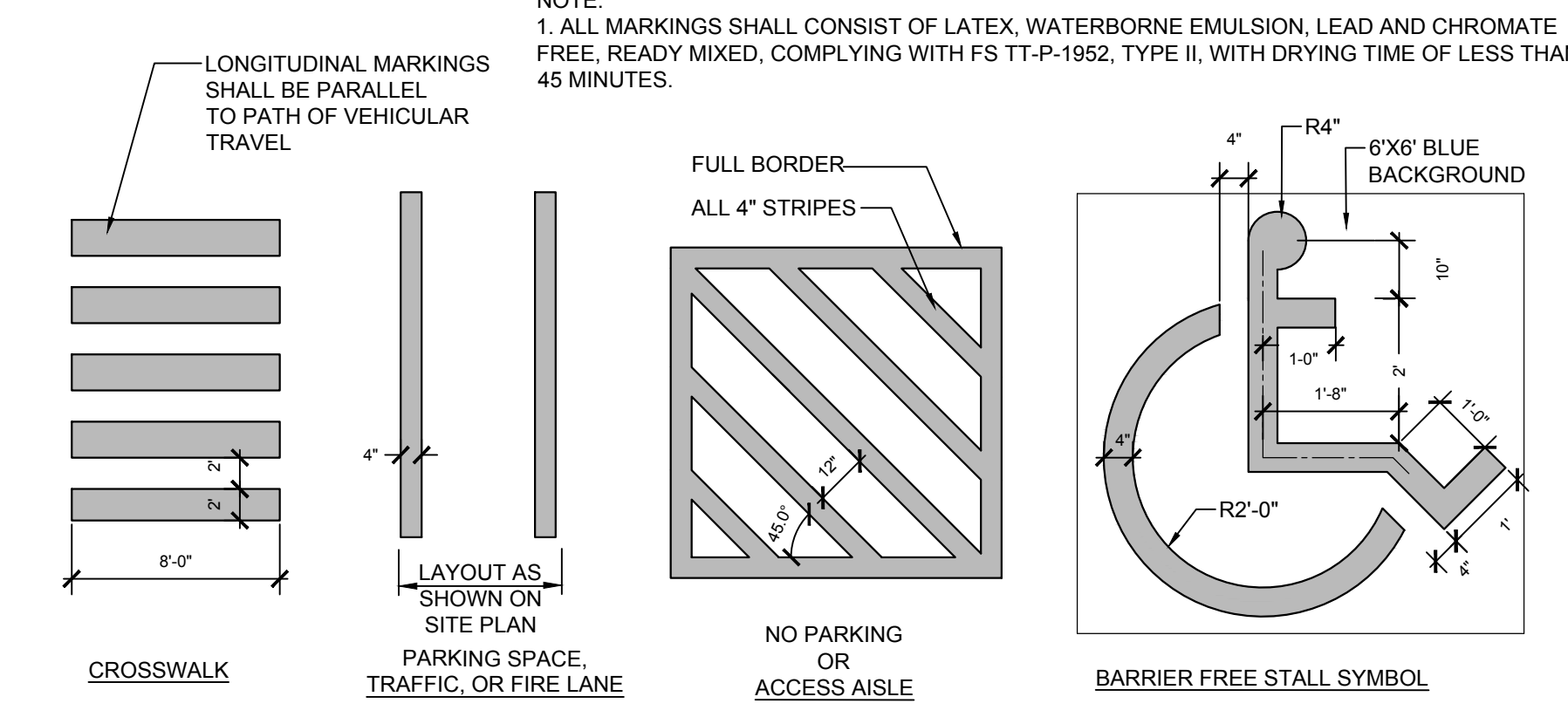

9 LINE STRIPING  
SCALE: N.T.S.

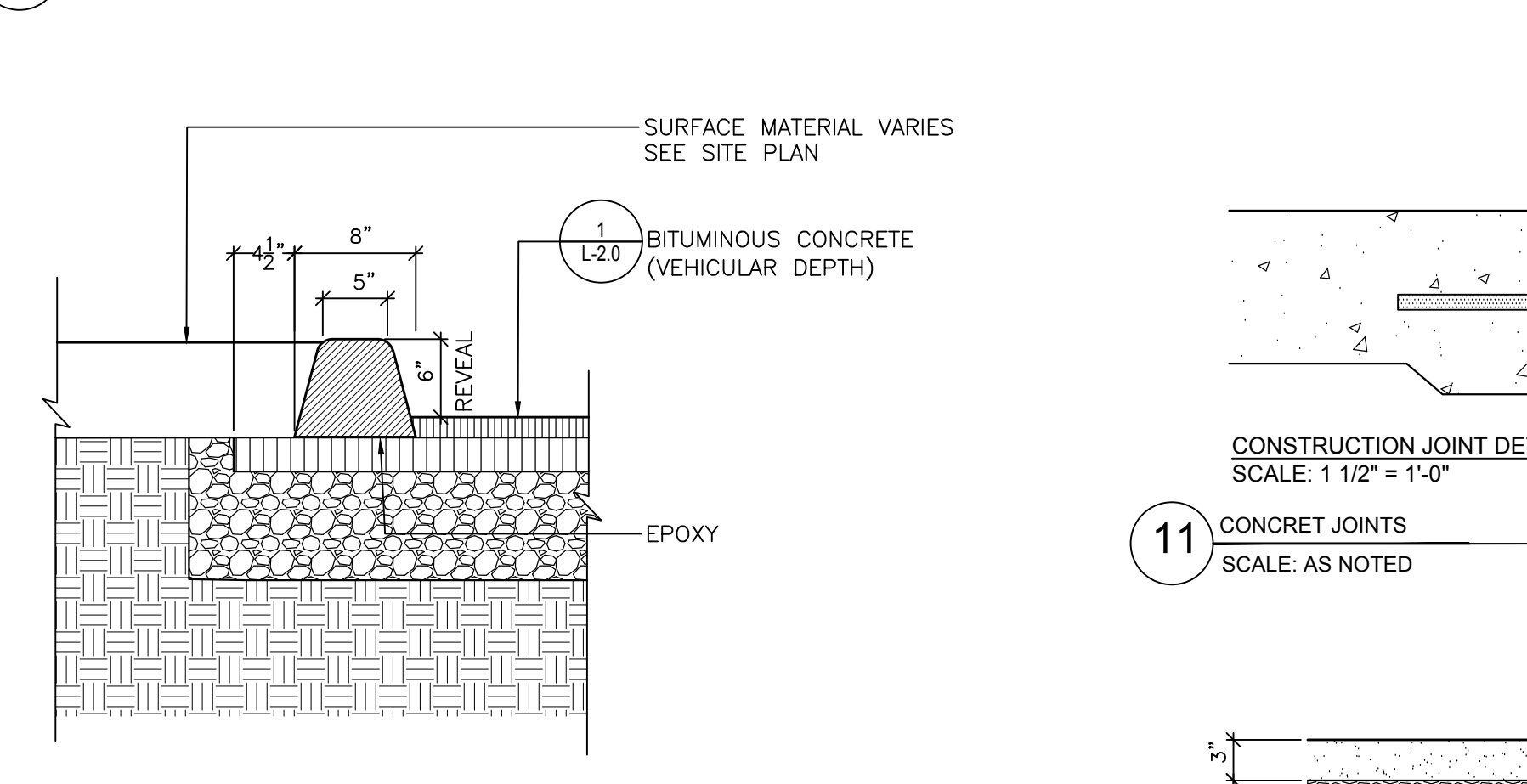

10 SLIPFORM VERTICAL CONCRETE CURB (NOT USED ADJACENT TO CONCRETE SIDEWALKS)  
SCALE: 1"=1'-0"

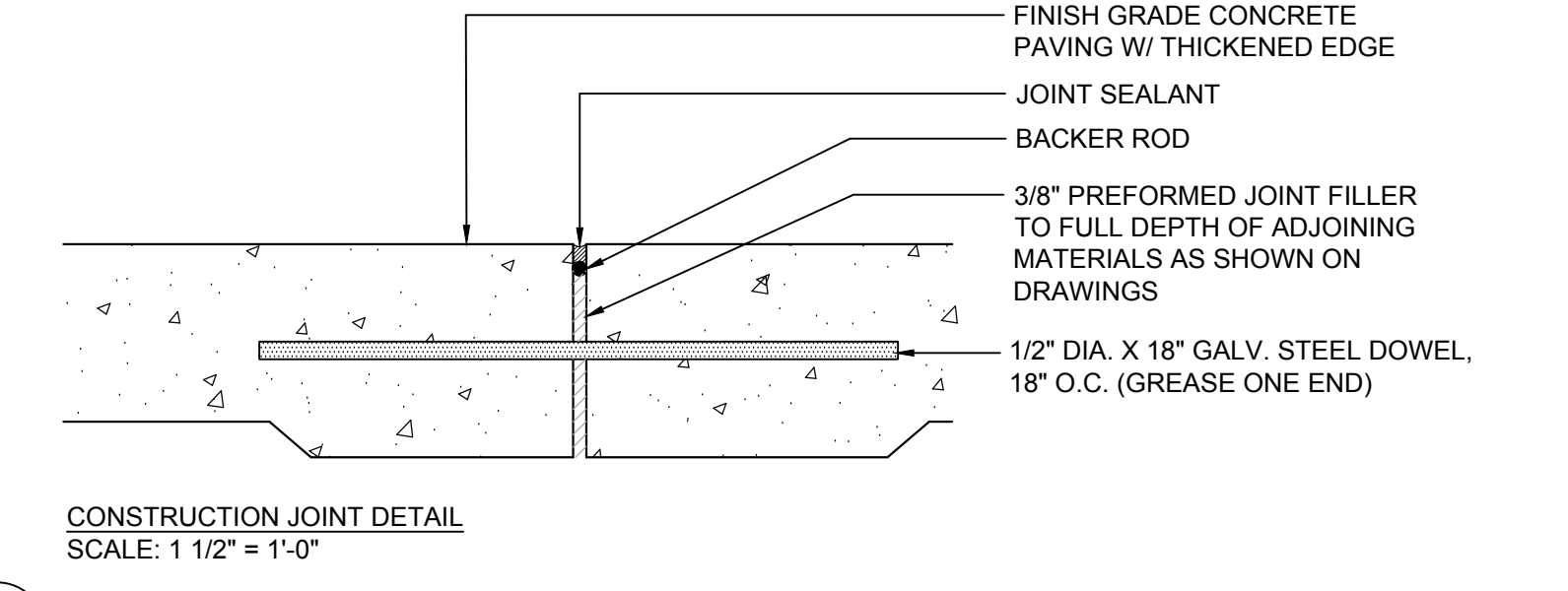

11 CONCRETE JOINTS  
SCALE: AS NOTED

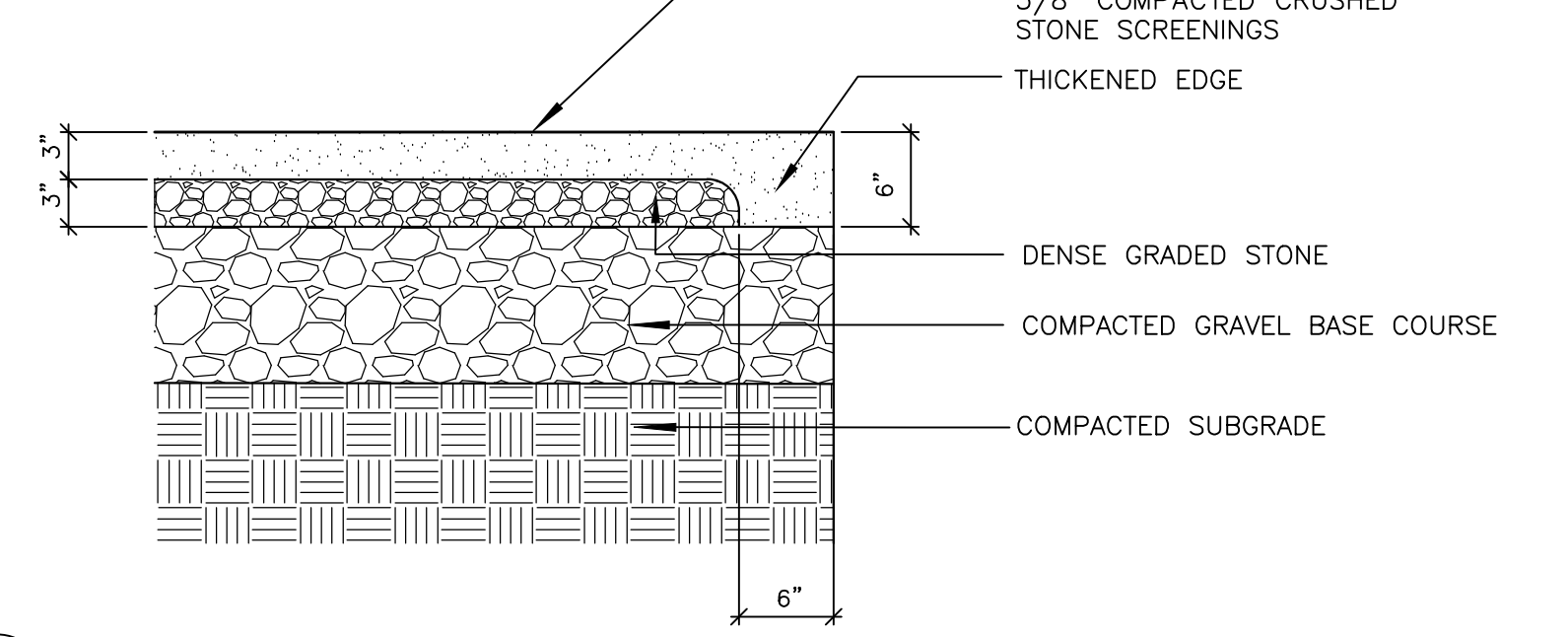

12 STONEDUST  
SCALE: AS NOTED

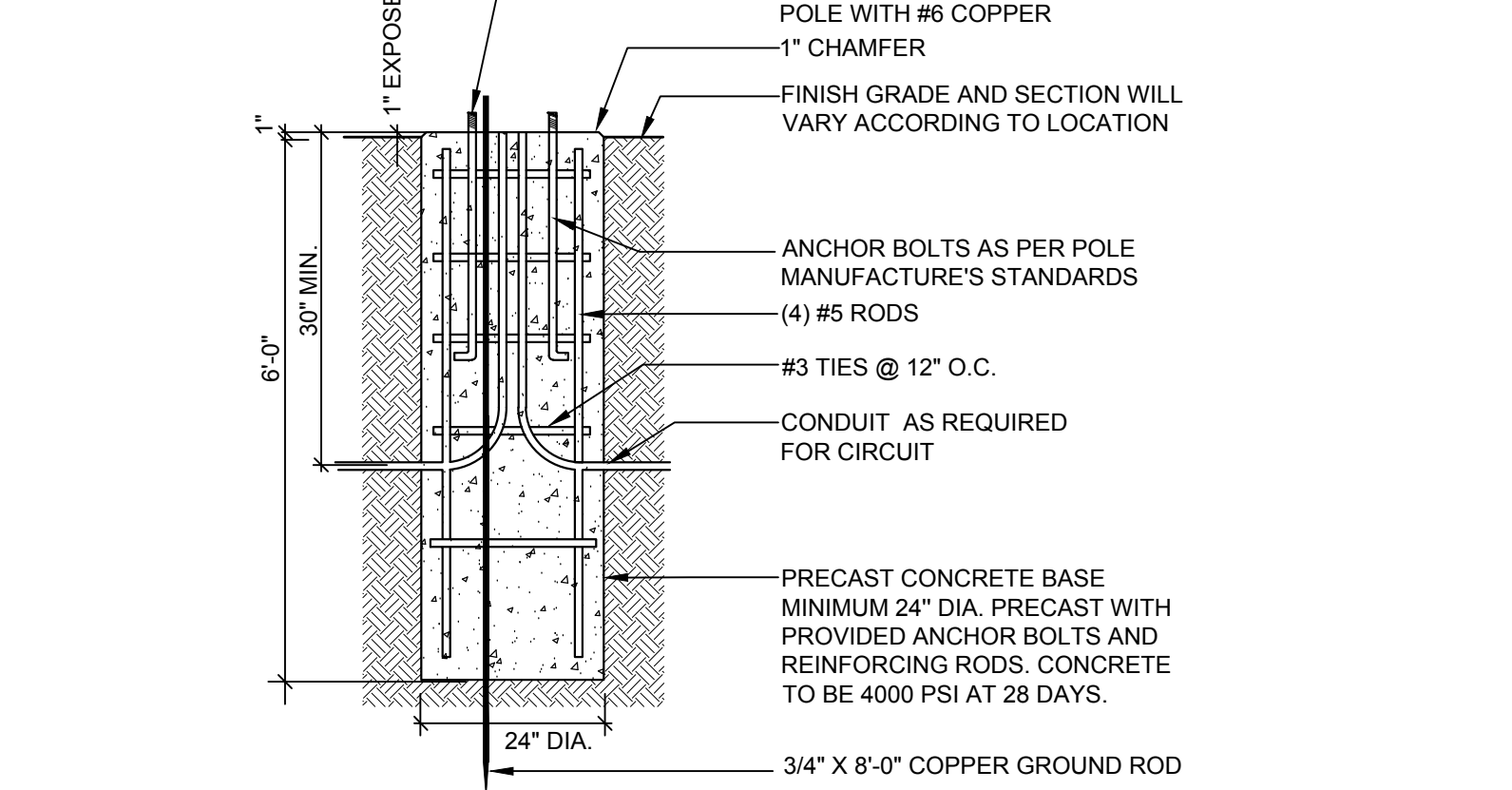

13 LIGHT POLE BASE  
SCALE: 1/2"=1'-0"

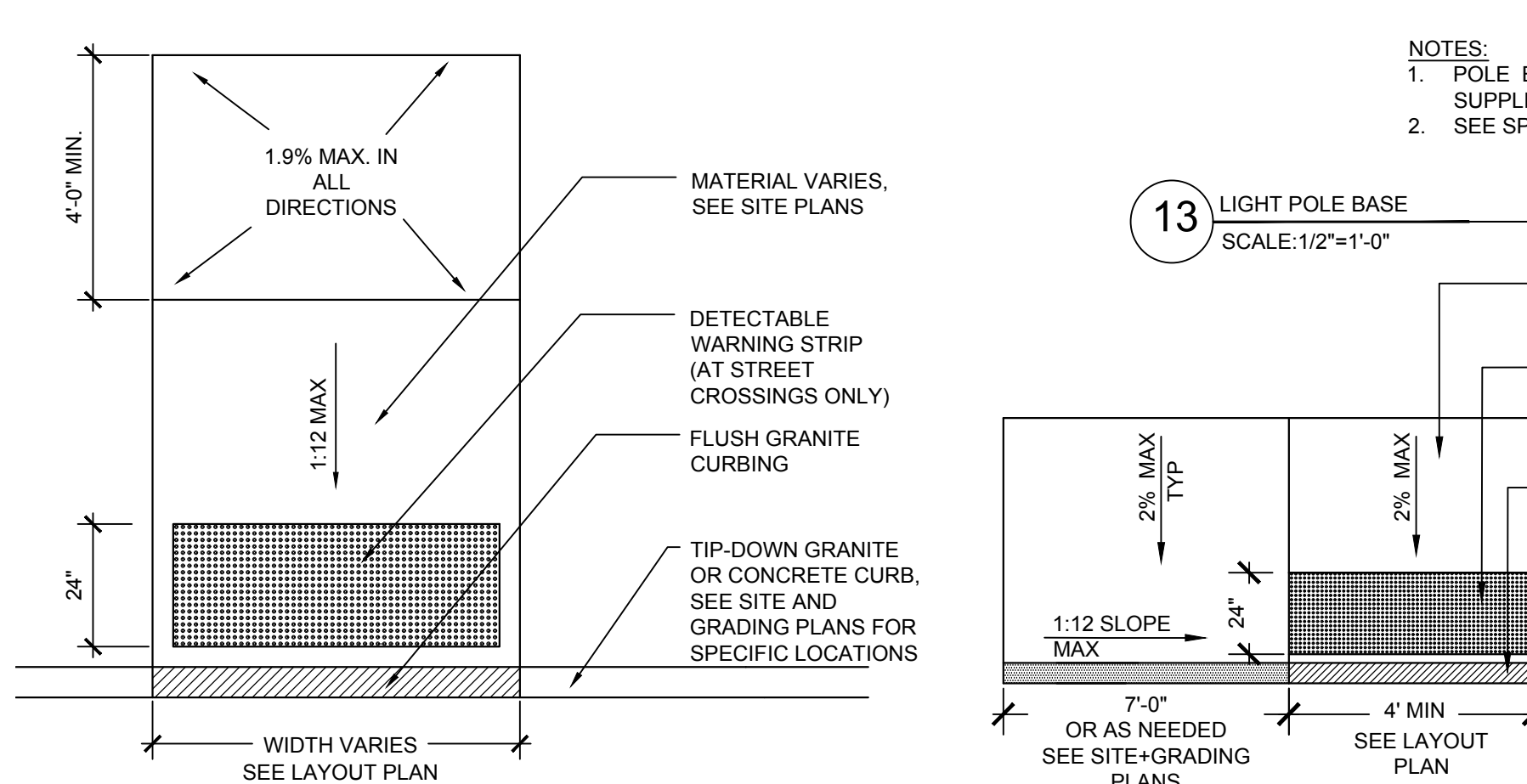

13 LIGHT POLE BASE  
SCALE: 1/2"=1'-0"

NOTE:  
1. ALL MARKINGS SHALL CONSIST OF LATEX, WATERBORNE EMULSION, LEAD AND CHROMATE FREE, READY MIXED, COMPLYING WITH FS TT-P-1952, TYPE II, WITH DRYING TIME OF LESS THAN 45 MINUTES.

APPLICANT:  
FRONT STREET REDEVELOPMENT, LP  
14 BAXTER BLVD  
PORTLAND, MAINE 04101

OWNER:  
PORTLAND HOUSING AUTHORITY  
14 BAXTER BLVD  
PORTLAND, MAINE 04101

Project: FRONT STREET DEVELOPMENT

Revisions	Date	Description
1	9.15.2017	CITY OF PORTLAND LEVEL, IN SITE PLAN SUBM.

Scale: AS SHOWN  
Approved By: PC  
Drawn By: MP

Phase: PERMITTING

CARROLL ASSOCIATES  
LANDSCAPE ARCHITECTS  
217 COMMERCIAL STREET, STE 200  
PORTLAND, MAINE 04101  
207.772.1552 V. F. 207.772.0172

Date: SEPT 28, 2017

Sheet No: L-3.0