

GENERAL NOTES:

General Plumbing Notes:
 1. Water piping located in exterior walls shall be protected from freezing by installation of a 1" rigid insulation box-out.

REVISIONS:

BENNETT ENGINEERING
 MECHANICAL/ELECTRICAL
 (207) 855-5475

STEPHEN P. DOEL
 No. 3807
 REGISTERED PROFESSIONAL ENGINEER

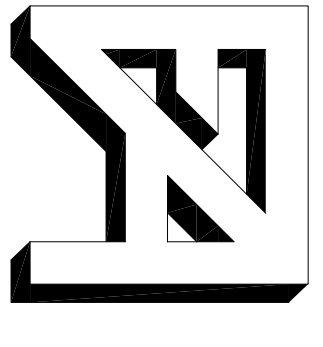

FORESIDE ARCHITECTS LLC
 5 Fundy Road
 Falmouth, Maine 04105
 Phone: 207-781-3344
 Fax: 207-699-5564
 Online @ foresidearchitects.com

Project Status:
 Bid Set
 Project Number:
 SR0712

Project Title:
 Seaside Rehab & Healthcare Center
 850 Baxter Blvd
 Portland, ME

Drawing Name:
 Plumbing First Floor Plan

Scale:
 1/8" = 1'-0"

Date:
 10/29/12

SHEET
P1.1

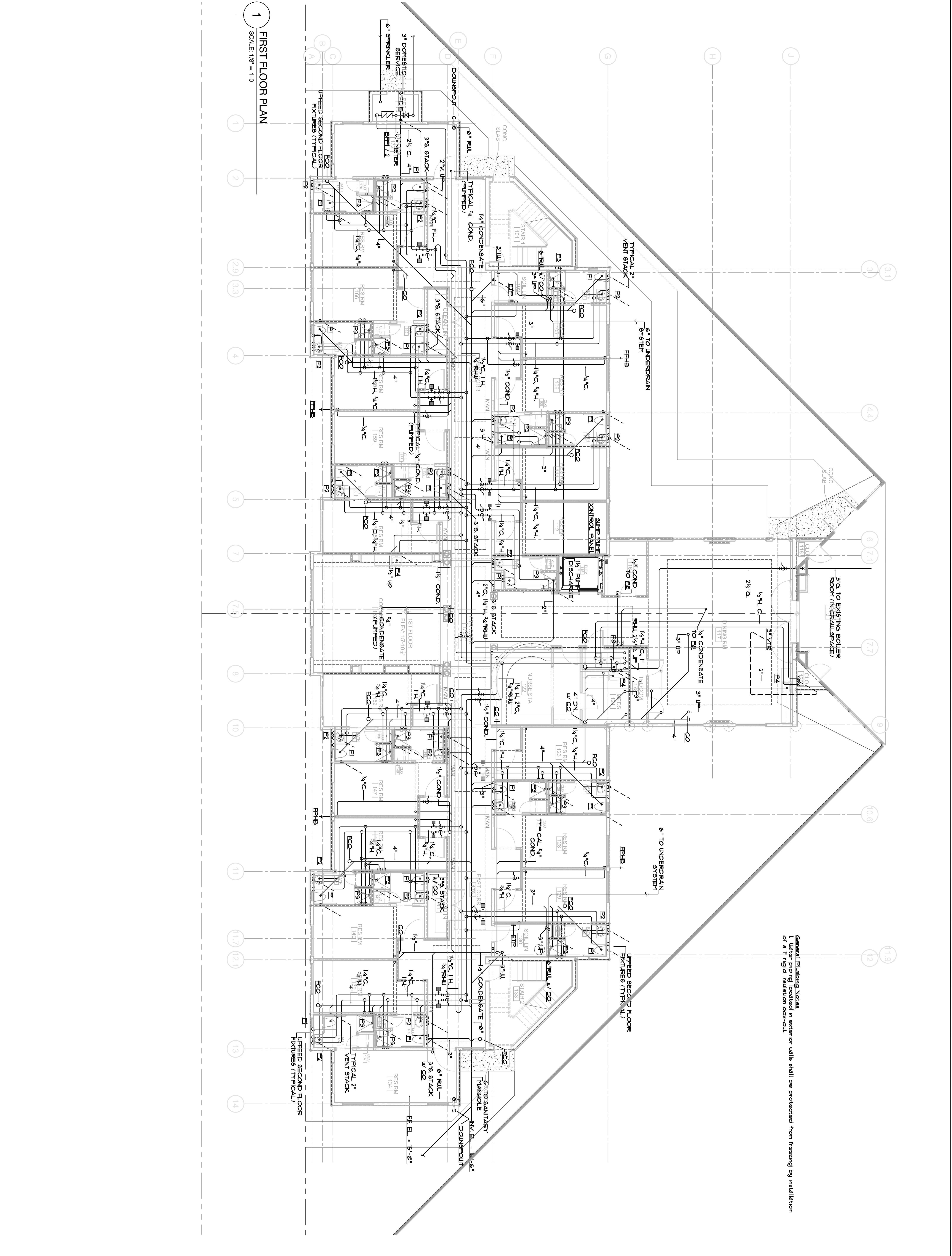

1 FIRST FLOOR PLAN
 SCALE: 1/8" = 1'-0"