

GENERAL NOTES:

1. REPORT AN DISCREPANCIES TO THE ARCHITECT. CONTRACTOR SHALL PROCEED WITH WORK ONLY AFTER DISCREPANCIES HAVE BEEN RESOLVED BY THE ARCHITECT.
2. EXISTING BUILDING COMPONENTS WHICH ARE AFFECTED BY NEW WORK AND DEMOLITION, OR WHICH MAY BE DAMAGED BY THE CONTRACTOR OR ANY SUBCONTRACTOR, SHALL BE REPLACED OR RESTORED TO THE ORIGINAL CONDITION AND COLOR AS APPROVED BY THE ARCHITECT.
3. THE BUILDING SHALL BE CONSTRUCTED TO CONFORM WITH ALL GOVERNING CODES INCLUDING 2006 IBC, NFPA 101 2006, MAINE HUMAN RIGHTS COMMISSION GUIDELINES, STATE OF MAINE PLUMBING CODE, REC 2005, AND ANSI.
4. ALL EXISTING CONDITIONS ARE TO BE FIELD VERIFIED BY THE CONTRACTOR PRIOR TO FABRICATION. THIS INCLUDES DELIVERY PROCEDURES, DIMENSIONS AND MATERIALS.
5. DRAWINGS ARE NOT TO BE SCALED. CONTRACTOR SHALL VERIFY DIMENSIONS AND CONDITIONS REQUIRING CLARIFICATION.
6. DEMOLITION REQUIRES SELECTIVE REMOVAL AND SUBSEQUENT OFF-SITE DISPOSAL OF THE FOLLOWING: REMOVAL OF ALL MATERIALS DISMANTLED NOT INTENDED FOR REUSE, AND REMOVAL AND RECONNECTION, CURPING, TERMINATION OR DISCONNECTION OF ALL WIRING, HEATING AND PLUMBING NOT USED IN THE NEW WORK.
7. THIS PROJECT SHALL NOT CONTAIN HAZARDOUS MATERIALS OF ANY OF PRODUCT, INCLUDING BUT NOT LIMITED TO ASBESTOS.
8. THE CONTRACTOR SHALL OBTAIN ALL REQUIRED PERMITS FROM THE APPROPRIATE OFFICIALS PRIOR TO THE COMMENCING THE WORK.
9. WHERE ONLY A SINGLE PRODUCT OR MANUFACTURER IS NAMED, PROVIDE THE PRODUCT IDENTIFIED. SUBSTITUTIONS SHALL BE PERMITTED ONLY WHEN APPROVED BY THE OWNER OR THE OWNER'S AUTHORIZED REPRESENTATIVE THROUGH WRITTEN DIRECTIVE.
9. AT PROJECT CLOSEOUT, SUBMIT SPECIFIC WARRANTIES, WORKMANSHIP BONDS, MAINTENANCE AGREEMENTS, FINAL CERTIFICATIONS AND SIMILAR DOCUMENTS.
10. COMPLETE FINAL CLEANUP AT PROJECT CLOSEOUT. TOUCH-UP, REPAIR AND RESTORE MARRED EXPOSED FINISHES.
11. THE LOCATION OF ALL DOORFRAMES NOT DIMENSIONED SHALL BE 4" FROM ADJACENT WALLS UNLESS OTHERWISE INDICATED.
12. ALL PARTITIONS SHALL EXTEND FROM FLOOR TO UNDERSIDE OF SUPPORTING STRUCTURE ABOVE UNLESS OTHERWISE NOTED.
13. INSTALL BLOCKING BEHIND ALL SURFACE APPLIED FIXTURES, TRIM, GRAB BARS, SHELVES, CHAIR RAILS, PICTURE RAILS AND BASE MOLDINGS.
14. IF TWO CONFLICTING COND. OR DETAILS EXIST IN THIS DRAWING SET OR ASSOCIATED SPECIFICATIONS IT SHALL BE THE ARCHITECTS CHOICE TO DECIDE WHICH CONDITION OR DETAIL APPLIES AT NO ADDITIONAL COST.

REVISIONS:



FORESIDE ARCHITECTS
 LLC

PO BOX 66736 Phone: 207-781-3344
 FALMOUTH, ME 04105

Online @ foresidearchitects.com

Project Status:
 BID SET
 NOT FOR
 CONSTRUCTION

Project Number:
 SR0712

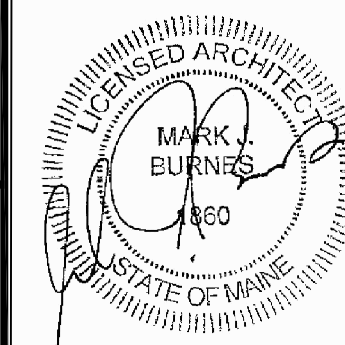

Seaside Rehabilitation
 and Health Care Center
 850 Baxter Blvd
 Portland, ME

Drawing Name:
 WALL SECTION

Scale:
 3/4" = 1'-0"

Date:
 10/29/12

SHEET
A3.8

1 WALL SECTION @ BUILDING EXTERIOR
 3/4" = 1'-0"

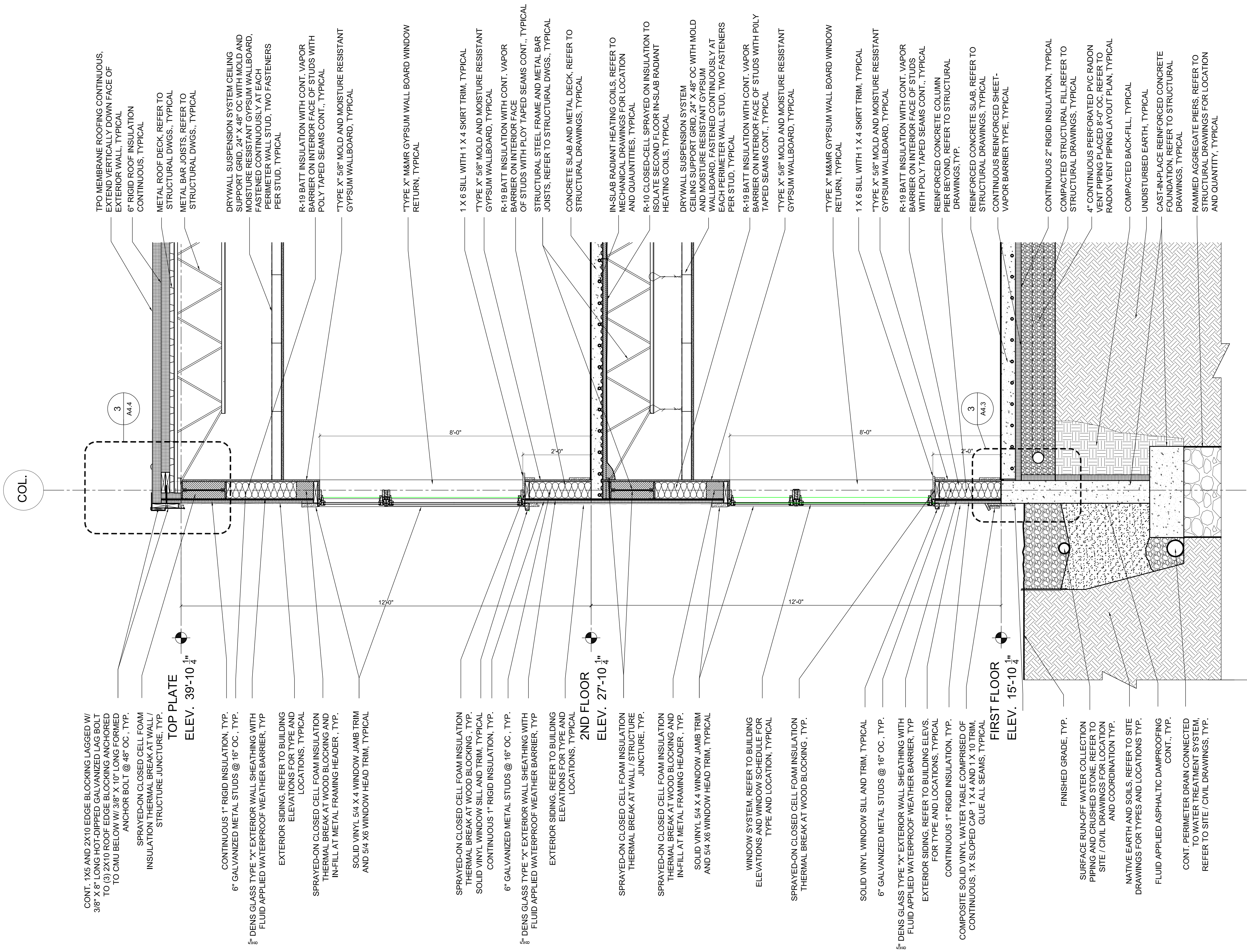

TPO MEMBRANE ROOFING CONTINUOUS,
 EXTEND VERTICALLY DOWN FACE OF
 EXTERIOR WALL, TYPICAL
 6" RIGID ROOF INSULATION
 CONTINUOUS, TYPICAL

METAL ROOF DECK, REFER TO
 STRUCTURAL DWGS., TYPICAL
 METAL BAR JOISTS, REFER TO
 STRUCTURAL DWGS., TYPICAL

DRYWALL SUSPENSION SYSTEM CEILING
 SUPPORT GRID, 24" X 48" OC WITH MOLD AND
 MOISTURE RESISTANT GYPSUM WALLBOARD,
 FASTENED CONTINUOUSLY AT EACH
 PERIMETER WALL STUD, TWO FASTENERS
 PER STUD, TYPICAL

R-19 BATT INSULATION WITH CONT. VAPOR
 BARRIER ON INTERIOR FACE OF STUDS WITH
 POLY TAPED SEAMS CONT., TYPICAL

"TYPE X" 5/8" MOLD AND MOISTURE RESISTANT
 GYPSUM WALLBOARD, TYPICAL

"TYPE X" M&MR GYPSUM WALL BOARD WINDOW
 RETURN, TYPICAL

1 X 6 SILL WITH 1 X 4 SKIRT TRIM, TYPICAL
 "TYPE X" 5/8" MOLD AND MOISTURE RESISTANT
 GYPSUM WALLBOARD, TYPICAL

R-19 BATT INSULATION WITH CONT. VAPOR
 BARRIER ON INTERIOR FACE
 OF STUDS WITH POLY TAPED SEAMS CONT., TYPICAL
 STRUCTURAL STEEL FRAME AND METAL BAR
 JOISTS, REFER TO STRUCTURAL DWGS., TYPICAL

CONCRETE SLAB AND METAL DECK, REFER TO
 STRUCTURAL DRAWINGS, TYPICAL

IN-SLAB RADIANT HEATING COILS, REFER TO
 MECHANICAL DRAWINGS FOR LOCATION
 AND QUANTITIES, TYPICAL

R-10 CLOSED-CELL SPRAYED ON INSULATION TO
 ISOLATE SECOND FLOOR IN-SLAB RADIANT
 HEATING COILS, TYPICAL

DRYWALL SUSPENSION SYSTEM
 CEILING SUPPORT GRID, 24" X 48" OC WITH MOLD
 AND MOISTURE RESISTANT GYPSUM
 WALLBOARD, FASTENED CONTINUOUSLY AT
 EACH PERIMETER WALL STUD, TWO FASTENERS
 PER STUD, TYPICAL

R-19 BATT INSULATION WITH CONT. VAPOR
 BARRIER ON INTERIOR FACE OF STUDS WITH POLY
 TAPED SEAMS CONT., TYPICAL

"TYPE X" 5/8" MOLD AND MOISTURE RESISTANT
 GYPSUM WALLBOARD, TYPICAL

"TYPE X" M&MR GYPSUM WALL BOARD WINDOW
 RETURN, TYPICAL

1 X 6 SILL WITH 1 X 4 SKIRT TRIM, TYPICAL
 "TYPE X" 5/8" MOLD AND MOISTURE RESISTANT
 GYPSUM WALLBOARD, TYPICAL

R-19 BATT INSULATION WITH CONT. VAPOR
 BARRIER ON INTERIOR FACE OF STUDS
 WITH POLY TAPED SEAMS CONT., TYPICAL
 REINFORCED CONCRETE COLUMN
 PIER BEYOND, REFER TO STRUCTURAL
 DRAWINGS, TYP.

REINFORCED CONCRETE SLAB, REFER TO
 STRUCTURAL DRAWINGS, TYPICAL
 CONTINUOUS REINFORCED SHEET-
 VAPOR BARRIER TYPE, TYPICAL

CONTINUOUS 2" RIGID INSULATION, TYPICAL
 COMPACTED STRUCTURAL FILL, REFER TO
 STRUCTURAL DRAWINGS, TYPICAL

4" CONTINUOUS PERFORATED PVC RADON
 VENT PIPING PLACED 8"-0" OC, REFER TO
 RADON VENT PIPING LAYOUT PLAN, TYPICAL

COMPACTED BACK-FILL, TYPICAL

UNDISTURBED EARTH, TYPICAL

CAST-IN-PLACE REINFORCED CONCRETE
 FOUNDATION, REFER TO STRUCTURAL
 DRAWINGS, TYPICAL

RAMMED AGGREGATE PIERS, REFER TO
 STRUCTURAL DRAWINGS FOR LOCATION
 AND QUANTITY, TYPICAL

CONT. 1X5 AND 2X10 EDGE BLOCKING LAGGED W/
 3/8" X 8" LONG HOT-DIPPED GALVANIZED LAG BOLT
 TO (3) 2X10 ROOF EDGE BLOCKING ANCHORED
 TO CMU BELOW W/ 3/8" X 10" LONG FORMED
 ANCHOR BOLT @ 48" OC, TYP.

SPRAYED-ON CLOSED CELL FOAM
 INSULATION THERMAL BREAK AT WALL/
 STRUCTURE JUNCTION, TYP.

TOP PLATE
ELEV. 39'-10 1/4"

CONTINUOUS 1" RIGID INSULATION, TYP.
 6" GALVANIZED METAL STUDS @ 16" OC, TYP.

5/8" DENS GLASS TYPE "X" EXTERIOR WALL SHEATHING WITH
 FLUID APPLIED WATERPROOF WEATHER BARRIER, TYP

EXTERIOR SIDING, REFER TO BUILDING
 ELEVATIONS FOR TYPE AND
 LOCATIONS, TYPICAL

SPRAYED-ON CLOSED CELL FOAM INSULATION
 THERMAL BREAK AT WOOD BLOCKING AND
 IN-FILL AT METAL FRAMING HEADER, TYP.

SOLID VINYL 5/4 X 4 WINDOW JAMB TRIM
 AND 5/4 X6 WINDOW HEAD TRIM, TYPICAL

SPRAYED-ON CLOSED CELL FOAM INSULATION
 THERMAL BREAK AT WOOD BLOCKING, TYP.
 SOLID VINYL WINDOW SILL AND TRIM, TYPICAL
 CONTINUOUS 1" RIGID INSULATION, TYP.

6" GALVANIZED METAL STUDS @ 16" OC, TYP.

5/8" DENS GLASS TYPE "X" EXTERIOR WALL SHEATHING WITH
 FLUID APPLIED WATERPROOF WEATHER BARRIER, TYP

EXTERIOR SIDING, REFER TO BUILDING
 ELEVATIONS FOR TYPE AND
 LOCATIONS, TYPICAL

2ND FLOOR
ELEV. 27'-10 1/4"

SPRAYED-ON CLOSED CELL FOAM INSULATION
 THERMAL BREAK AT WALL / STRUCTURE
 JUNCTION, TYP.

SPRAYED-ON CLOSED CELL FOAM INSULATION
 THERMAL BREAK AT WOOD BLOCKING AND
 IN-FILL AT METAL FRAMING HEADER, TYP.

SOLID VINYL 5/4 X 4 WINDOW JAMB TRIM
 AND 5/4 X6 WINDOW HEAD TRIM, TYPICAL

WINDOW SYSTEM, REFER TO BUILDING
 ELEVATIONS AND WINDOW SCHEDULE FOR
 TYPE AND LOCATION, TYPICAL

SPRAYED-ON CLOSED CELL FOAM INSULATION
 THERMAL BREAK AT WOOD BLOCKING, TYP.

SOLID VINYL WINDOW SILL AND TRIM, TYPICAL
 6" GALVANIZED METAL STUDS @ 16" OC, TYP.

5/8" DENS GLASS TYPE "X" EXTERIOR WALL SHEATHING WITH
 FLUID APPLIED WATERPROOF WEATHER BARRIER, TYP
 EXTERIOR SIDING, REFER TO BUILDING ELEV.
 FOR TYPE AND LOCATIONS, TYPICAL

CONTINUOUS 1" RIGID INSULATION, TYP.
 COMPOSITE SOLID VINYL WATER TABLE COMPRISED OF
 CONTINUOUS, 1X SLOPED CAP, 1 X 4 AND 1 X 10 TRIM,
 GLUE ALL SEAMS, TYPICAL

FIRST FLOOR
ELEV. 15'-10 1/4"

FINISHED GRADE, TYP.

SURFACE RUN-OFF WATER COLLECTION
 PIPING AND CRUSHED STONE, REFER TO
 SITE / CIVIL DRAWINGS FOR LOCATION
 AND COORDINATION TYP.

NATIVE EARTH AND SOILS, REFER TO SITE
 DRAWINGS FOR TYPES AND LOCATIONS TYP.

FLUID APPLIED ASPHALTIC DAMPROOFING
 CONT., TYP.

CONT. PERIMETER DRAIN CONNECTED
 TO WATER TREATMENT SYSTEM,
 REFER TO SITE / CIVIL DRAWINGS, TYP.