

GENERAL NOTES:

1. REPORT AN DISCREPANCIES TO THE ARCHITECT. CONTRACTOR SHALL PROCEED WITH WORK ONLY AFTER DISCREPANCIES HAVE BEEN RESOLVED BY THE ARCHITECT.
2. EXISTING BUILDING COMPONENTS WHICH ARE AFFECTED BY THE CONTRACTOR OR ANY SUBCONTRACTOR, SHALL BE REPLACED OR RESTORED TO THE ORIGINAL CONDITION AND COLOR AS APPROVED BY THE ARCHITECT.
3. THE BUILDING SHALL BE CONSTRUCTED TO CONFORM W/ ALL GOVERNING CODES INCLUDING 2006 IBC, NFPA 101 2006, MAINE HUMAN RIGHTS COMMISSION GUIDELINES, STATE OF MAINE PLUMBING CODE, NEC 2005, AND ANSI.
4. ALL EXISTING CONDITIONS ARE TO BE FIELD VERIFIED BY THE CONTRACTOR PRIOR TO FABRICATION. THIS INCLUDES DELIVERY PROCEDURES, DIMENSIONS AND MATERIALS.
5. DRAWINGS ARE NOT TO BE SCALED. CONTRACTOR SHALL VERIFY DIMENSIONS AND CONDITIONS REQUIRING CLARIFICATION.
6. DEMOLITION REQUIRES SELECTIVE REMOVAL AND SUBSEQUENT OFF-SITE DISPOSAL OF THE FOLLOWING: REMOVAL OF ALL MATERIALS DISMANTLED NOT INTENDED FOR REUSE, AND REMOVAL AND RECONNECTION, CAPPING, TERMINATION OR DISCONNECTION OF ALL WIRING, HEATING AND PLUMBING NOT USED IN THE NEW WORK.
7. THIS PROJECT SHALL NOT CONTAIN HAZARDOUS MATERIALS OF ANY OF PRODUCT, INCLUDING BUT NOT LIMITED TO ASBESTOS.
8. THE CONTRACTOR SHALL OBTAIN ALL REQUIRED PERMITS FROM THE APPROPRIATE OFFICIALS PRIOR TO THE COMMENCING THE WORK.
9. WHERE ONLY A SINGLE PRODUCT OR MANUFACTURER IS NAMED, PROVIDE THE PRODUCT INDICATED. SUBSTITUTIONS SHALL BE PERMITTED ONLY WHEN APPROVED BY THE OWNER OR THE OWNER'S AUTHORIZED REPRESENTATIVE THROUGH WRITTEN DIRECTIVE.
10. AT PROJECT CLOSEOUT, SUBMIT SPECIFIC WARRANTIES, WORKMANSHIP BONDS, MAINTENANCE AGREEMENTS, FINAL CERTIFICATIONS AND SIMILAR DOCUMENTS.
11. COMPLETE FINAL CLEANUP AT PROJECT CLOSEOUT. TOUCH-UP, REPAIR AND RESTORE MARRED EXPOSED FINISHES.
12. THE LOCATION OF ALL DOORFRAMES NOT DIMENSIONED SHALL BE 4" FROM ADJACENT WALLS UNLESS OTHERWISE INDICATED.
13. ALL PARTITIONS SHALL EXTEND FROM FLOOR TO UNDERSIDE OF SUPPORTING STRUCTURE ABOVE UNLESS OTHERWISE NOTED.
14. INSTALL BLOCKING BEHIND ALL SURFACE APPLIED FEATURES, TRIM, GRAB BARS, SHELVES, CHAIR RAILS, PICTURE RAILS AND BASE MOLDINGS.
15. IF TWO CONFLICTING COND. OR DETAILS EXIST IN THIS DRAWING SET OR ASSOCIATED SPECIFICATIONS IT SHALL BE THE ARCHITECTS CHOICE TO DECIDE WHICH CONDITION OR DETAIL APPLIES AT NO ADDITIONAL COST.

REVISIONS:



FORESIDE ARCHITECTS
 LLC

PO BOX 66736 Phone: 207-781-3344
 FALMOUTH, ME 04105

Online @ foresidearchitects.com

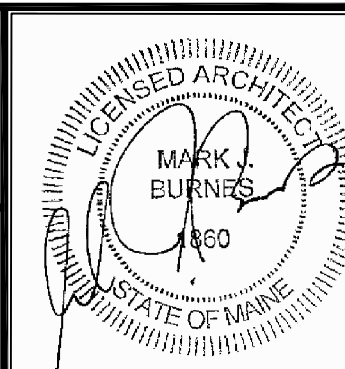
Project Status: BID SET NOT FOR CONSTRUCTION	
Project Number: SR0712	

Seaside Rehabilitation
 and Health Care Center
 850 Baxter Blvd
 Portland, ME

Drawing Name:
 WALL SECTION

Scale:
 3/4" = 1'-0"

Date:
 10/29/12

SHEET

A3.7

1 WALL SECTION @ BUILDING EXTERIOR / STAIR TOWER
 3/4" = 1'-0"

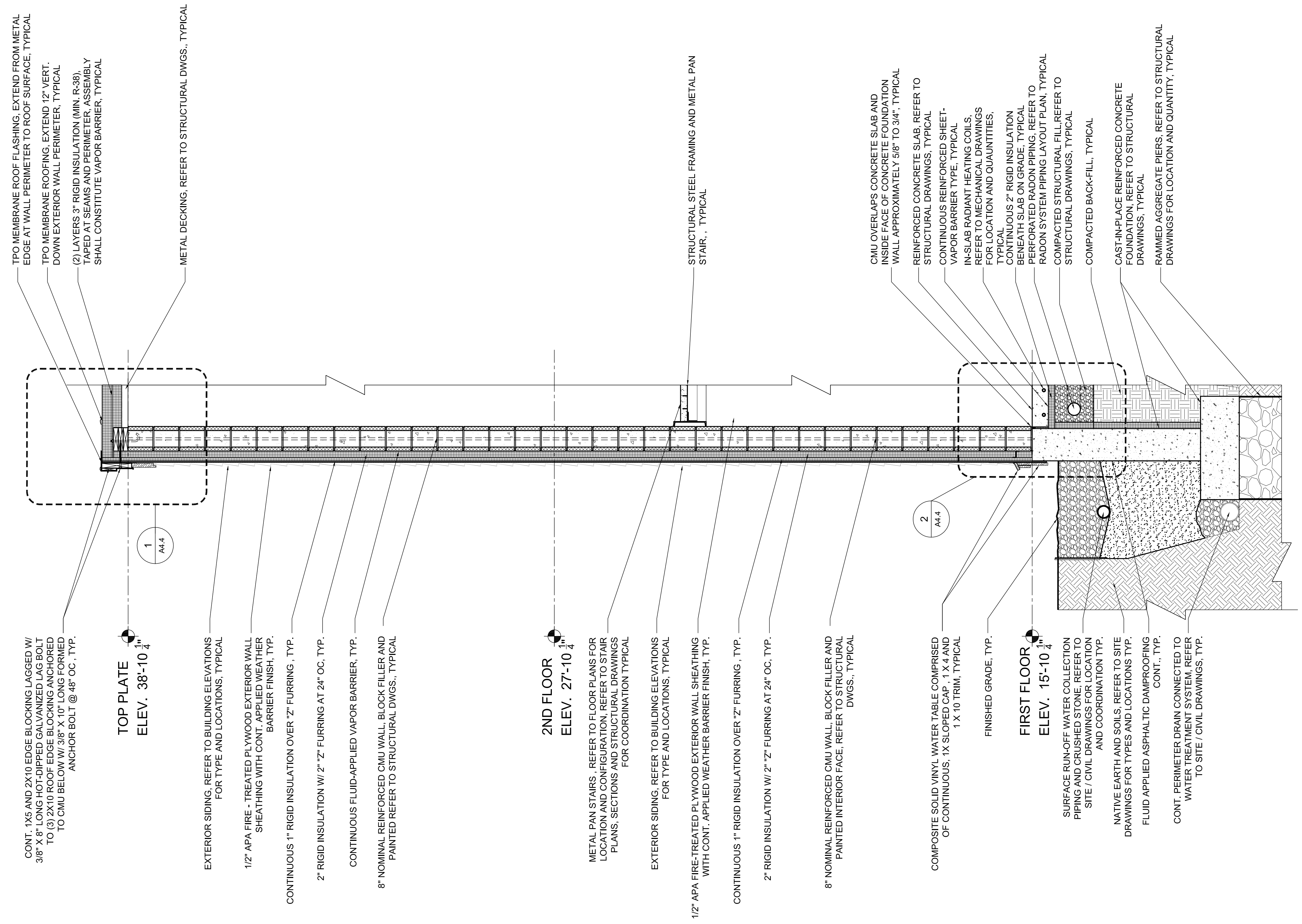

TPO MEMBRANE ROOF FLASHING, EXTEND FROM METAL EDGE AT WALL PERIMETER TO ROOF SURFACE, TYPICAL

TPO MEMBRANE ROOFING, EXTEND 12" VERT. DOWN EXTERIOR WALL PERIMETER, TYPICAL

(2) LAYERS 3" RIGID INSULATION (MIN. R-38), TAPED AT SEAMS AND PERIMETER, ASSEMBLY SHALL CONSTITUTE VAPOR BARRIER, TYPICAL

METAL DECKING, REFER TO STRUCTURAL DWGS., TYPICAL

CONT. 1X5 AND 2X10 EDGE BLOCKING LAGGED W/ 3/8" X 8" LONG HOT-DIPPED GALVANIZED LAG BOLT TO (3) 2X10 ROOF EDGE BLOCKING ANCHORED TO CMU BELOW W/ 3/8" X 10" LONG FORMED ANCHOR BOLT @ 48" OC., TYP.

EXTERIOR SIDING, REFER TO BUILDING ELEVATIONS FOR TYPE AND LOCATIONS, TYPICAL

1/2" APA FIRE-TREATED PLYWOOD EXTERIOR WALL SHEATHING WITH CONT. APPLIED WEATHER BARRIER FINISH, TYP.

CONTINUOUS 1" RIGID INSULATION OVER "Z" FURRING, TYP.

2" RIGID INSULATION W/ 2" "Z" FURRING AT 24" OC. TYP.

CONTINUOUS FLUID-APPLIED VAPOR BARRIER, TYP.

8" NOMINAL REINFORCED CMU WALL, BLOCK FILLER AND PAINTED REFER TO STRUCTURAL DWGS., TYPICAL

METAL PAN STAIRS, REFER TO FLOOR PLANS FOR LOCATION AND CONFIGURATION, REFER TO STAIR PLANS, SECTIONS AND STRUCTURAL DRAWINGS FOR COORDINATION TYPICAL

EXTERIOR SIDING, REFER TO BUILDING ELEVATIONS FOR TYPE AND LOCATIONS, TYPICAL

1/2" APA FIRE-TREATED PLYWOOD EXTERIOR WALL SHEATHING WITH CONT. APPLIED WEATHER BARRIER FINISH, TYP.

CONTINUOUS 1" RIGID INSULATION OVER "Z" FURRING, TYP.

2" RIGID INSULATION W/ 2" "Z" FURRING AT 24" OC. TYP.

8" NOMINAL REINFORCED CMU WALL, BLOCK FILLER AND PAINTED INTERIOR FACE. REFER TO STRUCTURAL DWGS., TYPICAL

CMU OVERLAPS CONCRETE SLAB AND INSIDE FACE OF CONCRETE FOUNDATION WALL APPROXIMATELY 3/8" TO 3/4", TYPICAL

REINFORCED CONCRETE SLAB, REFER TO STRUCTURAL DRAWINGS, TYPICAL

CONTINUOUS REINFORCED SHEET-VAPOR BARRIER TYPE, TYPICAL

IN-SLAB RADIANT HEATING COILS, REFER TO MECHANICAL DRAWINGS FOR LOCATION AND QUANTITIES, TYPICAL

CONTINUOUS 2" RIGID INSULATION BENEATH SLAB ON GRADE, TYPICAL

PERFORATED RADON PIPING, REFER TO RADON SYSTEM PIPING LAYOUT PLAN, TYPICAL

COMPACTED STRUCTURAL FILL, REFER TO STRUCTURAL DRAWINGS, TYPICAL

COMPACTED BACK-FILL, TYPICAL

CAST-IN-PLACE REINFORCED CONCRETE FOUNDATION, REFER TO STRUCTURAL DRAWINGS, TYPICAL

RAMMED AGGREGATE PIERS, REFER TO STRUCTURAL DRAWINGS FOR LOCATION AND QUANTITY, TYPICAL

COMPOSITE SOLID VINYL WATER TABLE COMPRISED OF CONTINUOUS, 1X SLOPED CAP, 1 X 4 AND 1 X 10 TRIM, TYPICAL

FINISHED GRADE, TYP.

SURFACE RUN-OFF WATER COLLECTION PIPING AND CRUSHED STONE, REFER TO SITE / CIVIL DRAWINGS FOR LOCATION AND COORDINATION TYP.

NATIVE EARTH AND SOILS, REFER TO SITE DRAWINGS FOR TYPES AND LOCATIONS TYP.

FLUID APPLIED ASPHALTIC DAMPROOFING CONT., TYP.

CONT. PERIMETER DRAIN CONNECTED TO WATER TREATMENT SYSTEM, REFER TO SITE / CIVIL DRAWINGS, TYP.

STRUCTURAL STEEL FRAMING AND METAL PAN STAIR, TYPICAL