

GENERAL NOTES:
1. PROVIDE NFPA 13D COMPLIANT RESIDENTIAL SPRINKLER SYSTEM TO BE DESIGNED AND INSTALLED BY SPRINKLER SUB-CONTRACTOR. COORDINATE WORK WITH OTHER TRADES.

1		1S	SHEAR WALL - REFER TO STRUCTURAL DRAWINGS
2		2S	SHEAR WALL - REFER TO STRUCTURAL DRAWINGS
F1		F2	
E1		E1S	SHEAR WALL - REFER TO STRUCTURAL DRAWINGS
E2		E3	

WALL TYPES
1 1/2" = 1'-0"

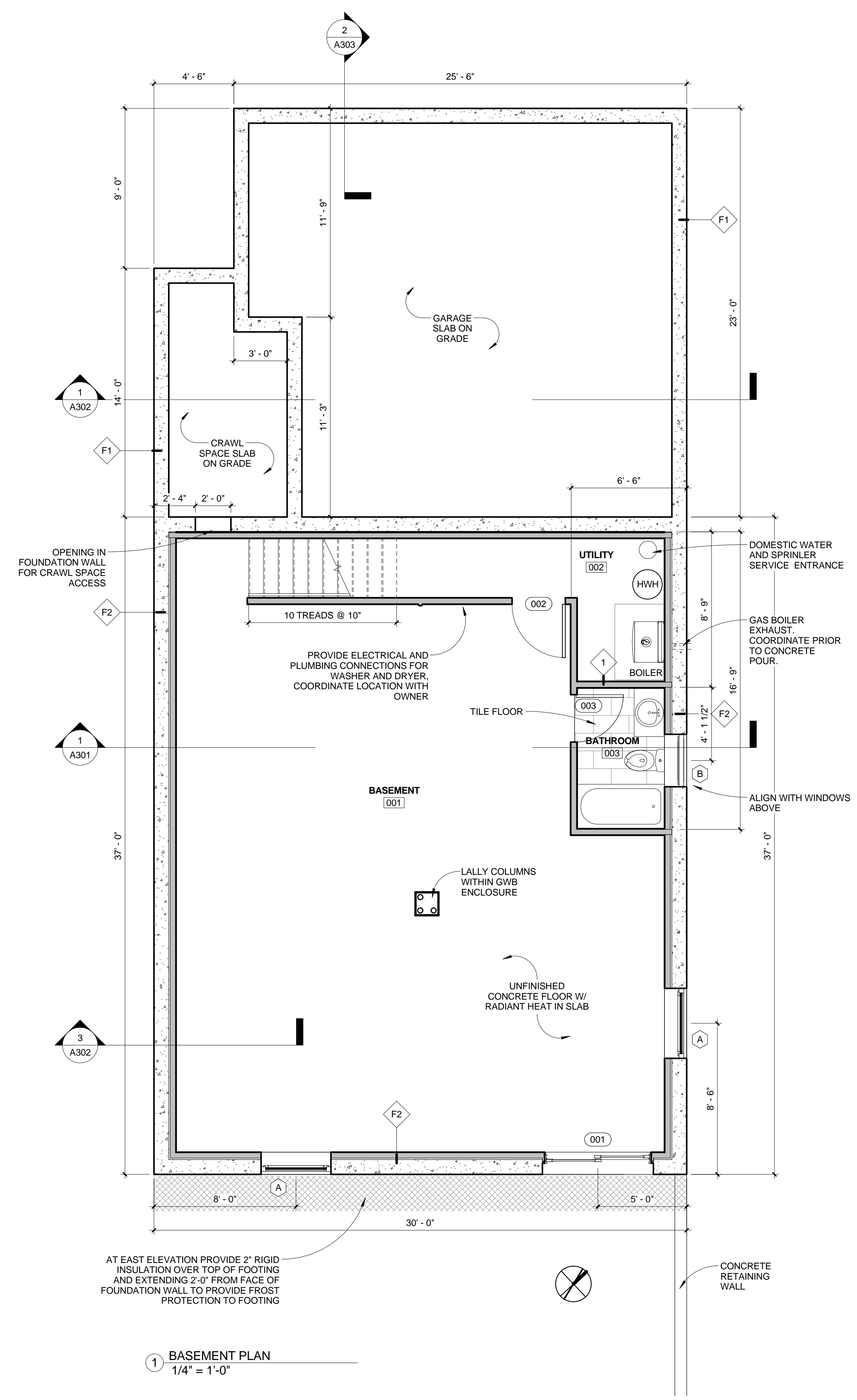

1 BASEMENT PLAN
1/4" = 1'-0"