

DISPLAY THIS CARD ON PRINCIPAL FRONTAGE OF WORK



# CITY OF PORTLAND

# BUILDING PERMIT

This is to certify that KEVIN L SHAW

Located At 24 E KIDDER ST

Job ID: 2011-12-2921-TANK

CBL: 163A- E-005-001

has permission to Install a 120 gallon LP Tank

provided that the person or persons, firm or corporation accepting this permit shall comply with all of the provisions of the Statues of Maine and of the Ordinances of the City of Portland regulating the construction, maintenance and use of the buildings and structures, and of the application on file in the department.

Notification of inspection and written permission procured before this building or part thereof is lathed or otherwise closed-in. 48 HOUR NOTICE IS REQUIRED.

A final inspection must be completed by owner before this building or part thereof is occupied. If a certificate of occupancy is required, it must be

\_\_\_\_\_  
**Fire Prevention Officer**

  
**Code Enforcement Officer / Plan Reviewer**

THIS CARD MUST BE POSTED ON THE STREET SIDE OF THE PROPERTY  
PENALTY FOR REMOVING THIS CARD

**City of Portland, Maine - Building or Use Permit Application**

389 Congress Street, 04101 Tel: (207) 874-8703, FAX: (207) 8716

Job No: 2011-12-2921-HVAC	Date Applied: 12/14/2011	CBL: 163A- E-005-001	
Location of Construction: 24 E KIDDER ST	Owner Name: KEVIN L SHAW	Owner Address: 23 LONGWOODS RD CUMBERLAND CTR, ME 04021	Phone:
Business Name:	Contractor Name: Down East Energy	Contractor Address: 72 Main St. South Portland, ME 04106	Phone: 799-5585
Lessee/Buyer's Name:	Phone:	Permit Type: HVAC -	Zone: R-5
Past Use:  Three Family Dwelling	Proposed Use:  Same: Three Family Dwelling - to install 120 gal LP tank	Cost of Work:	CEO District:
		Fire Dept:  <input checked="" type="checkbox"/> Approved w/ conditions <input type="checkbox"/> Denied <input type="checkbox"/> N/A Signature: <i>[Signature]</i> (58)	Inspection: Use Group: R-2 Type: LP TANK NFPASS Signature: <i>[Signature]</i> 1/5/12
Proposed Project Description: one 120 gallon propane tank		Pedestrian Activities District (P.A.D.)	
Permit Taken By: Gayle		<b>Zoning Approval</b>	

1. This permit application does not preclude the Applicant(s) from meeting applicable State and Federal Rules. 2. Building Permits do not include plumbing, septic or electrical work. 3. Building permits are void if work is not started within six (6) months of the date of issuance. False informatin may invalidate a building permit and stop all work.	<b>Special Zone or Reviews</b> <input type="checkbox"/> Shoreland <input type="checkbox"/> Wetlands <input type="checkbox"/> Flood Zone <input type="checkbox"/> Subdivision <input type="checkbox"/> Site Plan  <input type="checkbox"/> Maj <input type="checkbox"/> Min <input checked="" type="checkbox"/> MM Date: <i>OK</i> 12/14/11	<b>Zoning Appeal</b> <input type="checkbox"/> Variance <input type="checkbox"/> Miscellaneous <input type="checkbox"/> Conditional Use <input type="checkbox"/> Interpretation <input type="checkbox"/> Approved <input type="checkbox"/> Denied Date:	<b>Historic Preservation</b> <input checked="" type="checkbox"/> Not in Dist or Landmark <input type="checkbox"/> Does not Require Review <input type="checkbox"/> Requires Review <input type="checkbox"/> Approved <input type="checkbox"/> Approved w/Conditions <input type="checkbox"/> Denied Date: <i>[Signature]</i>
	<b>CERTIFICATION</b>		

I hereby certify that I am the owner of record of the named property, or that the proposed work is authorized by the owner of record and that I have been authorized by the owner to make this application as his authorized agent and I agree to conform to all applicable laws of this jurisdiction. In addition, if a permit for work described in the appication is issued, I certify that the code official's authorized representative shall have the authority to enter all areas covered by such permit at any reasonable hour to enforce the provision of the code(s) applicable to such permit.

SIGNATURE OF APPLICANT ADDRESS DATE PHONE

RESPONSIBLE PERSON IN CHARGE OF WORK, TITLE DATE PHONE

## BUILDING PERMIT INSPECTION PROCEDURES

Please call 874-8703 or 874-8693 (ONLY)

or email: [buildinginspections@portlandmaine.gov](mailto:buildinginspections@portlandmaine.gov)

With the issuance of this permit, the owner, builder or their designee is required to provide adequate notice to the city of Portland Inspections Services for the following inspections. Appointments must be requested 48 to 72 hours in advance of the required inspection. The inspection date will need to be confirmed by this office.

- **Please read the conditions of approval that is attached to this permit!! Contact this office if you have any questions.**
- **Permits expire in 6 months. If the project is not started or ceases for 6 months.**
- **If the inspection requirements are not followed as stated below additional fees may be incurred due to the issuance of a "Stop Work Order" and subsequent release to continue.**

### Final Inspection

The project cannot move to the next phase prior to the required inspection and approval to continue, REGARDLESS OF THE NOTICE OF CIRCUMSTANCES.

IF THE PERMIT REQUIRES A CERTIFICATE OF OCCUPANCY, IT MUST BE PAID FOR AND ISSUED TO THE OWNER OR DESIGNEE BEFORE THE SPACE MAY BE OCCUPIED.



# PORTLAND MAINE

*Strengthening a Remarkable City, Building a Community for Life* • [www.portlandmaine.gov](http://www.portlandmaine.gov)

Director of Planning and Urban Development  
Penny St. Louis

Job ID: 2011-12-2921-HVAC

Located At: 24 E KIDDER ST

CBL: 163A- E-005-001

## **Conditions of Approval:**

### **Fire**

1. Permit is to install a 120 gallon LP tank only. Installation of HVAC equipment is not indicated in the permit submittal.
2. Installation shall comply with City Code Chapter 10; NFPA 1, *Fire Code*, 2009 edition; and NFPA 58, *Liquefied Petroleum Gas Code*, 2008 edition. Compliance letters are required.

### **Building**

1. Tanks shall be installed per NFPA 58.
2. Separate permits are required for any electrical, plumbing, sprinkler, fire alarm, HVAC systems, heating appliances, including pellet/wood stoves, commercial hood exhaust systems and fuel tanks. Separate plans may need to be submitted for approval as a part of this process.



FILL IN AND SIGN WITH INK

# APPLICATION FOR PERMIT HEATING OR POWER EQUIPMENT



011-12 0901 66  
R-S

To the INSPECTOR OF BUILDINGS, PORTLAND, ME.

The undersigned hereby applies for a permit to install the following heating, cooking or power equipment in accordance with the Laws of Maine, the Building Code of the City of Portland, and the following specifications:

Location / CBL 163AE005001 Use of Building Private Date 12/14/11  
 Name and address of owner of appliance Kevin Shaw 24 E. Kidder St  
Portland ME  
 Installer's name and address Dawn East Energy 172 Main St  
South Portland Telephone 799-5585

### Location of appliance:

- Basement
- Floor
- Attic
- Roof

### Type of Fuel:

- Gas
- Oil
- Solid

### Appliance Name:

U.L. Approved  Yes  No

Will appliance be installed in accordance with the manufacture's installation instructions?  Yes  No

IF NO Explain:

### The Type of License of Installer:

- Master Plumber # \_\_\_\_\_
- Solid Fuel # \_\_\_\_\_
- Oil # \_\_\_\_\_
- Gas # \_\_\_\_\_
- Other \_\_\_\_\_

### Type of Chimney:

Masonry Lined  
Factory built \_\_\_\_\_

Metal  
Factory Built U.L. Listing # \_\_\_\_\_

Direct Vent  
Type \_\_\_\_\_ UL# \_\_\_\_\_

### Type of Fuel Tank

- Oil
- Gas

Size of Tank 20

Number of Tanks 1

Distance from Tank to Center of Flame \_\_\_\_\_ feet.

Cost of Work: \$ \_\_\_\_\_

Permit Fee: \$ 3000

## RECEIVED

DEC 14 2011

Dept. of Building Inspections  
City of Portland Maine

### Approved

Fire: \_\_\_\_\_  
 Ele.: \_\_\_\_\_  
 Bldg.: \_\_\_\_\_

### Approved with Conditions

See attached letter or requirement

Signature of Installer

Inspector's Signature

Date Approved

Assessor's Office | 399 Congress Street | Portland, Maine 04101 | Room 115 | (207) 874-8486

City Home Departments City Council E-Services Calendar Jobs

This page contains a detailed description of the Parcel ID you selected. Press the **New Search** button at the bottom of the screen to submit a new query.

**Current Owner Information:**

**Services**

Applications

Doing Business

Maps

Tax Relief

Tax Roll

Q & A

Browse city services a-z

Browse facts and links a-z



Best viewed at 800x600, with Internet Explorer

<b>CBL</b>	163A E005001
<b>Land Use Type</b>	THREE FAMILY
<b>Property Location</b>	24 E KIDDER ST
<b>Owner Information</b>	SHAW KEVIN L & LARRY R SHAW JTS 23 LONGWOODS RD CUMBERLAND ME 04021
<b>Book and Page</b>	13530/212
<b>Legal Description</b>	163A-E-S E KIDDER ST 24
<b>Acres</b>	5000 SF 0.115

**Current Assessed Valuation:**

<b>TAX ACCT NO.</b>	23082	<b>OWNER OF RECORD AS OF APRIL 2011</b>
<b>LAND VALUE</b>	\$62,800.00	SHAW KEVIN L & LARRY R SHAW JTS
<b>BUILDING VALUE</b>	\$282,800.00	23 LONGWOODS RD CUMBERLAND ME 04021
<b>NET TAXABLE - REAL ESTATE</b>	\$345,600.00	
<b>TAX AMOUNT</b>	\$6,317.58	

Any information concerning tax payments should be directed to the Treasury office at 874-8490 or e-mailed.

**Building Information:**

	<b>Building 1</b>
<b>Year Built</b>	1910
<b>Style/Structure Type</b>	OLD STYLE
<b># Stories</b>	3
<b>Bedrooms</b>	7
<b>Full Baths</b>	4
<b>Total Rooms</b>	15
<b>Attic</b>	FULL FINSH
<b>Basement</b>	FULL
<b>Square Feet</b>	4074

[View Sketch](#)      [View Map](#)      [View Picture](#)



**Sales Information:**

<b>Sale Date</b>	<b>Type</b>	<b>Price</b>	<b>Book/Page</b>
1/2/1998	LAND + BUILDING	\$0.00	13530/212

[New Search!](#)

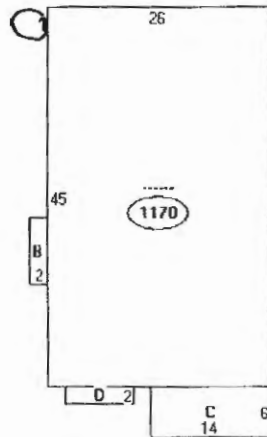

*E. Kiddie St*

*pkg  
lot*

Descriptor/Area

- A: 1170 sqft
- B: 3FBAY/B  
16 sqft
- C: OFF  
84 sqft
- D: 3FBAY/B  
16 sqft