

City of Portland, Maine – Building or Use Permit Application 389 Congress Street, 04101, Tel: (207) 874-8703, FAX: 874-8716

Location of Construction: 10 Sylvia Rd		Owner: Barbieri, Frank & Jill	Phone: 828-4703	Permit No: 980666
Owner Address: SAA 04103 *****	Lessee/Buyer's Name:	Phone:	BusinessName:	PERMIT ISSUED Permit Issued: JUN 22 1998 CITY OF PORTLAND
Contractor Name: Davis Woodworking, Inc.	Address: 971 Brighton Ave Ptld	Phone: 77402045		
Past Use: 1-fam	Proposed Use:	COST OF WORK: \$ 1,025.00	PERMIT FEE: \$ 25.00	
Proposed Project Description: Replace 6 x 12 portable shed with 8 x 10 portable shed		FIRE DEPT. <input type="checkbox"/> Approved <input type="checkbox"/> Denied	INSPECTION: Use Group: <u>4</u> Type: <u>5</u> <i>DOCAGS</i>	Zone: <u>R-3</u> CBL: 163-P-004
		Signature:	Signature: <i>[Signature]</i>	Zoning Approval: <i>[Signature]</i> 6/19/98 Special Zone or Reviews <input type="checkbox"/> Shoreland <input type="checkbox"/> Wetland <input type="checkbox"/> Flood Zone <input type="checkbox"/> Subdivision <input type="checkbox"/> Site Plan maj <input type="checkbox"/> minor <input type="checkbox"/> mm <input type="checkbox"/>
		PEDESTRIAN ACTIVITIES DISTRICT (P.A.D.)	Action: <input type="checkbox"/> Approved <input type="checkbox"/> Approved with Conditions <input type="checkbox"/> Denied	
Permit Taken By: MG		Date Applied For: 17 June 1998	Signature: _____	Date: _____

1. This permit application does not preclude the Applicant(s) from meeting applicable State and Federal rules.
2. Building permits do not include plumbing, septic or electrical work.
3. Building permits are void if work is not started within six (6) months of the date of issuance. False information may invalidate a building permit and stop all work..

CERTIFICATION

I hereby certify that I am the owner of record of the named property, or that the proposed work is authorized by the owner of record and that I have been authorized by the owner to make this application as his authorized agent and I agree to conform to all applicable laws of this jurisdiction. In addition, if a permit for work described in the application is issued, I certify that the code official's authorized representative shall have the authority to enter all areas covered by such permit at any reasonable hour to enforce the provisions of the code(s) applicable to such permit

SIGNATURE OF APPLICANT _____ ADDRESS: _____ DATE: 17 June 1998 PHONE: _____

RESPONSIBLE PERSON IN CHARGE OF WORK, TITLE _____ PHONE: _____

White-Permit Desk Green-Assessor's Canary-D.P.W. Pink-Public File Ivory Card-Inspector

Zoning Appeal

Variance
 Miscellaneous
 Conditional Use
 Interpretation
 Approved
 Denied

Historic Preservation

Not in District or Landmark
 Does Not Require Review
 Requires Review

Action:

Approved
 Approved with Conditions
 Denied

Date: *[Signature]*

CEO DISTRICT 6
m. LEAGY

COMMENTS

6-25-9F Shed will be put up in 2 months

Inspection Record

	Type	Date
Foundation:	_____	_____
Framing:	_____	_____
Plumbing:	_____	_____
Final:	_____	_____
Other:	_____	_____

THIS IS NOT A PERMIT/CONSTRUCTION CANNOT COMMENCE UNTIL THE PERMIT IS ISSUED

**Building or Use Permit Pre-Application
Additions/Alterations/Accessory Structures
To Detached Single Family Dwelling**

In the interest of processing your application in the quickest possible manner, please complete the Information below for a Building or Use Permit.

NOTEIf you or the property owner owes real estate or personal property taxes or user charges on any property within the City, payment arrangements must be made before permits of any kind are accepted.**

Location/Address of Construction: <u>10 SYLVIA ROAD</u>

Tax Assessor's Chart, Block & Lot Number Chart# <u>163</u> Block# <u>P</u> Lot# <u>004</u>	Owner: <u>FRANK + JILL BARBIERI</u>	Telephone#: <u>828-4703</u>
---	--	--------------------------------

Owner's Address: <u>10 SYLVIA ROAD 04103</u>	Lessee/Buyer's Name (If Applicable)	Cost Of Work: Fee <u>\$ 1025.00</u> <u>\$ 25</u>
---	-------------------------------------	--

Proposed Project Description:(Please be as specific as possible) <u>REPLACE 6 X 12 PORTABLE SHED WITH 8 X 10 PORTABLE SHED</u> m
--

Contractor's Name, Address & Telephone <u>DAVIS WOODWORKING, INC. - 971 BRIGHTON AVE., PORTLAND</u>	Rec'd By: <u>774-2045</u>
--	------------------------------

Separate permits are required for Internal & External Plumbing, HVAC and Electrical installation.

- All construction must be conducted in compliance with the 1996 B.O.C.A. Building Code as amended by Section 6-Art II.
- All plumbing must be conducted in compliance with the State of Maine Plumbing Code.
- All Electrical Installation must comply with the 1996 National Electrical Code as amended by Section 6-Art III.
- HVAC (Heating, Ventilation and Air Conditioning) installation must comply with the 1993 BOCA Mechanical Code.

You must Include the following with you application:

- 1) A Copy of Your Deed or Purchase and Sale Agreement
- 2) A Copy of your Construction Contract, if available
- 3) A Plot Plan (Sample Attached)

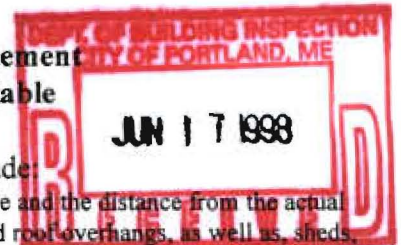

If there is expansion to the structure, a complete plot plan (Site Plan) must include:

- The shape and dimension of the lot, all existing buildings (if any), the proposed structure and the distance from the actual property lines. Structures include decks porches, a bow windows cantilever sections and roof overhangs, as well as, sheds, pools, garages and any other accessory structures.
- Scale and required zoning district setbacks

4) Building Plans (Sample Attached)

A complete set of construction drawings showing all of the following elements of construction:

- Cross Sections w/Framing details (including porches, decks w/ railings, and accessory structures)
- Floor Plans & Elevations
- Window and door schedules
- Foundation plans with required drainage and dampproofing
- Electrical and plumbing layout. Mechanical drawings for any specialized equipment such as furnaces, chimneys, gas equipment, HVAC equipment (air handling) or other types of work that may require special review must be included.

Certification

I hereby certify that I am the Owner of record of the named property, or that the proposed work is authorized by the owner of record and that I have been authorized by the owner to make this application as his/her authorized agent. I agree to conform to all applicable laws of this jurisdiction. In addition, if a permit for work described in this application is issued, I certify that the Code Official's authorized representative shall have the authority to enter all areas covered by this permit at any reasonable hour to enforce the provisions of the codes applicable to this permit.

Signature of applicant: <u>Frank Barbieri</u>	Date: <u>JUNE 15, 1998</u>
---	----------------------------

Site Review Fee: \$150.00/Building Permit Fee: \$25.00 for the 1st \$1000.cost plus \$5.00 per \$1,000.00 construction cost thereafter.

FLOOR 2x6 16" OC

WALLS 2x4 24" OC

ROOF 2x4 16" OC

SIDING 1x6 T+G PINK

ROOFING 20 FIBER GLASS 3 TABS

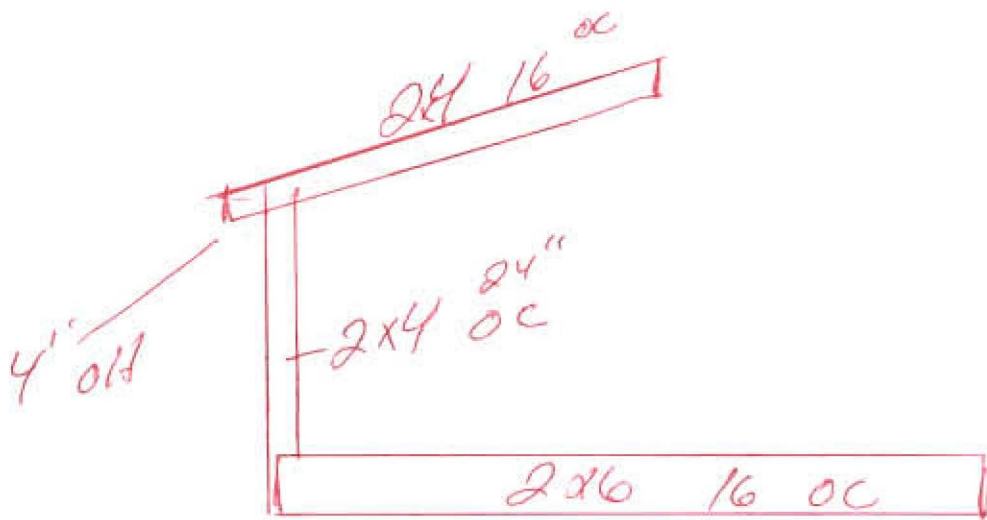

PORTABLE BUILDING
SET ON CONCRETE BLOCKS

Snow Plowing

Snow Removal

DAVIS WOODWORKING, INC.



BUILDING AND REMODELING

235 ALLEN AVENUE

PORTLAND, MAINE 04103

SHOP

971 BRIGHTON AVENUE

PORTLAND, MAINE 04102

774-2045 • 797-3368 • 839-6526

FAX 878-3808

In Maine 1-800-774-2045

PRICE LIST

Regular Sheds

4' X 8'.....	\$ 450.00	10' X 10'.....	\$1325.00
6' X 6'.....	595.00	10' X 12'.....	1650.00
6' X 8'.....	745.00	12' X 12'.....	1795.00
6' X 10'.....	850.00	12' X 14'.....	1925.00
6' X 12'.....	910.00		

8' X 8'.....	\$ 850.00
8' X 10'.....	1025.00
8' X 12'.....	1325.00
8' X 14'.....	1650.00
8' X 16'.....	1795.00

Blocks for sheds
extra \$3.00 each

Vinyl Sheds

4' X 8'.....	\$ 700.00	10' X 10'.....	\$ 1725.00
6' X 6'.....	845.00	10' X 12'.....	1825.00
6' X 8'.....	995.00	12' X 12'.....	2250.00
6' X 10'.....	1025.00	12' X 14'.....	2450.00
6' X 12'.....	1160.00		

8' X 8'.....	\$ 1150.00
8' X 10'.....	1275.00
8' X 12'.....	1475.00
8' X 14'.....	1675.00
8' X 16'.....	1875.00

P.T. lumber extra
for floors

All sheds are 2 X 4 walls and 2 X 6 floors.
All sheds are pre-fab.
All sheds delivered and set-up to 25 miles free.
Roof is shingled on site. Your choice of color.

All size shed kits available for
the "Do It Yourselfer"
Prices on request for kits.

Lawn and Patio

4' round table with 3 benches.....	\$ 115.00
5' round table with 4 benches.....	160.00
4' octagon with 4 benches.....	150.00
5' octagon with 4 benches.....	175.00
Double setee.....	75.00
Single bench 4'.....	30.00
Single chair.....	37.50
Lounge chairs.....Reg. \$75.00P.T.	105.00
Dog House S M L	Price on Request

Picnic Tables

Tot table - 48" L.....	\$ 55.00
4' table.....	70.00
6' table.....	85.00
6' table with separate benches.....	95.00
8' table.....	95.00
8' table with separate benches.....	115.00
10' table.....	117.50
12' table.....	135.00

P.T. + 1/2 cost of table.
Tables extra wide add \$25.00
Delivery \$10.00 under 10 miles for tables

Adirondack Chairs \$65.00
Adirondack Loveseat \$120.00

Prices are subject to change

may be 5'
from rear side
lot lines if less
than
100' 

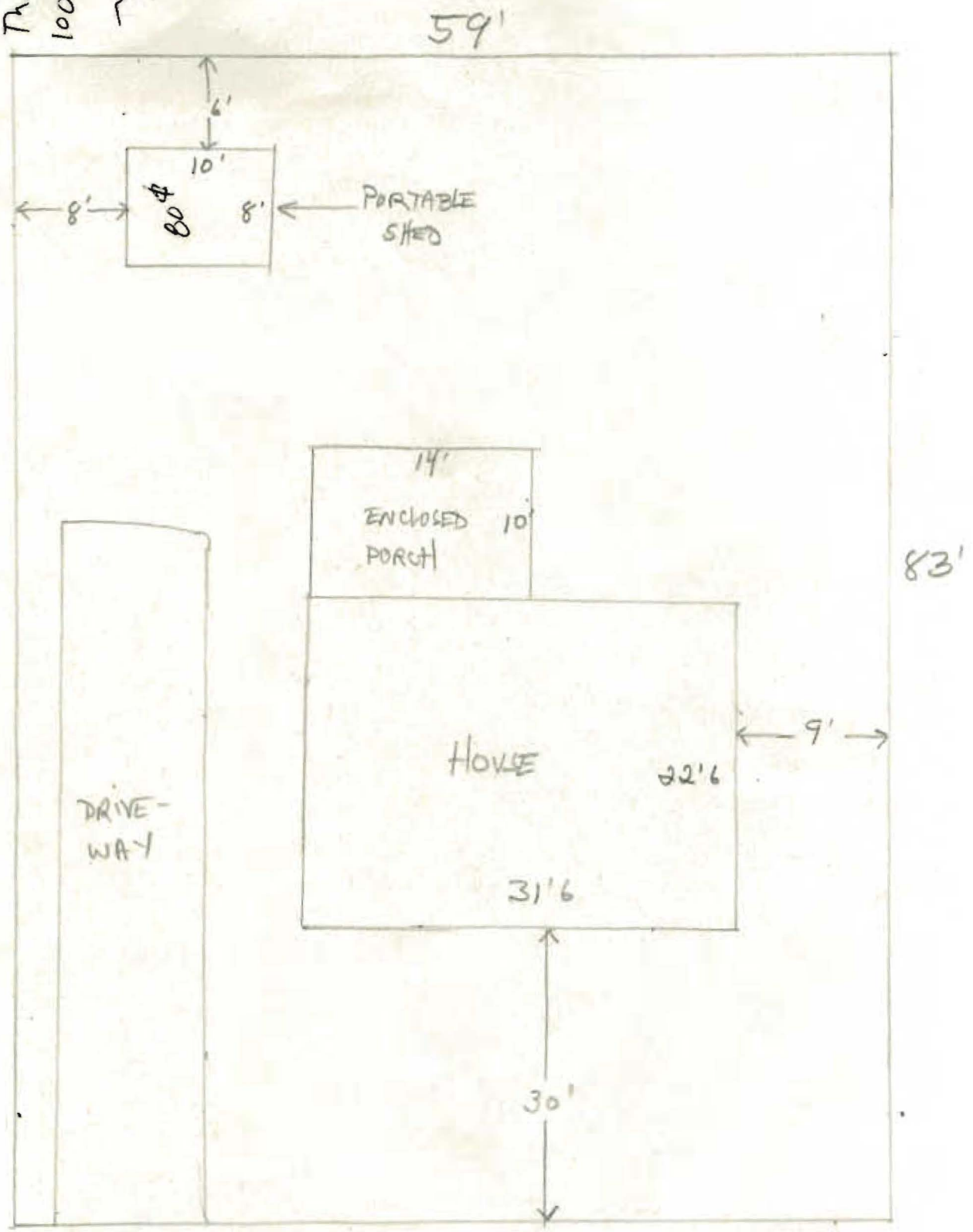

SYLVIA ROAD

LOT PLAN

FRANK & JILL BARBERI

10 SYLVIA ROAD
PORTLAND