

City of Portland, Maine - Building or Use Permit Application

389 Congress Street, 04101 Tel: (207) 874-8703, Fax: (207) 874-8716

Permit No: 08-0680	Issue Date: 6/14/08	CBL: 163 P001001
-----------------------	------------------------	---------------------

Location of Construction: 17 FERNALD TER	Owner Name: SARNO LORRAINE J	Owner Address: 17 FERNALD TER	Phone:
Business Name:	Contractor Name: property owner	Contractor Address: Portland	Phone
Lessee/Buyer's Name	Phone:	Permit Type: HVAC	Zone:

Past Use: Single Family Home	Proposed Use: Single Family Home - Install an Ashley APS 1600 wood stove w/ chimney	Permit Fee: \$40.00	Cost of Work: \$1,600.00	CEO District: 4
Proposed Project Description: Install an Ashley APS 1600 wood stove w/ chimne		FIRE DEPT: <input type="checkbox"/> Approved <input type="checkbox"/> Denied	INSPECTION: Use Group: R-3 Type: SB IRI-2003 IMC-2003	
		Signature: 6/14/08 [Signature]		
		PEDESTRIAN ACTIVITIES DISTRICT (P.A.D.)		
		Action: <input type="checkbox"/> Approved <input type="checkbox"/> Approved w/Conditions <input type="checkbox"/> Denied		
		Signature: _____ Date: _____		

Permit Taken By: ldobson	Date Applied For: 06/16/2008	Zoning Approval
-----------------------------	---------------------------------	------------------------

<ol style="list-style-type: none"> This permit application does not preclude the Applicant(s) from meeting applicable State and Federal Rules. Building permits do not include plumbing, septic or electrical work. Building permits are void if work is not started within six (6) months of the date of issuance. False information may invalidate a building permit and stop all work.. 	Special Zone or Reviews <input type="checkbox"/> Shoreland <input type="checkbox"/> Wetland <input type="checkbox"/> Flood Zone <input type="checkbox"/> Subdivision <input type="checkbox"/> Site Plan Maj <input type="checkbox"/> Minor <input type="checkbox"/> MM <input type="checkbox"/> Date: CSK 6/14/08	Zoning Appeal <input type="checkbox"/> Variance <input type="checkbox"/> Miscellaneous <input type="checkbox"/> Conditional Use <input type="checkbox"/> Interpretation <input type="checkbox"/> Approved <input type="checkbox"/> Denied Date: _____	Historic Preservation <input checked="" type="checkbox"/> Not in District or Landmark <input type="checkbox"/> Does Not Require Review <input type="checkbox"/> Requires Review <input type="checkbox"/> Approved <input type="checkbox"/> Approved w/Conditions <input type="checkbox"/> Denied Date: 6/16/08 [Signature]
	1000 0 1 MAP		

CERTIFICATION

I hereby certify that I am the owner of record of the named property, or that the proposed work is authorized by the owner of record and that I have been authorized by the owner to make this application as his authorized agent and I agree to conform to all applicable laws of this jurisdiction. In addition, if a permit for work described in the application is issued, I certify that the code official's authorized representative shall have the authority to enter all areas covered by such permit at any reasonable hour to enforce the provision of the code(s) applicable to such permit.

SIGNATURE OF APPLICANT ADDRESS DATE PHONE

RESPONSIBLE PERSON IN CHARGE OF WORK, TITLE DATE PHONE



FILL IN AND SIGN WITH INK

APPLICATION FOR PERMIT HEATING OR POWER EQUIPMENT

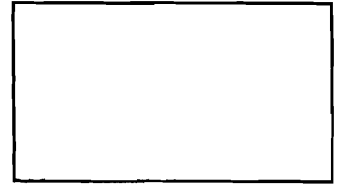

To the INSPECTOR OF BUILDINGS, PORTLAND, ME.

The undersigned hereby applies for a permit to install the following heating, cooking or power equipment in accordance with the Laws of Maine, the Building Code of the City of Portland, and the following specifications:

Location / CBL 17 Fernald Terrace Use of Building SFH Date 6.16.08

Name and address of owner of appliance _____

Installer's name and address Roger Robbins Jr
17 FERNALD TERR. PORTLAND ME. Telephone 207-773-6990

Location of appliance:

- Basement
- Attic
- Floor
- Roof

Type of Fuel:

- Gas
- Oil
- Solid

Appliance Name: Wood Stove
U.L. Approved Yes No Ashley APS 1600

Will appliance be installed in accordance with the manufacture's installation instructions? Yes No

IF NO Explain: _____

The Type of License of Installer:

- Master Plumber # _____
- Solid Fuel # NA
- Oil # _____
- Gas # _____
- Other _____

Type of Chimney:

- Masonry Lined
Factory built _____
- Metal
Factory Built U.L. Listing # _____
- Direct Vent
Type _____ UL# _____

Type of Fuel Tank

- Oil
- Gas

Size of Tank _____

Number of Tanks _____

Distance from Tank to Center of Flame _____ feet.

Cost of Work: \$ 11200

Permit Fee: \$ 40

Approved

Fire: _____
Ele.: _____
Bldg.: _____

Approved with Conditions

- See attached letter or requirement

Chris A. [Signature]
Inspector's Signature

6/14/08
Date Approved

Signature of Installer [Signature]

STATE OF MAINE CHIMNEY OR FIREPLACE CONSTRUCTION/INSTALLATION DISCLOSURE

Dear Consumer: State law, specifically 32 M.R.S.A. § 2313-A, requires that chimney or fireplace installers, as of January 1, 1992, provide you with this "Disclosure" prior to the installation or construction of your chimney or fireplace. The purpose of this Disclosure is to inform you that the National Fire Protection Standard #211 (NFPA #211) is the current standard which applies to all new construction of chimneys and fireplaces. Please note that the State of Maine does not require registration or licensure of chimney or fireplace installers. It is important to realize that many fires are caused each year from improperly constructed fireplaces and chimneys. This disclosure form should help you in making an informed decision as to the abilities of the installer and under what requirements the installation must comply.

INSTALLER INFORMATION

Name of Installer: <i>ROGER ROBBINS JR</i>		D/B/A:	
Name of Installer (if incorporated): <i>SAME</i>		D/B/A:	
Legal Address: <i>19 FERNALD TERR</i>			
City: <i>PORTLAND</i>	State: <i>ME.</i>	Zip Code: <i>04103</i>	
County: <i>COXB</i>	Home Telephone: <i>(207) 773-6990</i>		
	Work Telephone: () -		
Years of experience doing fireplace or chimney installations:			

CONSUMER INFORMATION

Name of Consumer: <i>LORRAINE SACNO</i>			
Mailing Address: <i>19 FERNALD TERR</i>			
City: <i>PORTLAND</i>	State: <i>ME</i>	Zip Code: <i>04103</i>	
County: <i>COXB</i>	Home Telephone: <i>(207) 773-6990</i>		
	Work Telephone: () -		

Installer, please give a brief description of installation being offered: _____

I hereby attest that the preceding information provided is true to the best of my knowledge. I also understand that if I fail to conform with the standards as outlined in NFPA #211 that I shall be subject to penalties as outlined in Title 32, M.R.S.A., Chapter 33 and the Oil and Solid Fuel Board Rules.

Signature of Installer: *Roger Robbins Jr.* Date: *6-16-07*

BUILDING PERMIT INSPECTION PROCEDURES

Please call 874-8703 or 874-8693 (ONLY)

to schedule your inspections as agreed upon

Permits expire in 6 months, if the project is not started or ceases for 6 months.

The Owner or their designee is required to notify the inspections office for the following inspections and provide adequate notice. Notice must be called in 48-72 hours in advance in order to schedule an inspection:

By initializing at each inspection time, you are agreeing that you understand the inspection procedure and additional fees from a "Stop Work Order" and "Stop Work Order Release" will be incurred if the procedure is not followed as stated below.

A Pre-construction Meeting will take place upon receipt of your building permit.

 X Footing/Building Location Inspection: Prior to pouring concrete or setting precast piers

 X Final inspection required at completion of work.

Certificate of Occupancy is not required for certain projects. Your inspector can advise you if your project requires a Certificate of Occupancy. All projects DO require a final inspection.

If any of the inspections do not occur, the project cannot go on to the next phase, REGARDLESS OF THE NOTICE OR CIRCUMSTANCES.

CERIFICATE OF OCCUPANICES MUST BE ISSUED AND PAID FOR, BEFORE THE SPACE MAY BE OCCUPIED.



Signature of Applicant/Designee

6-16-08
Date



Signature of Inspections Official

6-16-08
Date

City of Portland, Maine - Building or Use Permit

389 Congress Street, 04101 Tel: (207) 874-8703, Fax: (207) 874-8716

Permit No: 08-0680	Date Applied For: 06/16/2008	CBL: 163 P001001
------------------------------	--	----------------------------

Location of Construction: 17 FERNALD TER	Owner Name: SARNO LORRAINE J	Owner Address: 17 FERNALD TER	Phone:
Business Name:	Contractor Name: property owner	Contractor Address: Portland	Phone:
Lessee/Buyer's Name	Phone:	Permit Type: HVAC	

Proposed Use: Single Family Home - Install an Ashley APS 1600 wood stove w/ chimney	Proposed Project Description: Install an Ashley APS 1600 wood stove w/ chimne
--	---

Dept: Zoning	Status: Approved	Reviewer: Chris Hanson	Approval Date: 06/16/2008	Ok to Issue: <input checked="" type="checkbox"/>
Note:				
Dept: Building	Status: Approved with Conditions	Reviewer: Chris Hanson	Approval Date: 06/16/2008	Ok to Issue: <input checked="" type="checkbox"/>
Note:				
1) Prior to installing the solid fuel appliance, the product information which includes the UL listing shall be submitted. The heating unit shall be installed per the Listing, NFPA 211, IMC 2003 and the manufacturers instructions.				
2) Installation shall comply with 2003 International Mechanical Code and State of Maine Oil and Solid Fuel Board Laws and Rules				



ASHLEY

Distributed by United States Stove Company

INSTRUCTIONS & OPERATION MANUAL

ASHLEY 2010 APS-1200 **APS-1600** APS-2000

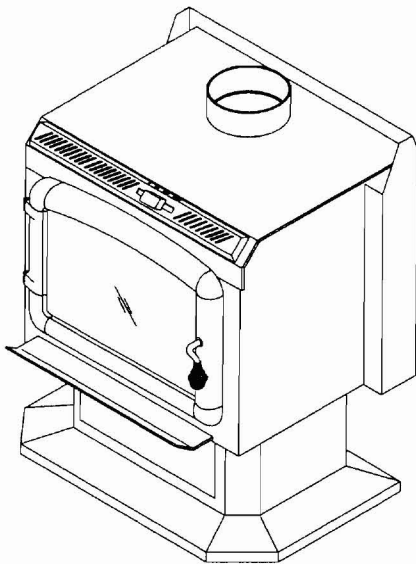

US ENVIRONMENTAL PROTECTION
AGENCY PHASE II CERTIFIED
WOODSTOVES

Verified and tested following
ULC S627 et UL 1482 Standards by:

Intertek Testing Services



READ AND KEEP THIS MANUAL FOR REFERENCE

FOR PARTS AND SERVICE CALL U.S.S.C. (423) 837-2100

TECHNICAL SPECIFICATIONS

	APS-1200	APS-1600	APS-2000	ASHLEY 2010
Fuel type:	Wood	Wood	Wood	Wood
Recommended Surface	600 to 1 200 ft ² (56 to 112 m ²)	900 to 1 600 ft ² (84 to 149 m ²)	1 000 to 2 000 ft ² (93 to 186 m ²)	600 to 1 200 ft ² (56 à 112 m ²)
Heating Capacity :	36 000 BTU/h (10,5kW)	40 000 BTU/h (11,7 kW)	60 200 BTU/h (17,6 kW)	36 000 BTU/h (10,5kW)
Auburn Method :	45 000 BTU/h (13,2 kW)	70 000 BTU/h (20,5 kW)	95 000 BTU/h (27,8 kW)	45 000 BTU/h (13,2 kW)
Efficiency :	73%	71,3%	72,2%	75%
Average Emissions:	6,5 g/h	3,3 g/h	3,8 g/h	7.4 g./h
Colour:	Metallic Black	Metallic Black	Metallic Black	Metallic black
Flue Pipe Diameter :	6" (152 mm)	6" (152 mm)	6" (152 mm)	6" (152 mm)
Chimney type :	2 100°F (650 °C)	2 100°F (650 °C)	2 100°F (650 °C)	2 100°F (650 °C)
Minimum Chimney Height :	12' (3,66 m)	12' (3,66 m)	12' (3,66 m)	12' (3,66 m)
Maximum Log Length :	16" (406 mm)	18" (457 mm)	19" (483 mm)	19" (483 mm)
Dimensions :				
Overall:	W x D x H 22 ¾ x 22 ½ x 29 ¾" (578 x 572 x 756mm)	W x D x H 25 1/8 x 26 ½ x 32 5/8" (638 x 673 x 828mm)	W x D x H 26 3/8 x 27 x 32 5/8" (671 x 686 x 828mm)	W x D x H 25 x 24 x 26" (635 x 533 x 660mm)
Combustion Chamber :				
Width x Depth :	18 x 14" (457 x 356 mm)	18 ¼ x 15 ¼" (464 x 387 mm)	22 ½ x 18" (572 x 457 mm)	20¼ x 11¼ " (514 x 286 mm)
Volume :	1,5 pi ³ (0,04 m ³)	2,5 pi ³ (0,07 m ³)	3,4 pi ³ (0,09 m ³)	1,5 pi ³ (0,04 m ³)
Door Opening :				
Width x Height :	15 ¼" x 7 ½" (387 x 191 mm)	16 ¾ x 8 ¾" (425 x 222 mm)	20 3/8 x 7 ¼" (518 x 184 mm)	7 5/8 X 18 ¼ " (200 x 464 mm)
Pyroceram Glass Door :				
Width x Height :	15 ½" x 8 ½" (394 x 216 mm)	17 x 10 ½" (432 x 267 mm)	20 ½ x 8 ¾" (521 x 222 mm)	16 ½ x 8 ¾" (425 x 222 mm)
Weight:	263 lbs (119 Kg)	380 lbs (172 Kg)	510 lbs (231 Kg)	255 lbs (116 Kg)

OPTIONS				
B36 Blower - 75 CFM (2,83 m ³ /min) with variable speed control:	Available	Available	Available	Available

CLEARANCES

It is very important that the clearances to combustible material be scrupulously respected upon installation of the stove you have selected. Those clearances appear on the stove's certification label. **For model Ashley 2010, please refer to code name "Eldorado" on the stove's label.** Refer to the tables below:

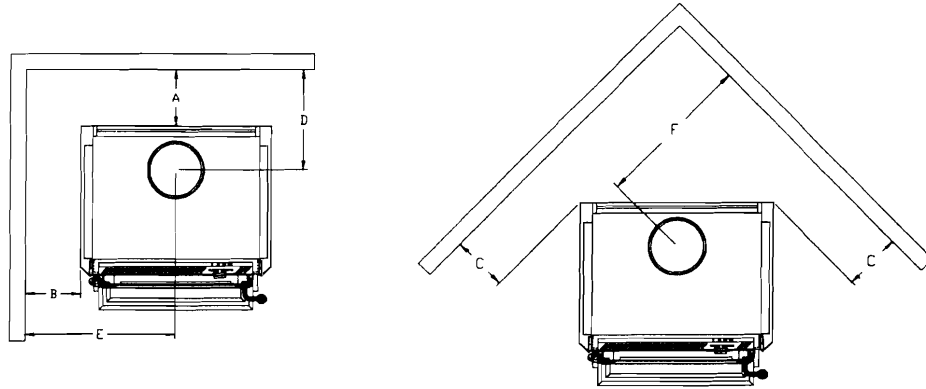
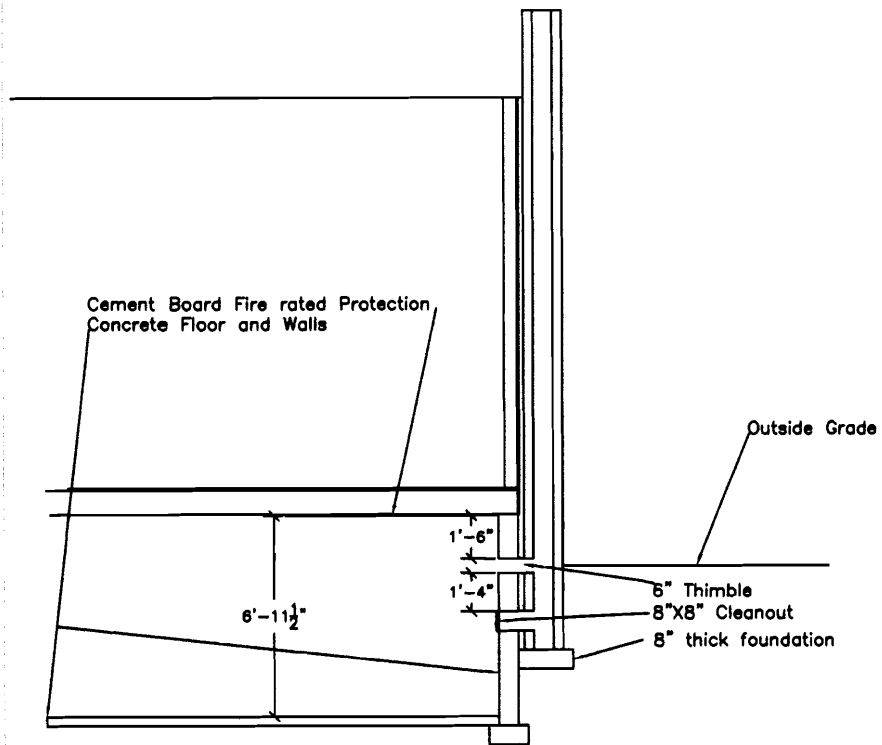

Figure 2: Clearances to combustibles

Model	Single wall stove pipe / Double wall stove pipe					
	A	B	C	D	E	F
APS-1200	17/17	16/16	10/10	22.3/22.3	27.3/27.3	21.8/21.8
APS-1600	15/12	16/16	12/10	20.8/17.8	28.7/28.7	25.2/23.2
APS-2000	19/10	19/14	11/8	25.4/16.4	33.1/28.1	25.5/22.5
Ashley 2010	15/6	18/18	12/12	21.5/12.5	30.5/30.5	24/24

All measures are expressed in inches.

- Floor to ceiling height must be at least 7' (84") in all cases.
- The clearance between the stove pipe and a wall are valid only for vertical walls and for vertical flue pipe.
- The stove pipe must not go through roof trussing, an attic, a wardrobe or similar spaces; neither a floor or combustible partition.
- A stove pipe crossing a combustible wall must have a minimum clearance of 18".
- To reduce stove pipe clearances from combustible materials, contact your local safety department.



Maintain 2" clearance from outside wall
 6" below grade clearance to be filled solid with grout
 Sheet membrane waterproofing on below grade portion of chimney
 Ceiling in basement above stove to receive cementboard protection fully taped and extending at least 3 ft past any corner of stove.
 Walls and floor need no fire protection
 Chimney liner to be 8" thimble to be 6"
 Chimney to be three feet above roof line and if needed an additional 2 ft above any roof surface within 10 ft horizontal
 Chimney attached every 16" with 16 gage HDG corrugated wall ties

Standard Notes

No.	Revision/Issue	Date

Per Name and Address

Danny Colson

Project Name and Address

Buddy's Chimney

Drawn by Danny Colson
 827-322-1000

Project Buddy's Chimney

Date June 18, 2008

Scale NONE

Sheet

1

