



AHARONIAN & ASSOCIATES INC. ARCHITECTS

310 George Washington Highway
Suite 100
Smithfield, Rhode Island
0 2 9 1 7

T 401-232-5010
F 401-232-5080
WWW.ARCH-ENG.COM

DISCLAIMER

OWNERSHIP AND USE OF DOCUMENTS, DRAWINGS AND SPECIFICATIONS ARE INSTRUMENTS OF PROFESSIONAL SERVICE AND SHALL REMAIN THE PROPERTY OF THE ARCHITECT. THESE DOCUMENTS ARE NOT TO BE USED, IN WHOLE OR IN PART, FOR ANY OTHER PROJECTS OR PURPOSES OR BY ANY OTHER PARTIES THAN THOSE PROPERLY AUTHORIZED BY CONTRACT WITHOUT THE EXPRESS WRITTEN AUTHORIZATION OF THE ARCHITECT.

KEYED EQUIPMENT REMOVAL NOTES

NOTE:
ALL EQUIPMENT SCHEDULED FOR REMOVAL ON THIS SHEET SHALL BE THE RESPONSIBILITY OF CUMBERLAND FARMS. CONTRACTOR TO DISCONNECT/MAKE SAFE ALL PLUMBING & ELECTRICAL EQUIPMENT SCHEDULED FOR REMOVAL & CUT/GAP PLUMBING AND ELECTRICAL LINES.

- 1 REMOVE COFFEE BAR EQUIPMENT
- 2 REMOVE ALL GONDOLAS, SHELVING & WALL SHELVING
- 3 REMOVE POS EQUIPMENT & SAFE
- 4 REMOVE ATM
- 5 REMOVE SANDWICH COOLER
- 6 REMOVE CHILL ZONE EQUIPMENT;
- 7 REMOVE BAG-IN-BOX RACK SYSTEM & RELATED ACCESSORIES
- 8 REMOVE STORAGE RACK
- 9 REMOVE ICE MERCHANDISER; SALVAGE FOR REFURBISHING (TYP OF 2)
- 10 REMOVE UPRIGHT MERCH COOLER; SALVAGE FOR REFURBISHING (TYP OF 2)
- 11 REMOVE UPRIGHT MERCH FREEZER; SALVAGE FOR REFURBISHING (TYP OF 3)
- 12 REMOVE PROPANE EXCHANGE STATION; COORDINATE REMOVAL & REINSTALLATION WITH VENDOR
- 13 REMOVE LOTTERY MACHINE; COORDINATE REMOVAL WITH VENDOR

LEGEND

- ===== ITEM TO REMAIN
- ITEM TO BE REMOVED
- ⬡ INDICATES KEYED DEMOLITION NOTE
- 'ETR' EXISTING TO REMAIN

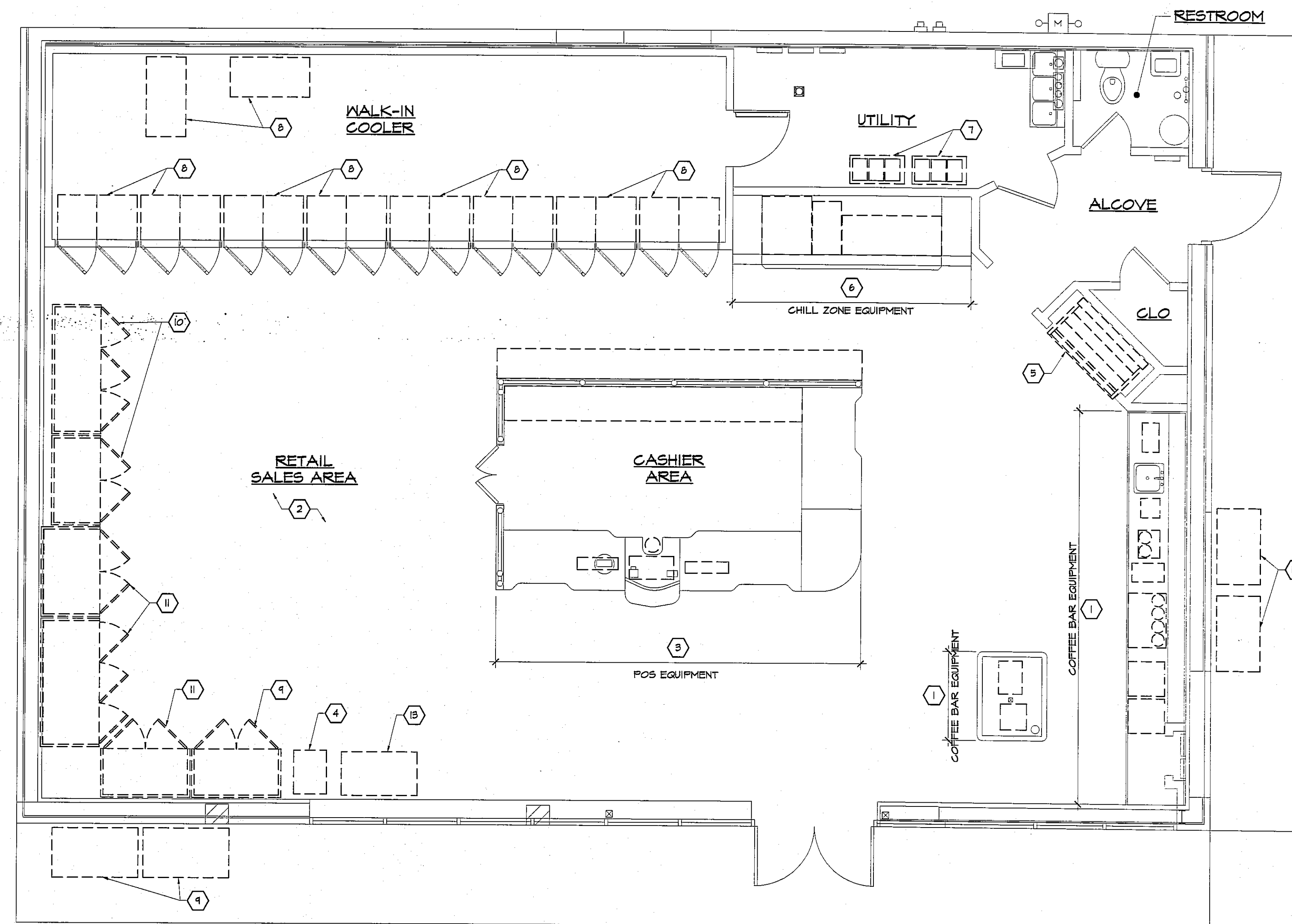

REVISIONS

NUMBER	REMARKS	DATE

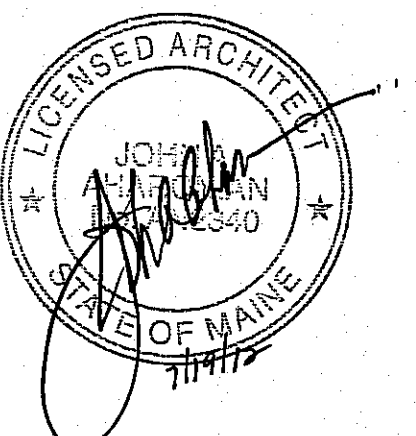

FOR CONSTRUCTION

PROJECT TITLE

Cumberland FARMS
 100 Crossing Blvd, Framingham, Massachusetts
 STORE # 5604
 V1079

801 WASHINGTON AVE
 PORTLAND, ME
 Cumberland County

DRAWING TITLE
CF EQUIPMENT REMOVAL PLAN

DATE JULY 19, 2012	PROJ NO 11112
DRAWN BY JJ	CHECKED BY AZ

DRAWING NUMBER
D1.1

1 EQUIPMENT REMOVAL PLAN
 SCALE: 1/4" = 1'-0"
