

City of Portland, Maine - Building or Use Permit Application

389 Congress Street, 04101 Tel: (207) 874-8703, Fax: (207) 874-8716

Permit No: 05-1800	Issue Date: OCT 14 2005	CBL: 163 A008001
-----------------------	----------------------------	---------------------

Location of Construction: 804 Washington Ave	Owner Name: Angie's Service Inc	Owner Address: 10 E Bridge St	Phone:
Business Name: Mullen's Driving School	Contractor Name:	Contractor Address: CITY OF PORTLAND	Phone:
Lessee/Buyer's Name	Phone: 207-892-8851	Permit Type: Signs - Permanent	Zone: R5/B

Past Use: Commercial	Proposed Use: Commercial/ add 2 signs to Building for Driving school	Permit Fee: \$126.00	Cost of Work: \$126.00	CEO District: 4
		FIRE DEPT: <input type="checkbox"/> Approved <input type="checkbox"/> Denied	INSPECTION: Use Group: B Type: SMN	

Proposed Project Description: add 2 signs to Building for Driving school	Signature:	Signature: JMB 10/12/05
PEDESTRIAN ACTIVITIES DISTRICT (P.A.D.)		
Action: <input type="checkbox"/> Approved <input type="checkbox"/> Approved w/Conditions <input type="checkbox"/> Denied		
Signature:		Date:

Permit Taken By: Idobson	Date Applied For: 09/07/2005	Zoning Approval	
-----------------------------	---------------------------------	------------------------	--

<ol style="list-style-type: none"> This permit application does not preclude the Applicant(s) from meeting applicable State and Federal Rules. Building permits do not include plumbing, septic or electrical work. Building permits are void if work is not started within six (6) months of the date of issuance. False information may invalidate a building permit and stop all work.. 	Special Zone or Reviews <input type="checkbox"/> Shoreland <input type="checkbox"/> Wetland <input type="checkbox"/> Flood Zone <input type="checkbox"/> Subdivision <input type="checkbox"/> Site Plan Maj <input type="checkbox"/> Minor <input type="checkbox"/> MM <input type="checkbox"/> Date: OK ABM 10/03/05	Zoning Appeal <input type="checkbox"/> Variance <input type="checkbox"/> Miscellaneous <input type="checkbox"/> Conditional Use <input type="checkbox"/> Interpretation <input type="checkbox"/> Approved <input type="checkbox"/> Denied Date:	Historic Preservation <input checked="" type="checkbox"/> Not in District or Landmark <input type="checkbox"/> Does Not Require Review <input type="checkbox"/> Requires Review <input type="checkbox"/> Approved <input type="checkbox"/> Approved w/Conditions <input type="checkbox"/> Denied Date: ABM
---	---	---	--

CERTIFICATION

I hereby certify that I am the owner of record of the named property, or that the proposed work is authorized by the owner of record and that I have been authorized by the owner to make this application as his authorized agent and I agree to conform to all applicable laws of this jurisdiction. In addition, if a permit for work described in the application is issued, I certify that the code official's authorized representative shall have the authority to enter all areas covered by such permit at any reasonable hour to enforce the provision of the code(s) applicable to such permit.

SIGNATURE OF APPLICANT	ADDRESS	DATE	PHONE
RESPONSIBLE PERSON IN CHARGE OF WORK, TITLE		DATE	PHONE

City of Portland, Maine - Building or Use Permit

389 Congress Street, 04101 Tel: (207) 874-8703, Fax: (207) 874-8716

Permit No: 05-1300	Date Applied For: 09/07/2005	CBL: 163 A008001
------------------------------	--	----------------------------

Location of Construction: 804 Washington Ave	Owner Name: Angie's Service Inc	Owner Address: 10 E Bridge St	Phone:
Business Name: Mullen's Driving School	Contractor Name:	Contractor Address:	Phone:
Lessee/Buyer's Name	Phone: 207-892-8851	Permit Type: Signs - Permanent	

Proposed Use: Commercial/ add 2 signs to Building for Driving school	Proposed Project Description: add 2 signs to Building for Driving school
--	--

Dept: Zoning **Status:** Approved with Conditions **Reviewer:** Ann Machado **Approval Date:** 10/03/2005

Note: 09/30/05 talked to Marvin. He will reduce the second sign and will bring in the information for the temporary sign. On hold. **Ok to Issue:**

10/03/05- Marvin said that there would be no temporary sign at this site.

1) Per our discussion of 10/03/05, the temporary sign is no longer part of the permit application.

Dept: Building **Status:** Approved with Conditions **Reviewer:** Jeanine Bourke **Approval Date:** 10/12/2005

Note: **Ok to Issue:**

1) Signage Installation to comply with Chapter 31 of the IBC 2003 building code.

Signage/Awning Permit Application

If you or the property owner owes real estate or personal property taxes or user charges on any property within the City, payment arrangements must be made before permits of any kind are accepted.

Location/Address of Construction: <u>512 WASHINGTON ST</u>		
Total Square Footage of Proposed Structure	Square Footage of Lot	
Tax Assessor's Chart, Block & Lot Chart# <u>163</u> Block# <u>A</u> Lot# <u>8</u>	Owner: <u>Private</u>	Telephone:
Lessee/Buyer's Name (If Applicable) <u>585 W. ...</u>	Applicant name, address & telephone: <u>...</u>	Total s.f. of signage x \$2.00 per s.f. plus \$30.00/\$65.00 for H.D. signage = Total Fee: \$ _____ Awning Fee = Cost Of Work: \$ _____ Total Fee: \$ _____
Current use: _____		
If the location is currently vacant, what was prior use: _____		
Approximately how long has it been vacant: _____		
Proposed use: <u>CLASS ROOM</u>		
Project description: <u>22' x 21' SIGN</u> <u>TEMPORARY SIGN</u>		
Contractor's name, address & telephone:		
Whom should we contact when the permit is ready: <u>MARVIN CAMPBELL</u>		
Mailing address: <u>585 ROSEVEAR TRAIL</u> <u>WILLIAMSBURG, ME 04092</u> <u>PH: 892-8851</u>		
We will contact you by phone when the permit is ready. You must come in and pick up the permit and review the requirements before starting any work, with a Plan Reviewer. A STOP WORK ORDER will be issued and a \$100.00 fee if any work starts before the permit is picked up. PHONE: <u>892-8851</u>		

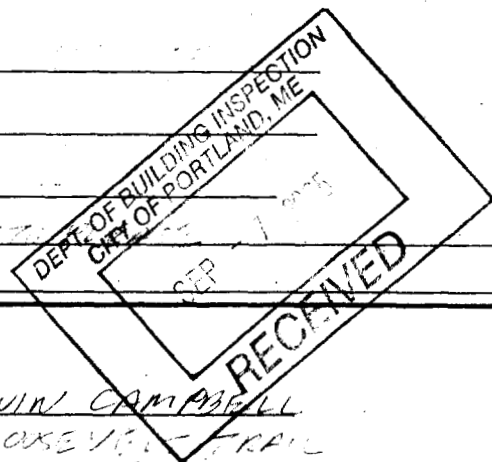

IF THE REQUIRED INFORMATION IS NOT INCLUDED IN THE SUBMISSIONS THE PERMIT WILL BE AUTOMATICALLY DENIED AT THE DISCRETION OF THE BUILDING/PLANNING DEPARTMENT. WE MAY REQUIRE ADDITIONAL INFORMATION IN ORDER TO APPROVE THIS PERMIT.

I hereby certify that I am the Owner of record of the named property, or that the owner of record authorizes the proposed work and that I have been authorized by the owner to make this application as his/her authorized agent. I agree to conform to all applicable laws of this jurisdiction. In addition, if a permit for work described in this application is issued, I certify that the Code Official's authorized representative shall have the authority to enter all areas covered by this permit at any reasonable hour to enforce the provisions of the codes applicable to this permit.

Signature of applicant: <u>MARVIN CAMPBELL</u>	Date: <u>08/31/05</u>
--	-----------------------

This is NOT a permit, you may not commence ANY work until the permit is issued.

SIGNAGE/AWNING PRE-APPLICATION QUESTIONNAIRE

PLEASE COMPLETE ALL INFORMATION

ADDRESS: 404 WASHINGTON AVE ZONE: _____

CBL: _____

SINGLE TENANT LOT? YES _____ NO MULTI TENANT LOT? YES NO _____

MORE THAN ONE SIGN TOTAL WITH PROPOSED SIGN? YES _____ NO _____

TENANT/ALLOCATED BUILDING SPACE FRONTAGE (FEET):

Length: 21' Height: 10'

INFORMATION ON PROPOSED SIGN(S):

FREESTANDING (e.g., pole) SIGN? YES _____ NO DIMENSIONS PROPOSED: _____

BLDG. WALL SIGN? (attached to bldg) YES NO _____ DIMENSIONS PROPOSED: 8' x 2'

INFORMATION ON ALREADY EXISTING AND PERMITTED SIGN(S):

FREESTANDING (e.g., pole) SIGN? YES _____ NO DIMENSIONS: SIGN # 2 7'6" x 2'
THAT SIGN WILL BE ATTACHED WITH 8 1/4" LAGS

BLDG. WALL SIGN(attached to bldg)? YES NO _____ DIMENSIONS: LIGHT PIPE SIGNS
40" ACROSS TOP EACH SIGN.

AWNING? YES _____ NO DIMENSIONS: _____

LOT FRONTAGE (FEET): 183'

AWNING YES _____ NO IS AWNING BACKLIT? YES _____ NO _____

HEIGHT OF AWNING: _____ LENGTH OF AWNING: _____ DEPTH: _____

IS THERE ANY COMMUNICATION, MESSAGE, TRADEMARK OR SYMBOL ON IT? YES _____ NO _____

IF YES, TOTAL S.F. OF PANELS WITH COMMUNICATIONS/MESSAGE/TRADEMARK/SYMBOL? _____ s.f.

A SITE SKETCH AND BUILDING SKETCH SHOWING EXACTLY WHERE EXISTING AND NEW SIGNAGE IS LOCATED MUST BE PROVIDED. SKETCHES AND/OR PICTURES OF PROPOSED SIGNAGE ARE ALSO REQUIRED.

SIGNATURE OF APPLICANT: Marvin Campbell DATE: 1/25

MARVIN CAMPBELL

***** FOR OFFICE USE ONLY *****

59' 31.5

Corner lot - second sign is not allowed
(1/2 max. allowed)

Table 2.13, continued

b. Individual Business Signs

Alternative 1

	B-1, B-2, AB, B-4, IB Zones	
	Tenant's Frontage < 150 linear ft.	Tenant's frontage ≥ 150 linear ft.
- Maximum Area	150 sq. ft.	na
- Sq. ft. per linear ft. of bldg. front	1.5 sq. ft.	na
- Maximum % of wall area on which sign(s) is(are) to be placed	na	5%
- # permitted per business (a)	1	1

(a) If individual tenant fronts on more than one street, one additional building sign is permitted for each additional frontage, but at 1/2 the maximum allowable area of the first.

length 21' - allowed 31.5
max allowed area
2nd sign 15.75' allowed 1.5
16 requested for second sign

Alternative 2

Note: Alternative 2 is available as an option to proprietors of multi-tenant lots needing greater flexibility in allocating signs to tenants. This option requires the submission of a signage plan as described in Section 14-368 (d) as evidence that all building signs on the subject lot comply with the provisions of this ordinance, including the size and number limits of this table. All nonconforming building signs must be brought into compliance to be eligible for the Alternative 2 option.

- Maximum Permitted Sign Area	na	
- Maximum % of wall area on which signs are to be placed	Principal Facade(s) 5%	All Other Facade(s) 2%
- # building signs permitted per lot	1 per tenant plus 1 additional per building face	

5%

CHECKLIST FOR SIGN/AWNING APPLICATION

Applicants for a sign or awning permit are required to submit the following information to the Code Enforcement Office at the time of application:

- _____ Certificate of Liability listing the City as additional insured if any portion of the sign abuts or encroaches on any public right of way, or can fall into any public right of way. Amount must equal \$400,000.00.
- _____ Letter of permission from the owner indicating the permissions granted and the tenant/space building frontage.
- _____ A sketch plan of lot, indicating location of buildings, driveways, and any abutting streets or rights of way, lengths of building frontages, street frontages, and all existing setbacks. **Indicate on the plan all existing and proposed signs with their dimensions and specific locations. Be sure to include distance from the ground and building facade dimensions for any signage attached to building.**
- _____ A sketch or photo of any proposed sign(s) indicating *content, dimensions, materials, source of illumination, and construction method, as well as specifics of installation/attachment.*
- /// _____ Certificate of Flammability required for awning or canopy at time of application.
- VA _____ UL# required for lighted signs at the time of Final Inspection. Failure to provide this information will invalidate the Sign Permit.
- _____ Pre-Application Questionnaire completed and attached. Photos of existing signage attached.

**Permit Fee for signage or awning-with-signage:
\$30.00 plus \$2.00 per square foot of sign.**

**Permit Fee for awning-without-signage is based on cost of work:
\$30.00 for the first \$1,000.00, plus \$9.00 for each additional \$1,000.00.**

Base Application Fee for any Historic District signage is \$65.00 instead of \$30.00

ACORD CERTIFICATE OF LIABILITY INSURANCE		DATE (MM/DD/YYYY) 09/01/2005
PRODUCER (207)774-6257 FAX (207)774-2994 Clark Associates 2385 Congress Street P O Box 3543 Portland, ME 04104	THIS CERTIFICATE IS ISSUED AS A MATTER OF INFORMATION ONLY AND CONFERS NO RIGHTS UPON THE CERTIFICATE HOLDER. THIS CERTIFICATE DOES NOT AMEND, EXTEND OR ALTER THE COVERAGE AFFORDED BY THE POLICIES BELOW.	
INSURED Mullen's Driving School Inc 405 Roosevelt Trail Windham, ME 04062	INSURERS AFFORDING COVERAGE	
	INSURER A: Philadelphia Ins co	NAIC #
	INSURER B: Maine Employers Mutual	
	INSURER C:	
	INSURER D:	
		INSURER E:

COVERAGES
 THE POLICIES OF INSURANCE LISTED BELOW HAVE BEEN ISSUED TO THE INSURED NAMED ABOVE FOR THE POLICY PERIOD INDICATED. NOTWITHSTANDING ANY REQUIREMENT, TERM OR CONDITION OF ANY CONTRACT OR OTHER DOCUMENT WITH RESPECT TO WHICH THIS CERTIFICATE MAY BE ISSUED OR MAY PERTAIN, THE INSURANCE AFFORDED BY THE POLICIES DESCRIBED HEREIN IS SUBJECT TO ALL THE TERMS, EXCLUSIONS AND CONDITIONS OF SUCH POLICIES. AGGREGATE LIMITS SHOWN MAY HAVE BEEN REDUCED BY PAID CLAIMS.

INSR ADD'L LTR INSRD	TYPE OF INSURANCE	POLICY NUMBER	POLICY EFFECTIVE DATE (MM/DD/YY)	POLICY EXPIRATION DATE (MM/DD/YY)	LIMITS
A	GENERAL LIABILITY <input checked="" type="checkbox"/> COMMERCIAL GENERAL LIABILITY CLAIMS MADE <input type="checkbox"/> OCCUR	PHPK046537	04/10/2005	04/10/2006	EACH OCCURRENCE \$ 1,000,000
					DAMAGE TO RENTED PREMISES (EA OCCURRENCE) \$ 100,000
					MED EXP (Any one person) \$ 5,000
					PERSONAL & ADV INJURY \$ 1,000,000
					GENERAL AGGREGATE \$ 2,000,000
					PRODUCTS - COM/OP AGG \$ 2,000,000
A	AUTOMOBILE LIABILITY <input checked="" type="checkbox"/> ANY AUTO <input type="checkbox"/> ALL OWNED AUTOS <input type="checkbox"/> SCHEDULED AUTOS <input type="checkbox"/> HIRED AUTOS <input type="checkbox"/> NON-OWNED AUTOS	PHPK046537	04/10/2005	04/10/2006	COMBINED SINGLE LIMIT (EA ACCIDENT) \$ 1,000,000
					BODILY INJURY (Per person) \$
					BODILY INJURY (Per accident) \$
					PROPERTY DAMAGE (Per accident) \$
	GARAGE LIABILITY <input type="checkbox"/> ANY AUTO				AUTO ONLY - EA ACCIDENT \$
					OTHER THAN EA ACC AGG \$
	EXCESS/UMBRELLA LIABILITY <input type="checkbox"/> OCCUR <input type="checkbox"/> CLAIMS MADE DEDUCTIBLE \$ RETENTION \$				EACH OCCURRENCE \$
					AGGREGATE \$
					\$
					\$
B	WORKERS COMPENSATION AND EMPLOYERS' LIABILITY ANY PROPRIETOR/PARTNER/EXECUTIVE OFFICER/MEMBER EXCLUDED? If yes, describe under SPECIAL PROVISIONS below	1810041666	04/10/2005	04/10/2006	<input checked="" type="checkbox"/> WC STATUTORY LIMITS <input type="checkbox"/> OTH-ER
					E.L. EACH ACCIDENT \$ 100,000
					E.L. DISEASE - EA EMPLOYEE \$ 100,000
					E.L. DISEASE - POLICY LIMIT \$ 500,000
	OTHER				

DESCRIPTION OF OPERATIONS / LOCATIONS / VEHICLES / EXCLUSIONS ADDED BY ENDORSEMENT / SPECIAL PROVISIONS
 City of Portland, ME. is an additional insured for liability for a sign at 804 Washington Avenue, Portland, ME.

CERTIFICATE HOLDER City of Portland, ME Congress Street, Room 315 Portland, ME 04101	CANCELLATION SHOULD ANY OF THE ABOVE DESCRIBED POLICIES BE CANCELLED BEFORE THE EXPIRATION DATE THEREOF, THE ISSUING INSURER WILL ENDEAVOR TO MAIL <u>10</u> DAYS WRITTEN NOTICE TO THE CERTIFICATE HOLDER NAMED TO THE LEFT, BUT FAILURE TO MAIL SUCH NOTICE SHALL IMPOSE NO OBLIGATION OR LIABILITY OF ANY KIND UPON THE INSURER, ITS AGENTS OR REPRESENTATIVES. AUTHORIZED REPRESENTATIVE Christine Clark Williams/RSC <i>Christine Clark Williams</i>
--	---

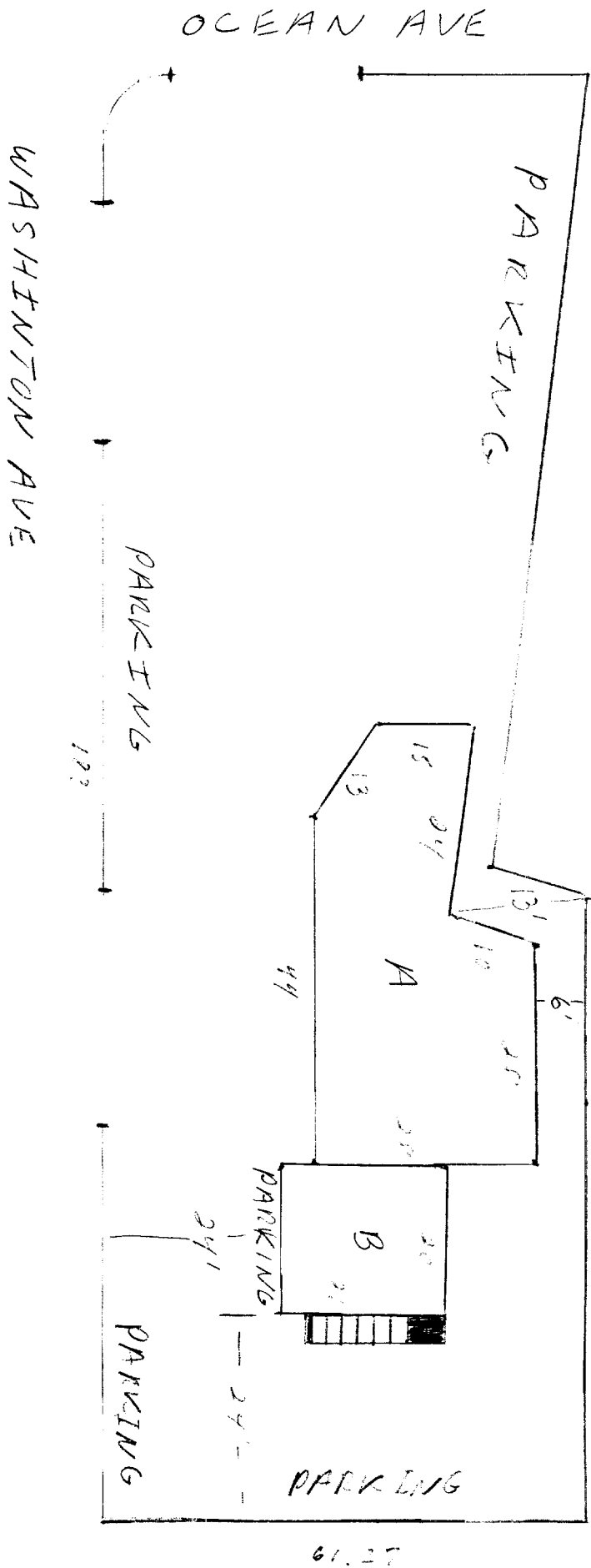

- A. 1ST 120' SQ. FT. RETAIL
- B. 1ST 420 SQ. FT. SERVICE
- C. 2ND 420 SQ. FT. CLASSROOM.

417700 W. 100th St. 1000
501 100th St. 1000
100th St. 1000

43 PORTLAND AVE

44 SMOKERS ST

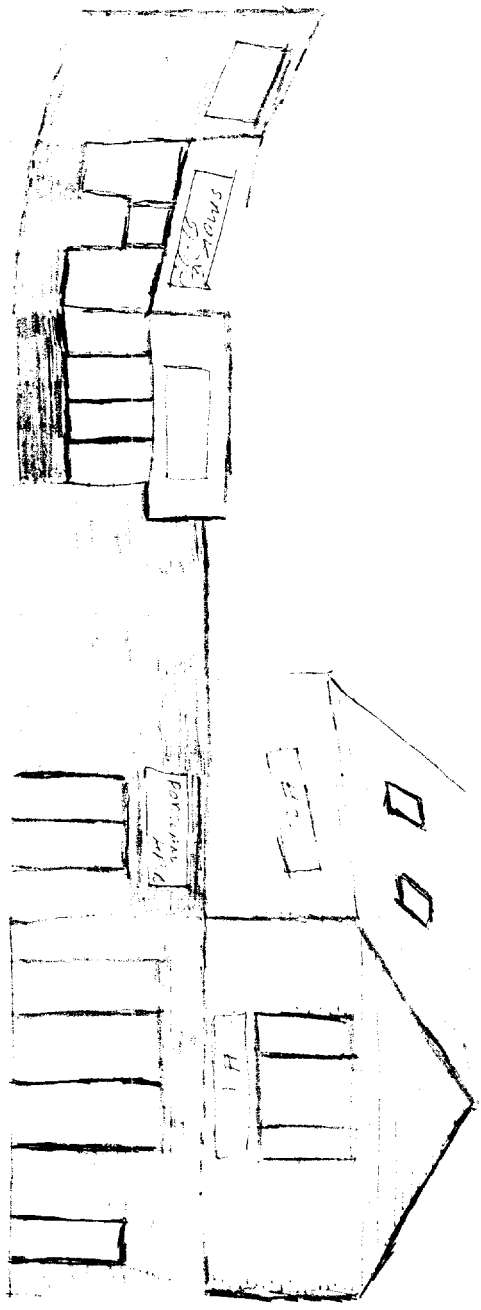

WASHINGTON AVE

Angie's Services Inc.
10 E Bridge Street
Westbrook ME 04092

City Of Portland
Congress Street
Portland ME 04102

Mullen's Driving School Is Authorized to Display 2 signs, 2 Feet High by 8 Feet Long, at
804 Washington Avenue On their leased portion of the structure.

Angie Services

Evan O'Connell 1/25/99