

PRINTED: Feb 27, 2015

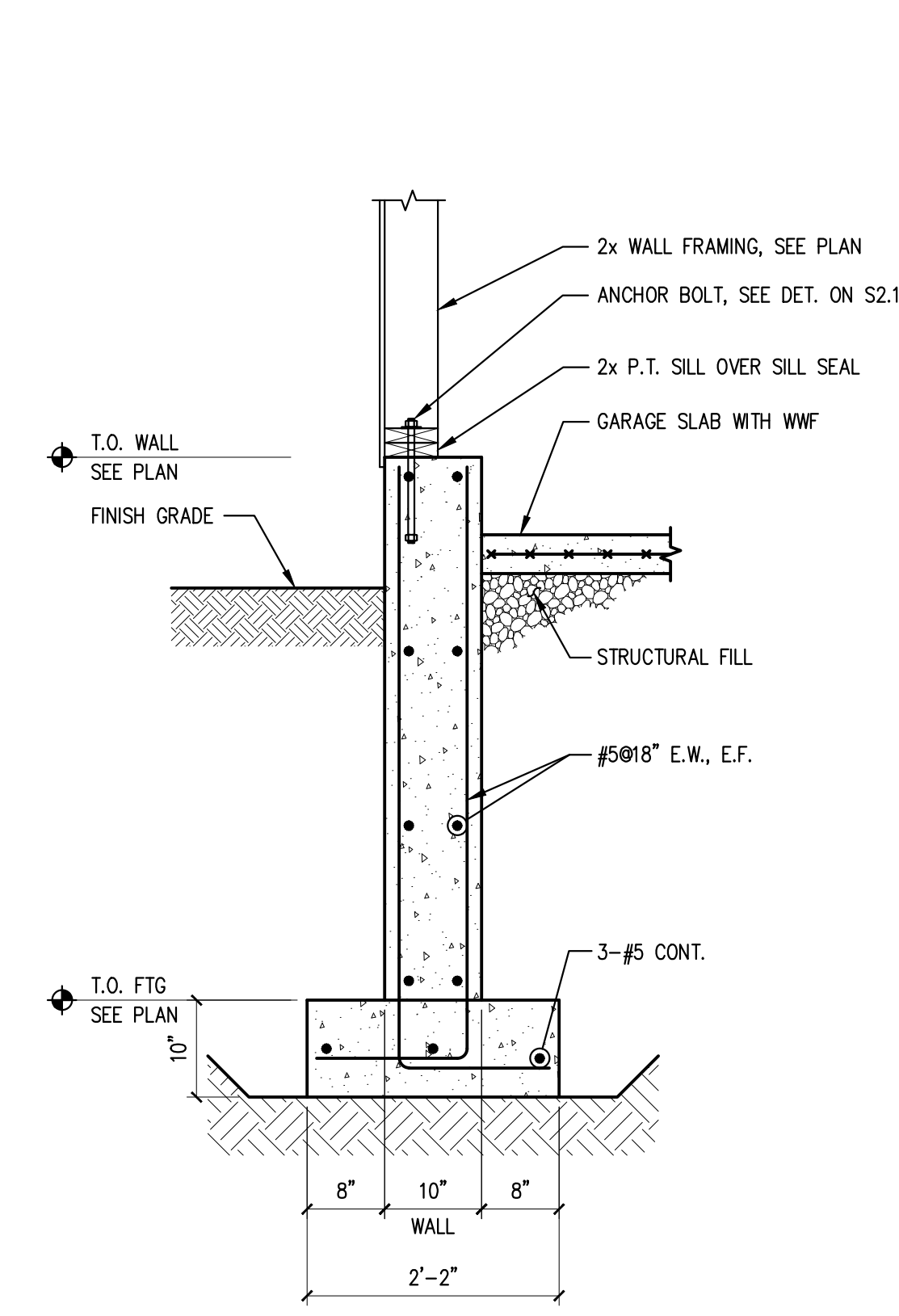

1 SECTION 3/4" = 1'-0"

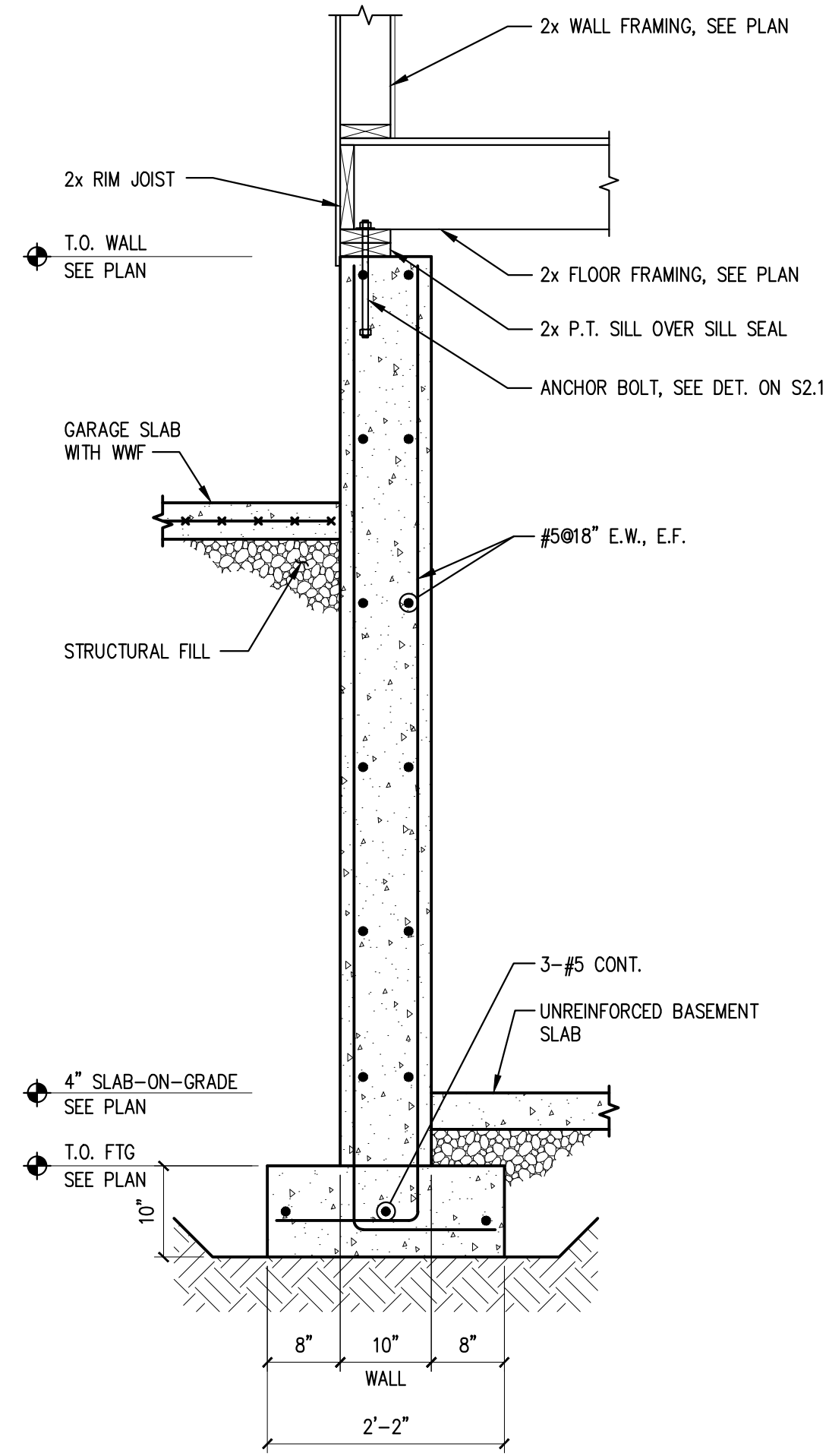

2 SECTION 3/4" = 1'-0"

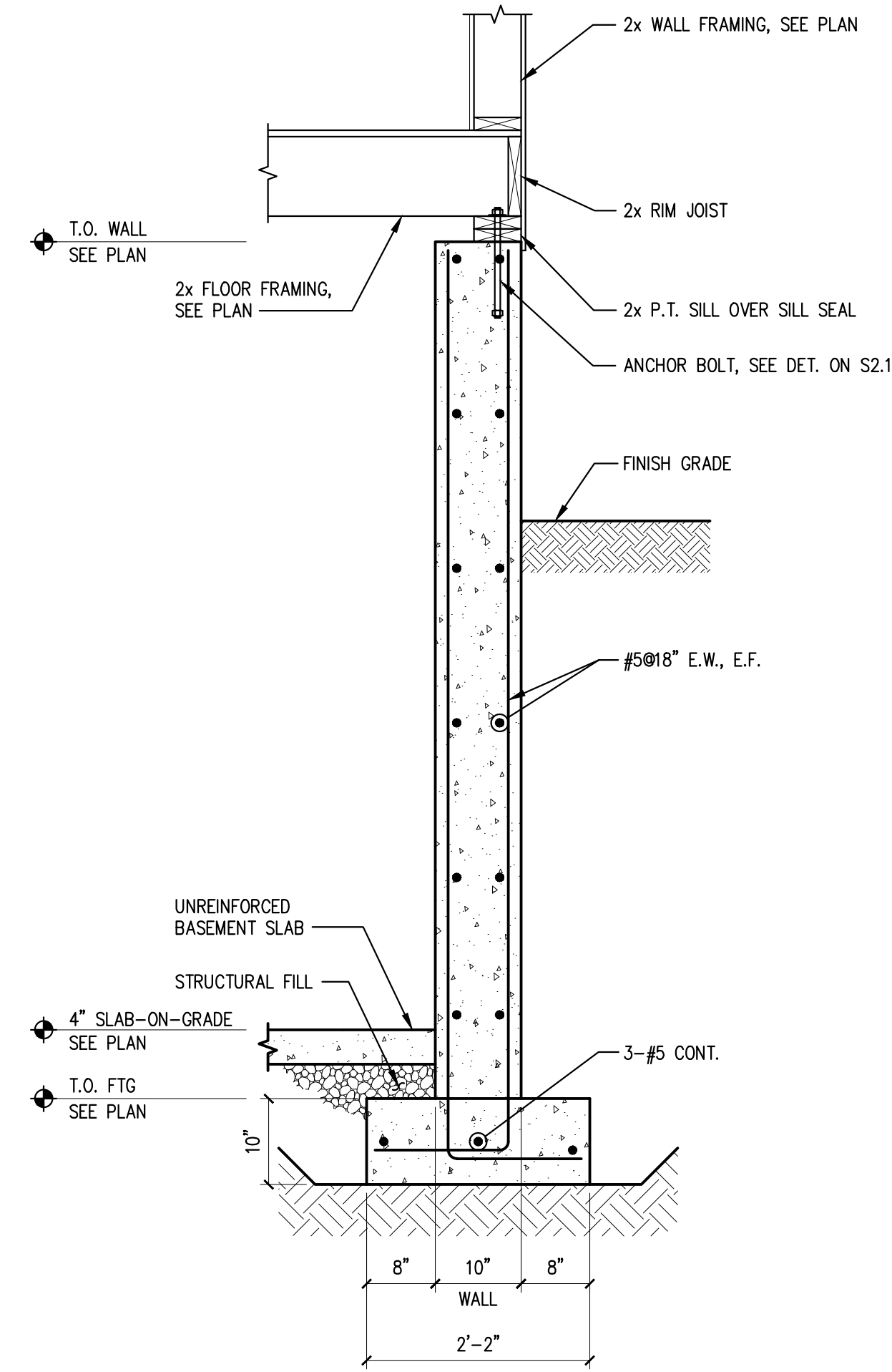

3 SECTION 3/4" = 1'-0"

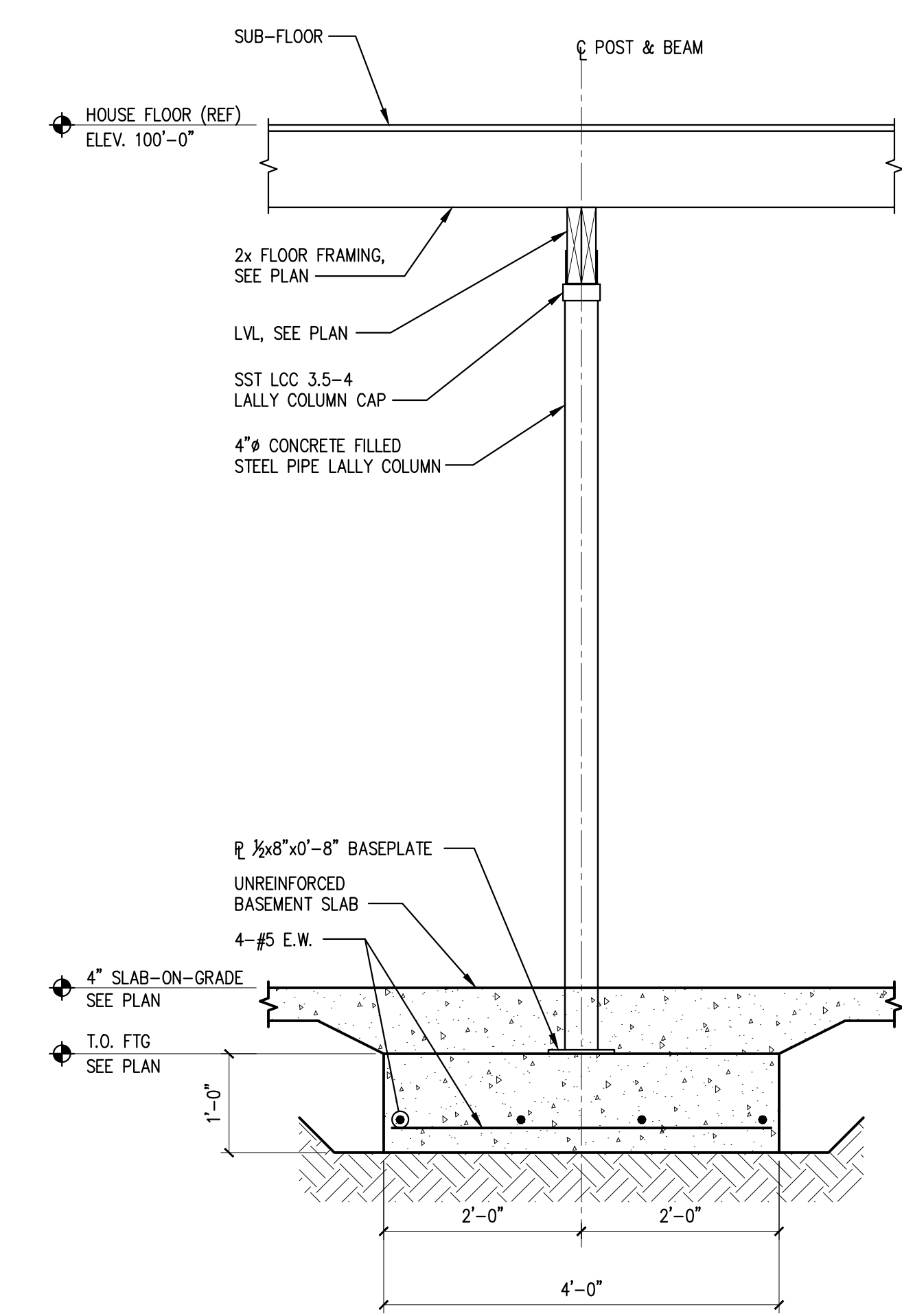

4 SECTION 3/4" = 1'-0"

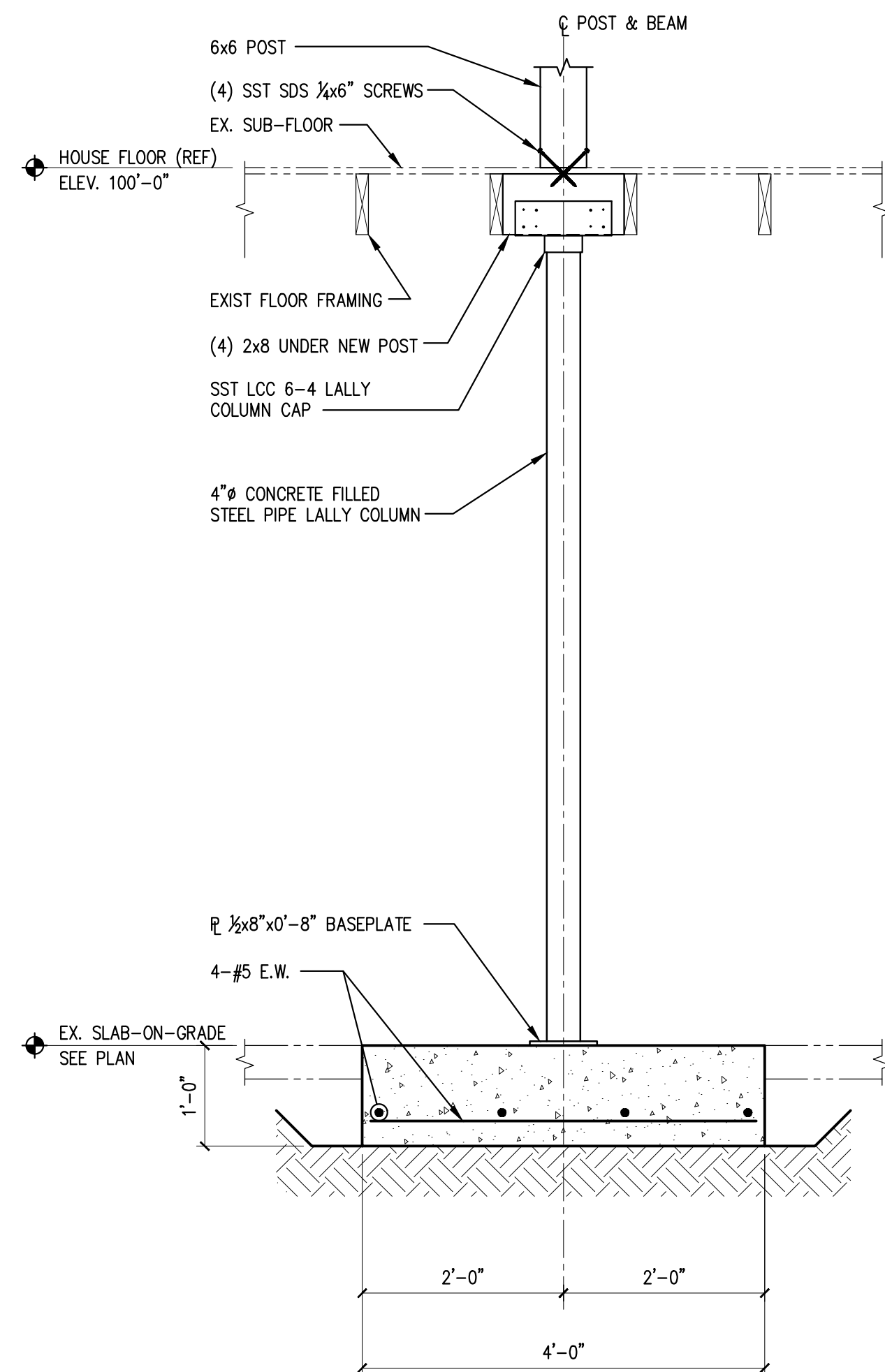

5 SECTION 3/4" = 1'-0"

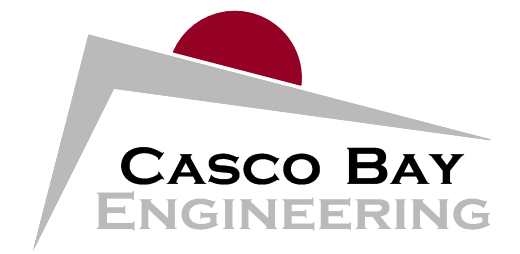

424 Fore Street
Portland, ME 04101
Phone 207.842.2800
Fax 207.842.2828
www.cascobayengineering.com

CLIENT:
WHIPPLE / CALLENDER
ARCHITECTS
136 PLEASANT AVE.
PORTLAND, MAINE

PRELIMINARY
NOT FOR CONSTRUCTION

OCEAN AVE. RESIDENCE
524 OCEAN AVE
PORTLAND, MAINE

BUILDING RENOVATION/ADDITION

ISSUED	DESCRIPTION	DR.	CHKD. BY	DATE
No.	A			

SHEET TITLE:

CONCRETE
DETAILS

DESIGNED: PR
DRAWN: PR
DATE: 2-5-15
PROJECT NUMBER: 15-019

S2.2