

Deck layout diagram



Top view without planks



Bottom view with planks

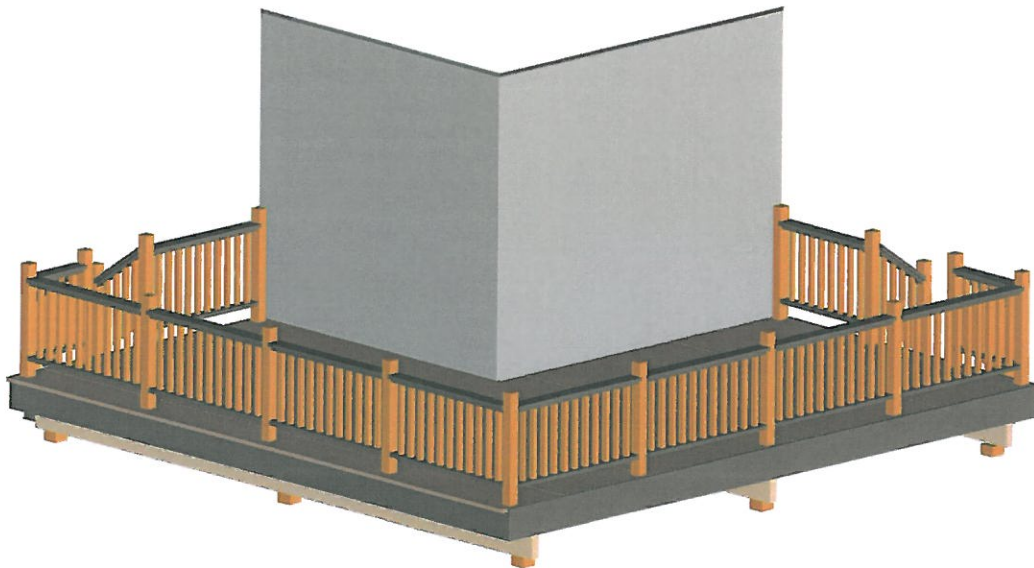

Top view with planks

Structural Connector Hardware Guide

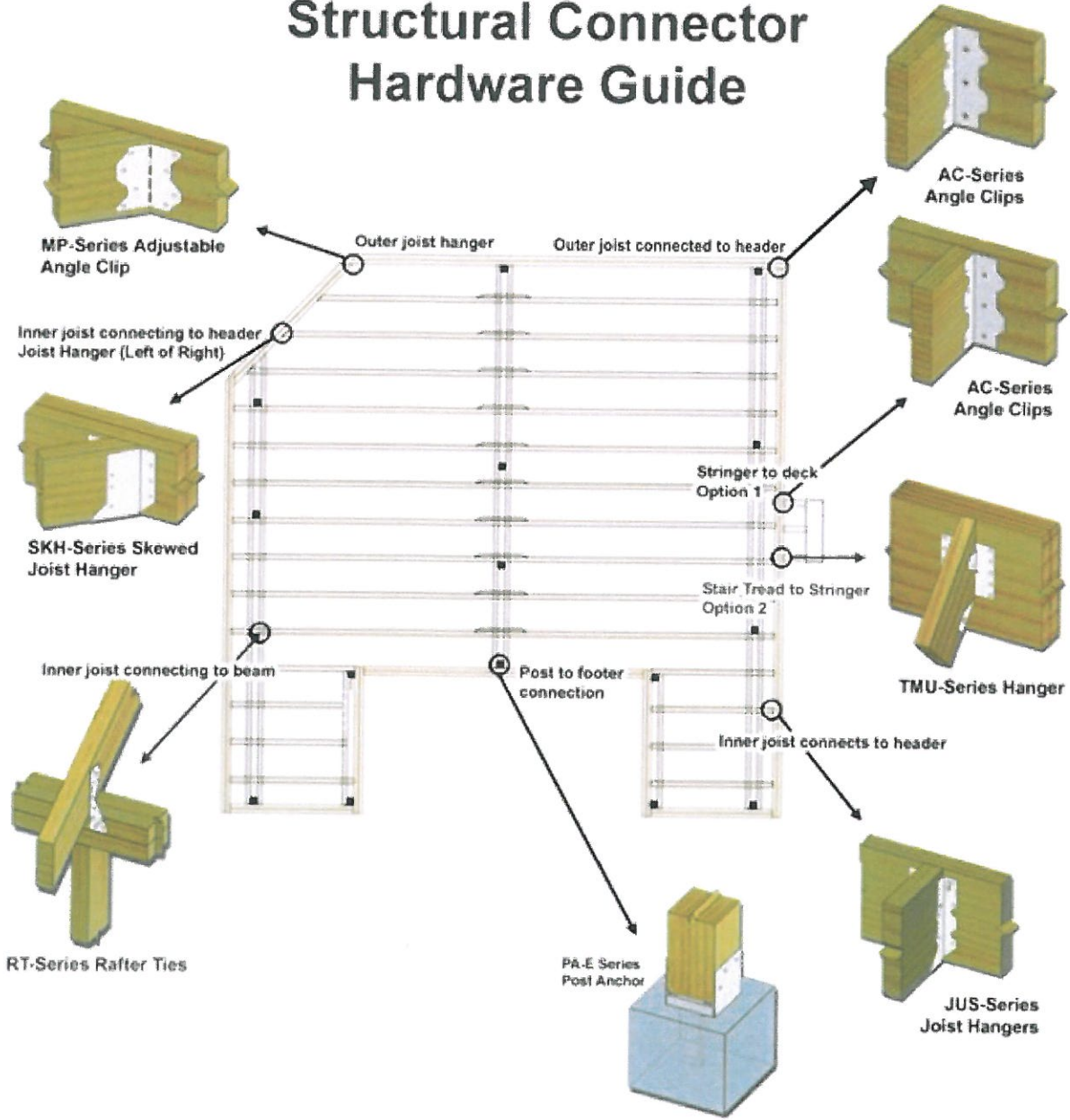

INSTALLATION CHECKLIST

Post bracing

Brace posts as dictated by local codes and by-laws.

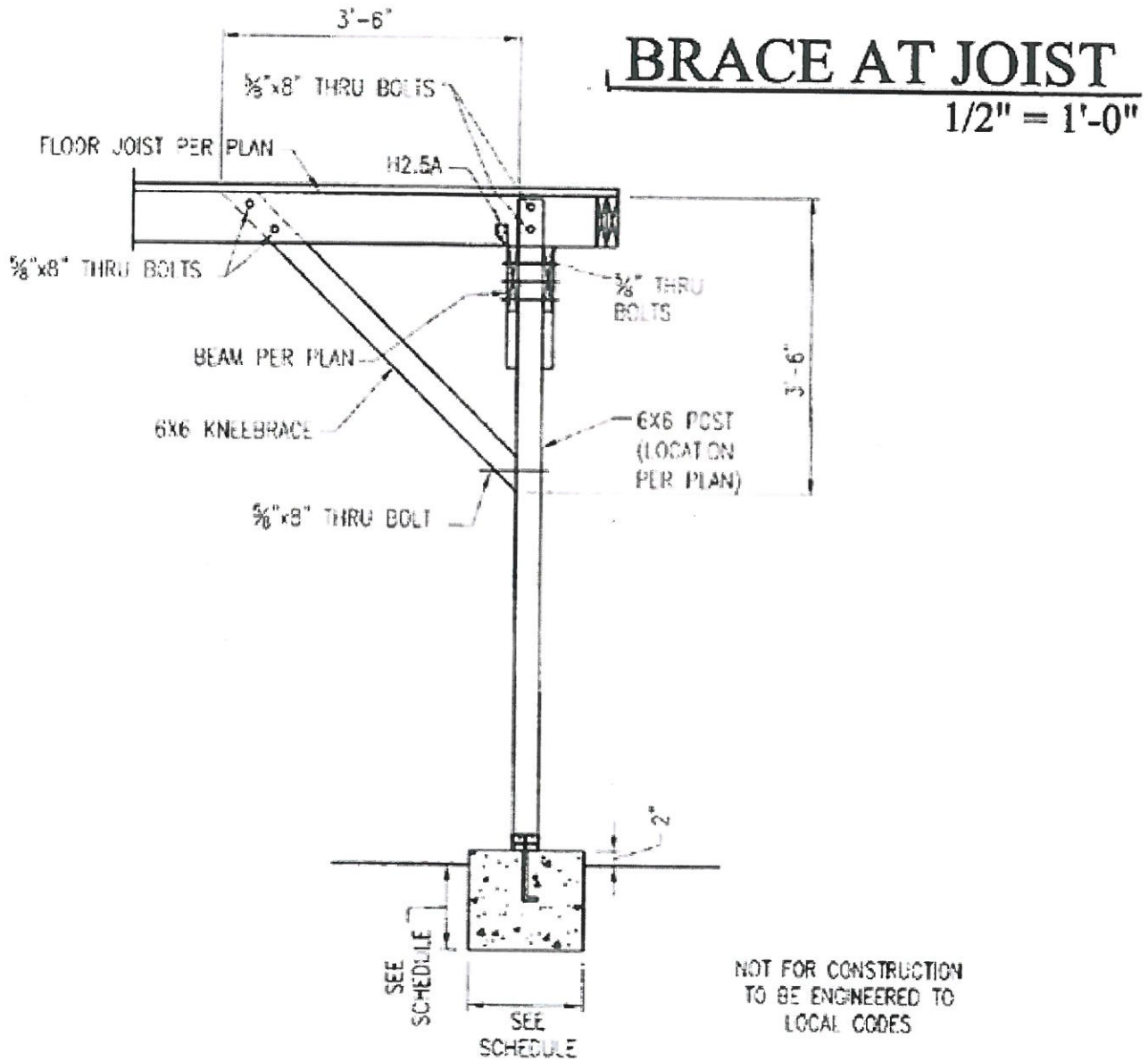

8'-0" MAX. GRADE TO TOP OF DECKING

Below are the Specifications And Materials that you have selected for your deck.

Overview	Number of Levels: 1	Footer Depth: 24" 48"
	Total Square Feet: 306	Live Load: 61 Dead Load: 10

Component	Size	Wood Type
Joists	2x10	Top Choice Treated
Beams	2x10	Top Choice Treated
Posts	6x6	Top Choice Treated
Decking	5/4x6	Composite
Railing		Composite
Bench		
Lattice		

FooterDepth	24" 48"	Live Load	61 psf
		Dead Load	10 psf

Material List

Lumber Materials

Item Number	Quantity	Description	Usage
201524	28	Top Choice 2 x 10 x 12 #2 Prime Pressure Treated Lumber	Rim Joist
201523	15	Top Choice 2 x 10 x 10 #2 Prime Pressure Treated Lumber	Beam
4643	10	Severe Weather 3-Step Treated Deck Stair Stringer	Pre Cut Stringer
201596	10	4X4X8 ACQ .40 TOP CHOICE TREATED	Railing Post
494513	10	ChoiceDek Foundations 2-in x 4-in x 8-ft Beach House Gray Composite Deck Railing	Railing Section
494510	10	ChoiceDek Foundations 14-Pack 31-in Beach House Gray Composite Deck Balusters	Baluster
371959	9	ChoiceDek Foundations 1-in x 6-in x 8-ft Beach House Gray Composite Decking Non-Grooved	Railing Section
371964	8	ChoiceDek Foundations 1 x 12 x 8 Beach House Gray Composite Deck Trim Board	Cladding
371959	88	ChoiceDek Foundations 1-in x 6-in x 8-ft Beach House Gray Composite Decking Non-Grooved	Decking
201525	2	Top Choice 2 x 10 x 16 #2 Prime Pressure Treated Lumber	Header
456216	1	6 x 6 x 8 #2 Pressure Treated Lumber	Post
201521	1	Top Choice 2 x 10 x 8 #2 Prime Pressure Treated Lumber	Stringer Support

Other Materials

Item Number	Quantity	Description	Usage
116209	38	USP#JUS210-TZ 2x10-12" TRIPLE ZINC JOIST HANGER	Joist Framing
184955	2	USP 1 lb 9-Gauge 1-1/2-in Galvanized Smooth Joist Hanger	Joist Framing
69139	8	Grip-Rite 1 lb 9-Gauge 3-in Hot-Dipped Galvanized Smooth Nails	Joist Framing
37164	5	USP#CLIP AC7-TZ 7" TRIPLE ZINC ANGLE	Joist Framing
21993	45	USP#RT7A-TZ TRIPLE ZINC RAFTER TIE	Joist Framing
68408	3	JOIST HGR.NAIL 1 LB 1-1/2"NA111CD	Joist Framing
68408	1	1.5"1LB HDG STRUCTURAL NAIL	Joist Framing
6472	8	USP#PA66E-TZ 6X6 TRIPLE ZINC DECK POST ANCHOR	Footing to Post
10385	20	QUIKRETE 80 lbs Setting Post Concrete Mix	Footing to Post
10150	4	CONCRETE FORM TUBE 12"X48"	Footing to Post
69141	1	NAIL COMMON GALV 1LB 16D	Footing to Post
163411	32	USP#PB66-6TZ POST CAP - TWO PIECE DESIGN	Post to Beam
29926	10	LSSH15TZ SLP/SKEW HGR TZ	CladRimOrStair
67366	69	GALV LAG SCREW 1/2 X 8	Railing Post
494511	19	ChoiceDek Foundations 4-in x 4-in x 48 in Beach House Gray Composite Deck Post Sleeve	Railing Post
263638	19	ChoiceDek Foundations 6-in x 6-in Beach House Gray Composite Deck Post Collar	Railing Post
63449	138	GALV ROUND WASHER 1/2"	Railing Post
41239	2	1/2" HEX NUT GALVANIZED (25) PP	Railing Post
63304	19	HEX NUTS 1/2 - 13	Railing Post
263354	19	ChoiceDek Foundations 6-in x 6-in Beach House Gray Composite Deck Post Cap	Railing Post
2235	11	FIELD ADJ FR ANGLE 4-5/8TZ	Joist Framing
18284	2	2 1/2" DECK SCREW 5# -10YR(51854)	Deck Planking



Other Materials			
Item Number	Quantity	Description	Usage
17365	1	2 1/2"PG 1 LB DECK SCREW(61550)	Deck Planking
Total Item Number Count: 35			

Beam Layout Level 1

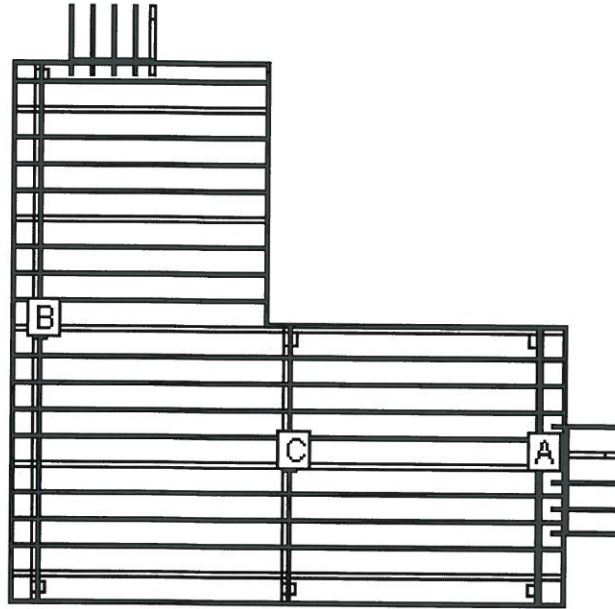

BEAM LABEL	BEAM LENGTH	POST COUNT	POST SPACING
A	10' 3 1/4"	2	9' 1 3/4"
B	19' 10 1/4"	3	9' 4 1/2"
C	10' 3"	3	4' 6 3/4"

Materials Cut List: Level 1

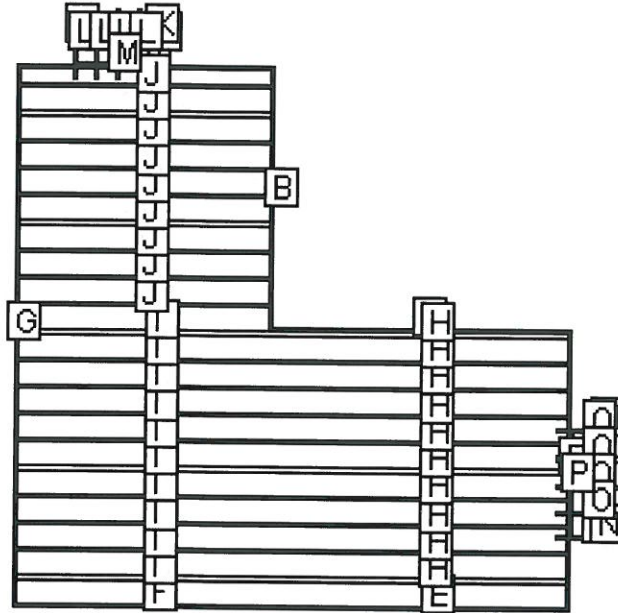

LABEL	NAME	QTY	LENGTH	BEVELS	LABEL	NAME	QTY	LENGTH	BEVELS
A	Rim Joist	1	9' 5 1/4"		I	Internal Joist	10	10' 3/4"	
B	Header	1	9' 7"		J	Internal Joist	9	9' 2 1/4"	
C	Rim Joist	1	10' 11"		K	Cladding	2	2' 6"	
D	Header	1	10' 1/4"		L	Pre Cut Stringer	5	2' 6"	
E	Rim Joist	1	10' 2 1/4"		M	Stringer Support	1	3' 1"	
F	Rim Joist	1	10' 2"		N	Cladding	2	2' 6"	
G	Header	1	19' 7 1/4"		O	Pre Cut Stringer	5	2' 6"	
H	Internal Joist	10	10' 1/2"		P	Stringer Support	1	4' 1/4"	

Cut Angles: L=Left, R=Right, F=Front, S=Side

Analysis Page: Level 1

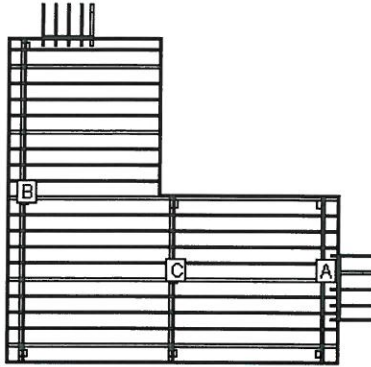

LOAD AND SUPPORT:

Your deck will support a 61 PSF live load.
Posts have 24" below ground support.

DECK AND POST HEIGHT:

You selected a height of 24" from the top of the decking to the ground level. The top of the deck support posts will therefore be 13" above ground level.

Joists:

Set joists on top of beams, 12"; center to center.

Stress Analysis: Level 1

Joist Deflection	532
Joist Bending	121
Joist Shear	224
Joist Compression	224
Beam Deflection	177
Beam Bending	71
Beam Shear	78
Post Stability	139