

DISPLAY THIS CARD ON PRINCIPAL FRONTAGE OF WORK

CITY OF PORTLAND

DEPARTMENT OF BUILDING INSPECTION

PERMIT

PERMIT
SEP 20 2004
Permit Number: 041344
CITY OF PORTLAND

Please Read Application And Notes, if Any, Attached

This is to certify that Mckenney John F & Mary C /Owner
has permission to install 6 x 30 Deck & Stairs
AT R _____ L 162 F011001

provided that the person or persons firm or corporation accepting this permit shall comply with all of the provisions of the Statutes of Maine and of the ordinances of the City of Portland regulating the construction, maintenance and use of buildings and structures, and of the application on file in this department.

Apply to Public Works for street line and grade if nature of work requires such information.

Notification of inspection must be given and when permission procured before this building or part thereof is leased or occupied. **FOUR HOUR NOTICE IS REQUIRED.**

A certificate of occupancy must be procured by owner before this building or part thereof is occupied.

OTHER REQUIRED APPROVALS
Fire Dept. _____
Health Dept. _____
Appeal Board _____
Other _____
Department Name

James Burke 9/21/04
Director - Building & Inspection Services

PENALTY FOR REMOVING THIS CARD

City of Portland, Maine - Building or Use Permit Application

389 Congress Street, 04101 Tel: (207) 874-8703, Fax: (207) 874-8716

Permit No: 04-1344	Issue Date:	CBL: 162 F011001
-----------------------	-------------	---------------------

Location of Construction: 86 Murray St	Owner Name: Mckenny John F & Mary C Jts	Owner Address: 86 Murray St	Phone:
Business Name:	Contractor Name: Owner	Contractor Address: Portland	Phone:
Lessee/Buyer's Name	Phone:	Permit Type: Single Family	Zone: R3

Past Use: Single Family Home	Proposed Use: Single Family Home / Install 6 x 30 Deck & Stairs	Permit Fee: \$30.00	Cost of Work: \$1,000.00	CEO District: 4
---------------------------------	--	------------------------	-----------------------------	--------------------

Proposed Project Description: Install 6 x 30 Deck & Stairs <i>Legal fee: permits # 98-0524 & 990873</i>	FIRE DEPT: <input type="checkbox"/> Approved <input type="checkbox"/> Denied	INSPECTION: Use Group: R3 Type: SB BOCA 1999 Signature: JMB 9/21/04
	PEDESTRIAN ACTIVITIES DISTRICT (P.A.D.) Action: <input type="checkbox"/> Approved <input type="checkbox"/> Approved w/Conditions <input type="checkbox"/> Denied Signature: _____ Date: _____	

Permit Taken By: Idobson	Date Applied For: 09/08/2004	Zoning Approval
-----------------------------	---------------------------------	------------------------

1. This permit application does not preclude the Applicant(s) from meeting applicable State and Federal Rules. 2. Building permits do not include plumbing, septic or electrical work. 3. Building permits are void if work is not started within six (6) months of the date of issuance. False information may invalidate a building permit and stop all work..	Special Zone or Reviews <input type="checkbox"/> Shoreland <input type="checkbox"/> Wetland <i>approved</i> <input type="checkbox"/> Flood Zone <input type="checkbox"/> Subdivision <input type="checkbox"/> Site Plan Maj <input type="checkbox"/> Minor <input type="checkbox"/> MM <input type="checkbox"/> Date: <i>JMB 9/21/04</i>	Zoning Appeal <input type="checkbox"/> Variance <input type="checkbox"/> Miscellaneous <input type="checkbox"/> Conditional Use <input type="checkbox"/> Interpretation <input type="checkbox"/> Approved <input type="checkbox"/> Denied Date: _____	Historic Preservation <input checked="" type="checkbox"/> Not in District or Landmark <input type="checkbox"/> Does Not Require Review <input type="checkbox"/> Requires Review <input type="checkbox"/> Approved <input type="checkbox"/> Approved w/Conditions <input type="checkbox"/> Denied Date: <i>JMB</i>
--	---	--	--

CERTIFICATION

I hereby certify that I am the owner of record of the named property, or that the proposed work is authorized by the owner of record and that I have been authorized by the owner to make this application as his authorized agent and I agree to conform to all applicable laws of this jurisdiction. In addition, if a permit for work described in the application is issued, I certify that the code official's authorized representative shall have the authority to enter all areas covered by such permit at any reasonable hour to enforce the provision of the code(s) applicable to such permit.

SIGNATURE OF APPLICANT	ADDRESS	DATE	PHONE
RESPONSIBLE PERSON IN CHARGE OF WORK, TITLE		DATE	PHONE

City of Portland, Maine - Building or Use Permit

389 Congress Street, 04101 Tel: (207)874-8703, Fax: (207) 874-8716

Permit No: 04-1344	Date Applied For: 09/08/2004	CBL: 162 F011001
------------------------------	--	----------------------------

Location of Construction: 86 Murray St	Owner Name: Mckenney John F & Mary C Jts	Owner Address: 86 Murray St	Phone:
Business Name:	Contractor Name: Owner	Contractor Address: Portland	Phone:
Lessee/Buyer's Name	Phone:	Permit Type: Single Family	

Proposed Use: Single Family Home / Install 6 x 30 Deck & Stairs	Proposed Project Description: Install 6 x 30 Deck & Stairs
---	--

Dept: Zoning	Status: Approved	Reviewer: Jeanine Bourke	Approval Date: 09/21/2004
Note:			Ok to Issue: <input type="checkbox"/>
1) It is the responsibility of the owner to indicate the property lines for the setback inspector. 2) This property shall remain a single family dwelling. Any change of use shall require a separate permit application for review and approval.			
Dept: Building	Status: Approved with Conditions	Reviewer: Jeanine Bourke	Approval Date: 09/21/2004
Note:			Ok to Issue: <input checked="" type="checkbox"/>
1) Permit approved based on the plans submitted and reviewed w/owner/contractor, with additional information as agreed on and as noted on plans.			

This page contains a detailed description of the Parcel ID you selected. Press the **New Search** button at the bottom of the screen to submit a new query.

Current Owner Information

Card Number	1 of 1
Parcel ID	162 F011001
Location	86 MURRAY ST
Land Use	SINGLE FAMILY
Owner Address	MCKENNEY JOHN F & MARY C JTS 86 MURRAY ST PORTLAND ME 04103
Book/Page	
Legal	162-F-11-12-13 MURRAY ST 84-86 9132 SF

Valuation Information

Land	Building	Total
\$29,720	\$68,670	\$98,390

Property Information

Year Built	Style	Story Height	Sq. Ft.	Total Acres	
1982	Cape	1.5	1262	0.21	
Bedrooms	Full Baths	Half Baths	Total Rooms	Attic	Basement
3	1		6	None	Full

Outbuildings

Type	Quantity	Year Built	Size	Grade	Condition
SHED-FRAME	1	1998	8X10	C	A

Sales Information

Date	Type	Price	Book/Page
10/15/1993	LAND + BLDING	\$84,000	11025-014

Picture and Sketch

[Picture](#) [Sketch](#)

[Click here to view Tax Roll Information.](#)

Any information concerning tax payments should be directed to the Treasury office at 874-8490 or e-mailed.

New Search!



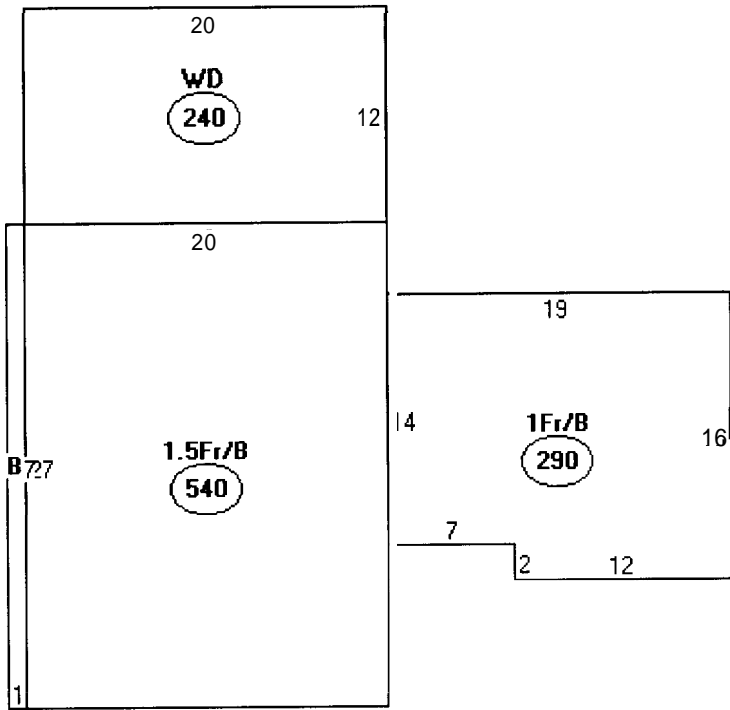

Descriptor/Area

- A: 1.5Fr/B
540 sqft
- B: FOH
27 sqft
- C: WD
240 sqft
- D: 1Fr/B
290 sqft

1,097
80 shed

1,177
180 deck

1,357 SF

Lot = 9,132
x 25%

2,283 SF

OK

All Purpose Building Permit Application

If you or the property owner owes real estate or personal property taxes or user charges on any property with the City, payment arrangements must be made before permits of any kind are accepted.

Location/Address of Construction: <u>86 MURRAY STREET, PHD, ME 0410</u>		
Total Square Footage of Proposed Structure <u>6' x 30' 180'</u>	Square Footage of Lot <u>House lot size.</u>	
Tax Assessor's Chart, Block & Lot Chart# <u>162</u> Block# <u>F</u> Lot# <u>11</u>	Owner: <u>John + MARY McKenney</u>	Telephone: (207) <u>774-6863</u>
Lessee/Buyer's Name (if applicable) <u>N/A</u>	Applicant name, address & telephone: <u>John + MARY McKenney</u>	Cost of Work: \$ <u>1000</u> Fee: \$ <u>30/00</u>
Current use: <u>Replacing Rotten Porch</u>		
If the location is currently vacant, what was prior use: <u>JA</u>		
Approximately how long has it been vacant: _____		
Proposed use: <u>Porch/Deck</u>		
Project description: <u>Porch/Deck</u>		
Contractor's name, address & telephone: <u>N/A self</u>		
Who should we contact when the permit is ready: <u>John or MARY McKenney 774-6863</u>		
Mailing address: _____		
We will contact you by phone when the permit is ready. You must come in and pick up the permit and review the requirements before starting any work, with a Plan Reviewer. A stop work order will be issued and a \$100.00 fee if any work starts before the permit is picked up. PHONE: <u>774-6863</u>		

IF THE REQUIRED INFORMATION IS NOT INCLUDED IN THE SUBMISSIONS THE PERMIT WILL BE AUTOMATICALLY DENIED AT THE DISCRETION OF THE BUILDING/PLANNING DEPARTMENT, WE MAY REQUIRE ADDITIONAL INFORMATION IN ORDER TO APPROVE THIS PERMIT.

I hereby certify that I am the Owner of record of the named property, or that the owner of record authorizes the proposed work and that have been authorized by the owner to make this application as his/her authorized agent. I agree to conform to all applicable laws of the jurisdiction. In addition, if a permit for work described in this application is issued, I certify that the Code Official's authorized representative shall have the authority to enter all areas covered by this permit at any reasonable hour to enforce the provisions of the codes applicable to this permit.

Signature of applicant: [Signature] Date: 8 Sep 04

This is NOT a permit, you may not commence ANY work until the permit is issued. If you are in a Historic District you may be subject to additional permitting and fees with the Planning Department on the 4th floor of City Hall



EXISTING 162711

162711

R3 Zone

Front 25' Req
30' shown

Rear 25' Req
50' shown

Side 8' Req
18' shown

House (Front)

ROAD (MURRAY STREET)

80'



162711

DRIVEWAY

8x16 block
2x16 16 O.C. Joists
4x6 Beams

30'

Cross sections

Access to rear porch

Entrance

STEPS

Deck platform, etc.
Dinner table

Spilling along
parking side

6'
Existing
(remove this)

205'

Planks

6x8 w/ 16 O.C. Joists
to porch

Deck

6'
30'

Impans

10/1/2017

(1) To be

Impans

(2) It is

(3) It is a 4x6 beam & 2x6 16 o.c. just 5/4 decking

(4) There will be a 4x4 post 36" tall. There will be 4x4 posts between the beams.

Proposed Design (Side view)
 for Murrays / etc

* Not to Scale

Supports

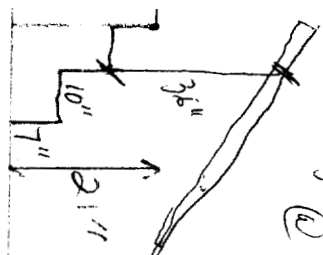
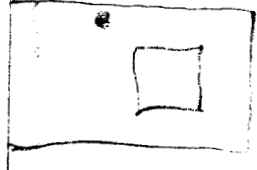
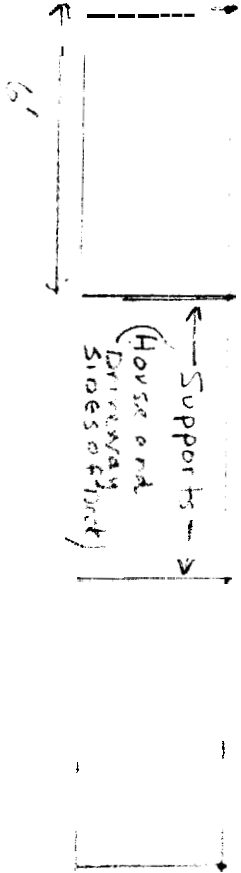

Will attach
 grasspale material
 @ 54-38
 panels
 returned
 One
 side

Plate

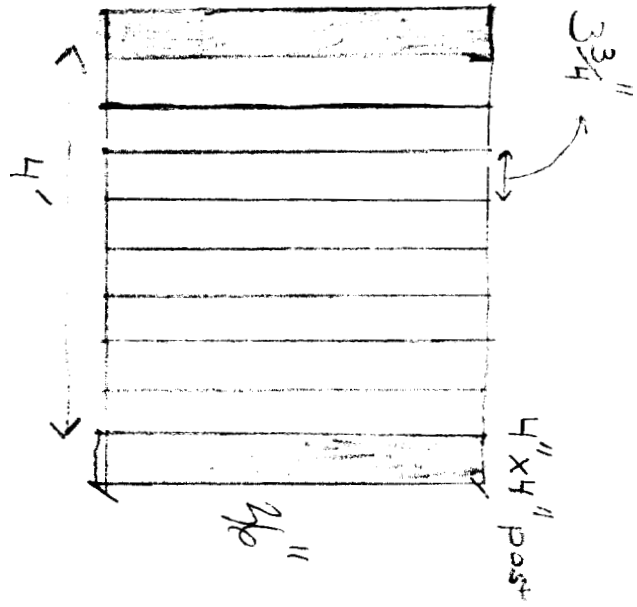

BUILDING PERMIT INSPECTION PROCEDURES

Please call **874-8703 or 874-8693** to schedule your inspections as agreed upon

Permits expire in 6 months, if the project is not started or ceases for 6 months.

The Owner or their designee is required to notify the inspections office for the following inspections and provide adequate notice. Notice must be called in **48-72** hours in advance in order to schedule an inspection:

By initializing at each inspection time, you are agreeing that you understand the inspection procedure and additional fees from a "Stop Work Order" and "Stop Work Order Release" will be incurred if the procedure is not followed as stated below.

A Pre-construction Meeting will take place upon receipt of your building permit.

- Footing/Building Location Inspection:** Prior to pouring concrete
- Re-Bar Schedule Inspection:** Prior to pouring concrete
- Foundation Inspection:** Prior to placing ANY backfill
- Framing/Rough Plumbing/Electrical:** Prior to any insulating or drywalling
- Final/Certificate of Occupancy:** Prior to any occupancy of the structure or use. NOTE: inspection at this point.

Certificate of Occupancy is not required for certain projects. Your inspector can advise you if your project requires a Certificate of Occupancy. All projects DO require a final inspection

If any of the inspections do not occur, the project cannot go on to the next phase, REGARDLESS OF THE NOTICE OR CIRCUMSTANCES.

CERIFICATE OF OCCUPANICES MUST BE ISSUED AND PAID FOR, BEFORE THE SPACE MAY BE OCCUPIED

Mary McKenney
Signature of Applicant/Designee

9/21/04
Date

Jane Bonta
Signature of Inspections Official

9/21/04
Date

CBL: 162-F-11

Building Permit #: 04-1344